

**LEGEND**

	Park property line
	Private property line
	Exist. chain link fence
	Existing Water main
	Existing hydrant
	Existing water valve
	Existing sewer main
	Existing manhole
	Existing catch basin
	Existing curb inlet
	Existing light standard
	Existing hydro pole w/ light
	Existing hydro pole
	Existing tree

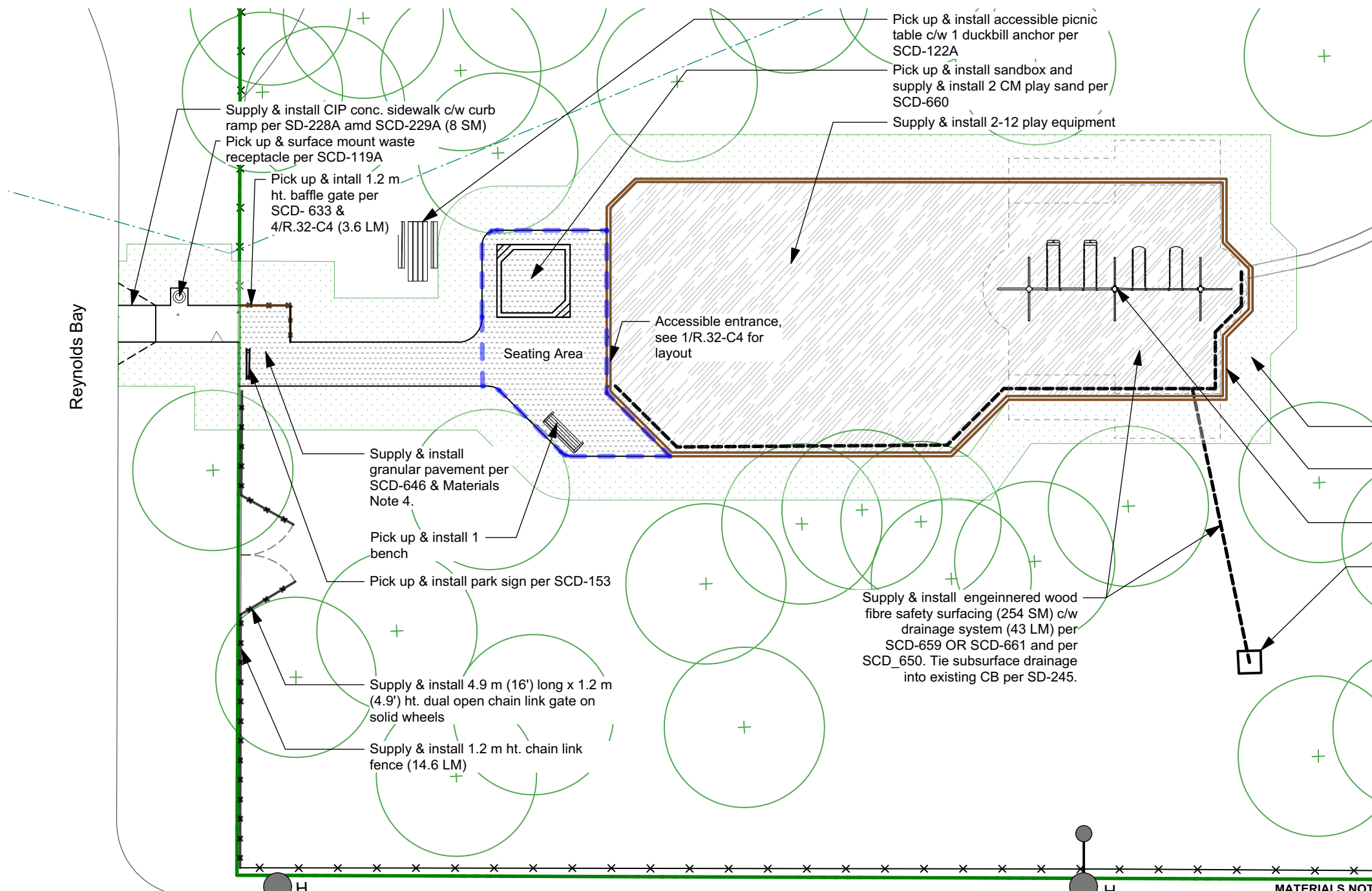

**MATERIALS NOTES**

1. ALL WORK TO CONFORM TO CURRENT CITY OF WINNIPEG STANDARD CONSTRUCTION SPECIFICATIONS AND DETAILS UNLESS OTHERWISE NOTED.
2. DIMENSIONS ARE IN METERS UNLESS OTHERWISE NOTED.
3. DO NOT SCALE DRAWING.
4. GRANULAR PAVEMENT PER SCD-646 & 1/R.32-C5
  - i) REMOVE ALL EXISTING ORGANIC MATERIAL TO AN APPROX. DEPTH OF 75mm.
  - ii) APPROXIMATELY 6 CUBIC METERS OF 50 mm (2") DOWN CRUSHED LIMESTONE SUB-BASE REQUIRED TO MEET DESIGN GRADES AT SEATING AREA.

CONTRACTOR TO CONFIRM ALL DIMENSIONS AND REPORT ANY DISCREPANCIES TO CONTRACT ADMINISTRATOR PRIOR TO CONSTRUCTION. LOCATION OF UNDERGROUND STRUCTURES AS SHOWN ARE BASED ON THE BEST INFORMATION AVAILABLE BUT NO GUARANTEE IS GIVEN THAT ALL EXISTING UTILITIES ARE SHOWN OR THAT THE GIVEN LOCATIONS ARE EXACT. CONFIRMATION OF EXISTENCE AND EXACT LOCATION OF ALL SERVICES MUST BE OBTAINED FROM THE INDIVIDUAL UTILITIES BEFORE PROCEEDING WITH CONSTRUCTION.

1  
R.32-C2  
**Materials Plan**  
Scale: 1:200

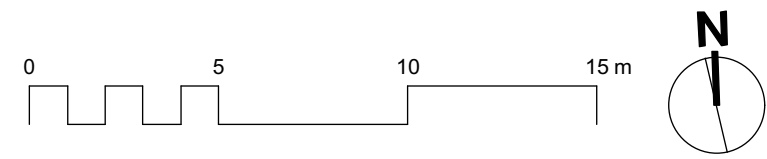

THE CITY OF WINNIPEG  
Planning, Property and Development Department  
Planning and Land Use Division  
Unit 15 - 30 Fort Street, Winnipeg, MB, (R3C 4X5)

DESIGNED BY	CHECKED BY
DRAWN BY LL	APPROVED BY
HORIZ. SCALE AS NOTED	
VERT. SCALE	
DATE MAY 2019	

MANAGER, PARK AND OPEN SPACES	DATE
MANAGER, PLANNING AND LAND USE DIVISION	DATE

DRAWING TITLE  
**Reynolds Park  
Playground Redevelopment  
Materials Plan**

SITE ADDRESS 35 Reynolds Bay

DRAWING NO.  
**R.32-C2**

BID OPPORTUNITY NO.  
**440-2019**