

NOTE:
ALL DIMENSIONS TAKEN
TO FACE OF STUD UNLESS
OTHERWISE NOTED

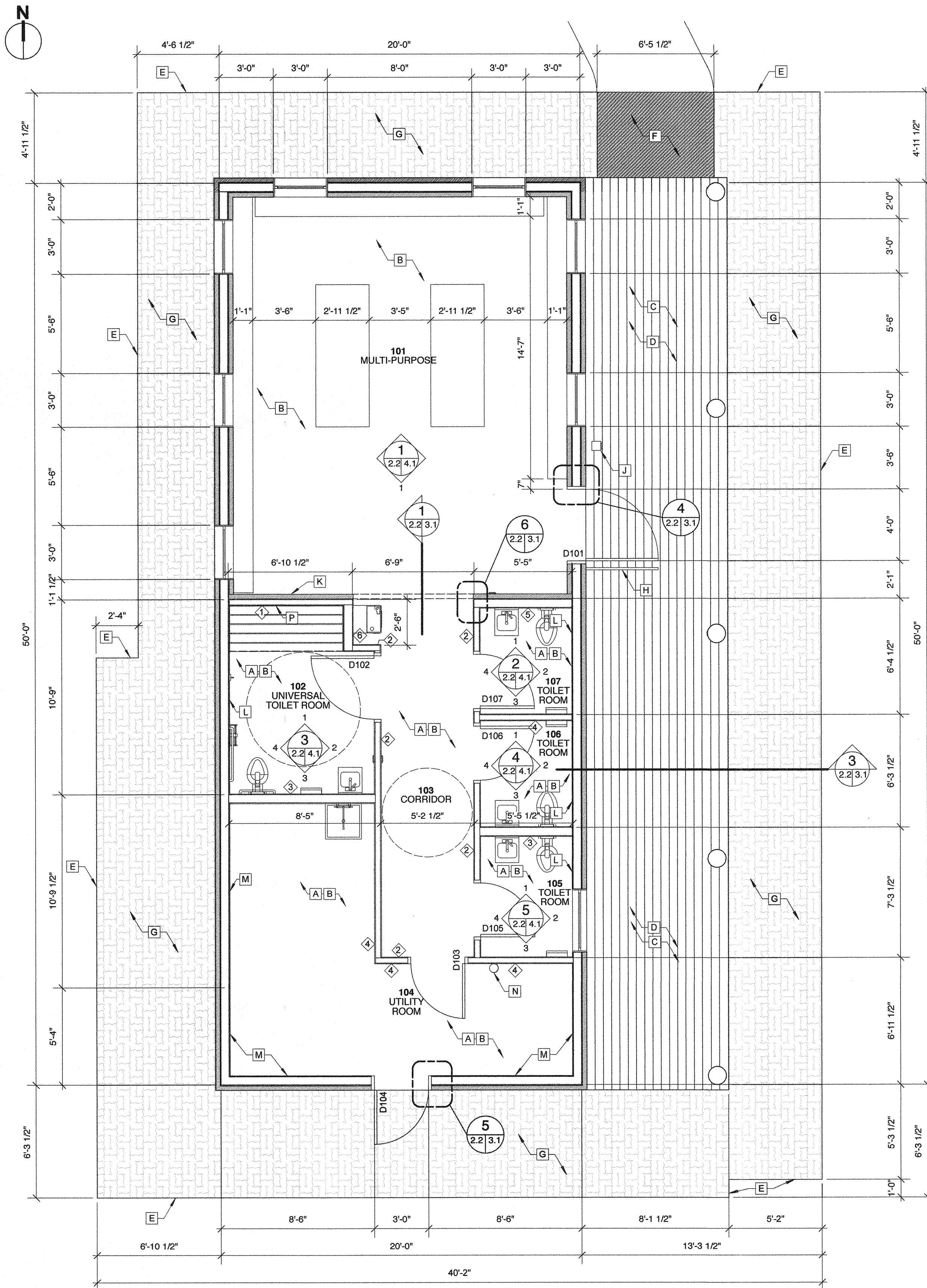

B MAIN FLOOR PLAN - RENOVATION
SCALE: 1/4" = 1'-0"

RENOVATION NOTES:

- A PATCH AND REPAIR CONCRETE FLOOR AS REQUIRED TO INSTALL NEW PLUMBING SERVICES. PROVIDE 12" DOWELS @ 16" O.C. FOR ALL CONCRETE SLAB INFILLS.
- B PAINT ALL CONCRETE FLOORS.
- C INSTALL NEW 2X8 PRESSURE TREATED WOOD JOISTS @ 16" O.C. REFER TO SECTION 3 ON A3.1.
- D INSTALL NEW COMPOSITE DECKING.
- E INSTALL NEW 2X6 PRESSURE TREATED EDGE BOARD AROUND PAVERS.
- F INSTALL NEW ASPHALT PAVEMENT. TRANSITION TO MEDIATE GRADE BETWEEN ASPHALT WALKWAY AND BOARDWALK.
- G RE-INSTALL EXISTING PAVERS OVER NEW COMPACTED GRANULAR BASE.
- H INSTALL NEW 4'-0" ALUMINUM GUIDE RAIL.
- J INSTALL NEW AUTOMATIC OPERATOR POST C/W WIRING. PROVIDE SOLID BLOCKING BETWEEN JOISTS TO SECURE POST AS PER MANUFACTURER'S INSTALLATION INSTRUCTIONS.
- K REINSTALL EXISTING COAT HOOK.
- L INSTALL NEW FRP PANELS ON EXISTING PLYWOOD SHEATHING.
- M PAINT EXISTING PLYWOOD SHEATHING.
- N NEW FIRE EXTINGUISHER.
- P NEW BENCH. PROVIDE SOLID WOOD BLOCKING IN WALL. REFER TO DETAILS 7 & 8 ON A4.1.

WALL TYPES

NOTE:
PROVIDE BLOCKING IN ALL WALLS TO ACCOMMODATE GRAB BARS, FIXTURES AND ACCESSORIES.

- 1 FRP PANEL
1/2" PLYWOOD SHEATHING
2 x 4 WOOD STUDS @ 16" O.C.
1/2" PLYWOOD SHEATHING
EXISTING LOG FINISH, RE-INSTALLED
- 2 FRP PANEL
1/2" PLYWOOD SHEATHING
2 x 4 WOOD STUDS @ 16" O.C.
1/2" PLYWOOD SHEATHING
FIBRE REINFORCED CEMENTITIOUS WALL PANEL
- 3 FRP PANEL
1/2" PLYWOOD SHEATHING
2 x 6 WOOD STUDS @ 16" O.C.
1/2" PLYWOOD SHEATHING
FRP PANEL
- 4 FRP PANEL
1/2" PLYWOOD SHEATHING
2 x 4 WOOD STUDS @ 16" O.C.
1/2" PLYWOOD SHEATHING
FRP PANEL
- 5 FRP PANEL
1/2" PLYWOOD SHEATHING
2 x 6 WOOD STUDS @ 16" O.C.
1/2" PLYWOOD SHEATHING
EXISTING LOG FINISH, RE-INSTALLED
- 6 FRP PANEL
1/2" PLYWOOD SHEATHING
2 x 6 WOOD STUDS @ 16" O.C.
1/2" PLYWOOD SHEATHING
FIBRE REINFORCED CEMENTITIOUS WALL PANEL

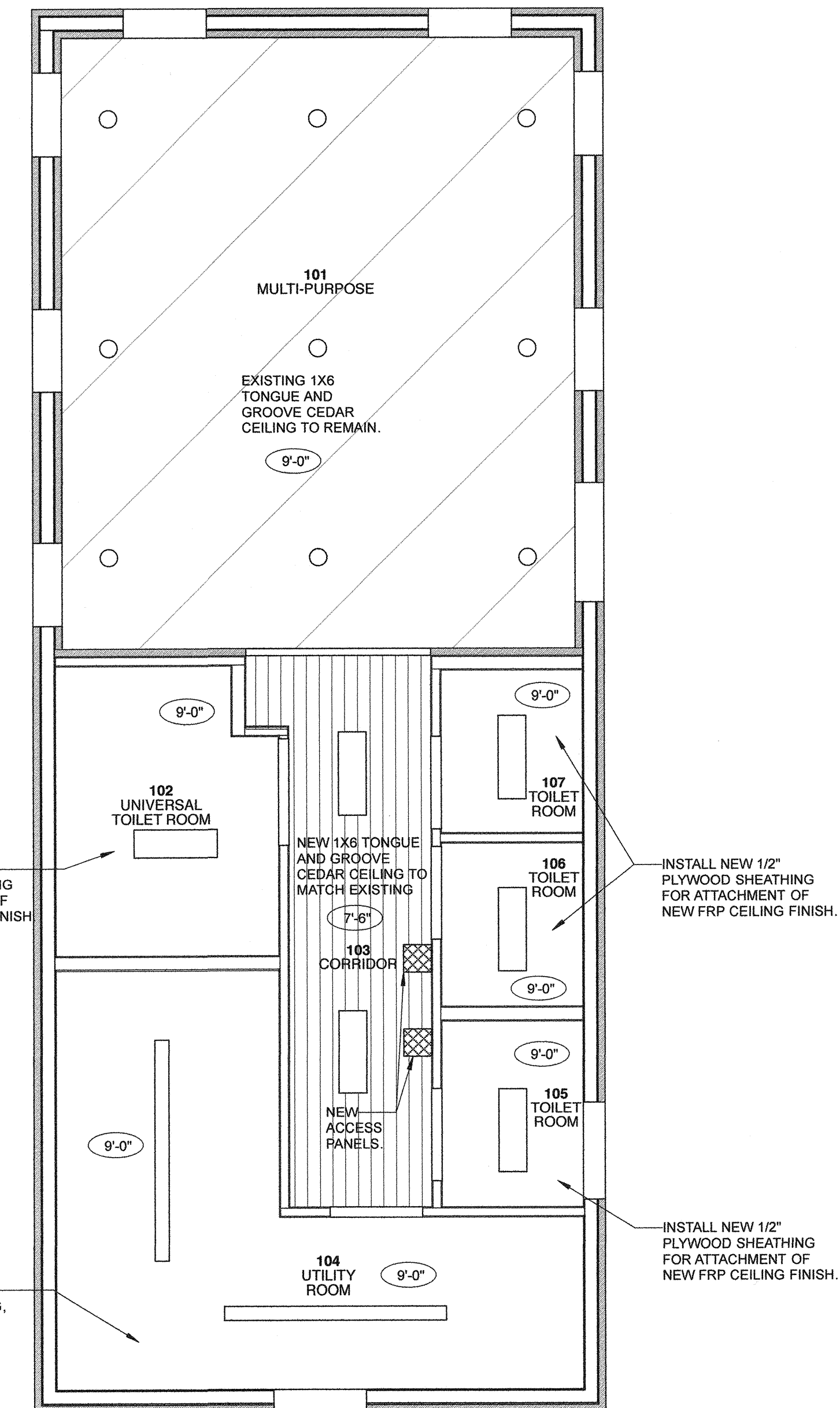

C REFLECTED CEILING PLAN - RENOVATION
SCALE: 1/4" = 1'-0"

- LEGEND:**
- EXISTING LIGHT FIXTURE
REFER TO ELECTRICAL
 - SURFACE MOUNTED LIGHT FIXTURE
REFER TO ELECTRICAL
 - ▬ SURFACE MOUNTED LIGHT FIXTURE
REFER TO ELECTRICAL



Revisions

| | |
|---------------|-------------------------|
| July 24, 2019 | Issued for Construction |
| Date | Revision |

Northern Sky Architecture Inc.

100-128 James Avenue
Winnipeg, Manitoba, Canada
R3B 0W8
Telephone: 204.656.7979
204.943.6767

Stamp

PROVINCE OF MANITOBA
NORTHERN SKY ARCHITECTURE INC.
No. 031
ARCHITECTURAL CORPORATION

Stamp

PROVINCE OF MANITOBA
DONALD R. OLIVER
24/7/19
REGISTERED ARCHITECT

Project

City of Winnipeg
Washroom/Change Building Renovations
64093 Klumpke Road
R1 Rosser, Manitoba

drawing title **RENOVATION - FLOOR PLAN / REFLECTED CEILING PLAN**

| | | | |
|---------------|------------|-------------|------|
| scale | as noted | designed by | kdw |
| date | July, 2019 | drawn by | jls |
| project no. | 19.166 | reviewed by | dko |
| reference no. | sheet | A2.2 | REV. |