

BROOKLYN STREET

ST MATTHEWS AVE

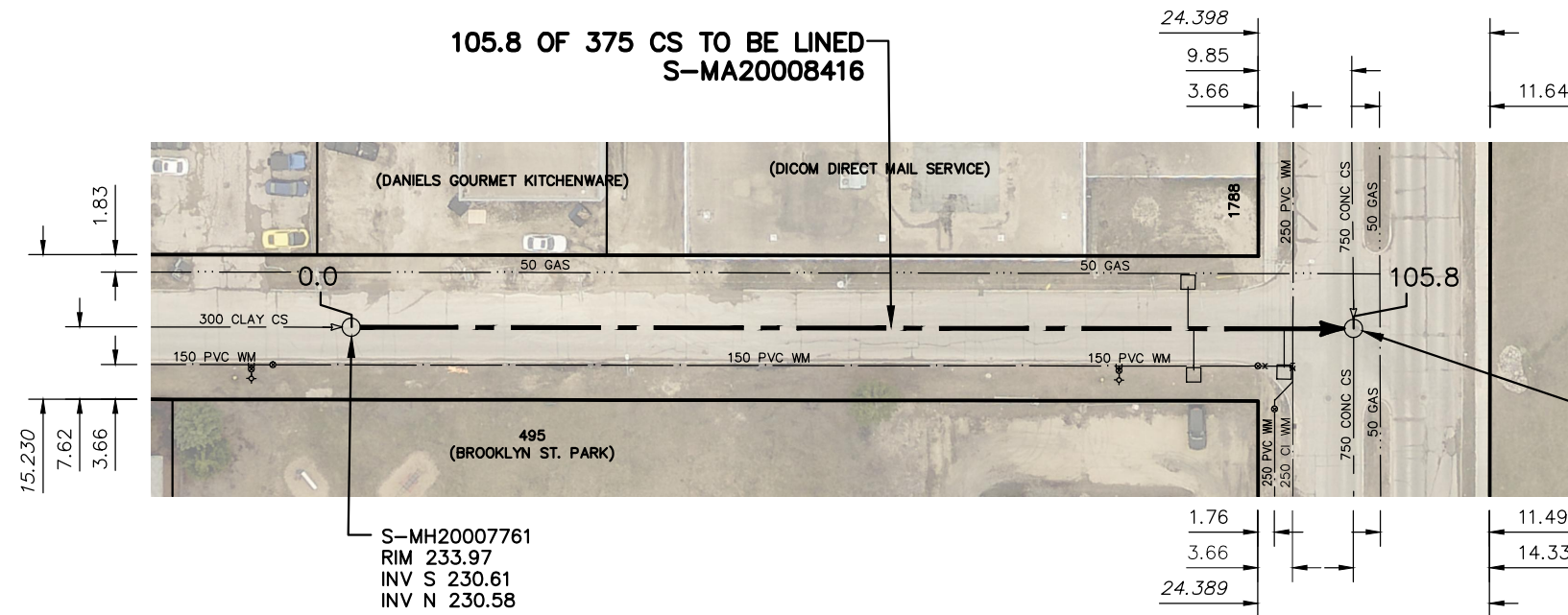

SEWER JUNCTION INFORMATION FROM SEWER VIDEO INSPECTION		
SEWER ID S-MA20008416		
DISTANCE FROM MH ID S-MH20007761		
DISTANCE	DIAMETER	CLOCK
14.2	150	11
14.9	150	11
58.7	150	10
68.8	150	11
70.0	150	1

S-MH20007060
RIM 233.98
INV E 229.26
INV S 230.15
INV W 229.26

S-MH20007761
RIM 233.97
INV S 230.61
INV N 230.58

WARNING

IF POWER EQUIPMENT OR EXPLOSIVES ARE TO BE USED FOR EXCAVATION ON THIS PROJECT THE CONTRACTOR MUST:

- 1) NOTIFY THE GAS COMPANY OF THE PROPOSED LOCATION OF EXCAVATION.
- 2) TAKE PRECAUTION TO AVOID DAMAGE TO GAS COMPANY INSTALLATIONS.

SEE PROVINCIAL REGULATION 210/72 FOR DETAILS

FOR INDEX SEE
11987

METRIC

WHOLE NUMBERS INDICATE MILLIMETRES
DECIMALIZED NUMBERS INDICATE METRES

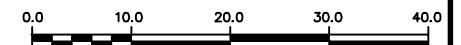

LOCATION APPROVED UNDERGROUND STRUCTURES

SUPV. U/G STRUCTURES COMMITTEE DATE

NOTE:

LOCATION OF UNDERGROUND STRUCTURES AS SHOWN ARE BASED ON THE BEST INFORMATION AVAILABLE BUT NO GUARANTEE IS GIVEN THAT ALL EXISTING UTILITIES ARE SHOWN OR THAT THE GIVEN LOCATIONS ARE EXACT. CONFIRMATION OF EXISTENCE AND EXACT LOCATION OF ALL SERVICES MUST BE OBTAINED FROM THE INDIVIDUAL UTILITIES BEFORE PROCEEDING WITH CONSTRUCTION.

B.M. ELEV.			
NO.	REVISIONS	DATE	BY

DESIGNED BY	SC	CHECKED BY	SC
DRAWN BY	AJ	APPROVED BY	KZ
SCALE:	1:750	RELEASED FOR CONSTRUCTION	K. ZUREK
HORIZONTAL		DATE	
VERTICAL	DATE	2019 01 24	DATE

ENGINEER'S SEAL
ORIGINAL SIGNED BY
S.R.J. COURNOYER
19/01/22
CONSULTANT DRAWING NUMBER -



THE CITY OF WINNIPEG

WATER AND WASTE DEPARTMENT
ENGINEERING DIVISION

2018 SEWER MAIN RENEWALS
BY AUGMENTATION
BROOKLYN STREET
1ST MH S OF ST MATTHEWS AVENUE TO
MH AT ST MATTHEWS AVENUE

SHEET **13** OF **52**
CITY DRAWING NUMBER
11998

PLOT DATE: 2019 01 24

BID OPPORTUNITY: 58-2019
CONTRACT NUMBER: 4

FILE PATH: R:\DRAWINGS\SEWER\2018 RENEWALS\RENEWALS & ASSOCIATED WORKS\CONTRACT 4\CONSTRUCTION DWGS\
FILE NAME: BROOKLYN STREET 1ST MH S OF ST MATTHEWS.dwg