

POWERS ST KILBRIDE AVENUE

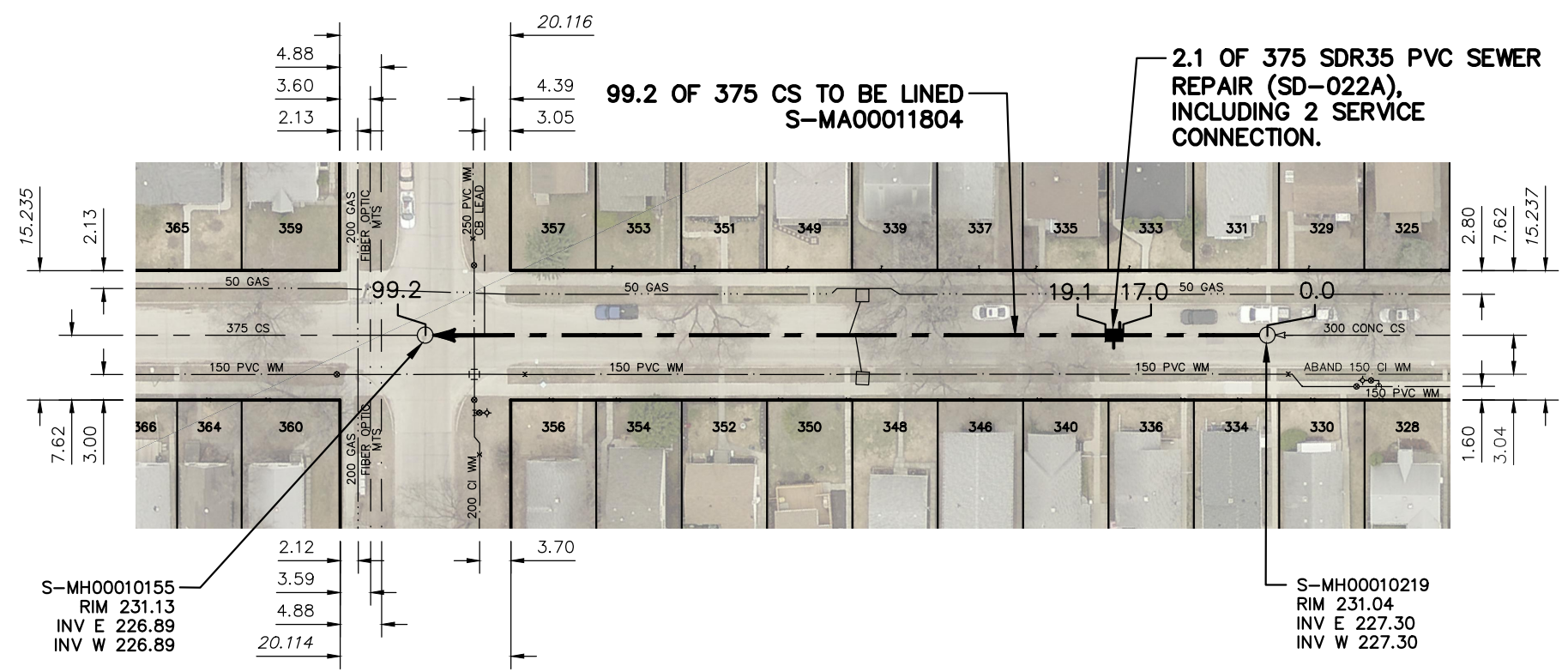

SEWER JUNCTION INFORMATION FROM SEWER VIDEO INSPECTION		
SEWER ID S-MA00011804		
DISTANCE FROM MH ID S-MH00010219	DIAMETER	CLOCK
6.5	150	10
7.2	150	2
17.4	150	2
18.1	150	10
27.3	150	10
28.3	150	2
37.5	150	10
38.2	150	2
47.5	150	2
49.1	150	10
49.7	150	10
50.7	150	1
58.5	150	2
60.0	150	10
68.4	150	10
69.2	150	1
79.2	150	10
79.2	150	1
85.0	150	1
85.7	150	10
90.2	150	10
92.9	150	2

WARNING

IF POWER EQUIPMENT OR EXPLOSIVES ARE TO BE USED FOR EXCAVATION ON THIS PROJECT THE CONTRACTOR MUST:

- 1) NOTIFY THE GAS COMPANY OF THE PROPOSED LOCATION OF EXCAVATION.
- 2) TAKE PRECAUTION TO AVOID DAMAGE TO GAS COMPANY INSTALLATIONS.

SEE PROVINCIAL REGULATION 210/72 FOR DETAILS

FOR INDEX SEE
11988

METRIC

WHOLE NUMBERS INDICATE MILLIMETRES
DECIMALIZED NUMBERS INDICATE METRES



<p>LOCATION APPROVED UNDERGROUND STRUCTURES</p> <p>SUPV. U/G STRUCTURES COMMITTEE _____ DATE _____</p> <p>NOTE: LOCATION OF UNDERGROUND STRUCTURES AS SHOWN ARE BASED ON THE BEST INFORMATION AVAILABLE BUT NO GUARANTEE IS GIVEN THAT ALL EXISTING UTILITIES ARE SHOWN OR THAT THE GIVEN LOCATIONS ARE EXACT. CONFIRMATION OF EXISTENCE AND EXACT LOCATION OF ALL SERVICES MUST BE OBTAINED FROM THE INDIVIDUAL UTILITIES BEFORE PROCEEDING WITH CONSTRUCTION.</p>	<table border="1" style="width: 100%; border-collapse: collapse;"> <tr><td style="text-align: center;">B.M. ELEV.</td><td></td><td></td><td></td></tr> <tr><td></td><td></td><td></td><td></td></tr> <tr><td></td><td></td><td></td><td></td></tr> <tr><td></td><td></td><td></td><td></td></tr> <tr><td></td><td></td><td></td><td></td></tr> <tr><td></td><td></td><td></td><td></td></tr> <tr><td></td><td></td><td></td><td></td></tr> <tr><td></td><td></td><td></td><td></td></tr> </table>	B.M. ELEV.																																<table border="1" style="width: 100%; border-collapse: collapse;"> <tr><td>DESIGNED BY</td><td>SC</td><td>CHECKED BY</td><td>SC</td></tr> <tr><td>DRAWN BY</td><td>AJ</td><td>APPROVED BY</td><td>KZ</td></tr> <tr><td>SCALE:</td><td></td><td>RELEASED FOR CONSTRUCTION</td><td></td></tr> <tr><td>HORIZONTAL</td><td>1:750</td><td></td><td></td></tr> <tr><td>VERTICAL</td><td></td><td></td><td></td></tr> <tr><td>DATE</td><td>2019 01 24</td><td>DATE</td><td>2019-01-23</td></tr> </table>	DESIGNED BY	SC	CHECKED BY	SC	DRAWN BY	AJ	APPROVED BY	KZ	SCALE:		RELEASED FOR CONSTRUCTION		HORIZONTAL	1:750			VERTICAL				DATE	2019 01 24	DATE	2019-01-23	<p>ENGINEER'S SEAL</p> <p>ORIGINAL SIGNED BY S.R.J. COURNOYER 19/01/22</p> <p>CONSULTANT DRAWING NUMBER -</p>	<p>THE CITY OF WINNIPEG WATER AND WASTE DEPARTMENT ENGINEERING DIVISION</p> <p>2018 SEWER MAIN RENEWALS BY AUGMENTATION KILBRIDE AVENUE 1ST MH W OF SALTER STREET TO MH AT POWERS STREET</p>	<p>SHEET 32 OF 52</p> <p>CITY DRAWING NUMBER 12017</p>
B.M. ELEV.																																																													
DESIGNED BY	SC	CHECKED BY	SC																																																										
DRAWN BY	AJ	APPROVED BY	KZ																																																										
SCALE:		RELEASED FOR CONSTRUCTION																																																											
HORIZONTAL	1:750																																																												
VERTICAL																																																													
DATE	2019 01 24	DATE	2019-01-23																																																										