

**FIELD NOTE:**  
 - ALL BOLTS AT ROOF LEVEL ONLY SHOWN ON THIS DRAWING ARE SNUG TIGHT.  
 - ALL BOLTS c/w LOCK WASHER.

- FOR VIEW 'B-B' DETAILS SEE DWG 'E02.2'  
 - READ THIS DWG IN CONJUNCTION WITH 'E02.2'

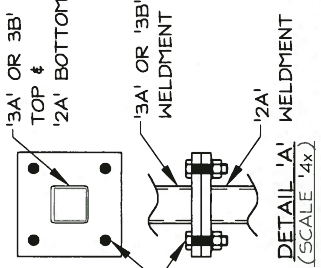
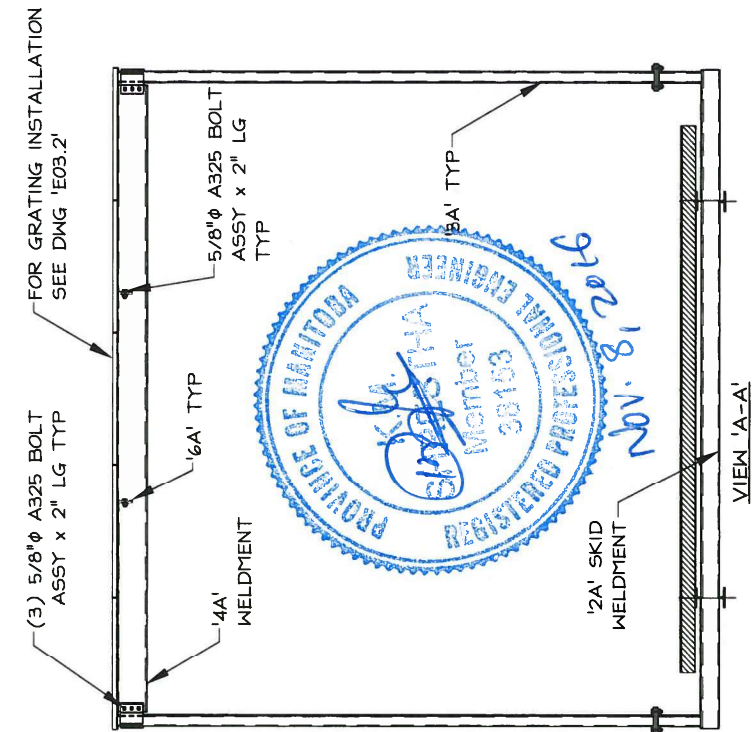
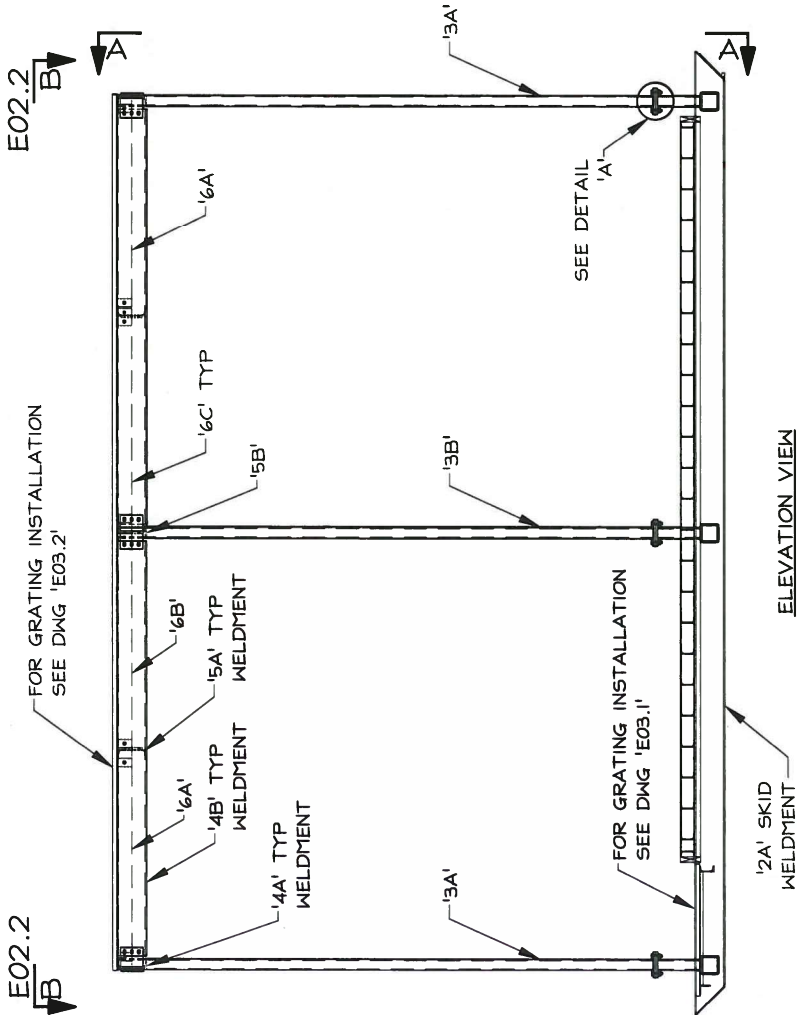

**FIELD BOLTS:**  
 (70) 5/8"  $\phi$  A325 BOLT ASSY x 2" LG c/w LOCK WASHER  
 (24) 5/8"  $\phi$  A325 BOLT ASSY x 2-3/4" LG c/w LOCK WASHER

**NOTE:**  
 - STRUCTURAL DESIGN OF PROPOSED SHELTER BUILDING AND FOUNDATIONS SATISFIES THE MANITOBA BUILDING CODE 2011.

A	DRAWING UPDATE	04/11/16	JSG
ISSUE	DESCRIPTION	DATE	BY
TITLE: SKID LAYOUT			
<b>WESTOWER</b>			
CUSTOMER: CITY OF WINNIPEG			
PROJECT: 13' x 17' SHELTER			
SITE: 2230 MAIN STREET, WINNIPEG, MB			
DWN BY/APP'R'D:	DATE:	PROJECT No.:	DRAWING No.:
JSG	18/08/16	22-00233B	-E02.1