

DETECTION CONNECTION DETAILS				
SENSOR NO.	POLE NO.	DETECTION LOCATION	DETECTOR LOCATION	TRANSPARITY DETECTOR NO.
MATRIX 1	4	SB LANE		
MATRIX 2	8	NB LANE		

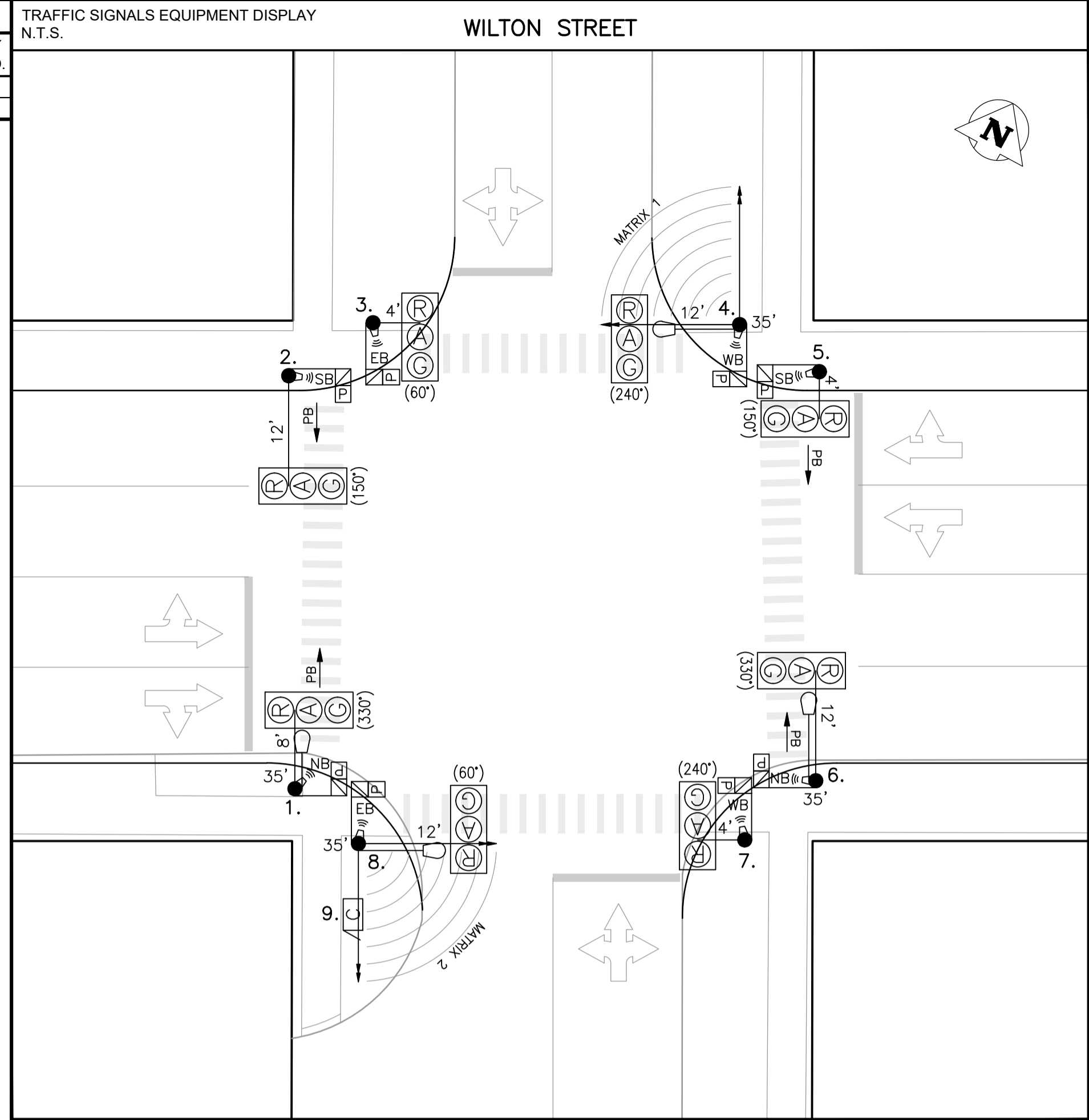

CONSTRUCTION NOTES:

- PROJECT SCOPE**
1. INSTALL CONDUIT, BASES AND PITS AS SHOWN. TOTAL LENGTH OF SERVICE CABLE: 35m.
 2. INSTALL EQUIPMENT AS SHOWN.
 3. TIMINGS REQUIRED.

- PROJECT COORDINATION**
1. COORDINATE WORK WITH SCOTT SUDERMAN, (204) 489-5900, scott.suderman@stantec.com.

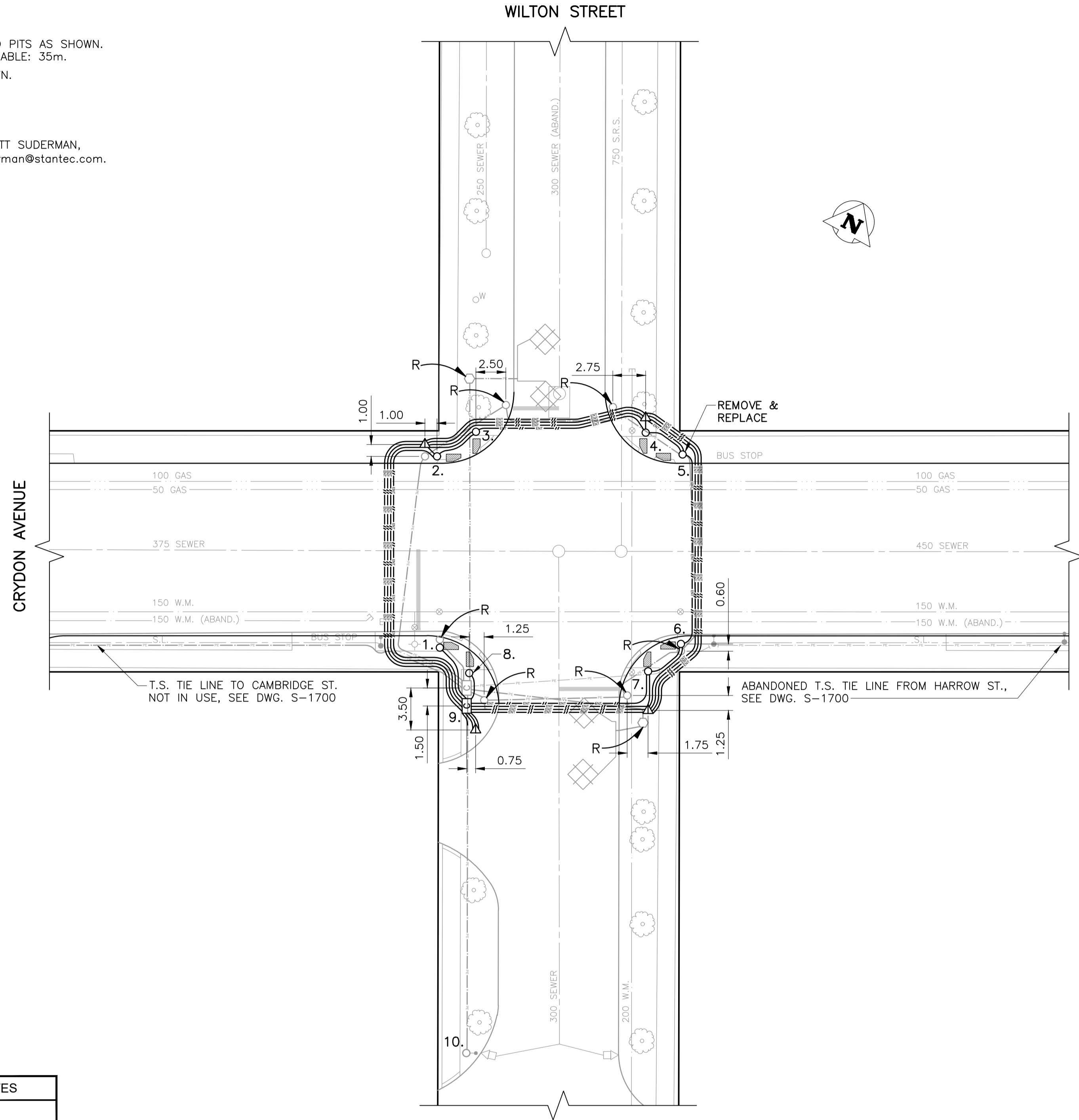

PLAN VIEW: UNDERGROUND CONSTRUCTION
1:250

EQUIPMENT DISPLAY LEGEND

	EXISTING		PROPOSED (AS SHOWN BELOW)		TRAFFIC SIGNAL HEAD		12' LOW ARM (SHOWN FROM CENTRE)
					TRAFFIC SIGNAL POLE		RED FLASHER
					PUSH BUTTON & DIRECTION		LUMINAIRE
					APS DUAL DIRECTION (2 SEPARATE SPEAKERS)		AMBER FLASHER (CIRCUIT 'X' OR 'Y')
					CAMERA		

NO.	EQUIPMENT LIST	ARM	BASE	B.B.	NO.	EQUIPMENT LIST	ARM	BASE	B.B.
1.	35' SIGNAL FOR LUMINAIRE	8'	G	GD					
2.	CANTILEVER	12'	OD	DC					
3.	CANTILEVER	4'	OD	DC					
4.	35' SIGNAL FOR LUMINAIRE	12'	OD	DD					
5.	CANTILEVER	4'	OD	DC					
6.	35' SIGNAL FOR LUMINAIRE	12'	OD	DD					
7.	CANTILEVER	4'	OD	DC					
8.	35' SIGNAL FOR LUMINAIRE	12'	OD	DD					
9.	332 CABINET/2070 CONTROLLER								
10.	HYDRO WOOD SERVICE								

TRAFFIC SIGNALS UNDERGROUND LEGEND

	EXISTING		PROPOSED (AS SHOWN BELOW)		POLE BASE		CONTROLLER BASE
	EXISTING				PEDESTAL BASE		TERMINAL BASE
	EXISTING				SERVICE BOX (PIT)		24\" PRECAST PIT
					30\" PRECAST PIT		36\" PRECAST PIT
					REMOVAL		

SIGNAL BASE BOLT SQUARE TYPES

	TYPE "A" - 8 1/8"		TYPE "B" - 6 3/4"
	TYPE "C" - 8 1/8" SCREW TYPE		TYPE "D" - 12 3/4", 1 1/4" DIA. BOLTS, 24" DIA.
	TYPE "E" - 12 3/4", 1 1/4" DIA. BOLTS, 28" DIA.		TYPE "F" - 12 3/4", PRECAST, 1 1/4" DIA. BOLTS
	TYPE "G" - 9 9/16" SCREW TYPE		TYPE "H" - 9 9/16" SCREW TYPE
	TYPE "I" - 9 9/16"		TYPE "J" - 7 3/4"
	TYPE "K" - 8 1/8", 1 1/4" DIA. BOLTS, 89mm PROJ.		TYPE "L" - 10 5/8", 1 1/4" DIA. BOLTS
	TYPE "M" - 8 1/8", 1 1/4" DIA. BOLTS, 76mm PROJ.		TYPE "N" - 6", 5/8" DIA. BOLTS
	TYPE "O" - 8 1/8", 1 1/4" DIA. BOLTS, 89mm PROJ.		TYPE "P" - 6", 5/8" DIA. BOLTS
	TYPE "Q" - 8 1/8", 1 1/4" DIA. BOLTS, 76mm PROJ.		TYPE "R" - 8 1/8", PRECAST, 5/8" DIA. BOLTS

INTERNAL REVIEW NOTES

OPERATIONS:

DATE: _____ INITIALS: _____

TIMINGS:

NEW TIMINGS REQUIRED? DATE: _____ INITIALS: _____

EXISTING	LEGEND	PROPOSED	EXISTING	LEGEND	PROPOSED	EXISTING	LEGEND	PROPOSED
	WATERMAIN			PROPERTY LINE			TELEPHONE	
	HYDRANT			ROADWAY			TELEPHONE	
	VALVE			SIDEWALK			TELEPHONE	
	SEWER			CURB & CURB RAMP			TELEPHONE	
	MANHOLE			WARNING TILE			TELEPHONE	
	CATCH BASIN			SLOPE			TELEPHONE	
	CURB INLET			CULVERT			TELEPHONE	
	HYDRO			BUILDING			TELEPHONE	
	GAS			TREE			TELEPHONE	

UNDERGROUND STRUCTURES

UNDERGROUND STRUCTURES ID: _____ DATE: (YYYYMMDD)

WATER & WASTE REVIEW ID: _____

NOTE: LOCATIONS OF UNDERGROUND STRUCTURES AS SHOWN ARE BASED ON THE BEST INFORMATION AVAILABLE. BUT NO GUARANTEE IS GIVEN THAT ALL EXISTING UTILITIES ARE SHOWN OR THAT THE GIVEN LOCATIONS ARE EXACT. CONFIRMATION OF EXISTENCE AND EXACT LOCATION OF ALL SERVICES MUST BE OBTAINED FROM THE INDIVIDUAL UTILITIES BEFORE PROCEEDING WITH CONSTRUCTION.

CONSTRUCTION REVISIONS

NO.	REVISION	DATE (YYYYMMDD)	BY
A	ISSUED FOR INTERNAL REVIEW		

ACCOUNTS:

DESIGNED BY: J.S.

DRAWN BY: J.S.

CHECKED BY:

APPROVED BY:

LIABILITY DISCLAIMER NOTICE: THE DIGITAL INFORMATION PROVIDED FOR YOUR CONVENIENCE HEREIN IS FOR USE AT YOUR OWN RISK. THE CITY OF WINNIPEG, PUBLIC WORKS DEPARTMENT, SHALL ASSUME NO RESPONSIBILITY FOR THE INFORMATION AND IT SHOULD NOT BE CONSTRUED AS ASSULT INFORMATION. THE INFORMATION SHOULD BE USED FOR PLANNING PURPOSES ONLY AND SHOULD BE VERIFIED BY SURVEY. THE DEPARTMENT SHALL NOT IN ANY WAY SUPPORT ANY LIABILITY WHATSOEVER TO ANY PARTY FOR INJURY, LOSS OR DAMAGES SUFFERED BY SUCH PARTY ARISING FROM THEIR USE OF, OR RELIANCE UPON, THIS INFORMATION.

ENGINEER'S SEAL

PRELIMINARY

NOT FOR CONSTRUCTION

THE CITY OF WINNIPEG

Winnipeg

PUBLIC WORKS DEPARTMENT

TRANSPORTATION DIVISION

TRAFFIC SIGNALS

CORYDON AVE. & WILTON ST.

UNITS: ALL DIMENSIONS ARE IN METERS UNLESS OTHERWISE NOTED

DRAWING NUMBER: S-1641