

CHAINAGE ALONG CENTERLINE

SEE DWG No's 18, 19 & 20 FOR CONTINUATION OF DAWSON ROAD SOUTH MULTI-USE PATH

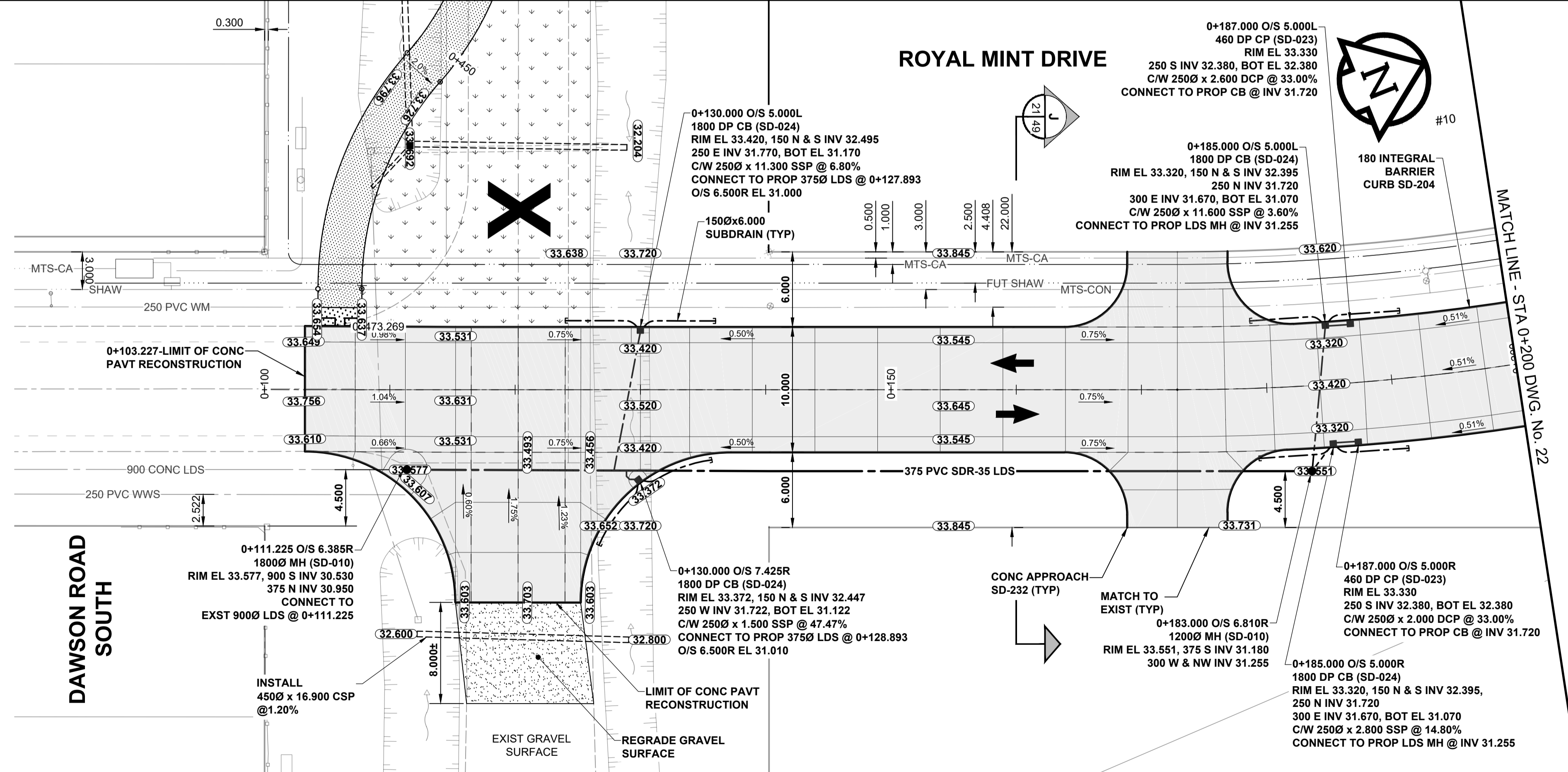

ROYAL MINT DRIVE

- NOTES
- ADJUST MH'S, CB RIMS, WV'S AND HYD'S TO NEW GRADES.
  - MODIFIED BARRIER CURB TO BE CONSTRUCTED AT ALL INTERSECTION RADI, BACK LANE RADI AND BULLNOSES.
  - CONTRACTOR TO CONFIRM THE LOCATION OF ALL UTILITIES/SERVICES IN THE FIELD PRIOR TO CONSTRUCTION.
  - ADD 200.000m TO ABBREVIATED ELEVATIONS TO OBTAIN GEODETIC ELEVATIONS.
  - CB SD-024 OFFSETS ARE DIMENSIONED TO BOC. CB SD-025 OFFSETS ARE DIMENSIONED O/C.
  - ALL DIMENSIONS TO BACK OF CURB AND THEORETICAL BACK OF CURB.
  - ALL WORK AND MATERIALS TO BE IN ACCORDANCE WITH LATEST REVISION OF THE CITY OF WINNIPEG STANDARD CONSTRUCTION SPECIFICATIONS.
  - ALL BOULEVARDS TO BE SEEDED UNLESS NOTED OTHERWISE. LIMITS TO BE IDENTIFIED IN THE FIELD BY THE CONTRACT ADMINISTRATOR.
  - INSTALL 6.000m OF 150mm SUBDRAIN TO CATCH BASINS IN BOTH DIRECTIONS PARALLEL TO ROADWAY AS PER SD-045 AND CAP ENDS.
  - CB LEADS TO BE INSTALLED AT MIN 1.0% SLOPE OR AS DIRECTED BY THE CONTRACT ADMINISTRATOR.
  - ISOLATE MISCELLANEOUS ITEMS IN NEW CONCRETE WORKS AS PER SD-228C.
  - LEGAL PLAN AND UNDERGROUND INFORMATION FROM CITY OF WINNIPEG LBIS.

SECTION LEGEND

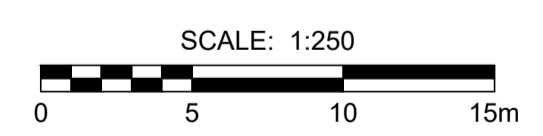

TENDER No. 8-2019

METRIC WHOLE NUMBERS INDICATE MILLIMETRES DECIMAL NUMBERS INDICATE METRES

---	GAS	○	MANHOLE	●	CONCRETE PAVEMENT	---	LOCATION APPROVED
---	MTS / PEDESTAL	□	CATCH BASIN / CATCH PIT	■	CONC SIDEWALK / MEDIAN	---	UNDERGROUND STRUCTURES
---	HYDRO / CABINET	△	CURB INLET WITH BOX	▲	ASPHALT PAVEMENT	---	DATE
---	CATV / FIBRE OPTIC	⊙	TREE	▲	ASPHALT PAVT WIDENING	---	DATE
---	TRAFFIC SIGNALS / PIT	⊕	TEST HOLE	▲	PAVING STONE	---	DATE
---	LAND DRAINAGE SEWER	⊕	PROPERTY LINE	▲	GRAVEL	---	DATE
---	SANITARY/COMBINED SEWER	⊕	SURVEY BAR	▲	RAMP CURB	---	DATE
---	CB LEAD / SSP / DCP	⊕	FENCE	▲	PLANING / REMOVAL	---	DATE
---	WATER MAIN	⊕	BOC / EDGE OF PAVEMENT	▲		---	DATE
---	SUBDRAIN	⊕	ELEVATION	▲		---	DATE
---	DITCH	⊕	TRAFFIC SIGN	▲		---	DATE
---	EXISTING	---	LEGEND - PLAN	---	EXISTING	---	LEGEND - PLAN
---	NEW	---	EXISTING	---	NEW	---	LEGEND - PLAN

LOCATION APPROVED UNDERGROUND STRUCTURES

DATE

NOTE: LOCATION OF UNDERGROUND STRUCTURES AS SHOWN ARE BASED ON THE BEST INFORMATION AVAILABLE BUT NO GUARANTEE IS GIVEN THAT ALL EXISTING UTILITIES ARE SHOWN OR THAT THE GIVEN LOCATIONS ARE EXACT. CONFIRMATION OF EXISTENCE AND EXACT LOCATION OF ALL SERVICES MUST BE OBTAINED FROM THE INDIVIDUAL UTILITIES BEFORE PROCEEDING WITH CONSTRUCTION.

GBM - 55-015	ELEV - 233.170
DESIGNED BY	JGK
CHECKED BY	RPB
DRAWN BY	DID
APPROVED BY	BWB
RELEASED FOR CONSTRUCTION	N/A
DATE	19/03/22

MORRISON HERSHFIELD

DESIGNED BY: JGK

CHECKED BY: RPB

DRAWN BY: DID

APPROVED BY: BWB

RELEASED FOR CONSTRUCTION: N/A

DATE: 19/03/22

PROFESSIONAL'S SEAL

PROVINCE OF MANITOBA

J.G. KENNEDY

Member 22326

REGISTERED PROFESSIONAL ENGINEER

CONSULTANT FILE NAME: 1804191-21-Fermor-PP-21.dwg

THE CITY OF WINNIPEG

PUBLIC WORKS DEPARTMENT

ENGINEERING DIVISION

2019/2020 REGIONAL STREET RENEWAL PROGRAM

FERMOR AVENUE

FROM LAGIMODIERE BOULEVARD TO PLESSIS ROAD (CITY BOUNDARY)

PLAN AND PROFILES

ROYAL MINT DRIVE

DAWSON ROAD SOUTH TO STA 0+200

CITY DRAWING NUMBER: P-3501-21

SHEET 21 OF 63

DRAWING No. 21