

Apr. 01, 2020 - 10:02am
 P:\2019\19M-01795-00 - 2020 Local Street and Asphalt Alley 20-R-05 and 20-LI-01.05 2020 Local Streets\10 Drawings\03 Working Drawings\19M-01795-00 Oakridge Bay Plan&Profile.dwg - fab:108-2020_Drawing_19M-01795-00-15-RC

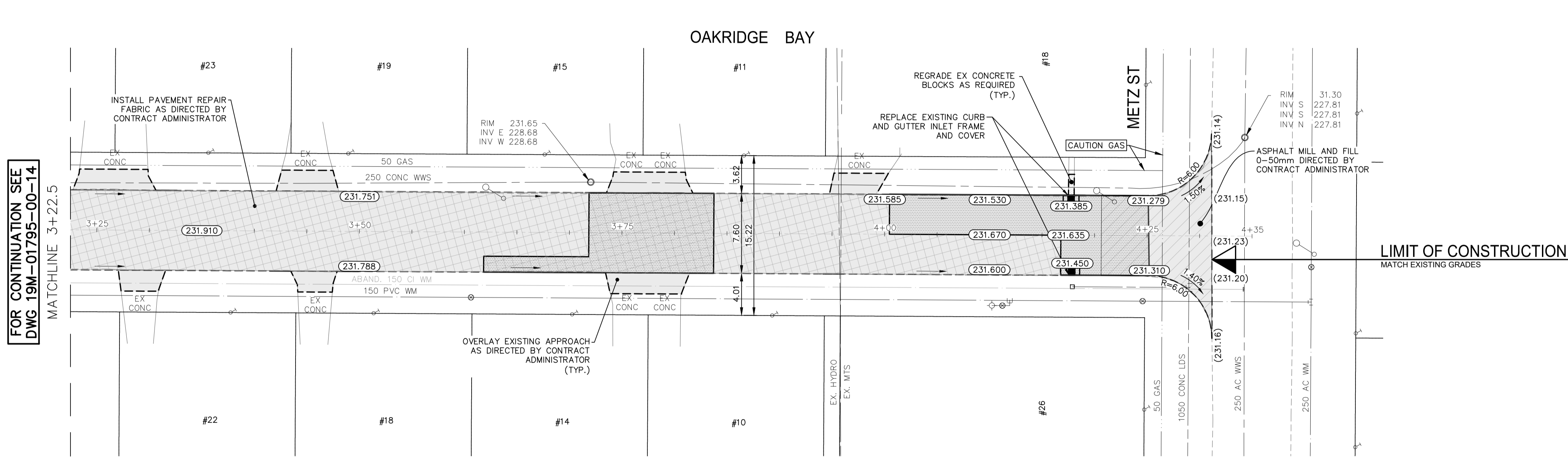

- NOTES:**
1. ALL WORK AND MATERIALS TO BE IN ACCORDANCE WITH THE LATEST REVISION OF THE CITY OF WINNIPEG STANDARD CONSTRUCTION SPECIFICATIONS.
 2. CONTRACTOR TO CONFIRM THE LOCATION OF ALL UTILITIES/SERVICES IN THE FIELD PRIOR TO CONSTRUCTION.
 3. ALL ROADWAY DIMENSIONS SHOWN ARE TO BACK OF CURB.
 4. RENEW CURB AND SIDEWALK AS IDENTIFIED BY CONTRACT ADMINISTRATOR.
 5. ALL PRIVATE WALKWAYS TO BE ADJUSTED TO NEW SIDEWALK OR TOP OF CURB ELEVATION, AS REQUIRED.
 6. ADJUST MH FRAMES, CB RIMS, AND VALVES TO NEW GRADES, AS REQUIRED.
 7. MODIFIED BARRIER CURB TO BE CONSTRUCTED AT ALL INTERSECTION RADII AND BACK LANE RADII.
 8. INSTALL 40mm LIP CURB THROUGH ALL RESIDENTIAL APPROACHES.
 9. LAMP STANDARDS, HYDRO POLES, AND ANCHORS THAT REQUIRE TEMPORARY SUPPORT, REMOVAL OR REPLACEMENT, TO BE DONE SO AT THE EXPENSE OF THE CONTRACTOR AS NECESSARY.
 10. CONTRACTORS TO TAKE PRECAUTIONARY STEPS TO PROTECT EXISTING TREES WITHIN THE LIMITS OF CONSTRUCTION FROM DAMAGE FROM CONSTRUCTION ACTIVITIES AS OUTLINED IN THE SPECIFICATIONS.
 11. ALL BOULEVARDS TO BE SODDED UNLESS OTHERWISE NOTED.
 12. ADJUST ALL WATER VALVES, HYDRANTS, MANHOLES, AND CATCH BASINS IN WORK AREA TO GRADE.

EXISTING	LEGEND-PLAN	PROPOSED	EXISTING	LEGEND-PLAN	PROPOSED	EXISTING	LEGEND-PROFILE	PROPOSED
---	WATER MAIN	---	⊕	IRON BAR	---	---		
---	LAND DRAINAGE SEWER	---	⊕	HYDRO POLE & LIGHT STANDARD	---	---		
---	WASTE WATER SEWER	---	⊕	LIGHT STANDARD OR TRAFFIC SIGNAL	---	---		
---	HYDRO	---	HP	HYDRO POLE	---	---		
---	BELL/MTS	---	□	CURB RAMP	---	---		
---	GAS	---	⊕	DETECTABLE WARNING SURFACE TILE	---	---		
---	SIGNALS	---	---	EDGE OF SIDEWALK	---	---		
○	MANHOLE	●	---	FENCE	---	---		
□	CATCH BASIN	■	---	PROPERTY LINE	---	---		
△	CURB INLET	▽	---	EDGE OF ASPHALT	---	---		
---	UTILITIES ADJUSTED	△ □ ○	---	EDGE OF CONCRETE	---	---		
⊔	PLUG	⊔	---	MODIFIED BARRIER CURB	---	---		
⊕	HYDRANT	⊕	---	BARRIER CURB	---	---		
⊕	VALVE	⊕	---	BARRIER CURB AND GUTTER	---	---		
⊕	CURB STOP	⊕	---	CONC SIDEWALK	---	---		
---	GROUND GRADE	---	---	CONCRETE SLAB	---	---		
(231.00)	PAVEMENT GRADE	(231.00)	---	ASPHALT	---	---		
---	ANCHOR	---	---	MILLED SURFACE	---	---		
#11	CIVIC ADDRESS	---	---	PAVEMENT REPAIR FABRIC	---	---		

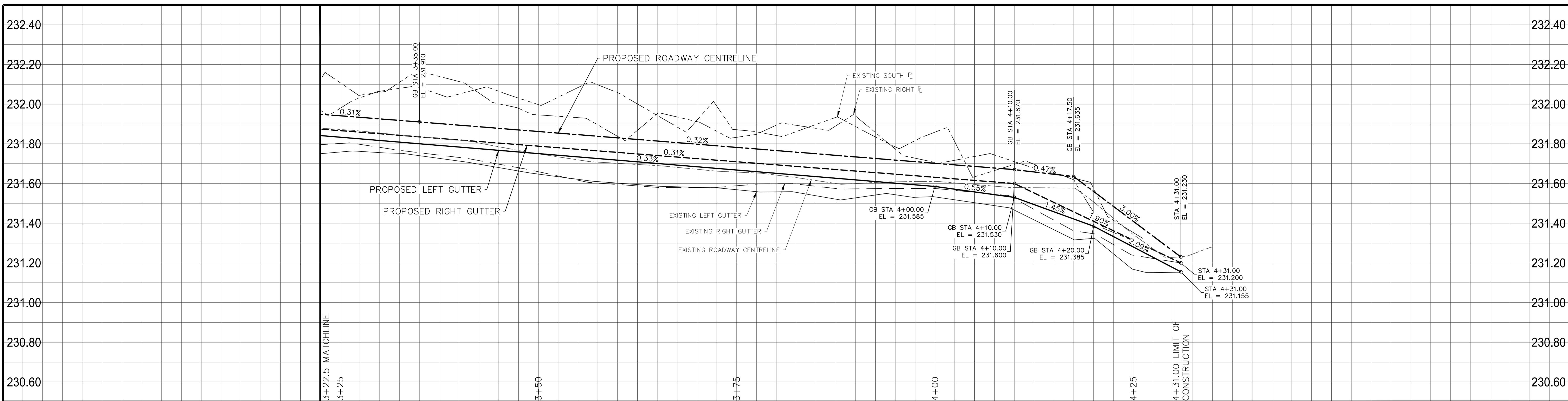
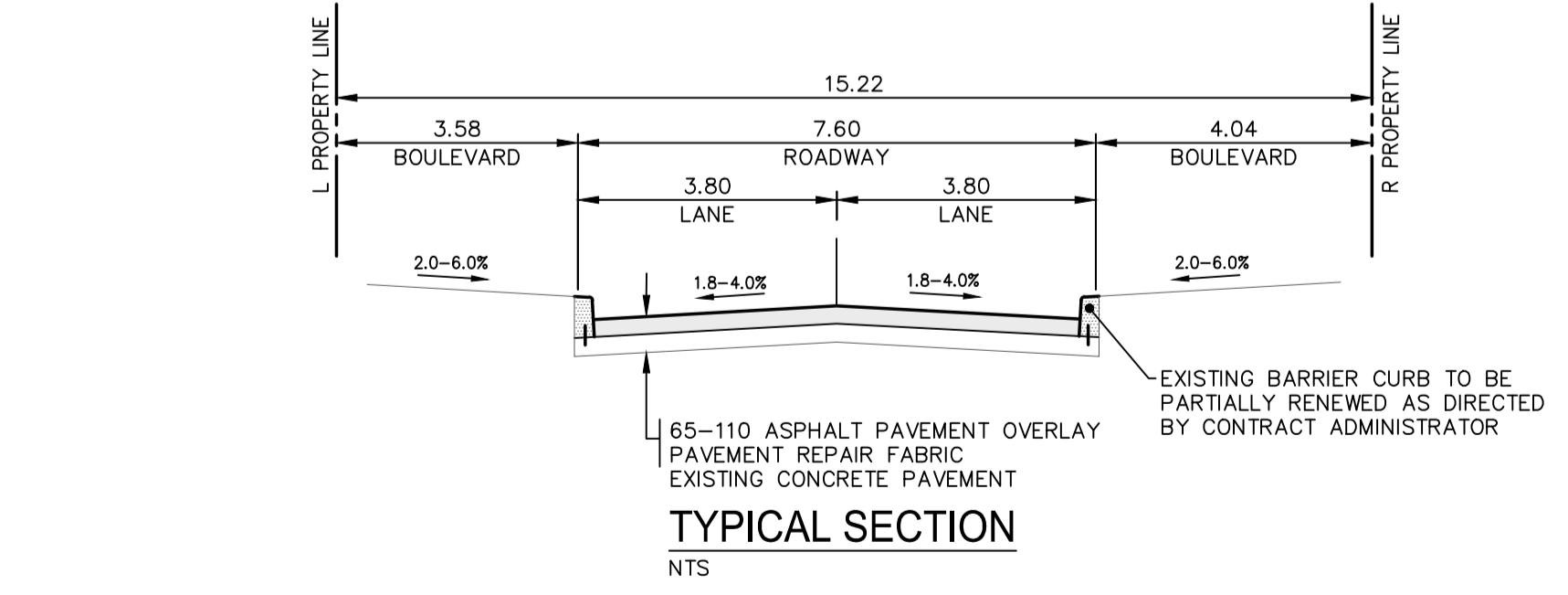

LOCATIONS APPROVED UNDERGROUND STRUCTURES

SIGNED BY: _____ DATE: _____

LOCATION OF UNDERGROUND STRUCTURES AS SHOWN ARE BASED ON THE BEST INFORMATION AVAILABLE BUT NO GUARANTEE IS GIVEN THAT ALL EXISTING UTILITIES ARE SHOWN OR THAT THE GIVEN LOCATIONS ARE EXACT CONFIRMATION OF EXISTENCE AND EXACT LOCATION OF ALL SERVICES MUST BE OBTAINED FROM THE INDIVIDUAL UTILITIES BEFORE PROCEEDING

G.B.M. 232.439	ELEV. TOP-NUT OF FIRE HYDRANT AT 42 METZ ST.		WSP Canada Group Limited Suite 111 - 93 Lombard Ave Winnipeg, MB R3B 3B1 t. 204.943.3178 f. 204.943.4948 www.wsp.com
H	-		
G	-		
F	-		
E	-		
D	-		
C	ISSUED FOR TENDER 2020/01/19 RH		
B	ISSUED FOR DETAILED DESIGN 2020/01/13 RH		
A	ISSUED FOR PRELIMINARY DESIGN REVIEW 2020/01/04 RH		
NO.	REVISIONS DATE BY		
DESIGNED BY	EL/RH	CHECKED BY	RH
DRAWN BY	RB/EL	APPROVED BY	VM
WORK SCALE	1:250	RELEASED FOR CONSTRUCTION	---
VERTICAL	1:10	DATE	JANUARY 2020

FOR TENDER PURPOSES ONLY
NOT FOR CONSTRUCTION

METRIC
WHOLE NUMBERS INDICATE MILLIMETRES
DECIMALIZED NUMBERS INDICATE METRES

ENGINEERS GEOSCIENTISTS MANITOBA
Certificate of Authorization
WSP Canada Group Limited
No. 6657

THE CITY OF WINNIPEG
PUBLIC WORKS DEPARTMENT
ENGINEERING SERVICES DIVISION

2020 LOCAL STREET PACKAGE
OAKRIDGE BAY

ASPHALT REHABILITATION
STA. 3+20 TO STA. 4+31

CITY DRAWING NUMBER: ---
SHEET: 15 OF 21
TENDER NO.: 108-2020

CONSULTANT ACAD DWG. NO.: 19M-01795-00-15