

ROBLIN BOULEVARD

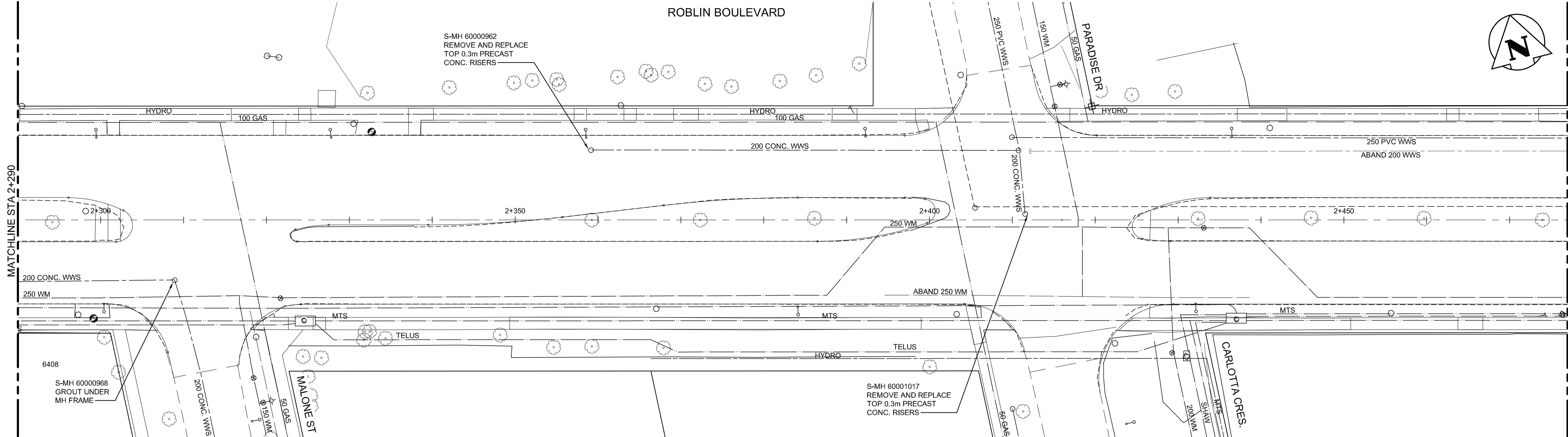

ROBLIN BOULEVARD

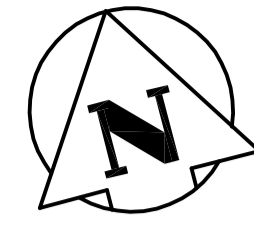
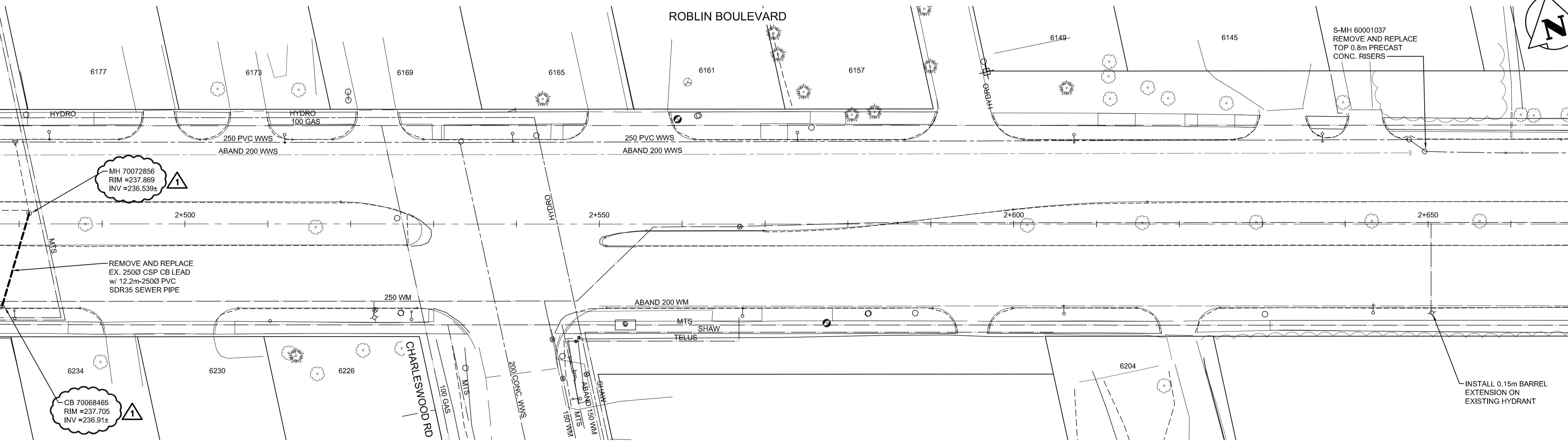

WARNING

IF POWER EQUIPMENT OR EXPLOSIVES ARE TO BE USED FOR EXCAVATION ON THIS PROJECT THE CONTRACTOR MUST:
 1) NOTIFY THE GAS COMPANY OF THE PROPOSED LOCATION OF EXCAVATION.
 2) TAKE PRECAUTION TO AVOID DAMAGE TO GAS COMPANY INSTALLATIONS.
 SEE PROVINCIAL REGULATION 140/92 FOR DETAILS.

METRIC

WHOLE NUMBERS INDICATE MILLIMETRES
 DECIMALIZED NUMBERS INDICATE METRES

NOTES:

- ADJUST ALL MANHOLE, CATCH BASIN, CATCH PIT AND GATE VALVES TO PROPOSED GRADES.
- CONTRACTOR TO CONFIRM THE LOCATION OF ALL UTILITIES / SERVICES IN THE FIELD PRIOR TO CONSTRUCTION.
- HYDRANT BARREL EXTENSIONS TO INCLUDE BARREL EXTENSION, STEM EXTENSIONS, STEM COUPLINGS, BREAK AWAY FLANGES OR KITS, RUBBER SEALS, FLANGE GASKETS AND FASTENERS REQUIRED TO RAISE EXISTING HYDRANT FLANGE ELEVATIONS.

ENGINEERS GEOSCIENTISTS MANITOBA
 Certificate of Authorization
 Stantec Consulting Ltd.
 No. 1301

WATERMAIN		M.T.S.		PROFILE	
150 WM	150 WM	GLASS GRID	XXXXXX	NORTH OR WEST GUTTER	----
HYDRANT	+	CONCRETE	=====	SOUTH OR EAST GUTTER	----
VALVE	⊕	ASPHALT	=====	NORTH MEDIAN GUTTER	----
300 LIDS	300 LIDS	SIDEWALK	=====	SOUTH MEDIAN GUTTER	----
250 WWS	250 WWS	ASPHALT MILL & FILL	=====	NORTH OR WEST P.L.	----
MANHOLE	○	STREET LIGHT	●	SOUTH OR EAST P.L.	----
CATCH BASIN	■	HYDRO POLE	●		
HYDRO	---	SURVEY BAR	+		
GAS	- - - -	ELEVATION	(32.231)		
TRANSIT STOP	(31.334)	SIDEWALK RAMP	=====		
PROPERTY LINE	---				
LEGEND-PLAN	PROPOSED	LEGEND-PLAN	PROPOSED	EXISTING	LEGEND-PROFILE

LOCATION APPROVED UNDERGROUND STRUCTURES

SUPV. U/G STRUCTURES COMMITTEE	DATE

NOTE:
 LOCATION OF UNDERGROUND STRUCTURES AS SHOWN ARE BASED ON THE BEST INFORMATION AVAILABLE BUT NO GUARANTEE IS GIVEN THAT ALL EXISTING UTILITIES ARE SHOWN OR THAT THE GIVEN LOCATIONS ARE EXACT. CONFIRMATION OF EXISTENCE AND EXACT LOCATION OF ALL SERVICES MUST BE OBTAINED FROM THE INDIVIDUAL UTILITIES BEFORE PROCEEDING WITH CONSTRUCTION.

NO.	REVISIONS	DATE	BY
1	ISSUED FOR ADDENDUM NO.1	20.04.09	R.K.H.
0	ISSUED FOR TENDER	20.04.03	R.K.H.

Stantec
 500 - 311 Portage Avenue, Winnipeg MB Canada
 www.stantec.com

DESIGNED BY	R.S.	CHECKED BY	R.S.

DRAWN BY	O.S.	APPROVED BY	R.S.

HOR. SCALE: 1:250
 VERTICAL:

NO.	REVISIONS	DATE	BY

2020/02/10

PRELIMINARY DRAWING
 NOT TO BE USED FOR CONSTRUCTION

CONSULTANT DRAWING NO.
U204

THE CITY OF WINNIPEG
 PUBLIC WORKS DEPARTMENT
 ENGINEERING DIVISION

ROBLIN BOULEVARD PAVEMENT RENEWAL

ROBLIN BOULEVARD
 STA 2+290 TO STA 2+670
 MUNICIPAL UTILITIES

SHEET	OF
36	50

CAD FILE DRAWING NUMBER
 08080u-204.dwg

CITY DRAWING NUMBER
P-3528-36