

- NOTES:**
- MILL ALL ASPHALT TO CONCRETE SURFACE.
 - THE CONTRACT ADMINISTRATOR TO MARK OUT ALL MILLING, PAVEMENT, CURB AND SIDEWALK TIE-IN LOCATIONS.
 - ALL MAINLINE CURBING TO BE RENEWED AS BARRIER CURB OR MONOLITHIC CONCRETE SPLASH STRIP (AS IDENTIFIED ON PLAN). CURB REVEAL TO BE 125mm UNLESS OTHERWISE NOTED.
 - ADJUST ALL WATER VALVES, MANHOLES, AND CATCH BASINS TO GRADE.
 - ADJUST ALL WATER SERVICE VALVES TO GRADE. EXISTING SERVICE VALVES ARE NOT SHOWN BUT ARE WITHIN THE SIDEWALK RENEWAL AREA.
 - THE CONTRACTOR IS RESPONSIBLE FOR ALL UTILITY LOCATES.
 - THE CONTRACTOR IS TO PROTECT ANY GEOMATIC MONUMENTS WITHIN THE PROJECT LIMITS. IF MONUMENTS CANNOT BE AVOIDED, THE CONTRACTOR IS RESPONSIBLE FOR NOTIFYING THE CITY OF WINNIPEG GEOMATICS AND LAND INFORMATION SERVICES BRANCH PRIOR TO ANY REMOVAL OR ADJUSTMENT TO THE PROPERTY BAR.
 - MATCH EXISTING RADII ON PRIVATE APPROACHES.
 - SIDEWALK WITH SEPARATE SPLASH STRIP AS SHOWN OR WHERE MINIMUM GRASSED BOULEVARD IS GREATER THAN 1.0m WIDE.
 - SIDEWALK COMPLETE WITH PAVING BANDS AS SHOWN OR WHERE BOULEVARD IS LESS THAN 1.0m WIDE.
 - AVERAGE ASPHALT THICKNESS TO BE 80mm.
 - GRADE BREAKS WITHIN PRIVATE APPROACHES TO BE DIRECTED BY THE CONTRACT ADMINISTRATOR TO ACCOMPLISH 2.4% ACROSS THE SIDEWALK.
 - PRIVATE APPROACH CONSTRUCTION TO BE 200mm EXPOSED REINFORCED CONCRETE WITH 75mm BASE COURSE, 225mm-50mm SUB-BASE AND NON-WOVEN GEOTEXTILE.
 - RENEW PRIVATE APPROACHES TO MATCH EXISTING SURFACE.

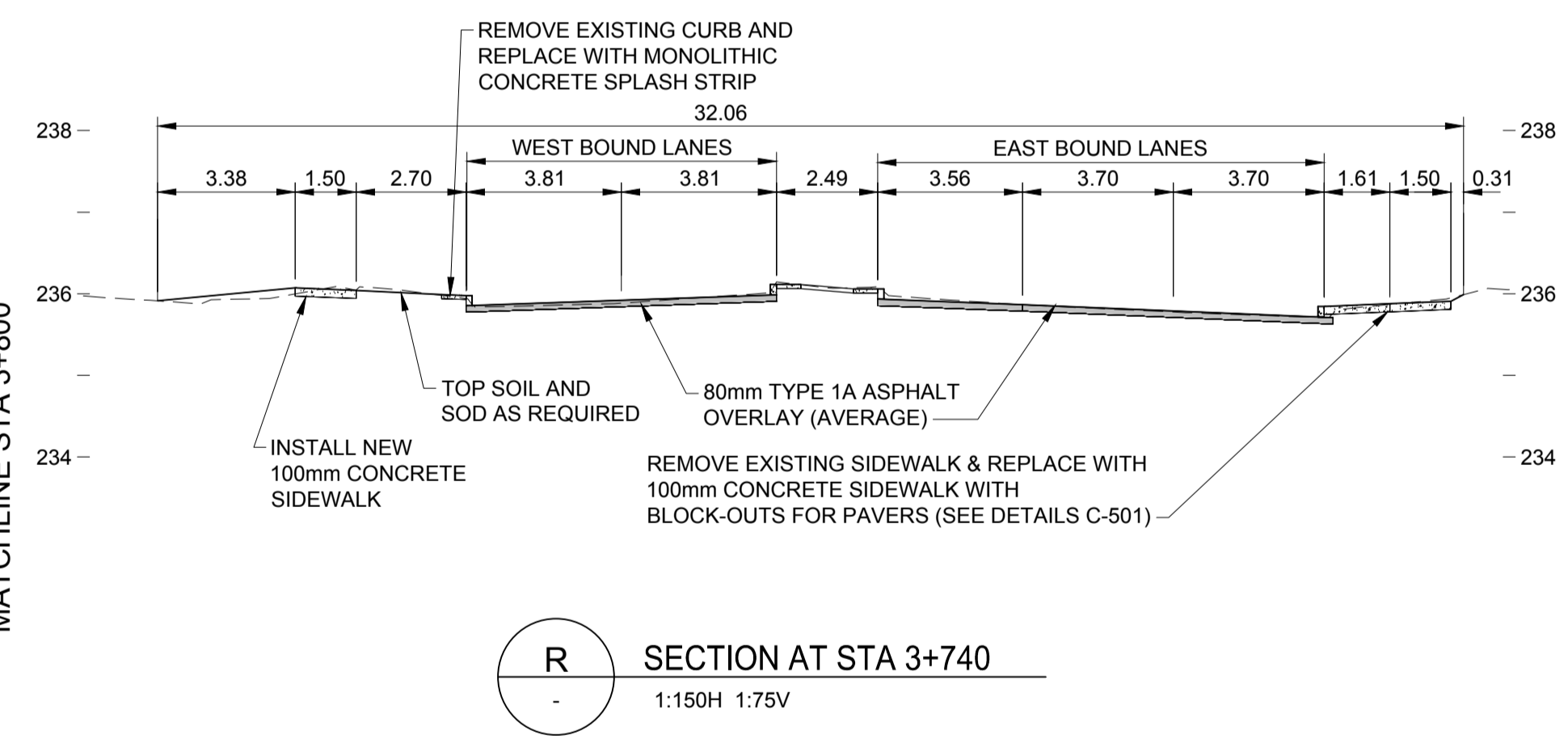
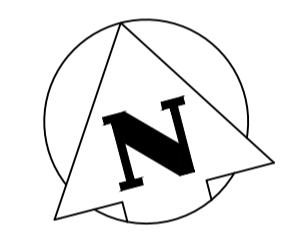
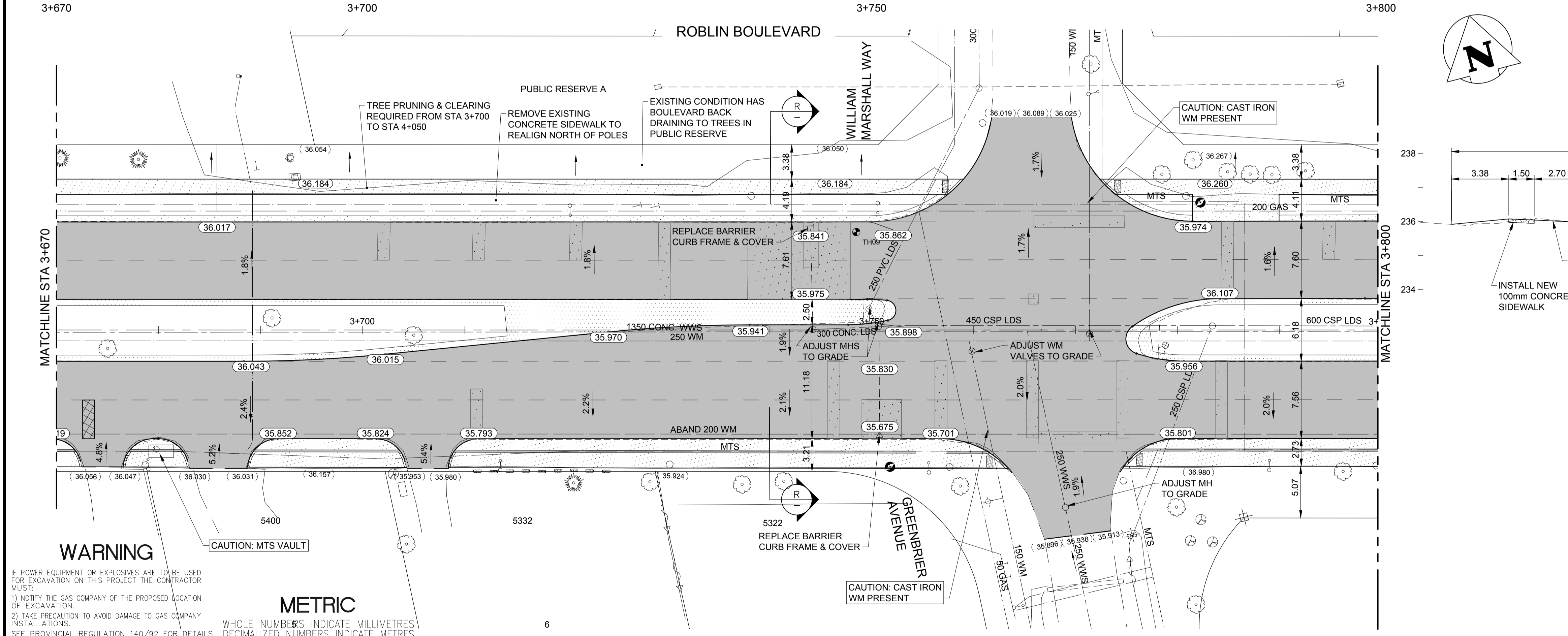

WARNING

IF POWER EQUIPMENT OR EXPLOSIVES ARE TO BE USED FOR EXCAVATION ON THIS PROJECT THE CONTRACTOR MUST:

- NOTIFY THE GAS COMPANY OF THE PROPOSED LOCATION OF EXCAVATION.
- TAKE PRECAUTION TO AVOID DAMAGE TO GAS COMPANY INSTALLATIONS.

SEE PROVINCIAL REGULATION 140/92 FOR DETAILS

METRIC

WHOLE NUMBERS INDICATE MILLIMETRES
DECIMALIZED NUMBERS INDICATE METRES

EXISTING	LEGEND-PLAN	PROPOSED	EXISTING	LEGEND-PLAN	PROPOSED	EXISTING	LEGEND-PROFILE	PROPOSED
150 WM	WATERMAIN	150 WM	M.T.S.	GLAS GRID	---	---	---	---
300 LDS	LAND DRAINAGE SEWER	300 LDS	---	CONCRETE	---	---	---	---
250 WWS	WASTE WATER SEWER	250 WWS	---	ASPHALT	---	---	---	---
MANHOLE	MANHOLE	MANHOLE	---	SIDEWALK	---	---	---	---
CATCH BASIN	CATCH BASIN	CATCH BASIN	---	ASPHALT MILL & FILL	---	---	---	---
HYDRO	HYDRO	HYDRO	---	STREET LIGHT	---	---	---	---
GAS	GAS	GAS	---	HYDRO POLE	---	---	---	---
TRANSIT STOP	TRANSIT STOP	TRANSIT STOP	---	SURVEY BAR	---	---	---	---
PROPERTY LINE	PROPERTY LINE	PROPERTY LINE	---	ELEVATION	---	---	---	---
---	---	---	---	SIDEWALK RAMP	---	---	---	---

LOCATION APPROVED UNDERGROUND STRUCTURES

SUPV. U/G STRUCTURES COMMITTEE DATE

NOTE:
LOCATION OF UNDERGROUND STRUCTURES AS SHOWN ARE BASED ON THE BEST INFORMATION AVAILABLE BUT NO GUARANTEE IS GIVEN THAT ALL EXISTING UTILITIES ARE SHOWN OR THAT THE GIVEN LOCATIONS ARE EXACT. CONFIRMATION OF EXISTENCE AND EXACT LOCATION OF ALL SERVICES MUST BE OBTAINED FROM THE INDIVIDUAL UTILITIES BEFORE PROCEEDING WITH CONSTRUCTION.

B.M. ELEV.	NO.	REVISIONS	DATE	BY
	0	ISSUED FOR TENDER	20.04.03	R.K.H.

Stantec
500 - 311 Portage Avenue, Winnipeg MB Canada
www.stantec.com

DESIGNED BY: J.D., T.G. CHECKED BY: S.R.S.
DRAWN BY: V.K. APPROVED BY: R.K.H.

HOR. SCALE: 1:250
VERTICAL: 1:10

RELEASED FOR CONSTRUCTION: 2019/11/05

ENGINEER'S SEAL

PRELIMINARY DRAWING

NOT TO BE USED FOR CONSTRUCTION

CONSULTANT DRAWING NO. C-219

THE CITY OF WINNIPEG
PUBLIC WORKS DEPARTMENT
ENGINEERING DIVISION

ROBLIN BOULEVARD PAVEMENT RENEWAL

ROBLIN BOULEVARD
STA 3+670 TO STA 3+800
ROADWORKS - RENEWAL

SHEET 26 OF 50
CAD FILE DRAWING NUMBER 08080c-219-xxx.dwg
CITY DRAWING NUMBER P-3528-26