

SEWER JUNCTION INFORMATION FROM SEWER VIDEO INSPECTION		
SEWER ID S-MA20005123		
DISTANCE FROM MH20004675		
DISTANCE	DIAMETER	CLOCK
2.1	150	12
2.8	150	10

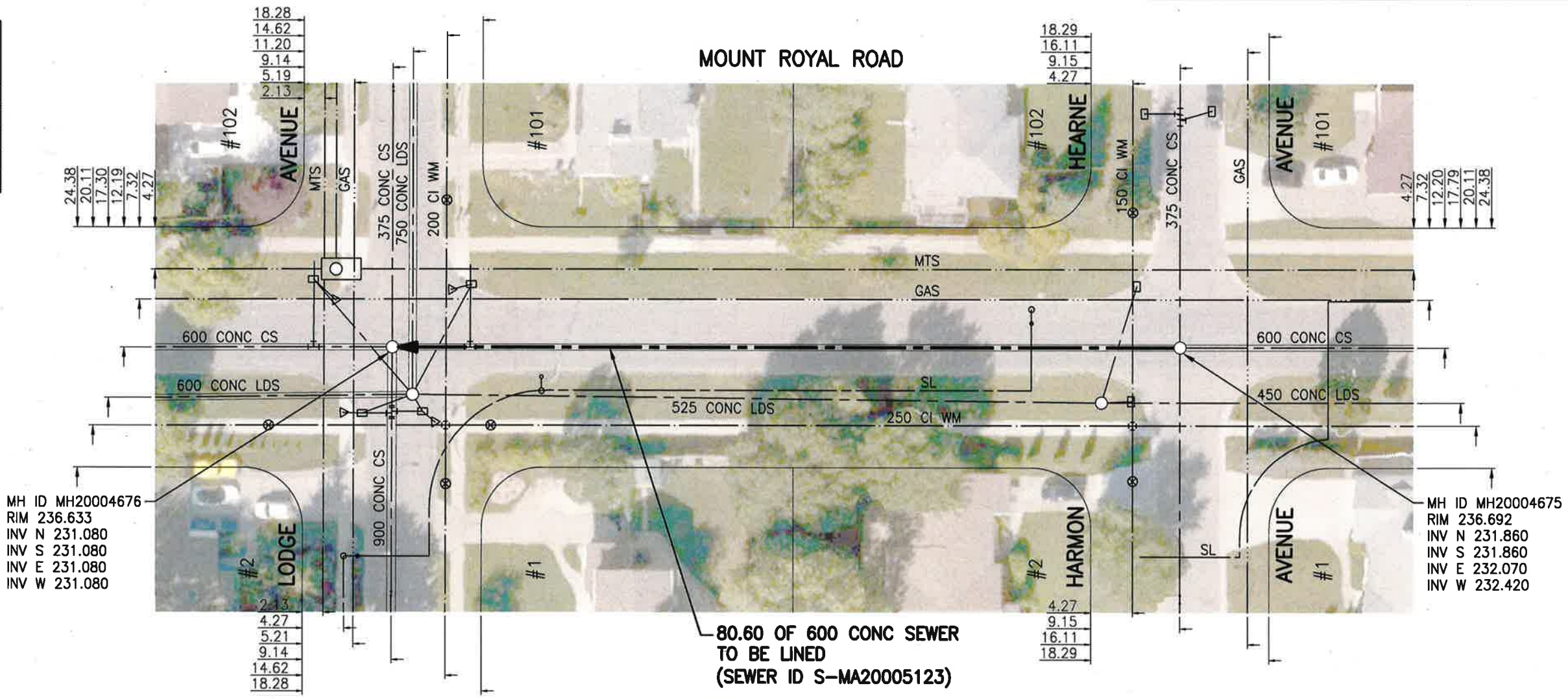

MH ID MH20004676
RIM 236.633
INV N 231.080
INV S 231.080
INV E 231.080
INV W 231.080

MH ID MH20004675
RIM 236.692
INV N 231.860
INV S 231.860
INV E 232.070
INV W 232.420

WARNING

IF POWER EQUIPMENT OR EXPLOSIVES ARE TO BE USED FOR EXCAVATION ON THIS PROJECT THE CONTRACTOR MUST:

- 1) NOTIFY THE GAS COMPANY OF THE PROPOSED LOCATION OF EXCAVATION.
 - 2) TAKE PRECAUTION TO AVOID DAMAGE TO GAS COMPANY INSTALLATIONS.
- SEE PROVINCIAL REGULATION 140/92 FOR DETAILS

ENGINEERS GEOSCIENTISTS MANITOBA
Certificate of Authorization
Stantec Consulting Ltd.
No. 1301

METRIC
WHOLE NUMBERS INDICATE MILLIMETRES
DECIMALIZED NUMBERS INDICATE METRES

1:500

TENDER NO. 116-2020

LOCATION APPROVED UNDERGROUND STRUCTURES

SUPV. U/G STRUCTURES COMMITTEE	DATE

NOTE:
LOCATION OF UNDERGROUND STRUCTURES AS SHOWN ARE BASED ON THE BEST INFORMATION AVAILABLE BUT NO GUARANTEE IS GIVEN THAT ALL EXISTING UTILITIES ARE SHOWN OR THAT THE GIVEN LOCATIONS ARE EXACT. CONFIRMATION OF EXISTENCE AND EXACT LOCATION OF ALL SERVICES MUST BE OBTAINED FROM THE INDIVIDUAL UTILITIES BEFORE PROCEEDING WITH CONSTRUCTION.

NO.	REVISIONS	DATE	BY
2	ISSUED FOR TENDER	20.03.20	RS
1	ISSUED FOR REVIEW	20.03.09	RS

Stantec
905 Waverley Street, Winnipeg, Manitoba
Tel 204-489-5900 Fax 204-453-9012

DESIGNED BY	RS	CHECKED BY	RS
DRAWN BY	SC	APPROVED BY	RS
HOR. SCALE:	1:500	RELEASED FOR CONSTRUCTION	<i>[Signature]</i>
VERTICAL:		CONSULTANT DRAWING NO.	C-102

ENGINEER'S SEAL
PROVINCE OF MANITOBA
REGISTERED PROFESSIONAL ENGINEER
R.M. SHERLOCK
MEMBER 24045

THE CITY OF WINNIPEG
WATER AND WASTE DEPARTMENT

2019 SEWER RENEWALS BY CIPP LINING
CONTRACT 4
MOUNT ROYAL ROAD
MH AT HEARNE AVE TO
MH AT LODGE AVE

SHEET	OF
04	12
CAD FILE DRAWING NUMBER 18930c-101-934.dwg	
CITY DRAWING NUMBER 12383	

V:\1112\active\111218930\0300_drawing\0302_sheet_files\02_civil\18930c-101-934.dwg