



**SEWER JUNCTION INFORMATION FROM SEWER VIDEO INSPECTION**

SEWER ID S-MA70031429

DISTANCE FROM MH20003889

DISTANCE	DIAMETER	CLOCK
2.4	150	9
3.3	150	3
3.7	150	3
18.0	150	9
19.0	150	3
20.8	150	9
21.7	150	3
35.4	150	9
36.3	150	3
50.1	150	9
21.3	150	3

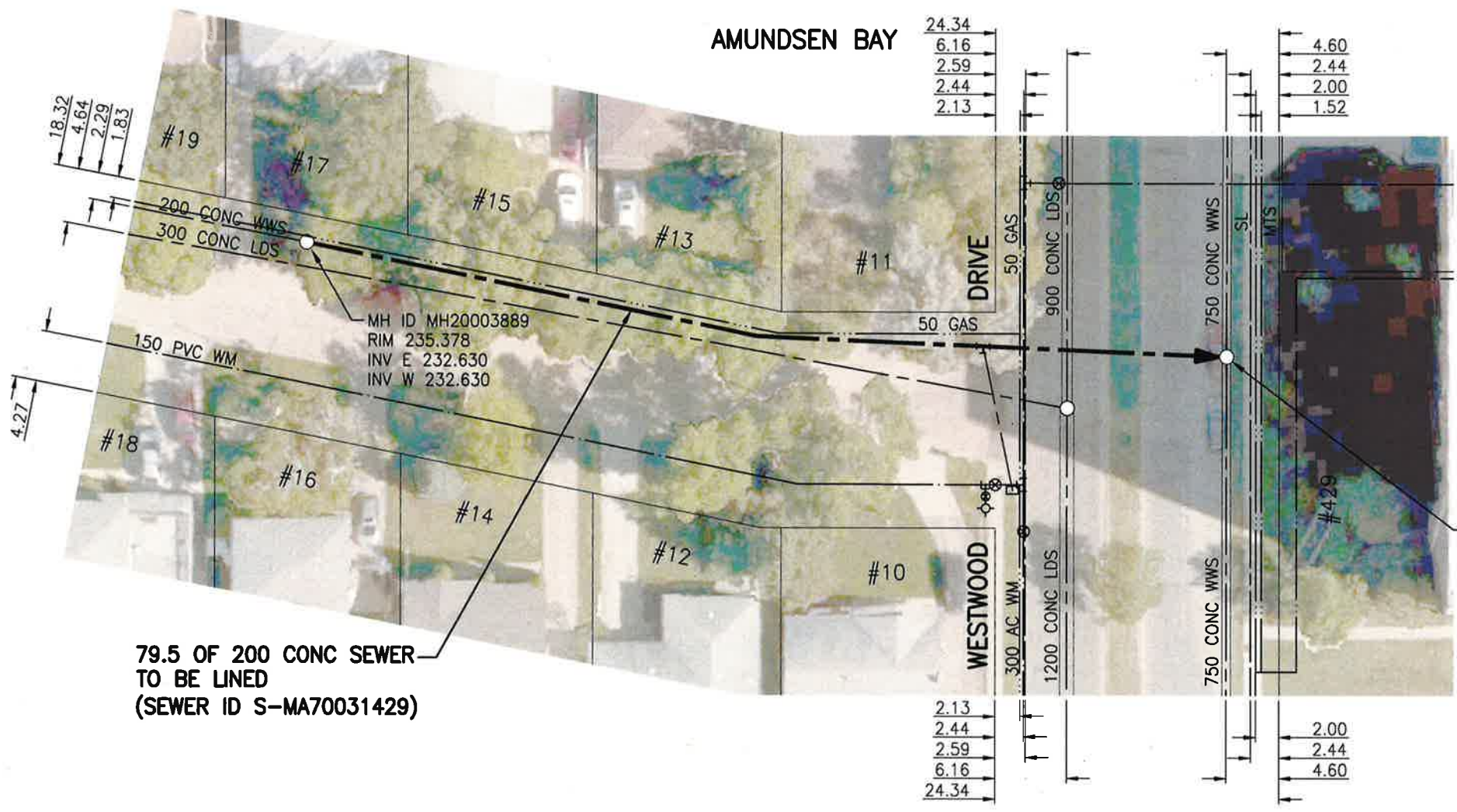

79.5 OF 200 CONC SEWER TO BE LINED (SEWER ID S-MA70031429)

### WARNING

IF POWER EQUIPMENT OR EXPLOSIVES ARE TO BE USED FOR EXCAVATION ON THIS PROJECT THE CONTRACTOR MUST:

- 1) NOTIFY THE GAS COMPANY OF THE PROPOSED LOCATION OF EXCAVATION.
- 2) TAKE PRECAUTION TO AVOID DAMAGE TO GAS COMPANY INSTALLATIONS.

SEE PROVINCIAL REGULATION 140/92 FOR DETAILS

**ENGINEERS GEOSCIENTISTS MANITOBA**

Certificate of Authorization  
Stantec Consulting Ltd.  
No. 1301

**METRIC**

WHOLE NUMBERS INDICATE MILLIMETRES  
DECIMALIZED NUMBERS INDICATE METRES

1:500

TENDER NO. 117-2020

V:\1112\active\11218920\0302\_drawing\0302\_sheet\_files\02\_civil\18920c-101-934.dwg

LOCATION APPROVED UNDERGROUND STRUCTURES		B.M. ELEV.	
SUPV. U/G STRUCTURES COMMITTEE	DATE		
NOTE: LOCATION OF UNDERGROUND STRUCTURES AS SHOWN ARE BASED ON THE BEST INFORMATION AVAILABLE BUT NO GUARANTEE IS GIVEN THAT ALL EXISTING UTILITIES ARE SHOWN OR THAT THE GIVEN LOCATIONS ARE EXACT. CONFIRMATION OF EXISTENCE AND EXACT LOCATION OF ALL SERVICES MUST BE OBTAINED FROM THE INDIVIDUAL UTILITIES BEFORE PROCEEDING WITH CONSTRUCTION.			
2	ISSUED FOR TENDER	20.03.20	RS
1	ISSUED FOR REVIEW	20.03.09	RS
NO.	REVISIONS	DATE	BY

**Stantec**  
905 Waverley Street, Winnipeg, Manitoba  
Tel 204-489-5900 Fax 204-453-9012

DESIGNED BY	RS	CHECKED BY	RS
DRAWN BY	SC	APPROVED BY	RS
HOR. SCALE:	1:500	RELEASED FOR CONSTRUCTION:	
VERTICAL:		DATE	20.01.06

ENGINEER'S SEAL

CONSULTANT DRAWING NO. C-106

**THE CITY OF WINNIPEG**  
WATER AND WASTE DEPARTMENT

2019 SEWER RENEWALS BY CIPP LINING  
CONTRACT 7  
**AMUNDSEN BAY N LEG**  
MH AT WESTWOOD DR TO  
1ST MH W OF WESTWOOD DR

SHEET	OF
08	50
CAD FILE DRAWING NUMBER 18920c-101-934.dwg	
CITY DRAWING NUMBER 12399	