

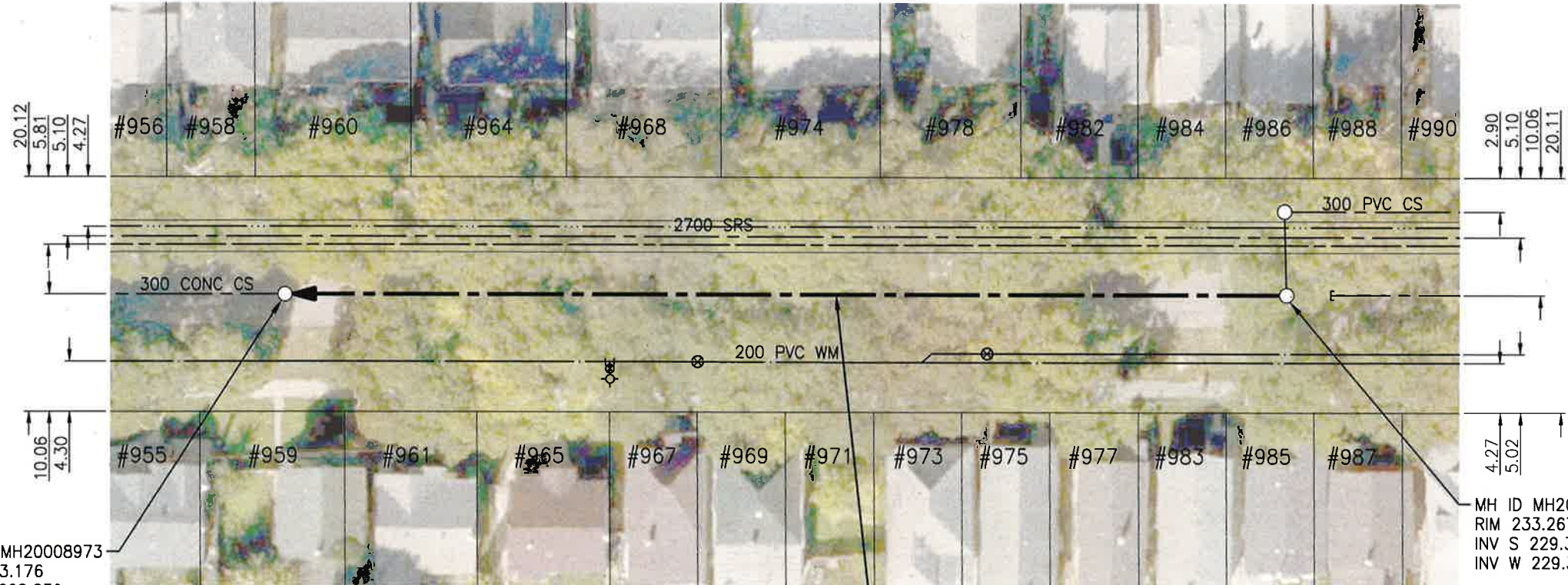

STRATHCONA STREET

SEWER JUNCTION INFORMATION FROM SEWER VIDEO INSPECTION

SEWER ID S-MA20009815		
DISTANCE FROM MHXXX		
DISTANCE	DIAMETER	CLOCK
5.0	150	10
5.5	150	2
11.8	150	10
12.3	150	2
19.2	150	10
19.9	150	2
26.7	150	10
27.3	150	2
34.2	150	10
34.8	150	2
42.1	150	10
43.0	150	2
50.2	150	10
57.4	150	10
57.9	150	2
65.2	150	10
65.7	150	2
72.7	150	10
73.3	150	2
80.5	150	10
81.1	150	2



MH ID MH20008973
RIM 233.176
INV N 228.830
INV S 228.830

MH ID MH20008974
RIM 233.267
INV S 229.300
INV W 229.300

86.30 OF 300 CONC SEWER
TO BE LINED
(SEWER ID S-MA20009815)

WARNING

IF POWER EQUIPMENT OR EXPLOSIVES ARE TO BE USED FOR EXCAVATION ON THIS PROJECT THE CONTRACTOR MUST:

- 1) NOTIFY THE GAS COMPANY OF THE PROPOSED LOCATION OF EXCAVATION.
 - 2) TAKE PRECAUTION TO AVOID DAMAGE TO GAS COMPANY INSTALLATIONS.
- SEE PROVINCIAL REGULATION 140/92 FOR DETAILS

EG ENGINEERS GEOSCIENTISTS MANITOBA
Certificate of Authorization
Stantec Consulting Ltd.
No. 1301

METRIC
WHOLE NUMBERS INDICATE MILLIMETRES
DECIMALIZED NUMBERS INDICATE METRES

1:500

TENDER NO. 117-2020

LOCATION APPROVED UNDERGROUND STRUCTURES

SUPV. U/G STRUCTURES COMMITTEE DATE

NOTE:
LOCATION OF UNDERGROUND STRUCTURES AS SHOWN ARE BASED ON THE BEST INFORMATION AVAILABLE BUT NO GUARANTEE IS GIVEN THAT ALL EXISTING UTILITIES ARE SHOWN OR THAT THE GIVEN LOCATIONS ARE EXACT. CONFIRMATION OF EXISTENCE AND EXACT LOCATION OF ALL SERVICES MUST BE OBTAINED FROM THE INDIVIDUAL UTILITIES BEFORE PROCEEDING WITH CONSTRUCTION.

NO.	REVISIONS	DATE	BY
2	ISSUED FOR TENDER	20.03.20	RS
1	ISSUED FOR REVIEW	20.03.09	RS

Stantec
905 Waverley Street, Winnipeg, Manitoba
Tel 204-489-5900 Fax 204-453-9012

DESIGNED BY	RS	CHECKED BY	RS
DRAWN BY	SC	APPROVED BY	RS
HOR. SCALE:	1:500	RELEASED FOR CONSTRUCTION	
VERTICAL:			
DATE	20.01.06	DATE	MAR 19 2020

ENGINEER'S SEAL
PROVINCE OF MANITOBA
REGISTERED PROFESSIONAL ENGINEER
R.M. SHERLOCK
MEMBER 24045
CONSULTANT DRAWING NO. C-126

THE CITY OF WINNIPEG
WATER AND WASTE DEPARTMENT

2019 SEWER RENEWALS BY CIPP LINING
CONTRACT 7
STRATHCONA STREET
2ND MH N OF ST MATTHEWS AVE TO
1ST MH N OF ST MATTHEWS AVE

SHEET 28 OF 50
CAD FILE DRAWING NUMBER 18920c-121-934.dwg
CITY DRAWING NUMBER 12419

V:\1112\active\111218920\0300_drawing\0302_sheet_files\02_civil\18920c-121-934.dwg