

SEWER JUNCTION INFORMATION FROM SEWER VIDEO INSPECTION

SEWER ID S-MA20013685		
DISTANCE FROM MH20012394		
DISTANCE	DIAMETER	CLOCK
1.8	150	2
2.8	150	2
23.2	150	10
24.9	150	2
33.8	150	10
39.6	150	2
42.6	150	2
47.2	150	10
54.8	150	2
57.8	150	10
61.0	250	10
61.8	150	2
67.4	150	2
70.5	150	10
80.5	150	10
83.8	150	2
91.2	150	10
97.9	150	2

MIDDLE GATE

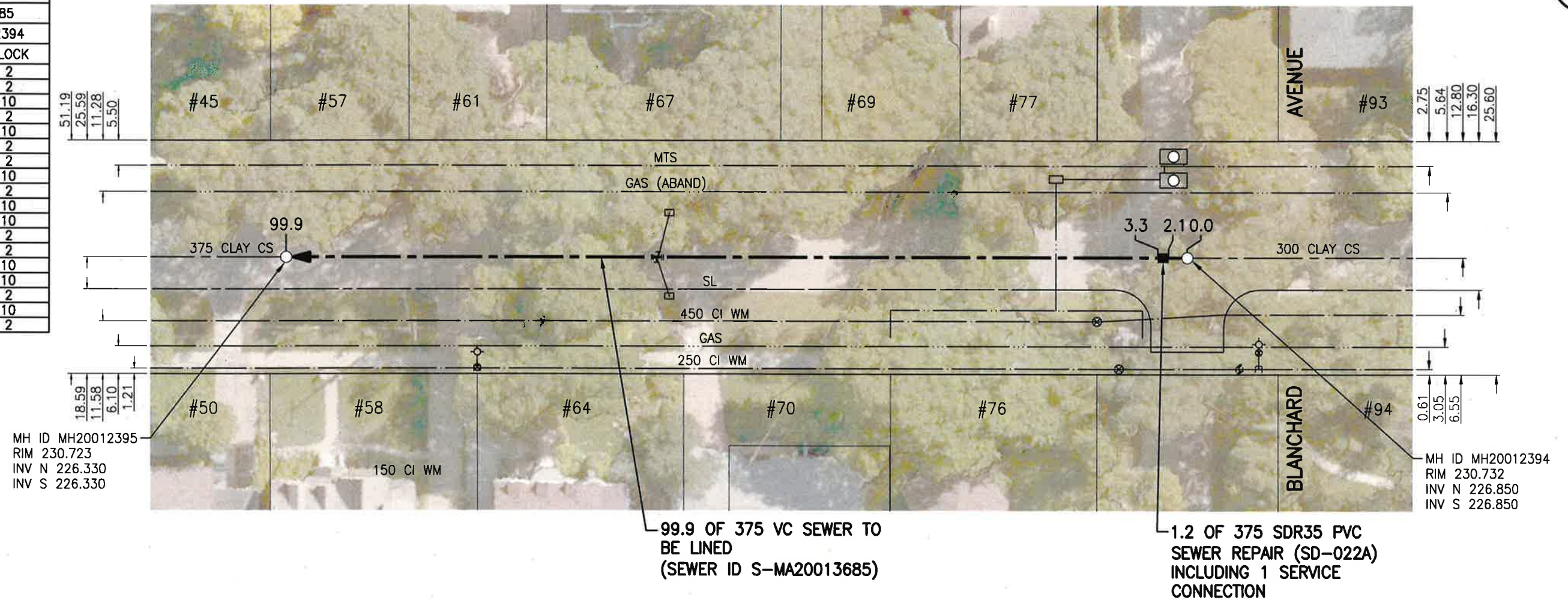

WARNING

IF POWER EQUIPMENT OR EXPLOSIVES ARE TO BE USED FOR EXCAVATION ON THIS PROJECT THE CONTRACTOR MUST:

- 1) NOTIFY THE GAS COMPANY OF THE PROPOSED LOCATION OF EXCAVATION.
 - 2) TAKE PRECAUTION TO AVOID DAMAGE TO GAS COMPANY INSTALLATIONS.
- SEE PROVINCIAL REGULATION 140/92 FOR DETAILS

ENGINEERS GEOSCIENTISTS MANITOBA
 Certificate of Authorization
 Stantec Consulting Ltd.
 No. 1301

METRIC
 WHOLE NUMBERS INDICATE MILLIMETRES
 DECIMALIZED NUMBERS INDICATE METRES

1:500

TENDER NO. 117-2020

LOCATION APPROVED UNDERGROUND STRUCTURES

SUPV. U/G STRUCTURES COMMITTEE	DATE

NOTE:
 LOCATION OF UNDERGROUND STRUCTURES AS SHOWN ARE BASED ON THE BEST INFORMATION AVAILABLE BUT NO GUARANTEE IS GIVEN THAT ALL EXISTING UTILITIES ARE SHOWN OR THAT THE GIVEN LOCATIONS ARE EXACT. CONFIRMATION OF EXISTENCE AND EXACT LOCATION OF ALL SERVICES MUST BE OBTAINED FROM THE INDIVIDUAL UTILITIES BEFORE PROCEEDING WITH CONSTRUCTION.

NO.	REVISIONS	DATE	BY
2	ISSUED FOR TENDER	20.03.20	RS
1	ISSUED FOR REVIEW	20.03.09	RS

B.M.	ELEV.

Stantec
 905 Waverley Street, Winnipeg, Manitoba
 Tel 204-489-5900 Fax 204-453-9012

DESIGNED BY RS	CHECKED BY RS
DRAWN BY SC	APPROVED BY RS
HOR. SCALE: 1:500 VERTICAL:	RELEASED FOR CONSTRUCTION: <i>[Signature]</i>
DATE 20.01.06	DATE <i>[Signature]</i>

ENGINEER'S SEAL

CONSULTANT DRAWING NO.
C-137

THE CITY OF WINNIPEG
 WATER AND WASTE DEPARTMENT

2019 SEWER RENEWALS BY CIPP LINING
 CONTRACT 7
MIDDLE GATE
 MH AT BLANCHARD AVE TO
 1ST MH NW OF BLANCHARD AVE

SHEET OF 39 50
CAD FILE DRAWING NUMBER 18920c-131-934.dwg
CITY DRAWING NUMBER 12430