

NOTE: CHAINAGES SHOWN ARE ALONG CENTRE LINE OF ROW

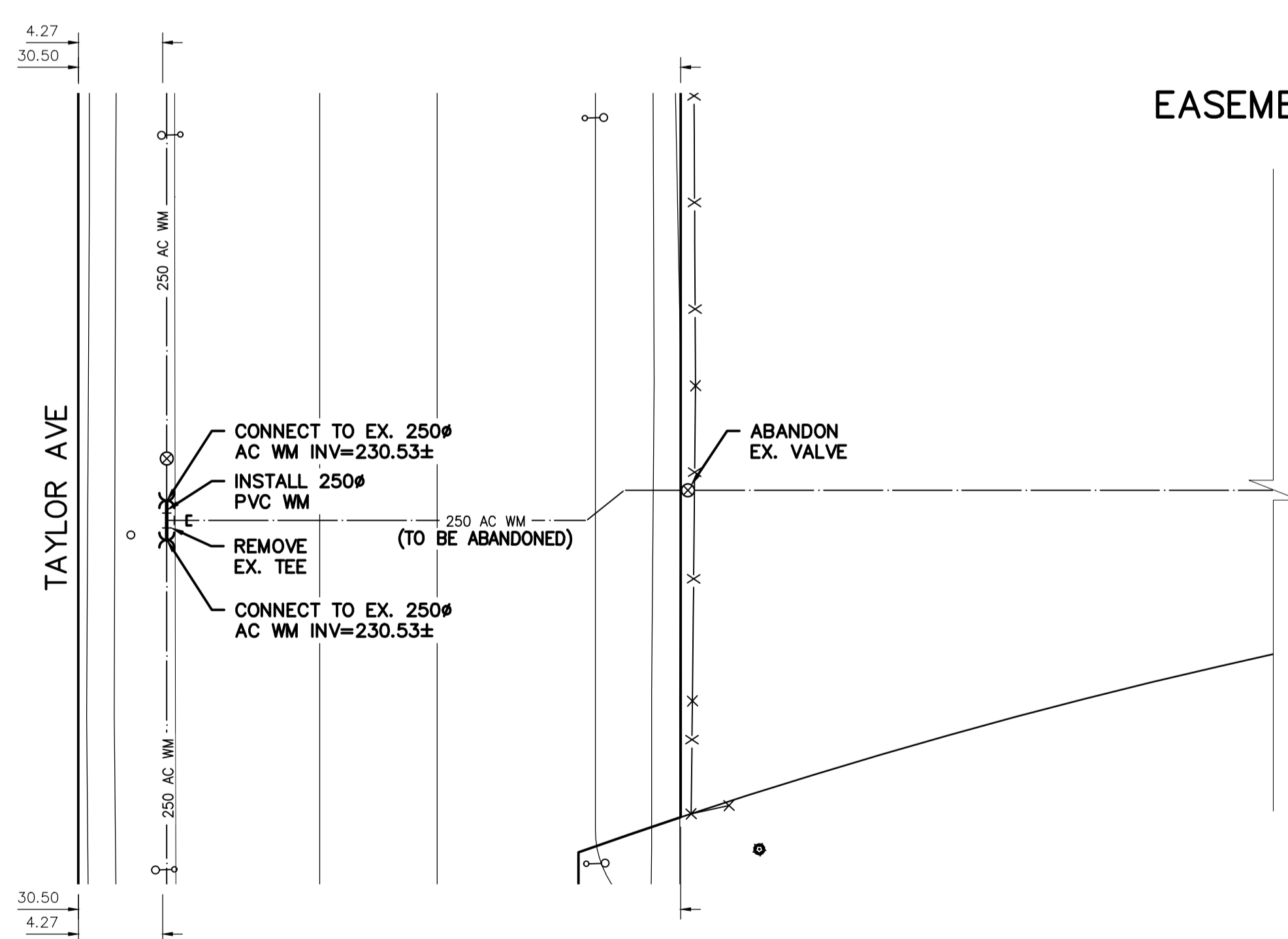

EASEMENT W OF CENTENNIAL ST

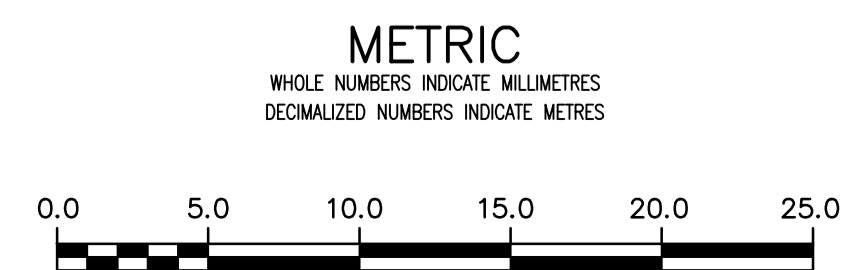
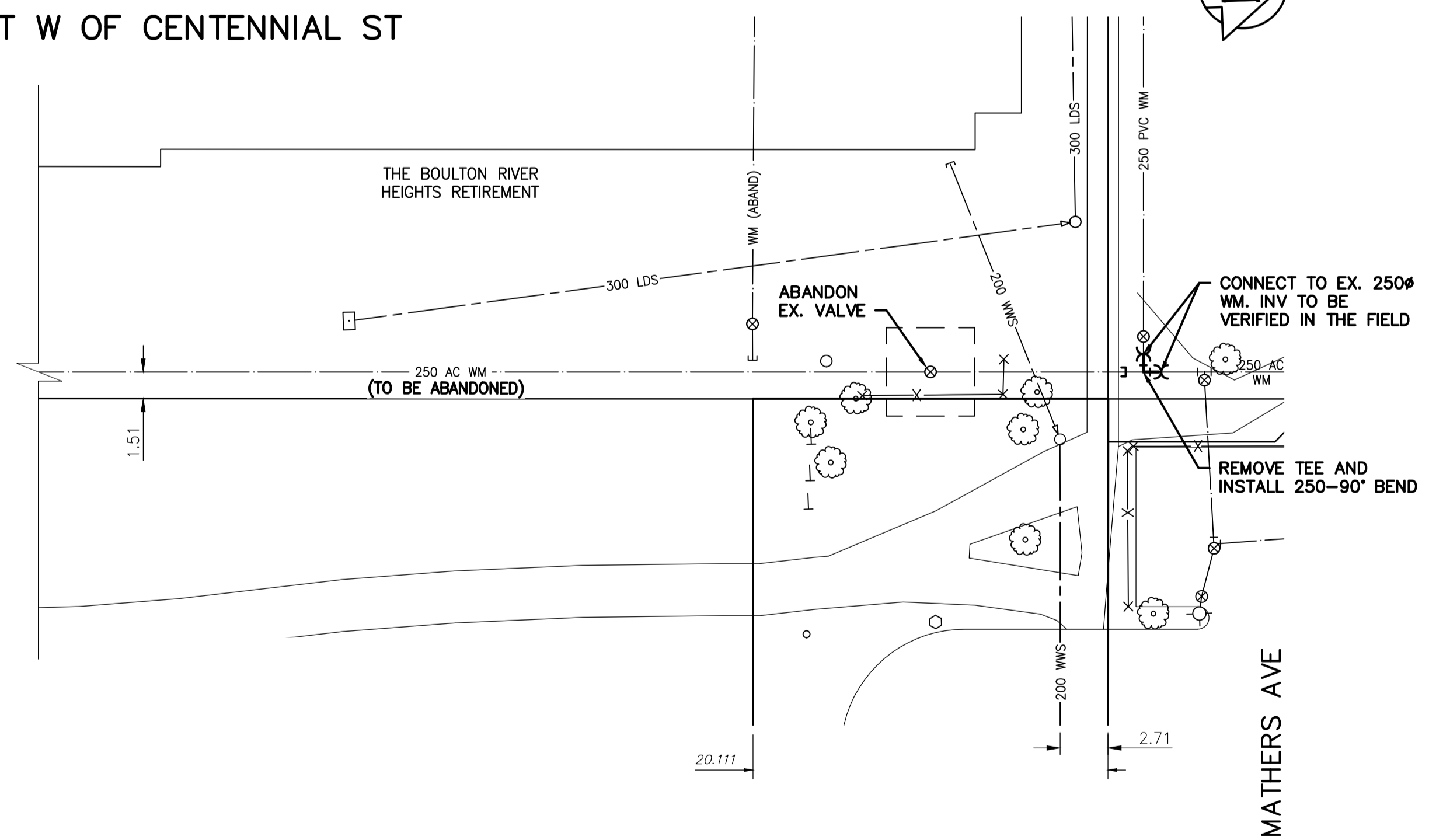

LOCATION APPROVED UNDERGROUND STRUCTURES

SUPV. U/G STRUCTURES COMMITTEE DATE

NOTE:
LOCATION OF UNDERGROUND STRUCTURES AS SHOWN ARE BASED ON THE BEST INFORMATION AVAILABLE BUT NO GUARANTEE IS GIVEN THAT ALL EXISTING UTILITIES ARE SHOWN OR THAT THE GIVEN LOCATIONS ARE EXACT. CONFIRMATION OF EXISTENCE AND EXACT LOCATION OF ALL SERVICES MUST BE OBTAINED FROM THE INDIVIDUAL UTILITIES BEFORE PROCEEDING WITH CONSTRUCTION.

B.M. Z51-35 ELEV. 234.061	S.E. Cor. Kingsway & Beaverbrook St., Brass plug in 7.3m Conc. pile 2.5m N. of S.L. Kingsway & 0.6m E. of E.L. Beaverbrook St.		
02	ISSUED FOR TENDER	2020.04.01	RS
01	ISSUED FOR 60% REVIEW	2020.03.09	RS
NO.	REVISIONS	DATE	BY

DESIGNED BY	RS	CHECKED BY	RS
DRAWN BY	SC	APPROVED BY	RS
SCALE:	HORIZONTAL 1:250	RELEASED FOR CONSTRUCTION	DATE
	VERTICAL 1:50		
DATE	2019.01.15		

PLOT DATE: 2020 04 01

ENGINEER'S SEAL

ORIGINAL SEALED BY
R.M. SHERLOCK
P. ENG.
2020/04/01

CONSULTANT DRAWING NUMBER
C-201

TENDER NUMBER: 118-2020

THE CITY OF WINNIPEG
WATER AND WASTE DEPARTMENT
ENGINEERING DIVISION

2020 WATERMAIN RENEWALS
CONTRACT 2
EASEMENT W OF CENTENNIAL ST
TAYLOR AVE TO
MATHERS AVE

SHEET 03 OF 19
CITY DRAWING NUMBER
D-15682

FILE PATH: V:\1112\active\111218970\0300_drawing\0300_sheet_files\02_civil\