

NOTE: CHAINAGES SHOWN ARE ALONG CENTRE LINE OF ROW

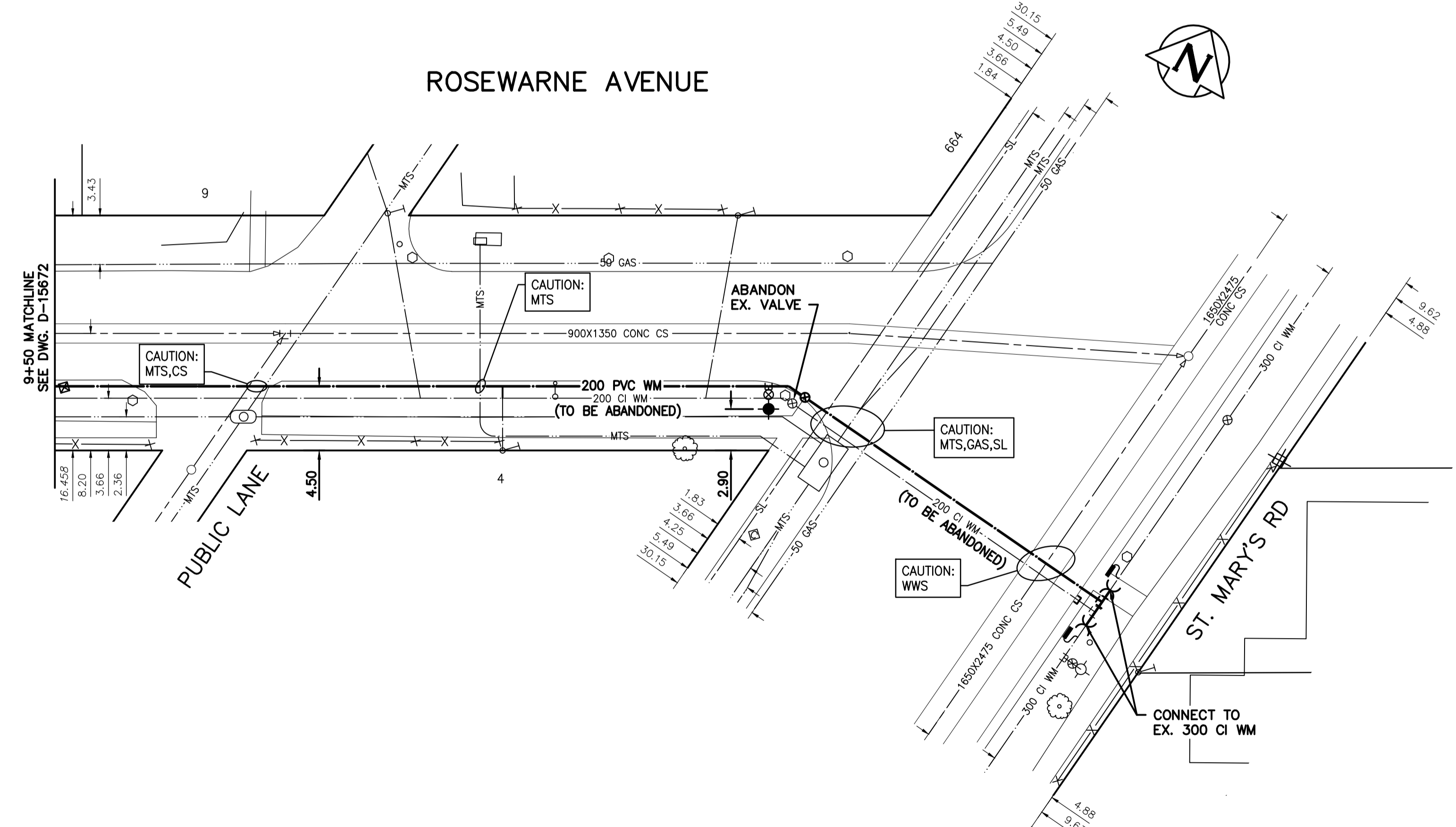

WATER SERVICE INFORMATION

ADDRESS	PIPE SIZE & MATERIAL (STREET)	PIPE SIZE & MATERIAL (PROP.)	SHORT & LONG MEASUREMENT	CORP. LOCATION	REMARKS
9 ROSEWARNE AVE	-	12	10.06 R/L	-	RECONNECT SERVICE
RESIDENTIAL	-	LEAD	14.02 W/WL ST. MARYS RD	-	RECONNECT SERVICE
4 ROSEWARNE AVE	-	20	0.61 R/L	-	RECONNECT SERVICE
RESIDENTIAL	-	CU	19.20 W/WL ST. MARYS RD	-	RECONNECT SERVICE
664 ST MARY'S RD	-	20	1.00 W/WL	-	RECONNECT SERVICE
RESIDENTIAL	-	CU	-	-	-

\* SERVICES TO BE RENEWED TO R

NOTE: VALVES TO BE INSTALLED CLOCKWISE TO CLOSE

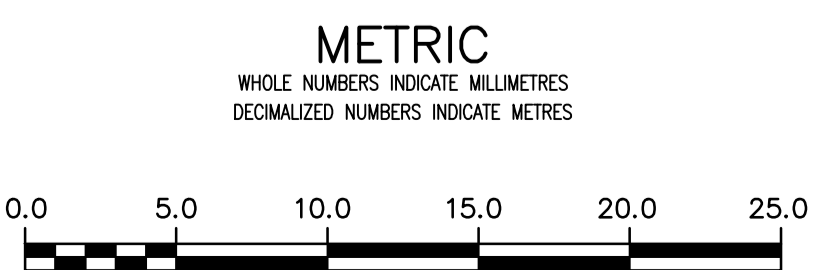

LOCATION APPROVED  
UNDERGROUND STRUCTURES

SUPV. U/G STRUCTURES COMMITTEE DATE

NOTE:  
LOCATION OF UNDERGROUND STRUCTURES AS SHOWN ARE BASED ON THE BEST INFORMATION AVAILABLE BUT NO GUARANTEE IS GIVEN THAT ALL EXISTING UTILITIES ARE SHOWN OR THAT THE GIVEN LOCATIONS ARE EXACT. CONFIRMATION OF EXISTENCE AND EXACT LOCATION OF ALL SERVICES MUST BE OBTAINED FROM THE INDIVIDUAL UTILITIES BEFORE PROCEEDING WITH CONSTRUCTION.

B.M. 82R543 ELEV. 230.874	S.W. Cor. Kingston Row & Kilarney St., Tblt. on top of 0.05 m dia. x 2.4 m iron pipe, 1.4 m N. of S.L. Kingston Row & 11.6 m W. of E.L. Kilarney St.		
02	ISSUED FOR TENDER	2020.04.01	RS
01	ISSUED FOR 60% REVIEW	2020.03.09	RS
NO.	REVISIONS	DATE	BY



DESIGNED BY	RS	CHECKED BY	RS
DRAWN BY	SC	APPROVED BY	RS
SCALE:	HORIZONTAL 1:250	RELEASED FOR CONSTRUCTION	DATE
	VERTICAL 1:50		
DATE	2019.01.15		

ENGINEER'S SEAL

ORIGINAL SEALED BY  
R.M. SHERLOCK  
P. ENG.  
2020/04/01

CONSULTANT DRAWING NUMBER  
C-214

TENDER NUMBER: 119-2020

**THE CITY OF WINNIPEG**  
WATER AND WASTE DEPARTMENT  
ENGINEERING DIVISION

2020 WATERMAIN RENEWALS  
CONTRACT 4  
ROSEWARNE AVENUE  
STA. 9+50 TO  
ST. MARY'S RD

SHEET 16 OF 22  
CITY DRAWING NUMBER  
D-15673