

NOTES :
 CONSTRUCTION STANDARDS
 TO BE CONSTRUCTED IN ACCORDANCE WITH MANITOBA HYDRO DISTRIBUTION AND SUBTRANSMISSION STANDARDS, LATEST REVISION. NO MAJOR CHANGE SHALL BE MADE WITHOUT APPROVAL OF THE DESIGN ENGINEER OR DELEGATE.
 SITE GRADING
 THE DEVELOPER IS RESPONSIBLE FOR GRADING OF THE SITE TO WITHIN +0.15M OF FINISHED GRADE PRIOR TO CONSTRUCTION COMMENCEMENT. BENCHMARKS ARE TO BE OBTAINED FROM THE DEVELOPER OR CONSULTANT.

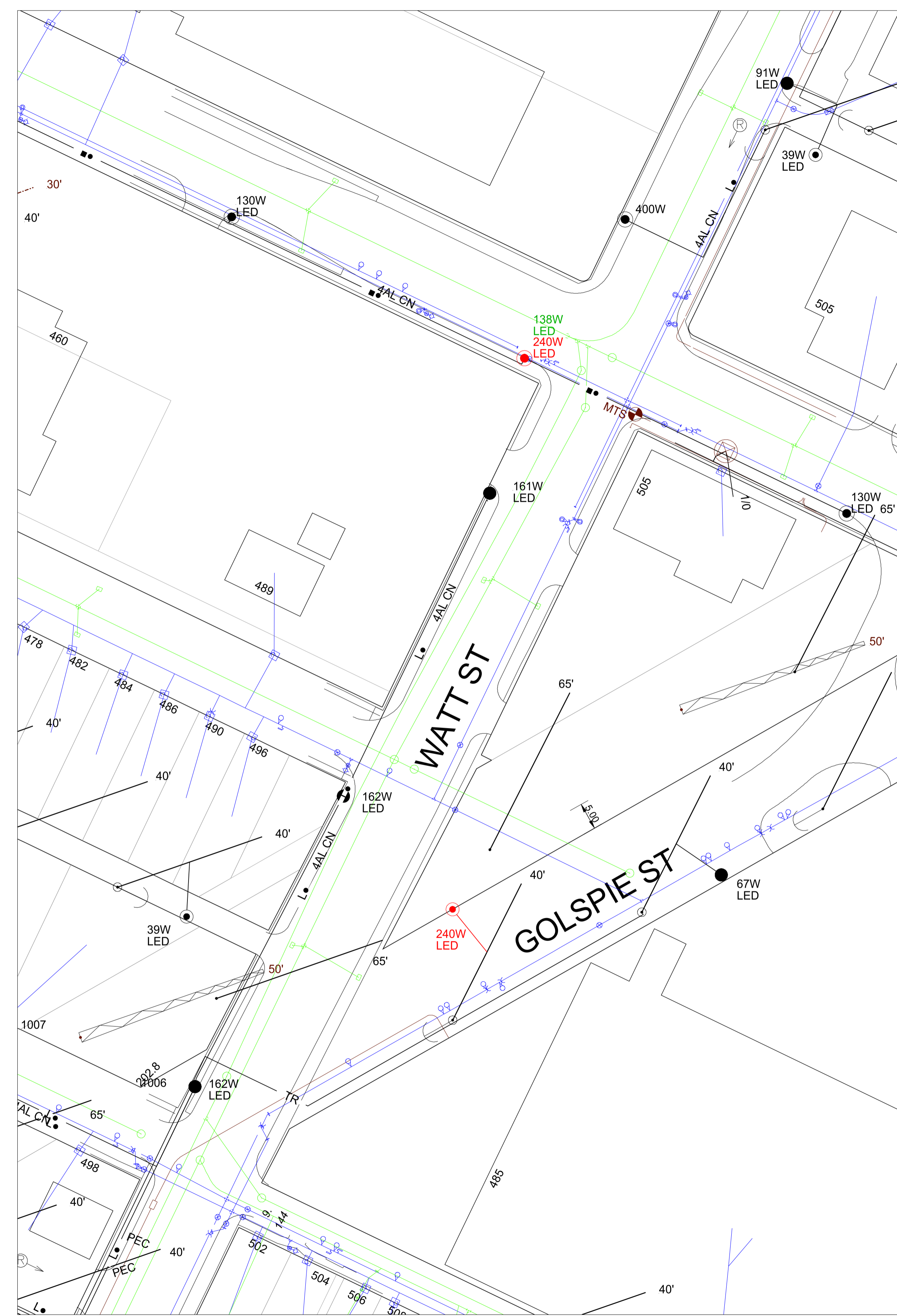
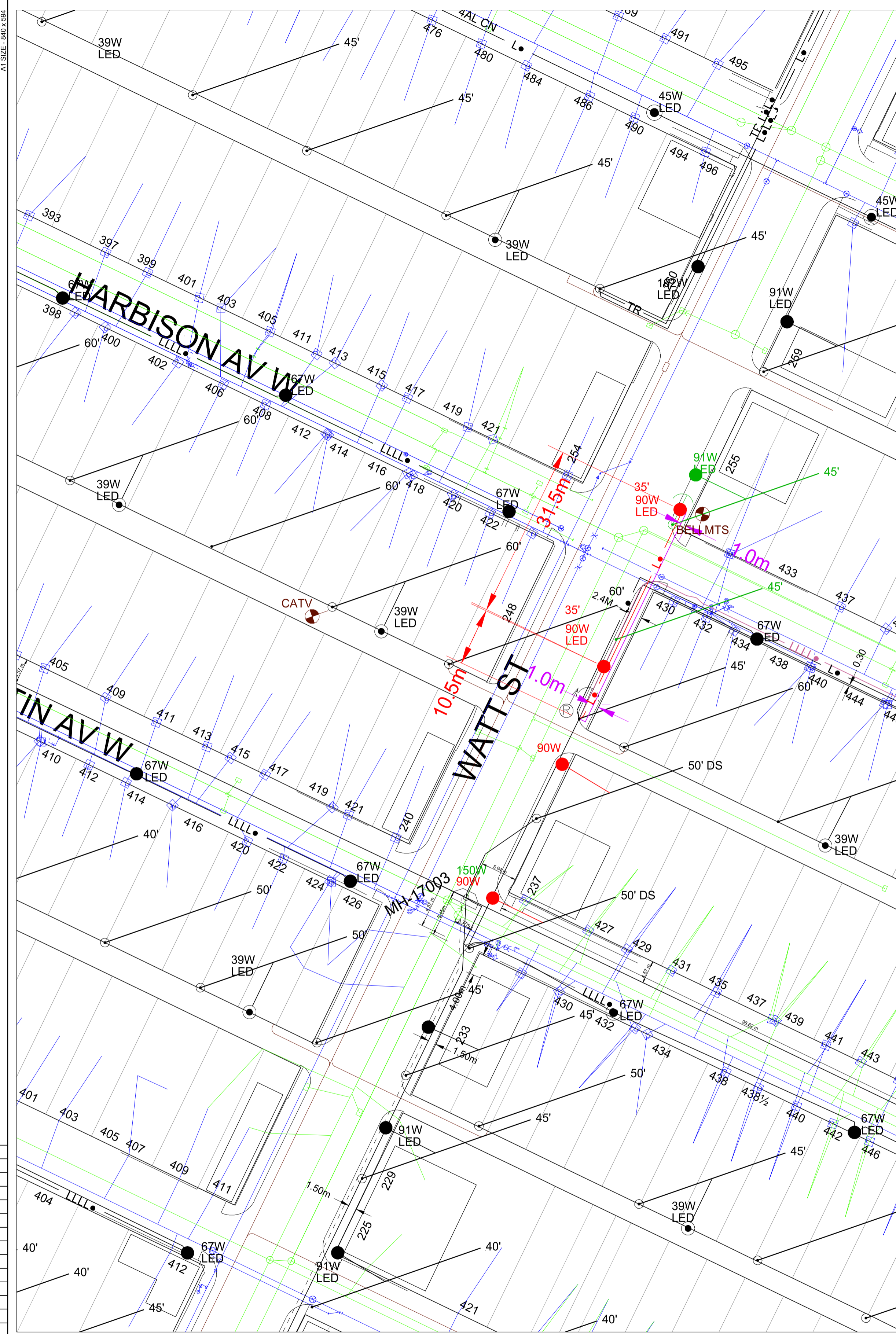

AUTHORITY	NOTIFIED	NOT REQ'D	OBTAINED
DISTRICT	2020 02 12		
C.O.W/MUNICIPAL	2020 02 20		
M.T.S.	2020 02 05		
GAS		X	
SHAW		X	
EASEMENTS		X	
COMMUNICATIONS		X	
S.C.C.		X	
DEPT. OF HIGHWAYS		X	

CONTACT	NAME	PHONE NUMBER	E-MAIL ADDRESS
DESIGN	TOM HUMBLE	360-3459	THUMBLE@HYDRO.MB.CA
DESIGN ENGINEER	MATT SINGER	360-3201	MSINGER@HYDRO.MB.CA
PORTFOLIO PM	DARIN WACH	360-3082	DWACH@HYDRO.MB.CA
ENERGY SERVICE ADVISOR	TIM LOEB	360-5157	TLOEB@HYDRO.MB.CA
U/G CONSTRUCTION	BILL AMMETER	981-8356	BAMMETER@HYDRO.MB.CA
O/H CONSTRUCTION	WAYNE IRELAND	771-5212	WIRELAND@HYDRO.MB.CA
HYDRO GAS			
SHAW			
MTS			
CUSTOMER REPRESENTATIVE	SCOTT MINTY	781-5518	SCOTT.MINTY@WSP.COM
DISTRICT ENG TECH	TODD FOUNTAIN	360-7467	TFOUNTAIN@HYDRO.MB.CA
ELECTRICAL CONTRACTOR			

INSTALLED			
Quantity	Fixture Type	Wattage	Pole Type
1	LED	240	EXCLUSIVE
1	LED	240	SHARED
2	LED	90	EXCLUSIVE
2	LED	90	SHARED
##	LED	##	SHARED

REMOVED			
Quantity	Fixture Type	Wattage	Pole Type
1	LED	138	EXCLUSIVE
1	LED	150	SHARED
##	LED	##	EXCLUSIVE
##	LED	##	SHARED
##	LED	##	SHARED

THIS IS A PRINT OF A DOCUMENT THAT HAS BEEN ELECTRONICALLY AUTHENTICATED WITH TECHNOLOGY AUTHORIZED BY THE EGM. THE ORIGINAL IS IN ELECTRONIC FORM.

INFORMATION PERTAINING TO THE SIZE, TYPE AND LOCATION OF MANITOBA HYDRO FACILITIES AND INSTALLATIONS IS ILLUSTRATIVE AND SHOULD NOT BE RELIED ON FOR THE PURPOSES OF ANY ACTIVITY BEING CONDUCTED AT OR NEAR THE IDENTIFIED HYDRO INSTALLATIONS. ALL LOCATIONS AND EQUIPMENT MUST BE VERIFIED BY APPROPRIATE HYDRO DISTRICT OFFICES PRIOR TO ANY PHYSICAL ACTIVITY BEING UNDERTAKEN AT OR NEAR HYDRO INSTALLATIONS.

CONTACT "CLICK BEFORE YOU DIG MANITOBA" AT
ClickBeforeYouDigMB.com
 THREE FULL WORKING DAYS
 PRIOR TO CONSTRUCTION FOR LOCATION OF EXISTING WATER, WASTEWATER, LAND DRAINAGE UTILITIES AND MANITOBA HYDRO UTILITIES

PRELIMINARY NOT TO BE USED FOR CONSTRUCTION

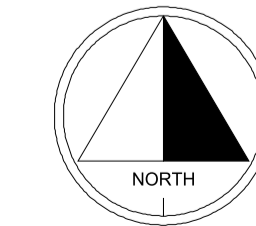

NO.	DATE	REVISION	BY	CKD.	APP.

DRAWING NUMBER	REFERENCE DRAWINGS	DRAWN	TH
03134-E-07143	MARTIN STATION SCHEMATIC		

CHECK	SCALE	DATE
	1:500	2020 02 12

AREA NUMBER	MANITOBA HYDRO DISTRIBUTION PLANNING & DESIGN	
5306	WO# P:32974	NETWORK # 4306092
STATION NUMBER	DISTRICT: ST BONIFACE	
1517	WATT STREET	
FEEDER NUMBER	INSTALL 2-35' DAVITS C/W 90W LUMINAIRES,	
1763	CHANGE OUT 2-O/H LUMINAIRES AND	
SYSTEM VOLTAGE	ADD 2 ADDITIONAL O/H LUMINAIRES ON 3M ARMS	
2.4/4.16KV		