

ALLEY PAVEMENT PROFILE
SCALE: 1:250 HOR 1:10 VER

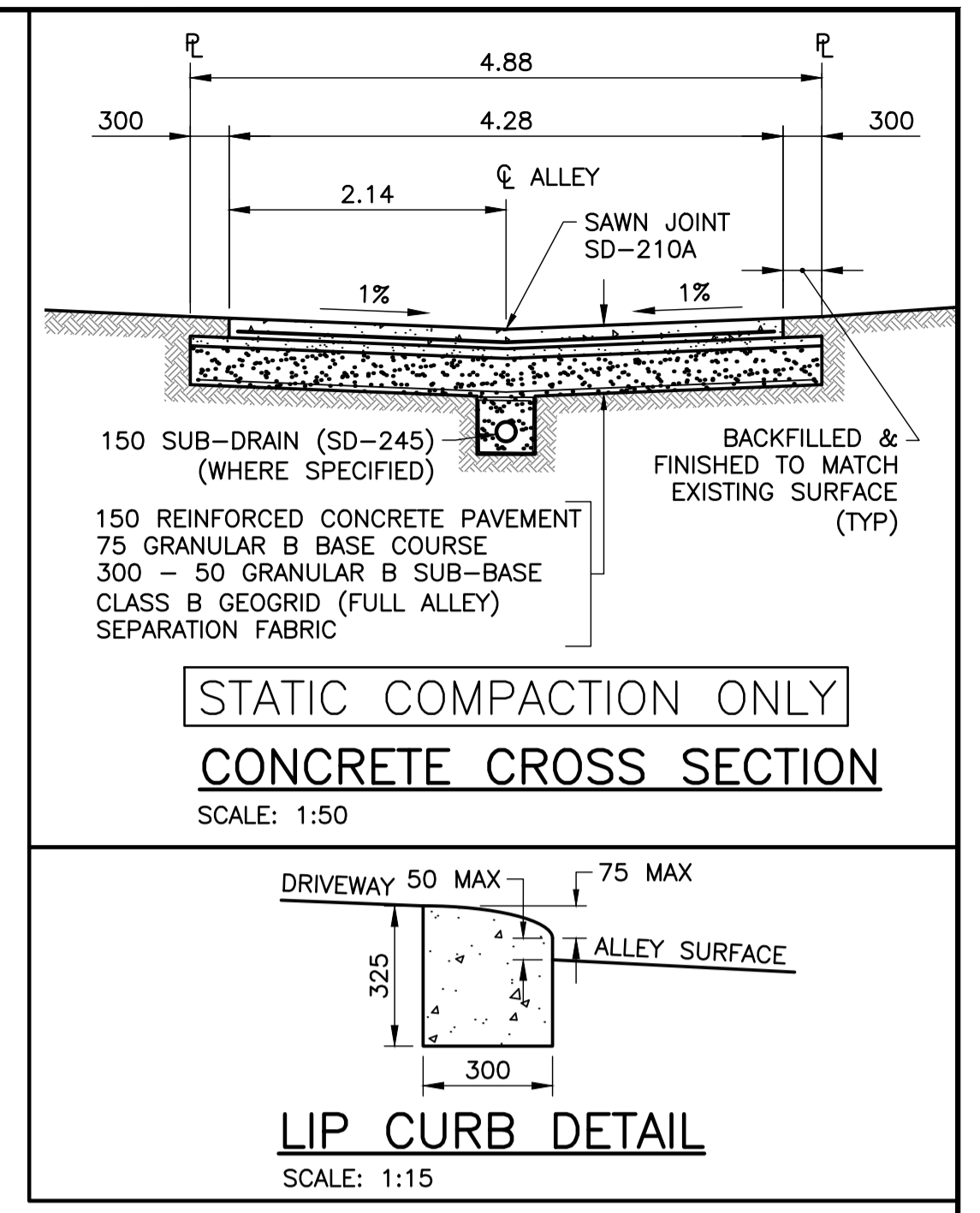

- NOTES**
- STATION CHAINAGE IS BASED ON CENTERLINE OF ALLEY RIGHT OF WAY.
 - ALLEY TO BE CONSTRUCTED IN PHASES AS SHOWN.
 - REGRADE EXISTING PRIVATE SIDEWALKS, APPROACHES & REAR OR SIDEYARDS AS DIRECTED.
 - INSTALLATION OF LIP CURBS AND THEIR EXTENTS TO BE DETERMINED BY THE CONTRACT ADMINISTRATOR ON SITE.
 - CONCRETE APPROACH RENEWALS TO BE REINFORCED IN ACCORDANCE WITH CW-3230, CW-3310, & SD-237.
 - INSTALL MODIFIED BARRIER CURB AT ALL ALLEY APPROACH RADII (SD-203B).
 - ALL EXISTING TREES TO BE PROTECTED THROUGHOUT CONSTRUCTION UNLESS OTHERWISE NOTED.
 - CONTACT THE CITY OF WINNIPEG GEOMATICS BRANCH IN ADVANCE OF CONSTRUCTION TO COORDINATE MONUMENT PROTECTION SERVICES (204)-918-1360.
 - CONFIRM THE LOCATION OF ALL UTILITIES PRIOR TO COMMENCING CONSTRUCTION.
 - LIGHT STANDARDS AND HYDRO POLES MAY REQUIRE TEMPORARY SUPPORT DURING CONSTRUCTION AT THE CONTRACTOR'S EXPENSE.
 - ISOLATE ALL POLES, BASES AND PILES WITHIN ALLEY RIGHT OF WAY (SD-228C).
 - NO VIBRATORY COMPACTION PERMITTED WITHIN 1.0M OF GAS MAINS OR DUCT BANKS.
 - NO WORKS, INCLUDING CONCRETE CUTTING OR BREAKING, TO BE UNDERTAKEN NEAR GAS LINES OR DUCT BANKS UNTIL DEPTH OF COVER IS DETERMINED AND A MANITOBA HYDRO SAFETY WATCH REPRESENTATIVE IS ON SITE.
 - PROVIDE SEWER INSPECTION FOR ALL NEW SEWER PIPE INSTALLATION, POINT REPAIRS & ABANDONMENTS.
 - ALL CONCRETE JOINTING TO BE AS INDICATED BY THE CONTRACT ADMINISTRATOR ON SITE. CRITICAL JOINT LOCATIONS WILL BE LOCATED AT EVERY GRADE BREAK, STREET LIGHT OR HYDRO POLE ISOLATION, UNDERGROUND STRUCTURE ISOLATION, AND ANY INTERSECTING ALLEY. GENERAL JOINT SPACING REQUIREMENTS ARE AS INDICATED ON SD-219.
 - SEE DETAILS ON SHEET 12 FOR AQUEDUCT, FEEDERMAIN AND DUCT BANK CROSSINGS.

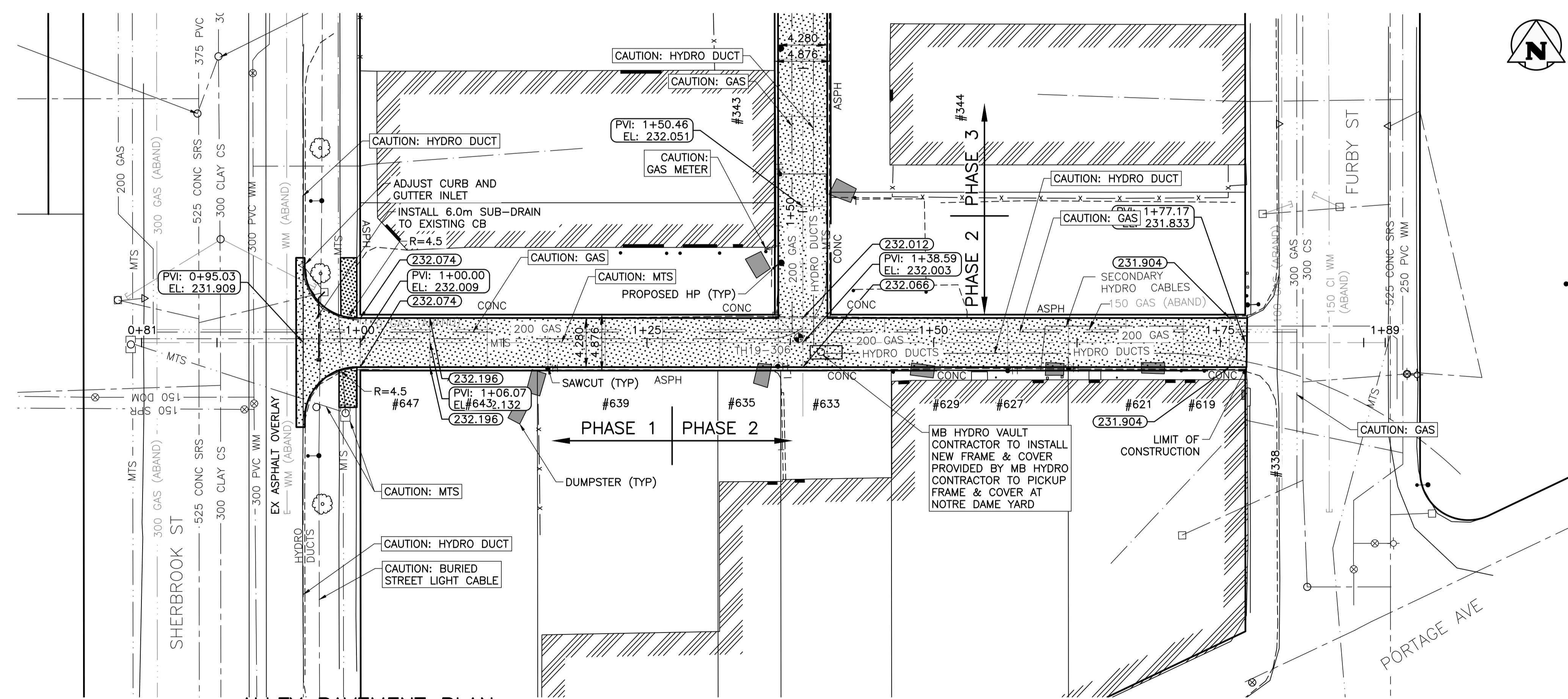

ALLEY PAVEMENT PLAN
SCALE: 1:250 HOR

PROPERTY LIMITS DELINEATION

DELINEATION OF PROPERTY LIMITS AS SHOWN ON THIS DWG DOES NOT REPRESENT A "LEGAL SURVEY". KGS GROUP MAKES NO REPRESENTATION OR WARRANTY AS TO THE ACCURACY OF PROPERTY LIMITS DELINEATED ON THIS DWG, NOR ON THE DIMENSIONAL ACCURACY OF DWG FEATURES RELATIVE TO THOSE PROPERTY LIMITS.

METRIC
WHOLE NUMBERS INDICATE MILLIMETRES
DECIMALIZED NUMBERS INDICATE METRES

ENGINEERS GEOSCIENTISTS MANITOBA
Certificate of Authorization
KGS Group
No. 245

- WARNING**
- NOTIFY THE GAS COMPANY OF THE PROPOSED LOCATION OF EXCAVATION.
 - TAKE PRECAUTION TO AVOID DAMAGE TO GAS COMPANY INSTALLATIONS.
 - SEE PROVINCIAL REGULATION 210/72 FOR DETAILS.

300 LBS	LAND DRAINAGE SEWER	300 LBS	- x - x -	FENCE			
250 WWS	WASTE WATER SEWER	250 WWS	+	TEST HOLE			
	GAS		+	GUY WIRE			
	HYDRO		+	LIGHT STANDARD			
	M.T.S.		+	BACK OF CURB			
150 WM	WATER MAIN	150 WM	+	CONCRETE			
	HYDRANT		+	ASPHALT			
	VALVE		+	SIDEWALK			
	MANHOLE		+	PROPERTY LINE			
	CATCH BASIN		+	SURVEY BAR			
	CURB INLET		+	GEODETIC BENCHMARK			
	POLES		+	ELEVATION	(232.231)	TTTTT	WINDOW/DOOR SILL
EXISTING	LEGEND-PLAN	PROPOSED	EXISTING	LEGEND-PROFILE	PROPOSED	EXISTING	LEGEND-PROFILE

LOCATION APPROVED UNDERGROUND STRUCTURES

SUPV. U/G STRUCTURES COMMITTEE DATE

NOTE:
LOCATION OF UNDERGROUND STRUCTURES AS SHOWN ARE BASED ON THE BEST INFORMATION AVAILABLE BUT NO GUARANTEE IS GIVEN THAT ALL EXISTING UTILITIES ARE SHOWN OR THAT THE GIVEN LOCATIONS ARE EXACT. CONFIRMATION OF EXISTENCE AND EXACT LOCATION OF ALL SERVICES MUST BE OBTAINED FROM THE INDIVIDUAL UTILITIES BEFORE PROCEEDING WITH CONSTRUCTION.

B.M. KGS_BASE	ELEV. 249.221
NO.	REVISIONS
DATE	BY

KGS GROUP	DESIGNED BY: JB	CHECKED BY: CR
	DRAWN BY: JLF	APPROVED BY: CR
	HOR. SCALE: 1:250	RELEASED FOR CONSTRUCTION: DATE
	VERTICAL: VARIES	

ENGINEER'S SEAL
PROVINCE OF MANITOBA
Asoc Roscoe
14869
2020-03-18
REGISTERED PROFESSIONAL ENGINEER

CONSULTANT DRAWING NO. **C301**

THE CITY OF WINNIPEG PUBLIC WORKS DEPARTMENT ENGINEERING DIVISION

PROJECT TITLE: **2019 ALLEY RENEWALS AND LOCAL IMPROVEMENT ALLEYS SHERBROOK ST/FURBY ST PORTAGE AVE TO ELLICE AVE SOUTH LEG**

SHEET **07** OF **24**

COMPUTER FILE NAME: **18-0107-017_CALL**

CITY DRAWING NUMBER: **---**

File: B:\Projects\2018\18-0107-017\Drawings\18-0107-017_CALL - Tab: C301 Plotted By: gloewen 20/03/18 [Wed 8:49am]
 At: C:\Users\jlf\OneDrive\Documents\18-0107-017_CALL - Scale: 1:1