

Roof Plan

Existing Roof Construction
(assumed all areas)

- steel deck
- felt and asphalt vapor barrier
- 4" polyisocyanurate
- 1/2" fiberboard
- 4 ply felt and asphalt
- gravel

Areas B1, C1, & D1 Construction

- steel deck
- 5/8" DensDeck
- SBS torch grade VB
- 2% sloped type 2 EPS min 2"
- 2" polyisocyanurate
- 3/8" Securock
- SBS torch grade base
- SBS torch grade cap

Area F1, G1 & H1 Construction

- steel deck
- 1/2" cement board
- 2 ply SBS torch grade VB
- 2% sloped type 2 EPS min 2"
- 2" polyisocyanurate
- 3/8" Securock
- SBS torch grade base
- SBS torch grade cap

Approx. Area

- sq.m.
- A1 = 21
- B1 = 34
- C1 = 243
- D1 = 33
- F1 = 28
- G1 = 59
- H1 = 59
- Total 746



Additional 3' width ply of
brown 250 GR cap sheet

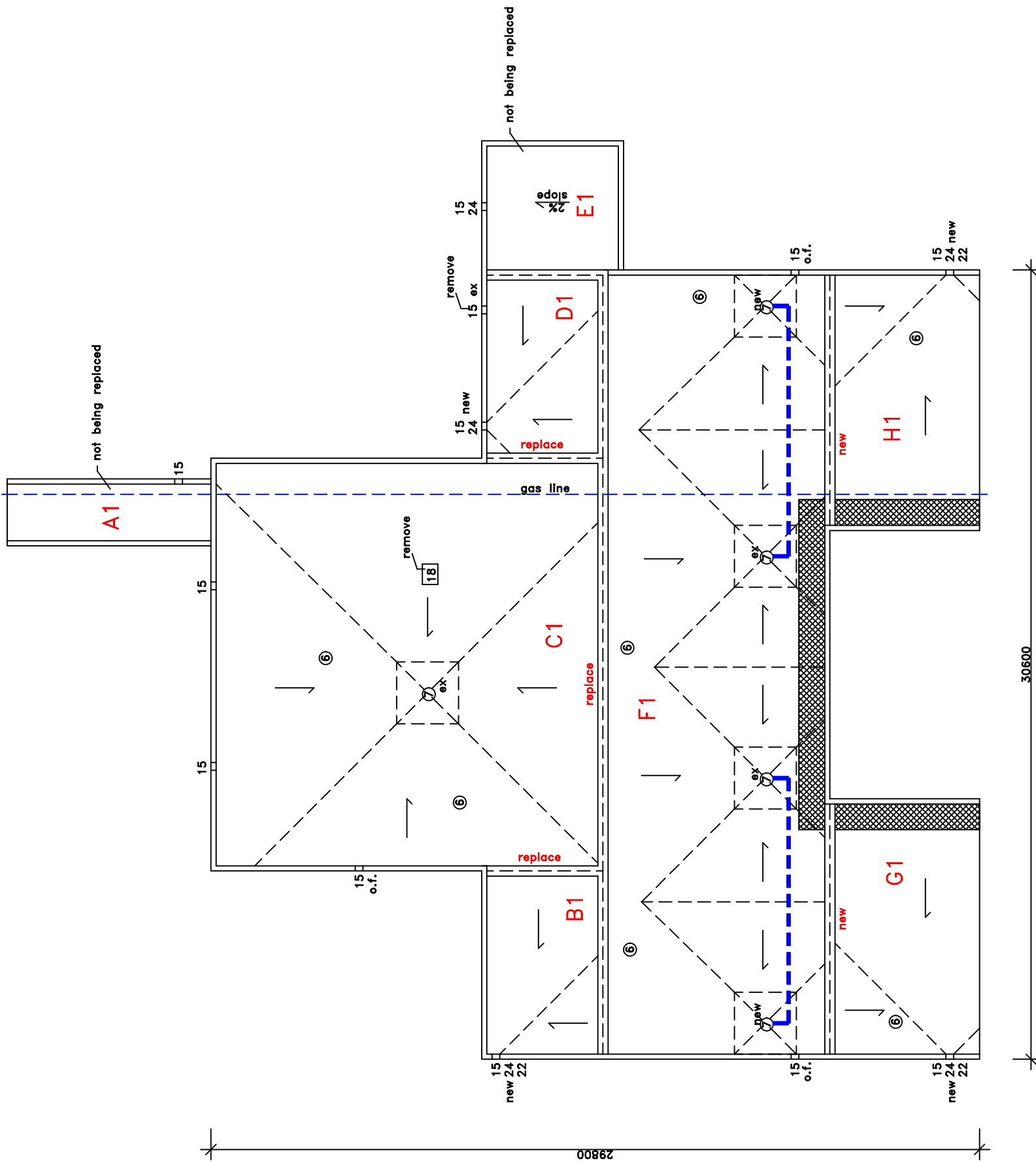

Notes:
 .01 Contractor is responsible for site verifications of all dimensions
 .02 Drawings are not to be scaled for estimating purposes
 .03 All areas given are approximate
 .04 Contractor is responsible for site verification of existing roof constructions
 Stated scale is when in 11x17 format

GRAPHIC LEGEND

- Parapet
- Gravel stop
- Gas line
- Control joint
- Expansion joint
- New insulated drain pipe
- Photo vantage point
- Area Label
area
no. of stories

☒ = attic vent X = leak

KEYNOTE LEGEND

- 1 core sample
- 2 chimney
- 3 AC unit
- 4 vent hood
- 5 ventilator
- 6 vent pipe
- 7 roof drain
- 8 skylight
- 9 eavestrough
- 10 firewall
- 11 antenna
- 12 ladder
- 13 stub column
- 14 roof hatch
- 15 scupper
- 16 pitch box
- 17 HVAC unit
- 18 capped curb
- 19 flag pole
- 20 electrical mast
- 21 cooling tower
- 22 splash pad
- 23 splash pan
- 24 downspout/rainwater leader
- 25 back slope
- 26 cant
- 27 increase slope to drain
- 28 cricket
- 29 parapet/wide flashing
- 30 life line anchor



Agassiz Consulting Group Ltd.
 Box 41, Warren, Manitoba R0C 3E0
 Office Phone: (204) 383-5538

Project: St. James Centennial Pool
 644 Parkdale
 Winnipeg, MB

Date: February 13, 2020

Drawing No. R-1

File no: 3609-20 Scale: 1:200