

NOTE: CHAINAGES SHOWN ARE ALONG W. R. OF PANET RD

NOTE: NOTIFY CONSTRUCTION SERVICES COORDINATOR (CITY OF WINNIPEG) AT 986-4289, 48 HOURS PRIOR TO EXCAVATION NEAR FEEDERMAIN

| WATER SERVICE INFORMATION |                             |                            |                          | CORP. LOCATION | REMARKS                                  |
|---------------------------|-----------------------------|----------------------------|--------------------------|----------------|--|
| ADDRESS                   | SIZE (mm) MATERIAL (STREET) | SIZE (mm) MATERIAL (PROP.) | SHORT & LONG MEASUREMENT |                |  |
| 212 PANET RD              |                             |                            |                          |                |  |
| 1 WARMAN RD               | 250 mm PVC                  | 250 mm PVC                 | 117.8 m NNL WARMAN       |                | Need Record Shell Terminal FIRE/DOMESTIC |

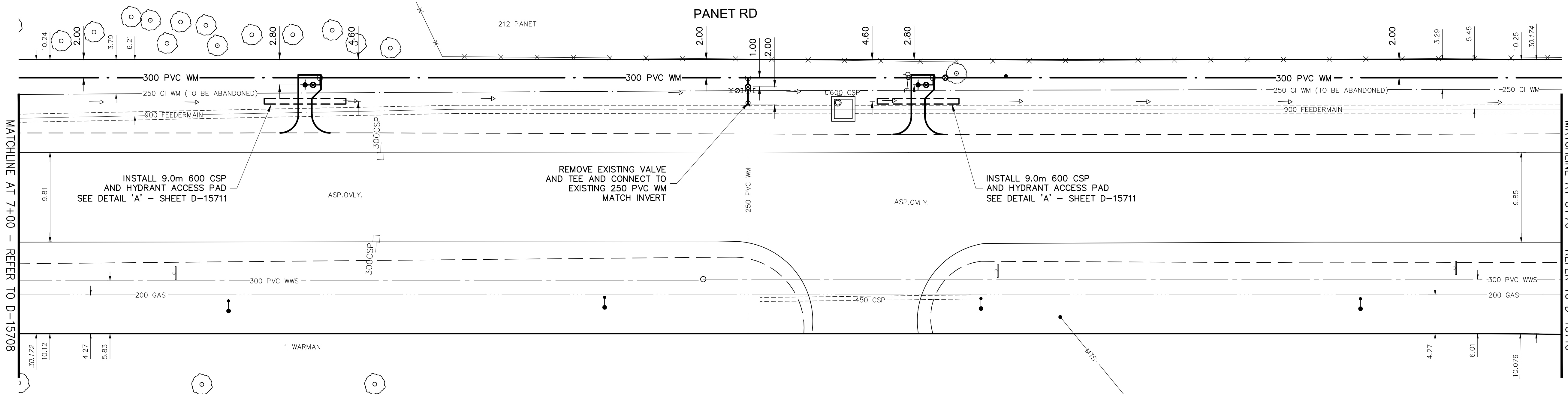
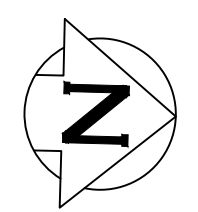

ALL VALVES ARE CLOCKWISE TO CLOSE (BLACK OPERATING NUT)

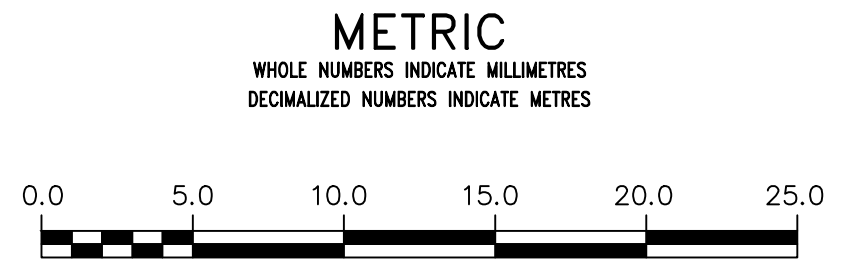

**ENGINEERS GEOSCIENTISTS MANITOBA**  
 Certificate of Authorization  
 AECOM Canada Ltd.  
 No. 4671 Date *April 13/20*  
 REFER TO DRAWING D-15700 FOR CONSTRUCTION NOTES

**WARNING**  
 IF POWER EQUIPMENT OR EXPLOSIVES ARE TO BE USED FOR EXCAVATION ON THIS PROJECT THE CONTRACTOR MUST:  
 1) NOTIFY THE GAS COMPANY OF THE PROPOSED LOCATION OF EXCAVATION.  
 2) TAKE PRECAUTION TO AVOID DAMAGE TO GAS COMPANY INSTALLATIONS.  
 SEE PROVINCIAL REGULATION 210/72 FOR DETAILS

**LOCATION APPROVED UNDERGROUND STRUCTURES**  
 SUPV. U/G STRUCTURES COMMITTEE DATE  
 NOTE:  
 LOCATION OF UNDERGROUND STRUCTURES AS SHOWN ARE BASED ON THE BEST INFORMATION AVAILABLE BUT NO GUARANTEE IS GIVEN THAT ALL EXISTING UTILITIES ARE SHOWN OR THAT THE GIVEN LOCATIONS ARE EXACT. CONFIRMATION OF EXISTENCE AND EXACT LOCATION OF ALL SERVICES MUST BE OBTAINED FROM THE INDIVIDUAL UTILITIES BEFORE PROCEEDING WITH CONSTRUCTION.

|                                |  |          |     |
|--------------------------------|--|----------|-----|
| B.M. 33-014<br>ELEV. 231.421 m | 360 (654360) - S.W. Cor. Mission St. & Panet Rd.,<br>Tilt: in 7.8 m Conc. pile, beneath Valve Box, 12.7 mm I.B. on N. side of pile for location purposes only. |          |     |
| NO.                            | REVISIONS  | DATE     | BY  |
| 0                              | ISSUED FOR TENDER  | 20/04/03 | GSK |
| B                              | ISSUED FOR REVIEW  | 20/03/18 | GSK |
| A                              | PRELIMINARY  | 20/02/13 | GSK |

**AECOM**

|             |                  |               |     |
|-------------|------------------|---------------|-----|
| DESIGNED BY | JP               | CHECKED BY    | GSK |
| DRAWN BY    | JP               | APPROVED BY   |     |
| SCALE:      | HORIZONTAL 1:250 | VERTICAL 1:50 |     |
| DATE        | 2020/04/03       | DATE          |     |

ENGINEER'S SEAL  
 PROVINCE OF MANITOBA  
 K.W. FITCHETT  
 REGISTERED PROFESSIONAL ENGINEER  
 CONSULTANT DRAWING NUMBER  
 C-0009

**THE CITY OF WINNIPEG**  
 WATER AND WASTE DEPARTMENT  
 ENGINEERING DIVISION  
 2020 WATER MAIN RENEWALS CONTRACT 6  
 PANET ROAD  
 FROM 38m N OF WARMAN ROAD TO 119m S OF MISSION STREET  
 SHEET 11 OF 13  
 CITY DRAWING NUMBER  
 D-15709