

TYPICAL CROSS SECTION  
N.T.S.

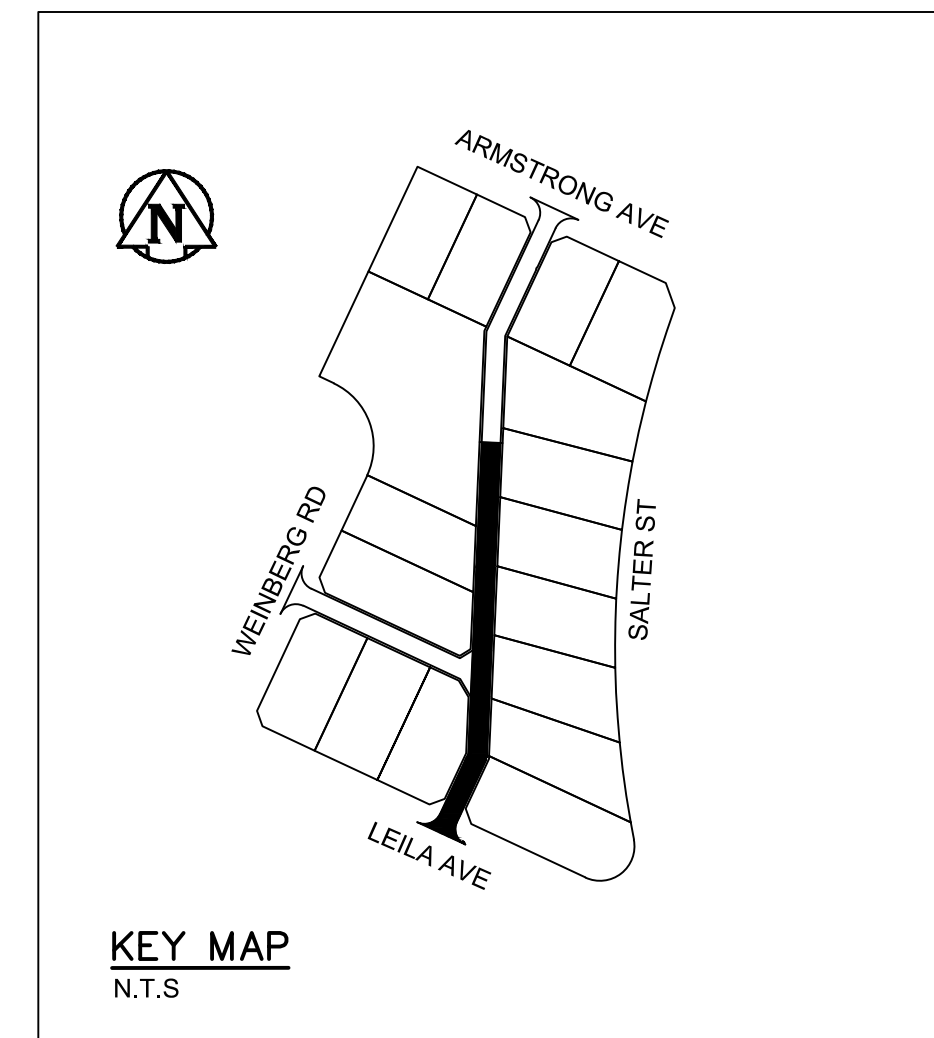
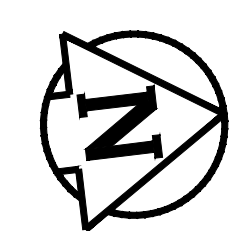
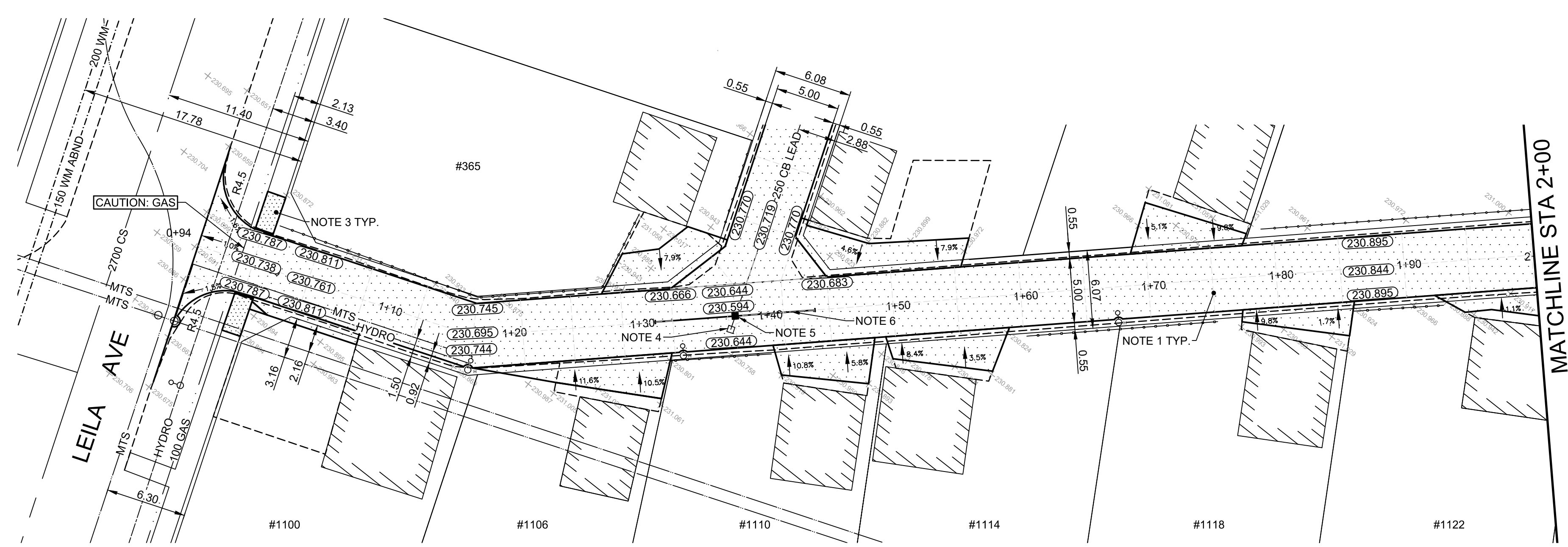

- CONSTRUCTION NOTES**
- REMOVE EXISTING PAVEMENT AND CONSTRUCT NEW 150mm REINFORCED CONCRETE PAVEMENT
  - REMOVE EXISTING APPROACH AND CONSTRUCT NEW 150mm REINFORCED CONCRETE APPROACH (SD-232)
  - RENEW 100mm CONCRETE SIDEWALK (SD-228A)
  - REMOVE EXISTING CATCH BASIN AS PER CW 2130
  - INSTALL NEW CATCH BASIN (SD-025), AND CONNECT TO EXISTING CB LEAD AS PER CW 2130
  - INSTALL 6.0m SUBDRAINS (SD-045) CONNECT TO CATCHBASIN AND CAP ENDS AS PER CW 3120
- GENERAL NOTES**
- PAVEMENT DIMENSIONS ARE TO BACK OF CURB / EDGE OF PAVEMENT
  - ALL CURB RADII UNDER 15.0m SHALL BE MODIFIED BARRIER (SD-203B)
  - CURB REPLACEMENT AS DIRECTED BY CONTRACT ADMINISTRATOR
  - PAVEMENT REPAIRS SHOWN ARE ONLY A REPRESENTATIVE SAME OF THE TENDER QUANTITIES

METRIC  
WHOLE NUMBERS INDICATE MILLIMETERS  
DECIMALIZED NUMBERS INDICATE METERS  
BID OPPORTUNITY NO. 4-2020

EXISTING	LEGEND - PLAN	PROPOSED	EXISTING	LEGEND - PLAN	PROPOSED	EXISTING	LEGEND - PROFILE	PROPOSED
⊕	HYDRANT	◆	---	LDS/WWS	---	▨	CONCRETE	▨
⊗	VALVE	◆	---	WATERMAIN	---	▨	CONCRETE SIDEWALK	▨
⊙	CURB STOP	◆	---	GAS	---	▨	ASPHALT	▨
⊖	MANHOLE	●	---	TRAFFIC SIGNALS	---	▨	BRICK	▨
⊖	CATCH BASIN	●	---	HYDRO/STREET LIGHT	---	▨	LEGEND - PLAN	PROPOSED
△	CURB INLET	▲	---	MTS/SHAW	---	---	WEST GUTTER	---
⊙	HYDRO POLE	●	---	CURB RENEWAL	---	---	CENTER LINE	---
⊙	LIGHT STANDARD	●	---	PROPERTY LINE	---	---	EAST GUTTER	---
⊙	TRAFFIC SIGNAL POLE	●	---	RAMP CURB	---	---	WEST SIDEWALK	---
⊕	SURVEY BAR	◆	---	ELEVATIONS	(31.000)	---	EAST SIDEWALK	---
⊕	GEODETIC BENCH MARK	⊕	---	TREE	---	---	---	---

LOCATION APPROVED  
UNDERGROUND STRUCTURES

IB @ N.E. CORNER 364 LEILA AVE  
230.708

ENGINEERING DIVISION  
TECHNOLOGY SERVICES BRANCH  
106 - 1155 PACIFIC AVE

DESIGNED BY C.W. CHECKED BY E.H.

DRAWN BY C.W. APPROVED BY

HOR. SCALE: 1 : 250  
VERTICAL: 1 : 10

DATE 2019/11/13

2. ISSUED FOR CONSTRUCTION 14/02/20 J.W.

1. SUBMIT FOR PLAN APPROVAL 16/12/19 E.H.

NO. REVISIONS DATE BY

NOTE:  
LOCATION OF UNDERGROUND STRUCTURES AS SHOWN ARE BASED ON THE BEST INFORMATION AVAILABLE. BUT NO GUARANTEE IS GIVEN THAT ALL EXISTING UTILITIES ARE SHOWN OR THAT THE GIVEN LOCATIONS ARE EXACT. CONFIRMATION OF EXISTENCE AND EXACT LOCATION OF ALL SERVICES MUST BE OBTAINED FROM THE INDIVIDUAL UTILITIES BEFORE PROCEEDING WITH CONSTRUCTION.

ENGINEER'S SEAL

PROVINCE OF MANITOBA  
L. LI  
Member  
32939  
REGISTERED ENGINEER

CITY DRAWING NUMBER  
SE-20-01  
SHEET 1 OF 39

1

THE CITY OF WINNIPEG  
PUBLIC WORKS DEPARTMENT

SALTER ST / WEINBERG RD ALLEY  
FROM LEILA AVE TO ARMSTRONG AVE  
CONCRETE RECONSTRUCTION AND ASSOCIATED WORKS  
FROM STA. 0+94.2 TO STA. 2+00