

# OSBORNE STREET

S-MH60007745  
RIM 231.99  
INV E 226.24  
INV S 226.13  
INV N 226.12

SEWER JUNCTION INFORMATION FROM SEWER VIDEO INSPECTION SEWER ID S-MA60009357		
DISTANCE FROM MH ID S-MH60007745		
DISTANCE	DIAMETER	CLOCK
3.7	100	10
10.7	100	10
18.9	100	02
19.3	100	10
27.8	100	10
27.8	100	02
29.4	150	01
35.1	100	12
35.7	100	10
35.7	100	02
43.9	100	02
44.1	100	10
45.4	100	02
45.8	100	10
46.4	100	12
52.0	100	10
52.0	100	01
60.1	100	10
60.1	100	02
66.8	100	11
68.7	100	02
68.7	100	10
76.6	100	02
76.8	100	10
77.9	100	11
81.1	100	02

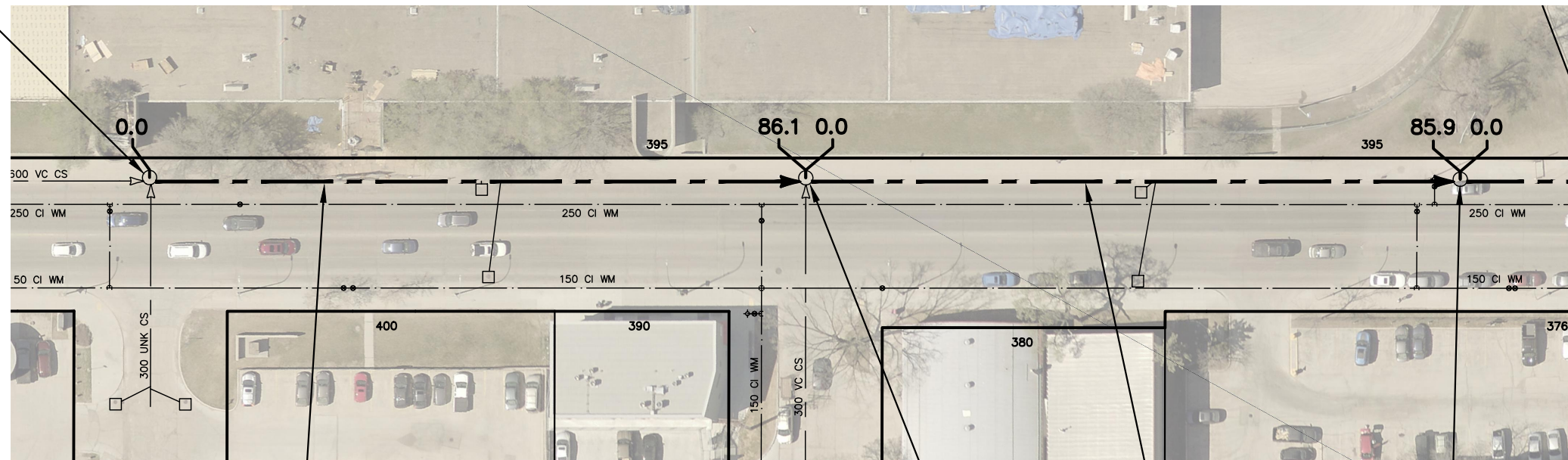

FOR CONTINUATION  
SEE DWG 12373

SEWER JUNCTION INFORMATION FROM SEWER VIDEO INSPECTION SEWER ID S-MA60009309		
DISTANCE FROM MH ID S-MH60007766		
DISTANCE	DIAMETER	CLOCK
17.4	150	10
17.4	150	02
25.8	150	02
25.8	150	10
33.3	150	10
33.3	150	02
41.7	150	10
41.7	150	02
43.3	150	02
43.5	150	10
50.4	150	10
50.4	150	02
58.4	150	10
58.4	150	02
66.5	150	10
66.5	150	02
70.7	100	11
74.8	150	10
74.8	150	02
78.4	200	10

86.1 OF 600 CLAY CS TO BE LINED  
S-MA60009357  
(FULLY DETERIORATED)

S-MH60007766  
RIM 232.00  
INV E 225.88  
INV S 225.80  
INV N 225.77

85.9 OF 600 CLAY CS TO BE LINED  
S-MA60009309  
(FULLY DETERIORATED)

S-MH60007697  
RIM 231.96  
INV S 225.51  
INV N 225.50

TOGO AVE

DON AVE

### WARNING

IF POWER EQUIPMENT OR EXPLOSIVES ARE TO BE USED FOR EXCAVATION ON THIS PROJECT THE CONTRACTOR MUST:

- 1) NOTIFY THE GAS COMPANY OF THE PROPOSED LOCATION OF EXCAVATION.
- 2) TAKE PRECAUTION TO AVOID DAMAGE TO GAS COMPANY INSTALLATIONS.

SEE PROVINCIAL REGULATION 210/72 FOR DETAILS

FOR INDEX SEE  
12361

### METRIC

WHOLE NUMBERS INDICATE MILLIMETRES  
DECIMALIZED NUMBERS INDICATE METRES

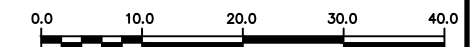

LOCATION APPROVED UNDERGROUND STRUCTURES  SUPV. U/G STRUCTURES COMMITTEE _____ DATE _____  NOTE: LOCATION OF UNDERGROUND STRUCTURES AS SHOWN ARE BASED ON THE BEST INFORMATION AVAILABLE BUT NO GUARANTEE IS GIVEN THAT ALL EXISTING UTILITIES ARE SHOWN OR THAT THE GIVEN LOCATIONS ARE EXACT. CONFIRMATION OF EXISTENCE AND EXACT LOCATION OF ALL SERVICES MUST BE OBTAINED FROM THE INDIVIDUAL UTILITIES BEFORE PROCEEDING WITH CONSTRUCTION.	B.M. ELEV.		ENGINEER'S SEAL  ORIGINAL SIGNED BY H.A. KATZ 2020 03 02	 <b>THE CITY OF WINNIPEG</b> WATER AND WASTE DEPARTMENT ENGINEERING DIVISION  <b>2020 SEWER RENEWALS BY CIPP LINING (LARGE DIAMETER)</b> <b>CONTRACT 3</b> <b>OSBORNE STREET</b> MH AT TOGO AVENUE TO 1ST MH N OF DON AVENUE	SHEET <b>13</b> OF <b>17</b> CITY DRAWING NUMBER  <b>12372</b>
NO. REVISIONS YY/MM/DD BY DATE 2019/12/16		TENDER NUMBER: 43-2020 CONTRACT NUMBER: 3		FILE PATH: P:\2019\190569500-924-2019 - Winnipeg 2019 Sewer Rene\09. CAD\07 Sheets\ FILE NAME: 13 OSBORNE 1.dwg	