

- NOTES:
1. THE CONTRACTOR TO MATCH EXISTING RADII FOR CURB RENEWAL AS DIRECTED BY THE CONTRACT ADMINISTRATOR.
 2. MINIMUM CURB REVEAL TO BE 100mm.
 3. ADJUST ALL WATER VALVES, MANHOLES, AND CATCH BASINS TO GRADE.
 4. THE CONTRACTOR IS RESPONSIBLE FOR ALL UTILITY LOCATES.
 5. THE CONTRACTOR SHALL PROTECT ANY GEODETIC MONUMENTS WITHIN THE PROJECT LIMITS. IF MONUMENTS CANNOT BE AVOIDED THE CONTRACTOR IS RESPONSIBLE FOR NOTIFYING THE CITY OF WINNIPEG GEOMATICS AND LAND INFORMATION SERVICES BRANCH PRIOR TO ANY REMOVAL OR ADJUSTMENT TO THE PROPERTY BAR. DOCUMENTATION SHALL BE SUBMITTED TO THE CONTRACT ADMINISTRATOR PRIOR TO STARTING THE WORK.
 6. RENEW PRIVATE APPROACHES AS INDICATED IN THE PLANS.
 7. THE CONTRACTOR SHALL SET SUFFICIENT GEODETIC CONTROL TO ENSURE MINIMUM GRADES CAN BE ACHIEVED.
 8. AVERAGE ASPHALT THICKNESS TO BE 80mm
 9. FOR CB LEADS AND UNDERGROUND INFO SEE SHEETS 22 TO 28.

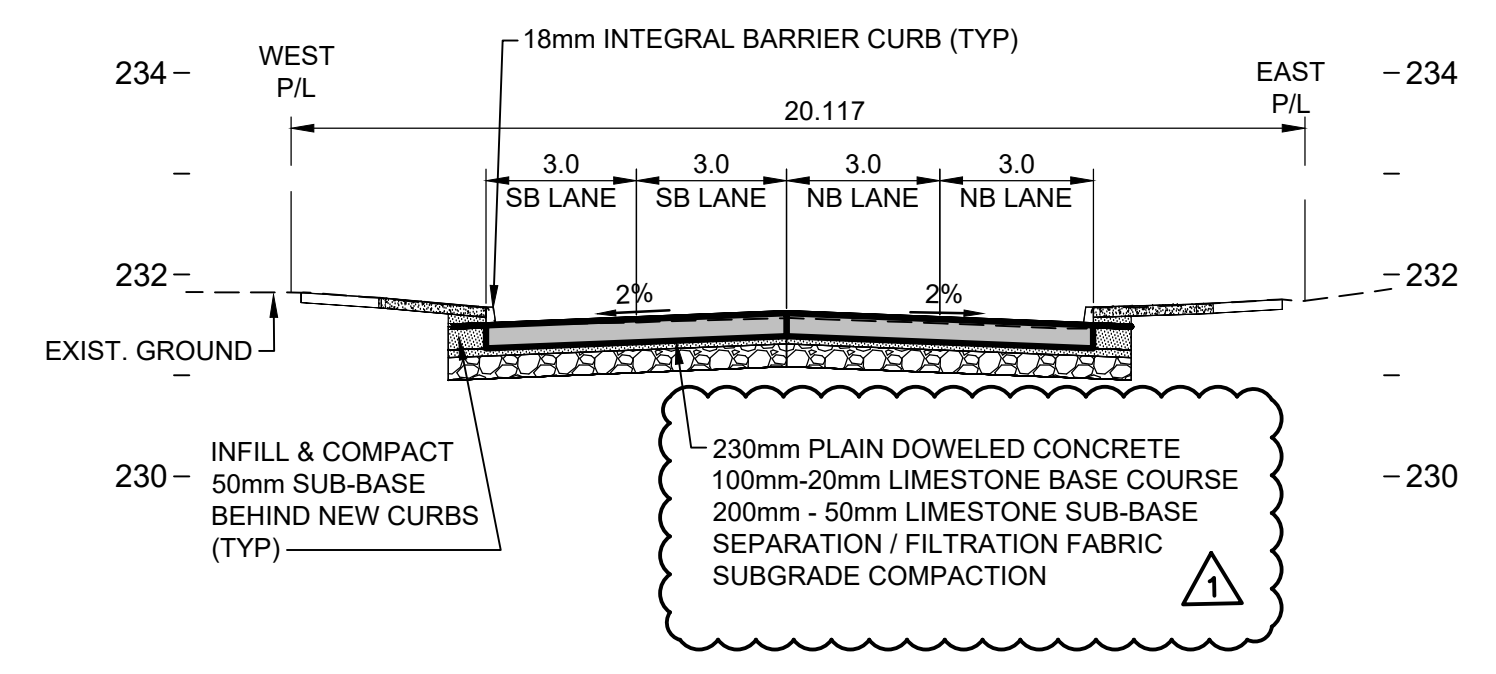
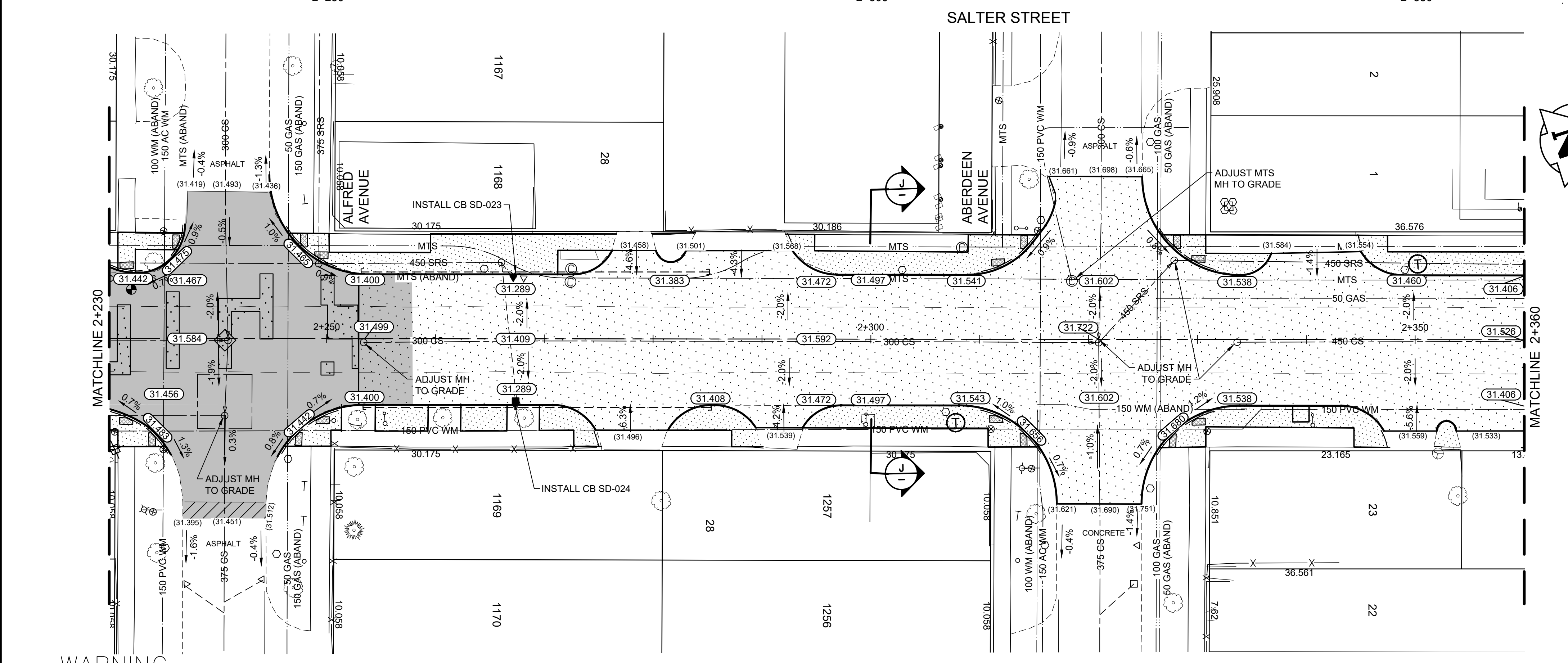

J SECTION AT STA 2+300
1:150 H 1:75 V

WARNING
IF POWER EQUIPMENT OR EXPLOSIVES ARE TO BE USED FOR EXCAVATION ON THIS PROJECT THE CONTRACTOR MUST:

- 1) NOTIFY THE GAS COMPANY OF THE PROPOSED LOCATION OF EXCAVATION.
 - 2) TAKE PRECAUTION TO AVOID DAMAGE TO GAS COMPANY INSTALLATIONS.
- SEE PROVINCIAL REGULATION 140/92 FOR DETAILS

METRIC
WHOLE NUMBERS INDICATE MILLIMETRES
DECIMALIZED NUMBERS INDICATE METRES

EXISTING	LEGEND-PLAN	PROPOSED	EXISTING	LEGEND-PLAN	PROPOSED	EXISTING	LEGEND-PROFILE	PROPOSED
150 WM	WATERMAIN	150 WM	150 WM	HYDRO	150 WM	---	PROFILE	---
300 LIDS	HYDRANT	300 LIDS	---	M.T.S.	---	---	WEST GUTTER	---
300 LIDS	VALVE	300 LIDS	---	CONCRETE	---	---	EAST GUTTER	---
300 LIDS	LAND DRAINAGE SEWER	300 LIDS	---	ASPHALT	---	---	WEST MEDIAN GUTTER	---
250 WWS	WASTE WATER SEWER	250 WWS	---	SIDEWALK	---	---	EAST MEDIAN GUTTER	---
---	MANHOLE	---	---	ASPHALT MILL & FILL	---	---	WEST P	---
---	CATCH BASIN	---	---	GLASGRID	---	---	EAST P	---
---	CURB INLET/CATCH PIT	---	---	STREET LIGHT	---	---	---	---
---	TRANSIT STOP	---	---	HYDRO POLE	---	---	---	---
---	GAS	---	---	SURVEY BAR	---	---	---	---
---	PROPERTY LINE	---	---	ELEVATION	---	---	---	---
---	LEGEND-PLAN	---	---	LEGEND-PLAN	---	---	---	---

LOCATION APPROVED UNDERGROUND STRUCTURES
SUPV. U/G STRUCTURES COMMITTEE DATE _____

NOTE:
LOCATION OF UNDERGROUND STRUCTURES AS SHOWN ARE BASED ON THE BEST INFORMATION AVAILABLE BUT NO GUARANTEE IS GIVEN THAT ALL EXISTING UTILITIES ARE SHOWN OR THAT THE GIVEN LOCATIONS ARE EXACT. CONFIRMATION OF EXISTENCE AND EXACT LOCATION OF ALL SERVICES MUST BE OBTAINED FROM THE INDIVIDUAL UTILITIES BEFORE PROCEEDING WITH CONSTRUCTION.

NO.	REVISIONS	DATE	BY
1	ADDENDUM No 1	20.12.07	S.R.S.
0	ISSUED FOR TENDER	20.11.20	S.R.S.

Stantec
500 - 311 Portage Avenue, Winnipeg MB Canada
www.stantec.com

DESIGNED BY	T.G.	CHECKED BY	S.R.S.
DRAWN BY	T.G.	APPROVED BY	S.R.S.
HOR. SCALE:	1:250	RELEASED FOR CONSTRUCTION:	
VERTICAL:	1:10	DATE	20.05.26

PRELIMINARY DRAWING
NOT TO BE USED FOR CONSTRUCTION
CONSULTANT DRAWING NO. C-209

THE CITY OF WINNIPEG
PUBLIC WORKS DEPARTMENT
ENGINEERING DIVISION

2021 SALTER ST. - PAVEMENT RENEWALS
SLAW REBCHUK BRIDGE TO CATHEDRAL AVENUE
SALTER STREET
STA 2+230 TO STA 2+360
PLAN / PROFILE / SECTION

SHEET	OF
13	28
CAD FILE DRAWING NUMBER	08150c-209.dwg
CITY DRAWING NUMBER	P-3532-13

ENGINEERS GEOSCIENTISTS MANITOBA
Certificate of Authorization
Stantec Consulting Ltd.
No. 1301

V:\1171\2021\1171081\0300_drawing\0302_sheet_files\02_civil\08150c-209.dwg 2021/12/07 10:41:34 AM