

D SIZE 22" x 34" (559mm x 864mm)

PLOT: 10/20/2020 2:17:13 PM

AECOM REVIEW DRFT CHK
AECOM FILE NAME: 60622950-SHT-00-0000-C-1004.dwg Saved By: ccooperkl

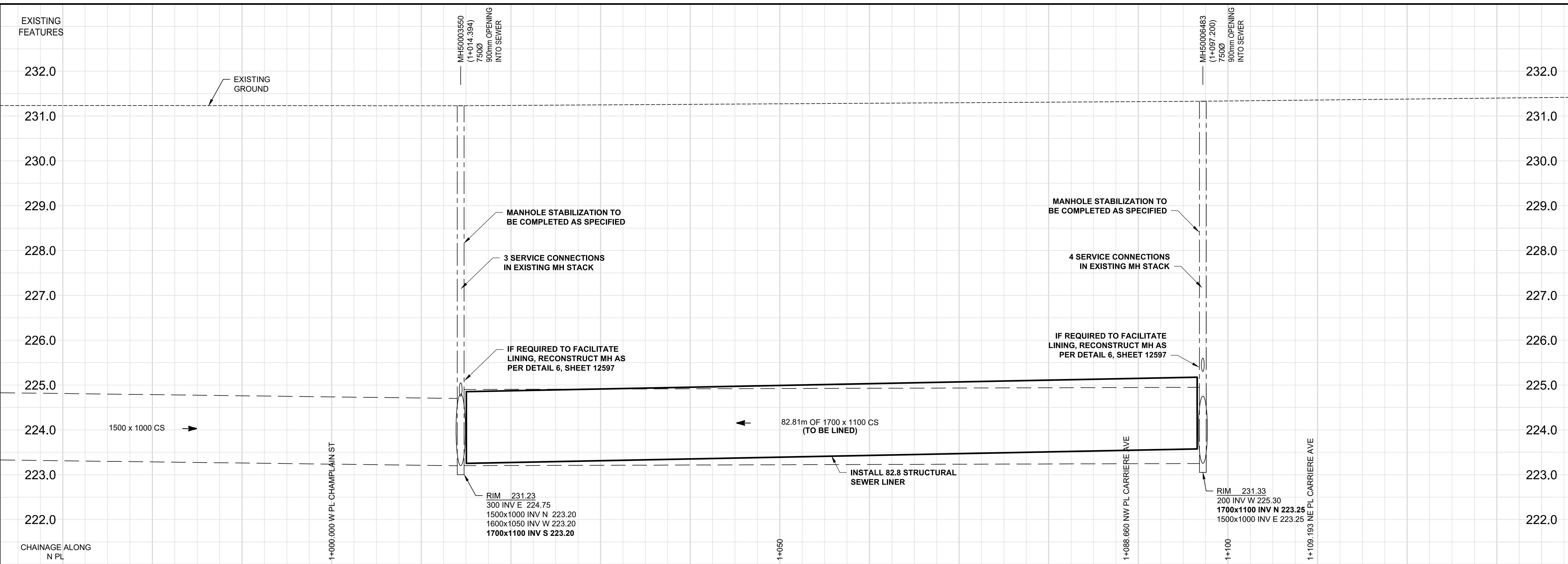

SEWER JUNCTION INFORMATION

SERVICE COUNT	STATION	CLOCK
1	1090.6	10
2	1089.8	2
3	1081.0	2
4	1078.0	10
5	1071.2	2
6	1061.0	2
7	1055.7	10
8	1047.3	10
9	1047.3	2
10	1040.6	2
11	1032.2	10
12	1032.2	12
13	1030.3	11
14	1025.0	11
15	1025.0	1
16	1016.2	10

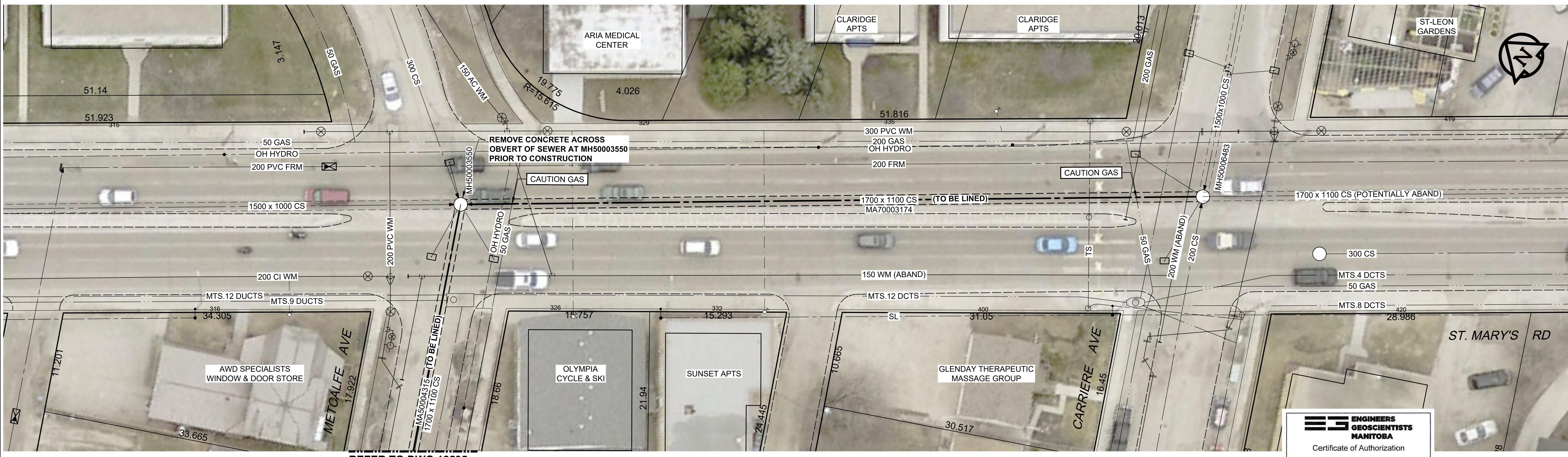

SEWER REHABILITATION NOTES:

- INSTALL ONE OF THE FOLLOWING REHABILITATION SYSTEMS:
 - CIPP
 - GRP
 - CCCP
- EXISTING SEWER DETERIORATION STATE:
 - MA70003174 - PARTIALLY DETERIORATED
- MINIMUM POST LINING DIMENSIONS:
 - MA70003174 - 1487mm x 887mm
- EXTEND REHABILITATION SYSTEM TO THE EDGE OF THE EXISTING MANHOLE OPENINGS AS SHOWN IN DETAIL 2, SHEET 12597
- CIPP REHABILITATION SHALL UTILIZE A PIPE ACCESS SHAFT AT ONE OF THE EXISTING MANHOLES, IF REQ'D
- GRP AND CCCP REHABILITATION MAY UTILIZE A PIPE ACCESS SHAFT AT EITHER OF THE EXISTING MANHOLES OR AT A MID POINT.
- SEE PIPELINE CLOSURE AND MANHOLE RECONSTRUCTION DETAILS ON SHEET 12597

GENERAL CONSTRUCTION NOTES:

- RESTORE SITE TO EXISTING CONDITIONS UPON COMPLETION OF WORK
- TRAFFIC CONTROL
 - REGIONAL STREET LANE CLOSURE REQUIRED: YES
 - IMPACTED REGIONAL STREET: ST. MARY'S ROAD
 - BUS ROUTE
 - MAINTAIN MINIMUM ONE LANE OF TRAFFIC IN BOTH DIRECTIONS ON ST. MARY'S ROAD AT ALL TIMES.

METRIC
WHOLE NUMBERS INDICATE MILLIMETRES
DECIMALIZED NUMBERS INDICATE METRES

REFER TO DWG 12595 FOR SEWER MA50004315

EXISTING	LEGEND - PLAN	NEW	EXISTING	LEGEND - PROFILE	NEW	EXISTING	LEGEND - PROFILE	NEW
150 WM	WATERMAIN	150 WM	150 WM	WATERMAIN	150 WM	300 LDS	LAND DRAINAGE SEWER	300 LDS
300 LDS	LAND DRAINAGE SEWER	300 LDS	300 LDS	LAND DRAINAGE SEWER	300 LDS	250 WWS	WASTE WATER SEWER	250 WWS
250 WWS	WASTE WATER SEWER	250 WWS	250 WWS	WASTE WATER SEWER	250 WWS	○	MANHOLE	○
○	MANHOLE	○	○	MANHOLE	○	□	CATCH BASIN	□
□	CATCH BASIN	□	□	CATCH BASIN	□	△	CURB INLET	△
△	CURB INLET	△	△	CURB INLET	△	▭	CULVERT	▭
▭	CULVERT	▭	▭	CULVERT	▭	—	PIPE ABANDONMENTS	—
—	PIPE ABANDONMENTS	—	—	PIPE ABANDONMENTS	—	+	SURVEY BAR	+
+	SURVEY BAR	+	+	SURVEY BAR	+	—	EXISTING	—
—	EXISTING	—	—	EXISTING	—	—	LEGEND - PLAN	—
—	LEGEND - PLAN	—	—	LEGEND - PLAN	—	—	LEGEND - PROFILE	—
—	LEGEND - PROFILE	—	—	LEGEND - PROFILE	—	—	LEGEND - PROFILE	—

LOCATION APPROVED
UNDERGROUND STRUCTURES

SUPR. U/G STRUCTURES DATE COMMITTEE

NOTE:
LOCATION OF UNDERGROUND STRUCTURES AS SHOWN ARE BASED ON THE BEST INFORMATION AVAILABLE. BUT NO GUARANTEE IS GIVEN THAT ALL EXISTING UTILITIES ARE SHOWN OR THAT THE GIVEN LOCATIONS ARE EXACT. CONFIRMATION OF EXISTENCE AND EXACT LOCATION OF ALL SERVICES MUST BE OBTAINED FROM THE INDIVIDUAL UTILITIES BEFORE PROCEEDING WITH CONSTRUCTION.

NO.	REVISIONS	Y/M/D	BY
0	ISSUED FOR CONSTRUCTION	20/10/16	KLC

AECOM

DESIGNED BY: TJB
CHECKED BY: CCM

DRAWN BY: KLC
APPROVED BY: KWF

HOR. SCALE: 1:250
VERT. SCALE: 1:50

RELEASED FOR CONSTRUCTION
DATE: Oct 16/20

PROFESSIONAL'S SEAL

ENGINEERS GEOSCIENTISTS MANITOBA

Certificate of Authorization
AECOM Canada Ltd.
No. 4671 Date: Oct 20/20

THE CITY OF WINNIPEG
WATER AND WASTE DEPARTMENT

2020 TRENCHLESS REHABILITATION OF NON-CIRCULAR COMBINED SEWERS
CONTRACT 2
PLAN / PROFILE
ST MARY'S ROAD
METCALFE AVENUE TO CARRIERE AVENUE

SHEET 5 OF 6
CITY DRAWING NUMBER
12596
REV 0

TENDER NO. 459-2020