

- CONSTRUCTION NOTES:**
- ALL WORK AND MATERIALS TO BE IN ACCORDANCE WITH LATEST REVISION OF THE CITY OF WINNIPEG STANDARD CONSTRUCTION SPECIFICATIONS.
 - LEGAL PLAN AND UNDERGROUND INFORMATION FROM CITY OF WINNIPEG LBIS. CONTRACTOR TO VERIFY ALL UNDERGROUNDS IN THE FIELD.
 - CONTRACTOR TO TAKE PRECAUTIONARY STEPS TO AVOID DAMAGE FROM CONSTRUCTION ACTIVITIES TO TREES WITHIN THE LIMITS OF CONSTRUCTION.
 - LOCATION OF EXISTING SERVICES TO BE CONFIRMED IN THE FIELD BY THE CONTRACTOR.
 - INSTALL CB LEADS AT MIN 1% SLOPE OR AS DIRECTED BY THE CONTRACT ADMINISTRATOR.

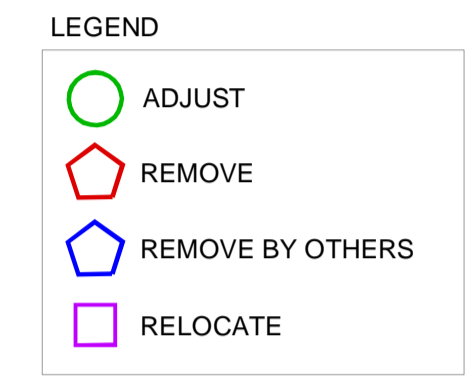

BORE HOLE LOCATIONS

TEST HOLE ID	NORTHING	EASTING
18	5522105.031	635637.483
19	5522102.989	635652.502

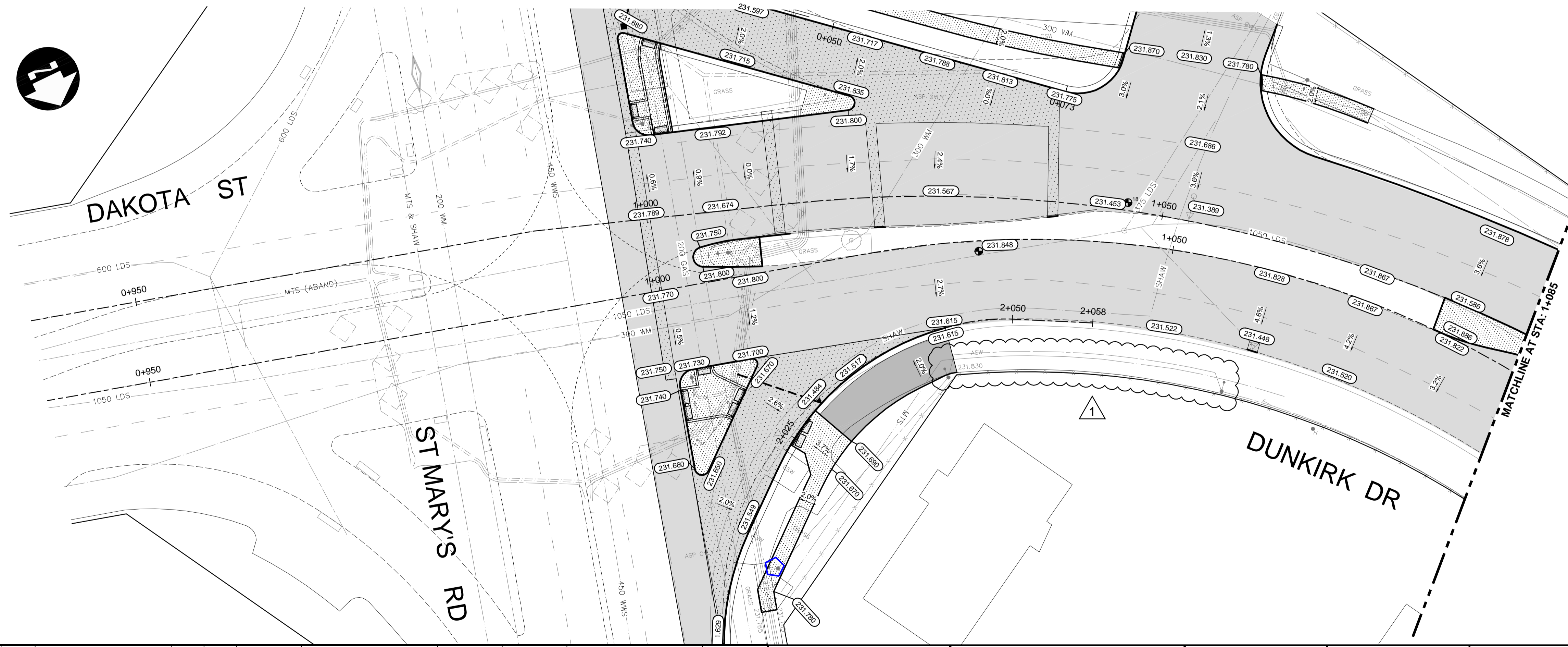

- ABBREVIATIONS:**
- CONC CONCRETE ROADWAY
 - ASP ASPHALT ROADWAY
 - ASP OVLY ASPHALT OVERLAY ROADWAY
 - GRAN GRANULAR ROADWAY
 - PVS PAVING STONE/BRICK
 - CSW CONCRETE SIDEWALK
 - ASW ASPHALT SIDEWALK
 - GSW GRANULAR SIDEWALK
 - TYP TYPICAL
 - EX EXISTING
 - MH MANHOLE
 - VV WATER VALVE
 - EL ELEVATION
 - CB CATCH BASIN
 - CP CATCH PIT
 - CI CURB INLET
 - CL CONTROL LINE

METRIC

WHOLE NUMBERS INDICATE MILLIMETRES
DECIMAL NUMBERS INDICATE METRES

WARNING

IF POWER EQUIPMENT OR EXPLOSIVES ARE TO BE USED FOR EXCAVATION ON THIS PROJECT THE CONTRACTOR MUST:

- NOTIFY THE GAS COMPANY OF THE PROPOSED LOCATION OF EXCAVATION.
- TAKE PRECAUTION TO AVOID DAMAGE TO GAS COMPANY INSTALLATIONS SEE PROVINCIAL REGULATION 210/72 FOR DETAILS.
- OBTAIN EXCAVATION PERMITS PRIOR TO CONSTRUCTION.

APEGM
Certificate of Authorization
Dillon Consulting Limited (MB)
No. 1789 Date: 20/12/03

C:\pwworking\directory\projects\2020_40\p\18155\202434-DUN-CI-CON-PLAN-PROFILE.dwg

EXISTING	LEGEND-PLAN	PROPOSED	EXISTING	LEGEND-PLAN	PROPOSED	EXISTING	LEGEND-PROFILE	PROPOSED
	HYDRANT			CONCRETE			WATERMAIN	
	VALVE			ASPHALT			LAND DRAINAGE SEWER	
	MANHOLE			SIDEWALK			WASTE WATER SEWER	
	CATCH BASIN			PAVING STONES			HYDRANT	
	CATCH PIT			PAVEMENT REPAIR FABRIC			VALVE	
	WATERMAIN			PROPERTY LINE			PROFILE	
	LAND DRAINAGE SEWER			ELEVATION			NORTH/WEST GUTTER	
	WASTE WATER SEWER			TRAFFIC SIGNAL			SOUTH/EAST GUTTER	
	HYDRO			SURVEY BAR			NORTH/WEST DITCH	
	M.T.S.			CURB RAMP			SOUTH/EAST DITCH	
	GAS			DETECTABLE TILE				

UNDERGROUND STRUCTURES
UGS APPROVED - NOVEMBER 20, 2020

LOCATION OF UNDERGROUND STRUCTURES AS SHOWN ARE BASED ON THE BEST INFORMATION AVAILABLE, BUT NO GUARANTEE IS GIVEN THAT ALL EXISTING UTILITIES ARE SHOWN OR THAT THE GIVEN LOCATIONS ARE EXACT. CONFIRMATION OF EXISTENCE AND EXACT LOCATION OF ALL SERVICES MUST BE OBTAINED FROM THE INDIVIDUAL UTILITIES BEFORE PROCEEDING WITH CONSTRUCTION.

B.M. ELEV.	NO.	REVISIONS	DATE	BY
	1	ISSUED FOR ADDENDUM #2	20/12/16	DBW
	0	ISSUED FOR TENDER	20/12/03	DBW

DESIGNED BY	DRAWN BY	CHECKED BY	APPROVED BY	HOR. SCALE	VERTICAL
RTP/PMW	PMW	TCS	DBW	1:250	1:10

DILLON CONSULTING

RELEASED FOR CONSTRUCTION

DATE

ENGINEER'S SEAL

TENDER DRAWING

NOT TO BE USED FOR CONSTRUCTION

CONSULTANT PROJECT NUMBER
20-2434

THE CITY OF WINNIPEG
PUBLIC WORKS DEPARTMENT

Winnipeg

2021-2023 REGIONAL PAVEMENT RENEWAL PROJECT
DUNKIRK DRIVE REHABILITATION
ST MARY'S ROAD TO FERMOR AVENUE

CITY DRAWING NUMBER
P-3537-2021-03

SHEET **03** OF **28**

CONSULTANT DRAWING NUMBER

PLAN PROFILE (START TO STA 1+085)