

**GEOTECHNICAL (2020 / 2021 WINTER WORKS)**  
 (TEMPORARY ACCESS, RIPRAP, SHEAR KEYS AND OFFLOADING)  
 (STAGING DETAILS SEE DWG GE-05)

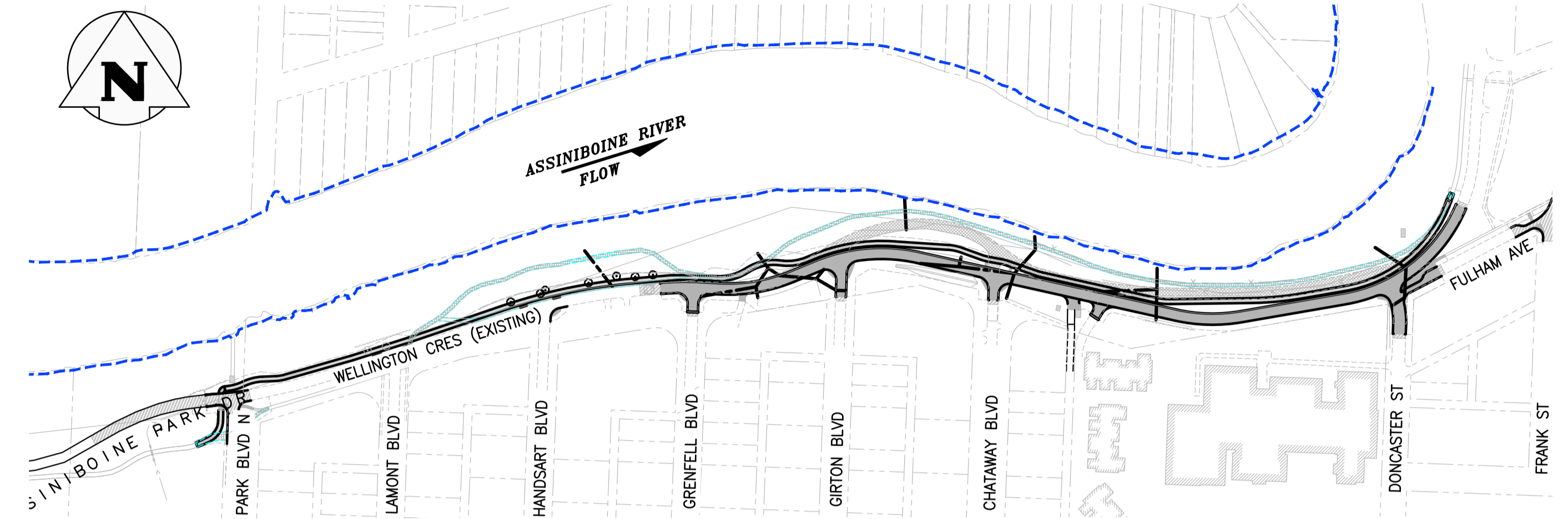

**PATH AND ROADWAY (2021 SUMMER WORKS)**  
 (ROAD AND MUP REALIGNMENT)  
 (STAGING DETAILS SEE DWG GE-07 AND GE-08)



**UNDERGROUND (2020 / 2021 WINTER WORKS)**  
 (OUTFALLS, SEWER AND WATER)  
 (STAGING DETAILS SEE DWG GE-06)



**LANDSCAPE (2021 SUMMER WORKS)**  
 (RESTORATION, WILDERNESS TRAILS, TENSION CRACK SEALING, DRAINAGE IMPROVEMENTS AND ENHANCEMENT)  
 (STAGING DETAILS SEE DWG GE-09)

**METRIC**  
 WHOLE NUMBERS INDICATE MILLIMETRES  
 DECIMALIZED NUMBERS INDICATE METRES

**PROPERTY LIMITS DELINEATION**  
 DELINEATION OF PROPERTY LIMITS AS SHOWN ON THIS DWG DOES NOT REPRESENT A "LEGAL SURVEY". KGS GROUP MAKES NO REPRESENTATION OR WARRANTY AS TO THE ACCURACY OF PROPERTY LIMITS DELINEATED ON THIS DWG, NOR ON THE DIMENSIONAL ACCURACY OF DWG FEATURES RELATIVE TO THOSE PROPERTY LIMITS.

**WARNING**  
 1. NOTIFY THE GAS COMPANY OF THE PROPOSED LOCATION OF EXCAVATION.  
 2. TAKE PRECAUTION TO AVOID DAMAGE TO GAS COMPANY INSTALLATIONS.  
 3. SEE PROVINCIAL REGULATION 210/72 FOR DETAILS.

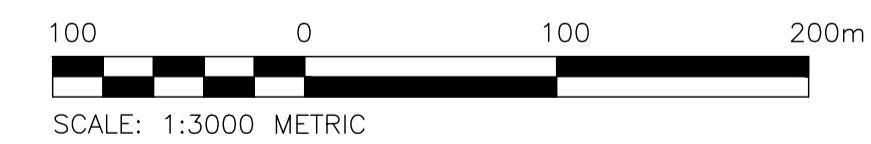

File: P:\Projects\2018\18-0107-011\DWG\Geo\18-0107-011\_GE-04 - Tab1Rev1 Plotted By: PDefner 20/10/14 [Wed 3:20pm]  
 1:1 (Scale)

300 LBS	LAND DRAINAGE SEWER	300 LBS	- - x - -	FENCE				
250 WWS	WASTE WATER SEWER	250 WWS	+	TEST HOLE				
	GAS		—	GUY WIRE				
	HYDRO		••	LIGHT STANDARD				
	M.T.S.		—	BACK OF CURB				
150 WM	WATERMAIN	150 WM	—	CONCRETE	—	—	—	—
+	HYDRANT		+	ASPHALT	—	—	—	—
⊗	VALVE		⊗	SIDEWALK	—	—	—	—
○	MANHOLE		○	PROPERTY LINE	—	—	—	—
□	CATCH BASIN		+	SURVEY BAR	—	—	—	—
▽	CURB INLET		⊙	GEODETIC BENCHMARK	—	—	—	—
•	POLES		231.33	ELEVATION	(232.231)	TTTTT		
EXISTING	LEGEND-PLAN	PROPOSED	EXISTING	LEGEND-PLAN	PROPOSED	EXISTING	LEGEND-PROFILE	PROPOSED

**LOCATION APPROVED UNDERGROUND STRUCTURES**

SUPV. U/G STRUCTURES DATE COMMITTEE

NOTE:  
 LOCATION OF UNDERGROUND STRUCTURES AS SHOWN ARE BASED ON THE BEST INFORMATION AVAILABLE BUT NO GUARANTEE IS GIVEN THAT ALL EXISTING UTILITIES ARE SHOWN OR THAT THE GIVEN LOCATIONS ARE EXACT. CONFIRMATION OF EXISTENCE AND EXACT LOCATION OF ALL SERVICES MUST BE OBTAINED FROM THE INDIVIDUAL UTILITIES BEFORE PROCEEDING WITH CONSTRUCTION.

B.M.	KGS_BASE		
ELEV.	249.221		
NO.	REVISIONS	DATE	BY
1	RE-ISSUED FOR TENDER	20/10/15	BPA
0	ISSUED FOR TENDER	20/10/05	BPA

		ENGINEER'S SEAL	
		DESIGNED BY: CMR	CHECKED BY: BPA
DRAWN BY: TVW		APPROVED BY: BPA	
HOR. SCALE: AS NOTED		RELEASED FOR CONSTRUCTION:	
VERTICAL:		DATE:	

CONSULTANT DRAWING NO.  
**GE-04**

**THE CITY OF WINNIPEG**  
 PUBLIC WORKS DEPARTMENT  
 ENGINEERING DIVISION

PROJECT TITLE:  
**WELLINGTON CRESCENT RIVERBANK,  
 PATH AND ROADWAY PROJECT**

**GENERAL**  
 CONSTRUCTION STAGING - OVERVIEW  
 (SHEET 1 OF 6)

SHEET **4** OF **69**  
 COMPUTER FILE NAME:  
 18-0107-011\_GE-04  
 CITY DRAWING NUMBER:  
**P-3536-04**