

C:\USERS\WFOK\SCATLIFF + MILLER + MURRAY\WARREN WYSZOMIRSKI - ONEDRIVE_SERVER\PROJECTS\PROJECTS\2020 WELLINGTON CRESCENT\LANDSCAPE-WORKING.DWG

PLANT SCHEDULE

QTY.	COMMON NAME	BOTANICAL NAME	SIZE AND REMARKS (shown are minimum specifications)	SPACING
DECIDUOUS TREES				
72	MANITоба MAPLE	<i>Acer negundo</i>	5 gal. Container Grown, 1.2m Height, Single Straight Trunk, 5 Major Branches.	AS SHOWN
65	OHIO BUCKEYE	<i>Aesculus glabra</i>	5 gal. Container Grown, 1.2m Height, Single Straight Trunk, 5 Major Branches.	AS SHOWN
80	HACKBERRY	<i>Celtis occidentalis</i>	5 gal. Container Grown, 1.2m Height, Single Straight Trunk, 5 Major Branches.	AS SHOWN
46	PLAINS COTTONWOOD	<i>Populus deltoides</i>	75mm Caliper, 4.0m Height, Single Straight Trunk, 10 Major Branches in Well Formed Head 1.75m Above Root Flare. Wire Basket, Machine Dug, Root Flare to be Visible.	AS SHOWN
78	BUR OAK	<i>Quercus macrocarpa</i>	5 gal. Container Grown, 1.2m Height, Single Straight Trunk, 5 Major Branches.	AS SHOWN
5	AMERICAN BASSWOOD	<i>Tilia americana</i>	65mm Caliper, 3.5m Height, Single Straight Trunk, 10 Major Branches in Well Formed Head 1.75m Above Root Flare. Wire Basket, Machine Dug, Root Flare to be Visible.	AS SHOWN
14	PRAIRIE EXPEDITION ELM	<i>Ulmus americana 'Lewis and Clark'</i>	65mm Caliper, 3.5m Height, Single Straight Trunk, 10 Major Branches in Well Formed Head 1.75m Above Root Flare. Wire Basket, Machine Dug, Root Flare to be Visible.	AS SHOWN
85	DISCOVERY ELM	<i>Ulmus davidiana ssp. Japonica 'Discovery'</i>	5 gal. Container Grown, 1.2m Height, Single Straight Trunk, 5 Major Branches.	AS SHOWN
CONIFEROUS TREES				
12	BLACK HILLS WHITE SPRUCE	<i>Picea glauca 'Densata'</i>	2.0m Height, Single Straight Leader. Well formed, Dense Bushy Growth Habit, Wire Basket, Machine Dug.	AS SHOWN
DECIDUOUS SHRUB				
80	RED OSIER DOGWOOD	<i>Cornus sericea</i>	#5 gal., Min. 400mm Height, Min. 3 Major Basal Branches. Well Formed, Bushy Plants, Vigorous Root System	AS SHOWN
40	BUSH HONEYSUCKLE	<i>Diervilla lonicera</i>	#5 gal., Min. 400mm Height, Min. 3 Major Basal Branches. Well Formed, Bushy Plants, Vigorous Root System	AS SHOWN
40	SMOOTH SUMAC	<i>Rhus glabra</i>	#5 gal., Min. 400mm Height, Min. 3 Major Basal Branches. Well Formed, Bushy Plants, Vigorous Root System	AS SHOWN
40	WILD BLACK CURRANT	<i>Ribes americanum</i>	#2 gal., Min. 400mm Height, Min. 3 Major Basal Branches. Well Formed, Bushy Plants, Vigorous Root System	AS SHOWN
20	RASPBERRY	<i>Rubus idaeus</i>	#2 gal., Min. 400mm Height, Min. 3 Major Basal Branches. Well Formed, Bushy Plants, Vigorous Root System	AS SHOWN
20	BUFFALOBERRY	<i>Shepherdia argentea</i>	#5 gal., Min. 400mm Height, Min. 3 Major Basal Branches. Well Formed, Bushy Plants, Vigorous Root System	AS SHOWN
80	WESTERN SNOWBERRY	<i>Symphoricarpos occidentalis</i>	#2 gal., Min. 400mm Height, Min. 3 Major Basal Branches. Well Formed, Bushy Plants, Vigorous Root System	AS SHOWN
40	NANNYBERRY (SHRUB FORM)	<i>Viburnum lentago</i>	#5 gal., Min. 400mm Height, Min. 3 Major Basal Branches. Well Formed, Bushy Plants, Vigorous Root System	AS SHOWN
40	HIGHBUSH CRANBERRY	<i>Viburnum trilobum</i>	#5 gal., Min. 400mm Height, Min. 3 Major Basal Branches. Well Formed, Bushy Plants, Vigorous Root System	AS SHOWN
VINES				
160	CLIMBING BITTERSWEET	<i>Celastrus scandens</i>	2 Year from Division No. 1 Grade. Well-Branched with not less than 3 Runners 500mm or more, Vigorous Root System	AS SHOWN
190	VIRGINIA CREEPER	<i>Parthenocissus quinquefolia</i>	2 Year from Division No. 1 Grade. Well-Branched with not less than 3 Runners 500mm or more, Vigorous Root System	AS SHOWN
130	WILD GRAPE	<i>Vitis riparia</i>	2 Year from Division No. 1 Grade. Well-Branched with not less than 3 Runners 500mm or more, Vigorous Root System	AS SHOWN

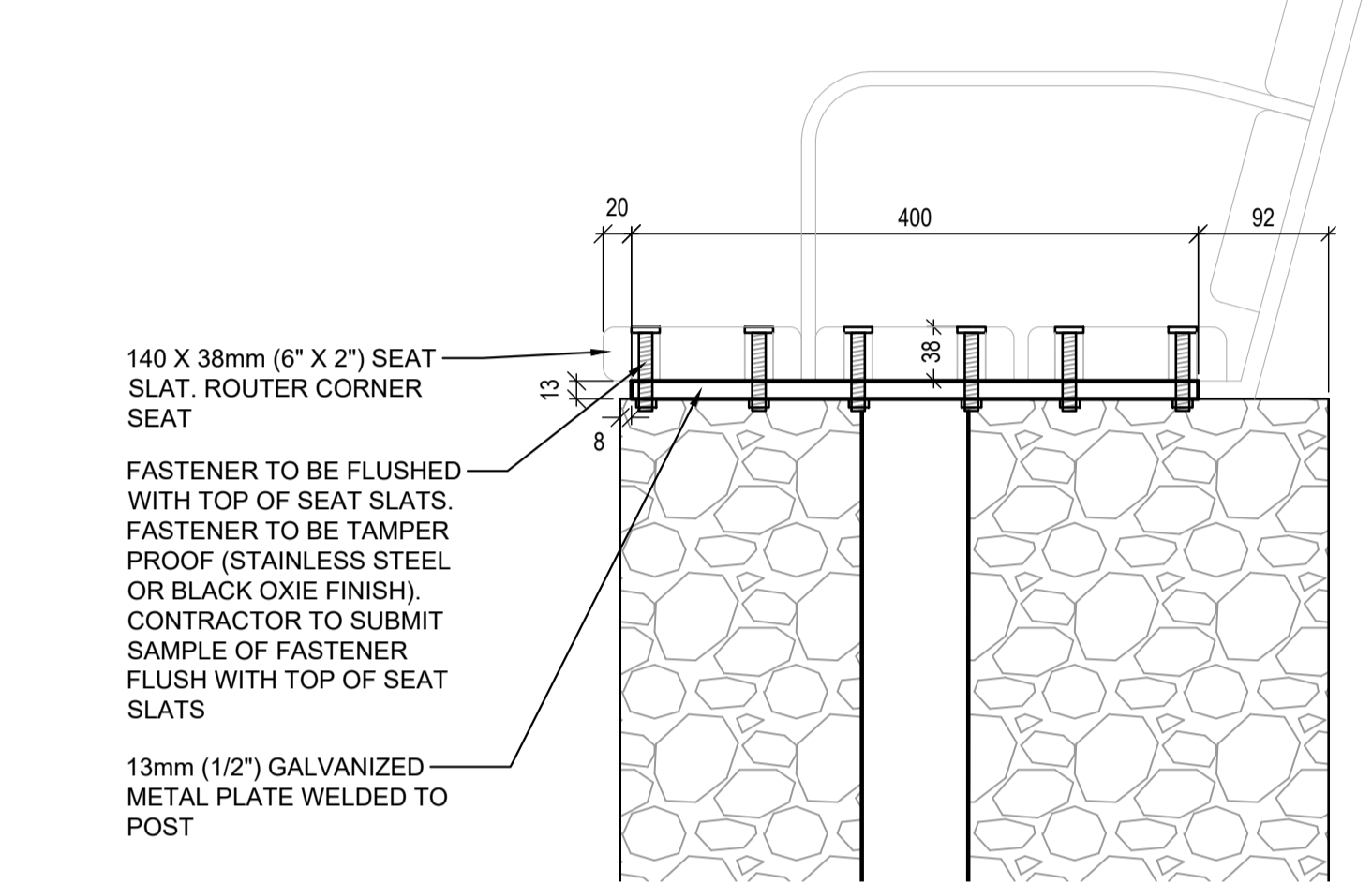
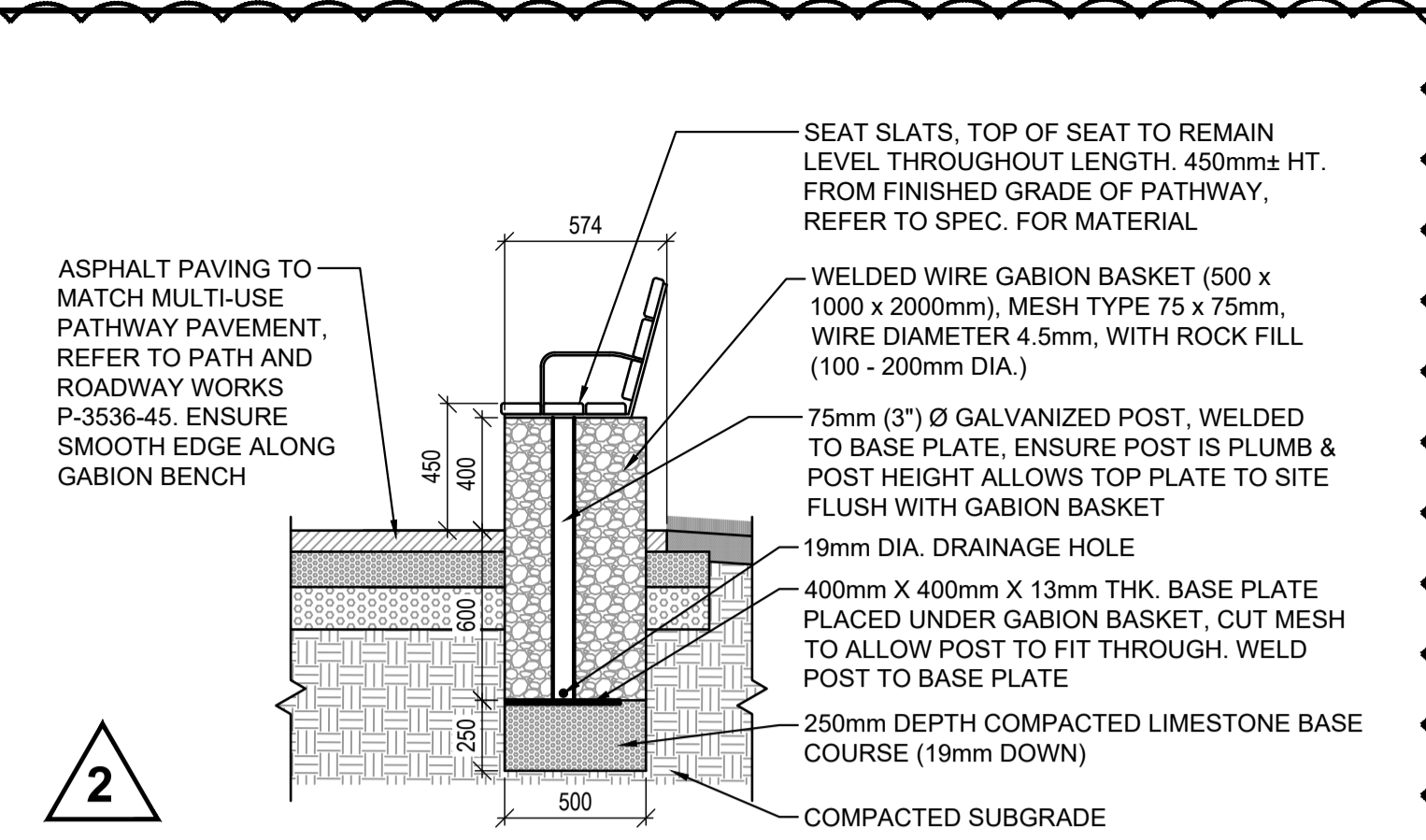
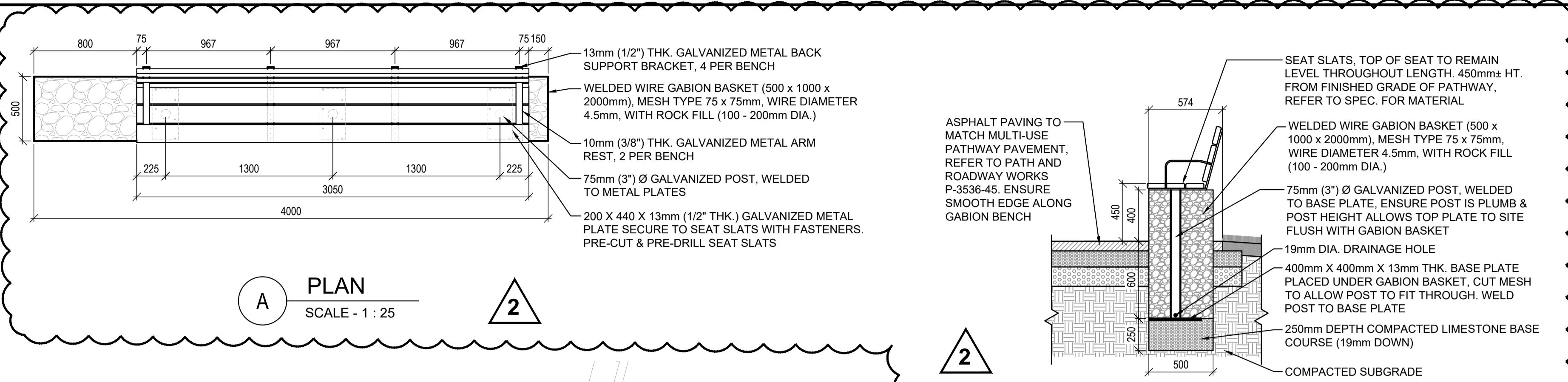

NOTES

- ALL FASTENERS TO BE CADMIUM PLATED AND GALVANIZED.
- CONTRACTOR TO SUBMIT SHOP DRAWINGS WITH ENGINEER STAMPS FOR ALL STRUCTURES AND FABRICATION FOR REVIEW AND APPROVAL BY CONTRACT ADMINISTRATOR PRIOR TO CONSTRUCTION.

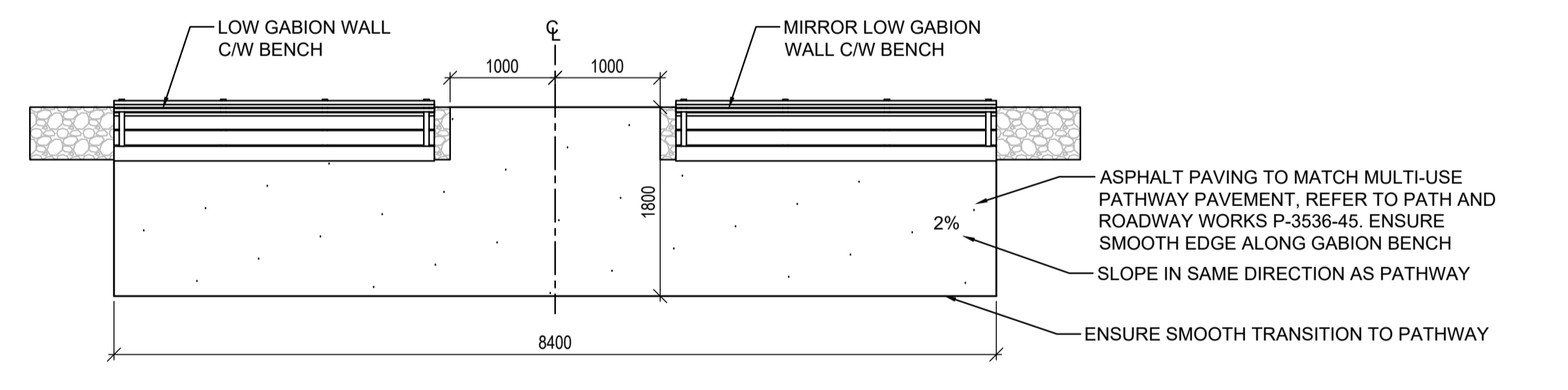
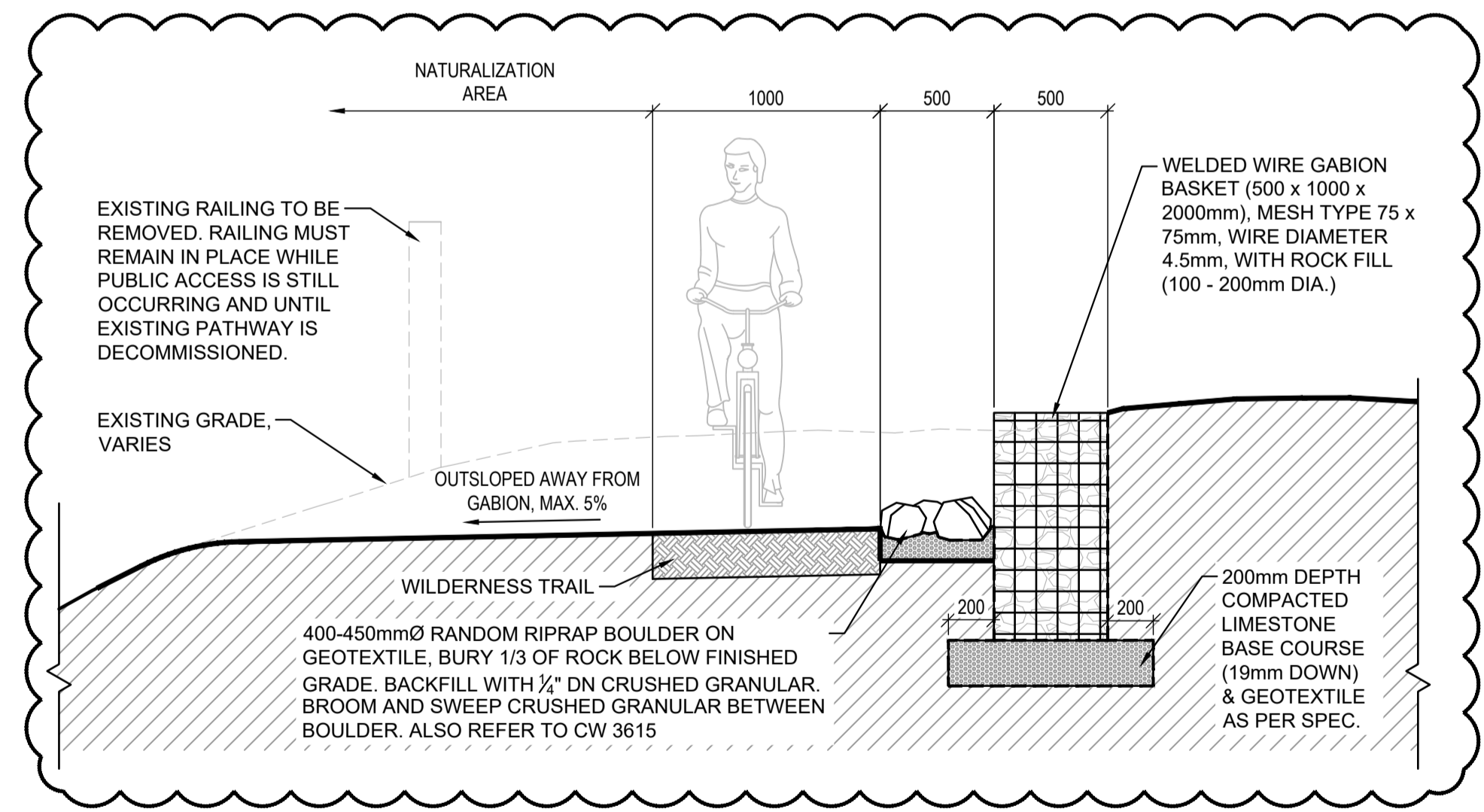
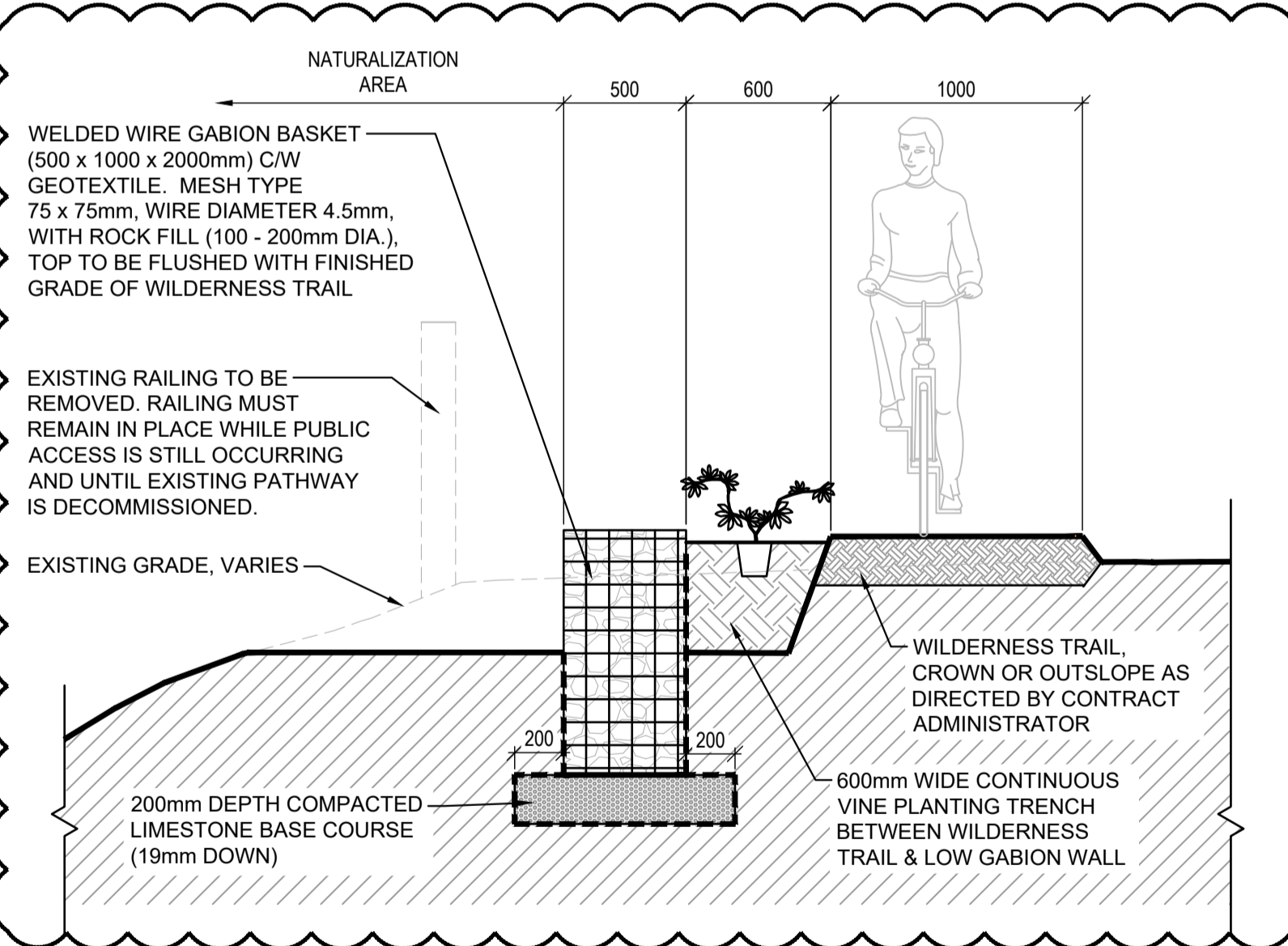
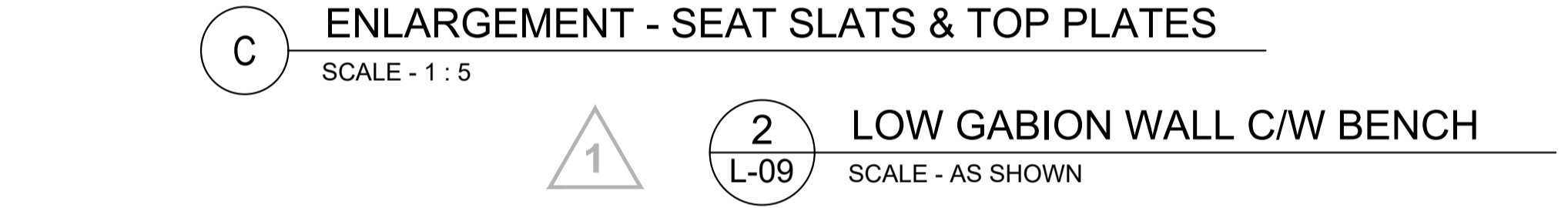
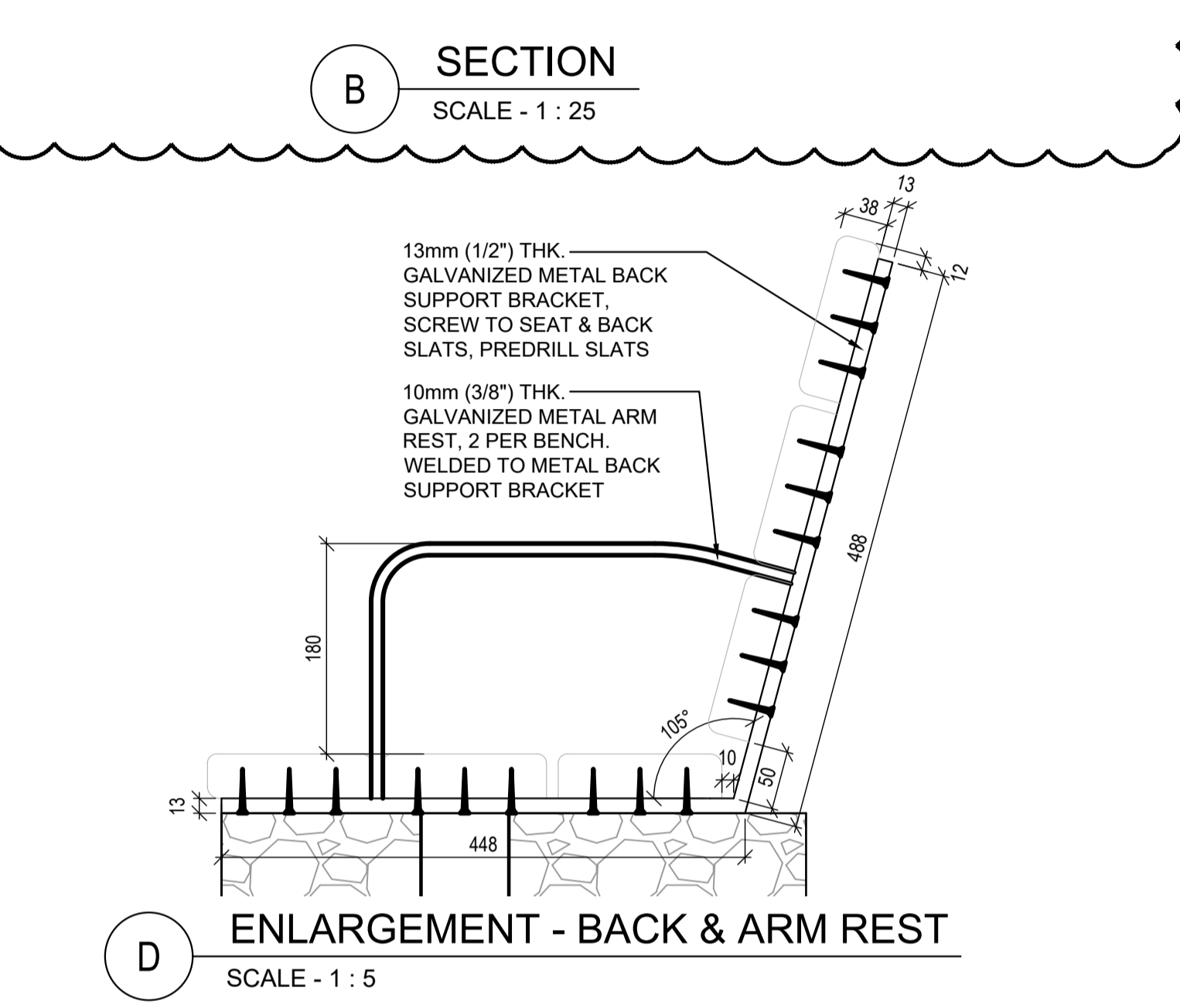

1 **2** **A** TYPE A - SECTION SCALE - 1 : 25

1 **L-09** LOW GABION WALL SCALE - AS SHOWN

B TYPE B - SECTION SCALE - 1 : 25

1 **2** **3** **L-09** TYPICAL SEATING NODE SCALE - 1:50

- GENERAL NOTES:**
- ALL CONSTRUCTION MATERIALS AND METHODS TO BE IN ACCORDANCE WITH "THE CITY OF WINNIPEG, STANDARD CONSTRUCTION SPECIFICATION AND STANDARD DETAILS" (LATEST REVISION).
 - FINAL LOCATION OF REST STOPS TO BE CONFIRMED ON SITE PRIOR TO CONSTRUCTION.
 - CONTRACTOR TO STAKE PROPOSED TREE LOCATION ON SITE, LAYOUT TO BE APPROVED BY LANDSCAPE ARCHITECT PRIOR TO INSTALLATION.
 - CONTRACTOR TO CONFIRM THE LOCATION OF ALL UTILITIES/SERVICES IN THE FIELD PRIOR TO CONSTRUCTION.
 - CONTRACTOR MUST FOLLOW THE REQUIREMENTS OF THE VARIOUS UTILITIES.
 - ALSO REFER TO WRITTEN SPECIFICATION.

LOCATION APPROVED UNDERGROUND STRUCTURES		B.I.M. KGS_BASE ELEV. 249.213	COORDINATE SYSTEM: CGVD28
SUPV. U/G STRUCTURES COMMITTEE	DATE		
NOTE: LOCATION OF UNDERGROUND STRUCTURES AS SHOWN ARE BASED ON THE BEST INFORMATION AVAILABLE BUT NO GUARANTEE IS GIVEN THAT ALL EXISTING UTILITIES ARE SHOWN OR THAT THE GIVEN LOCATIONS ARE EXACT. CONFIRMATION OF EXISTENCE AND EXACT LOCATION OF ALL SERVICES MUST BE OBTAINED FROM THE INDIVIDUAL UTILITIES BEFORE PROCEEDING WITH CONSTRUCTION.			
NO.	REVISIONS	DATE	BY
2	ISSUED WITH ADDENDUM NO. 3	20/10/28	BS
1	ISSUED WITH ADDENDUM NO. 2	20/10/22	BS
0	ISSUED FOR TENDER	20/10/05	BS

KGS GROUP		SCATLIFF + MILLER + MURRAY	
DESIGNED BY	BS / TJ / CO	CHECKED BY	BS
DRAWN BY	WF	APPROVED BY	BS
HOR. SCALE:	AS SHOWN	RELEASED FOR CONSTRUCTION:	
VERTICAL:		DATE	2020/10/05

PROFESSIONAL SEAL

THE CITY OF WINNIPEG
PUBLIC WORKS DEPARTMENT
ENGINEERING DIVISION

PROJECT TITLE
WELLINGTON CRESCENT RIVERBANK, PATH AND ROADWAY PROJECT

LANDSCAPING WORKS

LANDSCAPE DETAILS (SHEET 1 OF 4)

SHEET 63 OF 69
COMPUTER FILE NAME: WELLINGTON-CRESCENT-LANDSCAPE-WORKING.DWG
CITY DRAWING NUMBER: P-3536-56

WARNING

NOTIFY THE GAS COMPANY OF THE PROPOSED LOCATION OF EXCAVATION.

TAKE PRECAUTION TO AVOID DAMAGE TO GAS COMPANY INSTALLATIONS.

SEE PROVINCIAL REGULATION 210/72 FOR DETAILS.

PROPERTY LIMITS DELINEATION

DELINEATION OF PROPERTY LIMITS AS SHOWN ON THIS DWG DOES NOT REPRESENT A "LEGAL SURVEY". KGS GROUP MAKES NO REPRESENTATION OR WARRANTY AS TO THE ACCURACY OF PROPERTY LIMITS DELINEATED ON THIS DWG, NOR ON THE DIMENSIONAL ACCURACY OF DWG FEATURES RELATIVE TO THOSE PROPERTY LIMITS.