

**PLAN**  
SCALE: 1:500

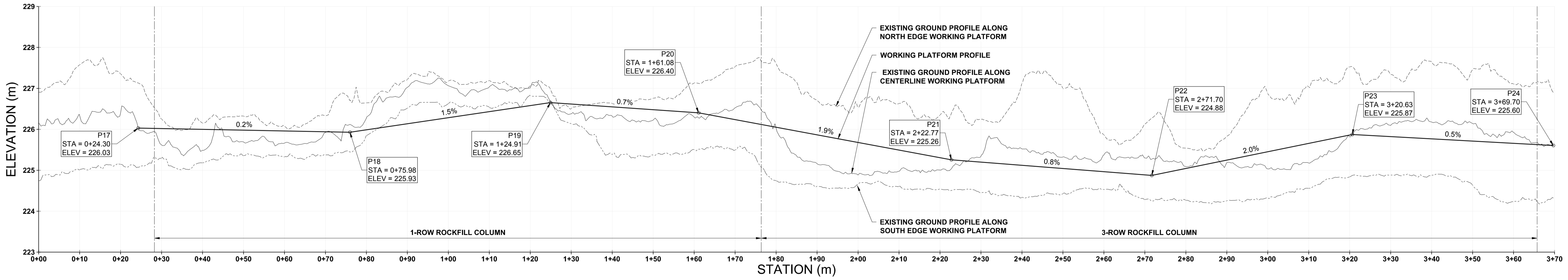

**PROFILE - WORKING PLATFORM**  
SCALE: 1:500

**SEQUENCE OF WORK**  
1. IMPLEMENT AND MAINTAIN TEMPORARY SEDIMENT AND EROSION CONTROL MEASURES THROUGHOUT CONSTRUCTION.

**NOTES:**  
1. TOPOGRAPHIC SURFACE CONTOURS FROM CITY OF WINNIPEG LIDAR (2015)

POINT ID	NORTHING	EASTING	ELEVATION
P1	5525961.450	634351.977	226.03
P2	5525954.234	634354.023	226.03
P3	5525976.317	634404.425	226.01
P4	5525969.734	634408.703	225.99
P5	5525987.979	634414.137	226.21
P6	5525974.372	634412.565	226.06
P7	5525993.805	634442.709	226.61
P8	5525983.933	634449.530	226.62
P9	5525990.711	634453.041	226.61
P10	5525980.928	634459.565	226.56
P11	5526000.697	634496.287	226.08
P12	5525989.902	634498.424	226.08

POINT ID	NORTHING	EASTING	ELEVATION
P13	5526017.185	634595.886	225.03
P14	5526006.434	634598.297	225.03
P15	5526041.778	634682.351	225.60
P16	5526031.198	634685.361	225.60
P17	5525957.842	634353.000	226.03
P18	5525971.936	634402.720	225.93
P19	5525989.078	634445.422	226.65
P20	5525991.402	634480.476	226.40
P21	5526002.546	634541.129	225.26
P22	5526010.537	634589.403	224.88
P23	5526023.064	634636.659	225.87
P24	5526036.455	634683.742	225.61

EXISTING	NEW	EXISTING	NEW	EXISTING	NEW	EXISTING	NEW

**LOCATION APPROVED**  
UNDERGROUND STRUCTURES

DATE: \_\_\_\_\_

**NOTE:**  
LOCATION OF UNDERGROUND STRUCTURES AS SHOWN ARE BASED ON THE BEST INFORMATION AVAILABLE BUT NO GUARANTEE IS GIVEN THAT ALL EXISTING UTILITIES ARE SHOWN OR THAT THE GIVEN LOCATIONS ARE EXACT. CONFIRMATION OF EXISTENCE AND EXACT LOCATION OF ALL SERVICES MUST BE OBTAINED FROM THE INDIVIDUAL UTILITIES BEFORE PROCEEDING WITH CONSTRUCTION.

No.	REVISIONS	DATE	BY
0	ISSUED FOR TENDER	20/11/05	

**TREK GEOTECHNICAL**

DESIGNED BY: MVH  
DRAWN BY: BIT

CHECKED BY: KMS  
APPROVED BY: \_\_\_\_\_

HOR SCALE: 1:500  
VERT SCALE: \_\_\_\_\_

RELEASED FOR CONSTRUCTION

PROFESSIONAL'S SEAL

ORIGINAL SIGNED BY M. J. VAN HELDEN, Member No. 24729, 20/11/05

CONSULTANT FILE NAME: \_\_\_\_\_

**THE CITY OF WINNIPEG**  
PLANNING, PROPERTY AND DEVELOPMENT DEPARTMENT  
WATERWAYS BRANCH

**LYNDALE DRIVE RIVERBANK STABILIZATION AND ASSOCIATED WORKS**  
BIRCHDALE AVENUE TO CLAREMONT AVENUE

RIVERBANK STABILIZATION - WORK PLATFORM LAYOUT AND PROFILES

CITY DRAWING NUMBER: PPD-WAT-779-2020-05  
SHEET 5 OF 13  
DRAWING NUMBER: 05



TENDER No. 779-2020