

CITY OF ST. JAMES

RIVER LOT 20
PARISH OF ST. JAMES
LOT 1

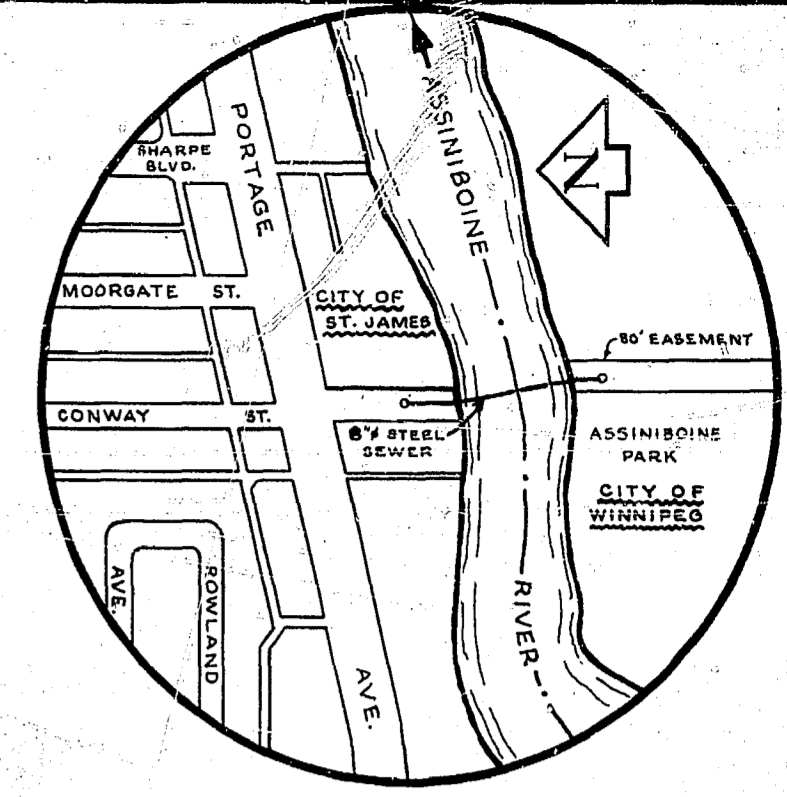
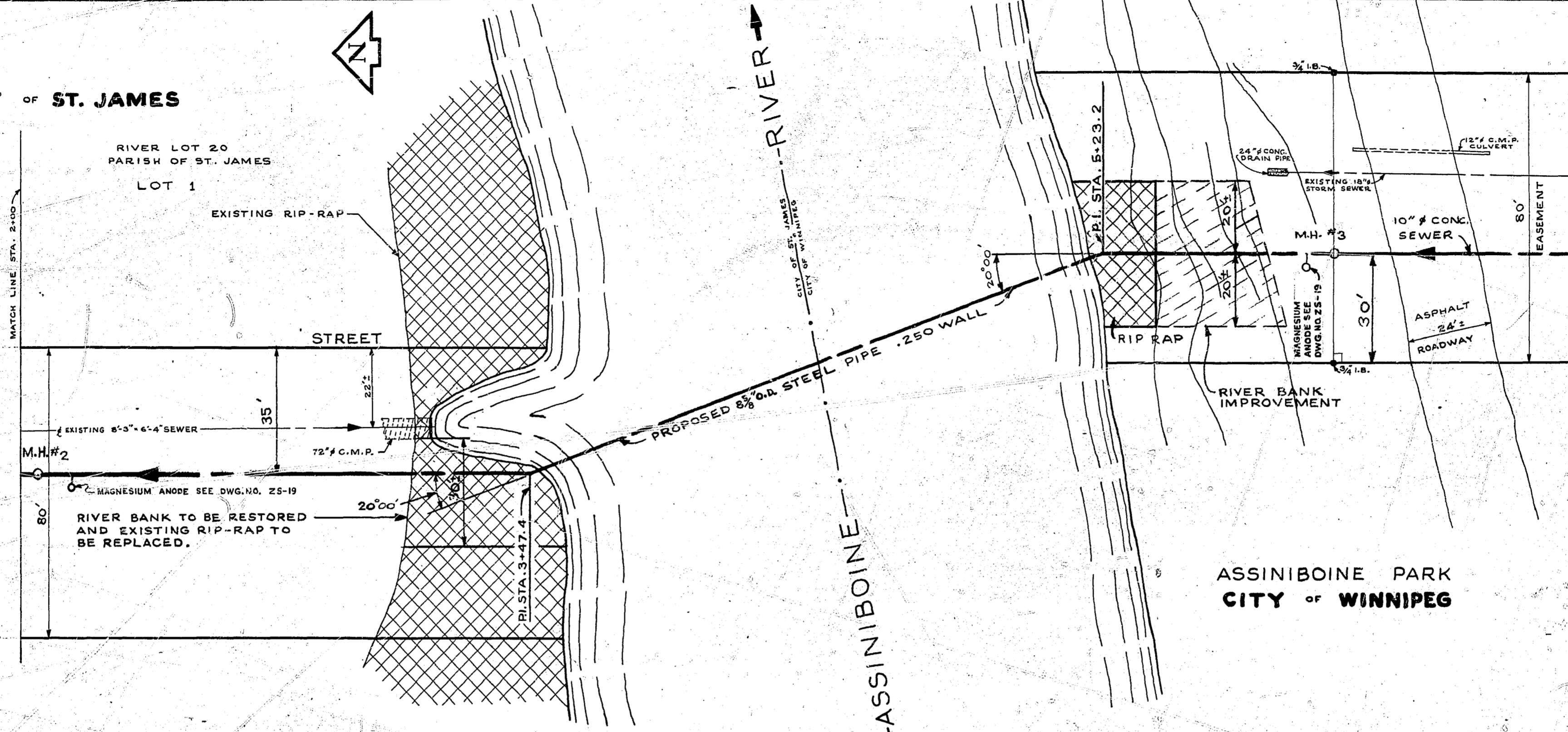

SITE PLAN
SCALE - N.T.S.

ALL SAN. SEWERS
TO HAVE RUBBER
GASKETED JOINTS

780

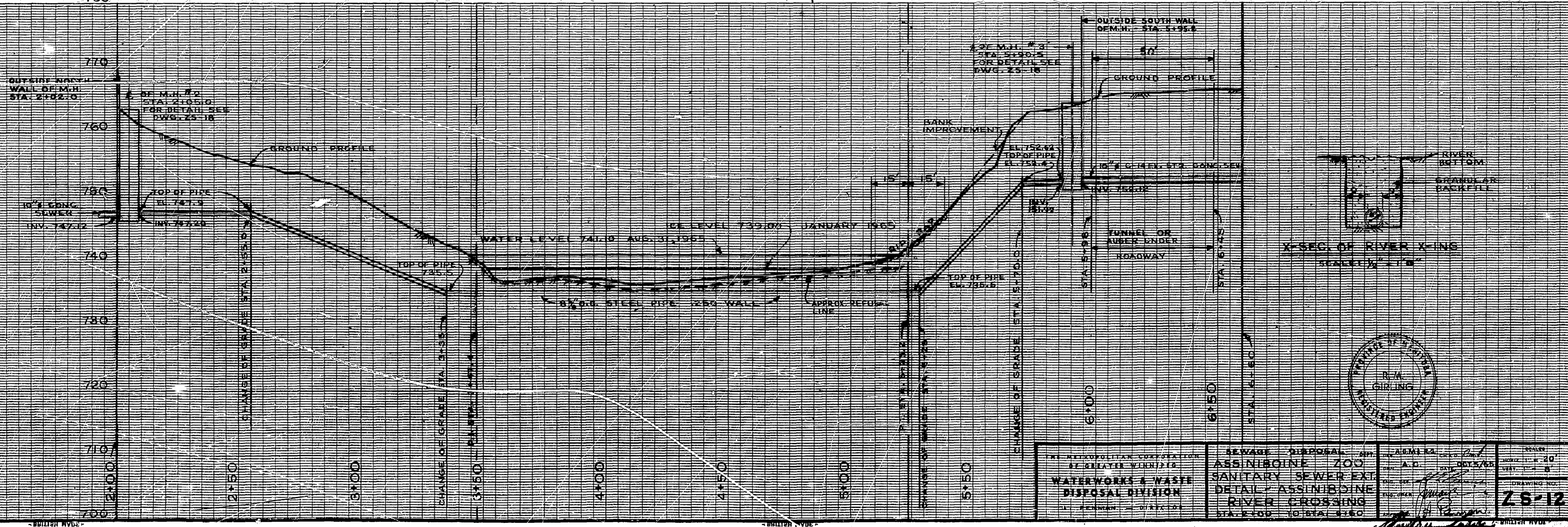

<p>THE METROPOLITAN COOPERATION OF GREATER WINNIPEG WATERWORKS & WASTE DISPOSAL DIVISION 1 - PENMAN - 07/28/61</p>	<p>SEWER DISPOSAL APP. ASSINIBOINE ZOO SANITARY SEWER EXT. DETAIL ASSINIBOINE RIVER CROSSING STA. 2+00 TO STA. 6+50</p>	<p>SCALE: HORIZ. 1" = 20' VERT. 1" = 5' DRAWING NO. 25-12 ANDREW CURRIE Director of Parks & Protection</p>
--	---	---