

DETECTION CONNECTION DETAILS			
SENSOR NO.	POLE NO.	DETECTION LOCATION	NOTES
MATRIX 1	1	SB LANES	
MATRIX 2	4	WB MEDIAN LANE (WBL)	
MATRIX 3	5	NB LANES	

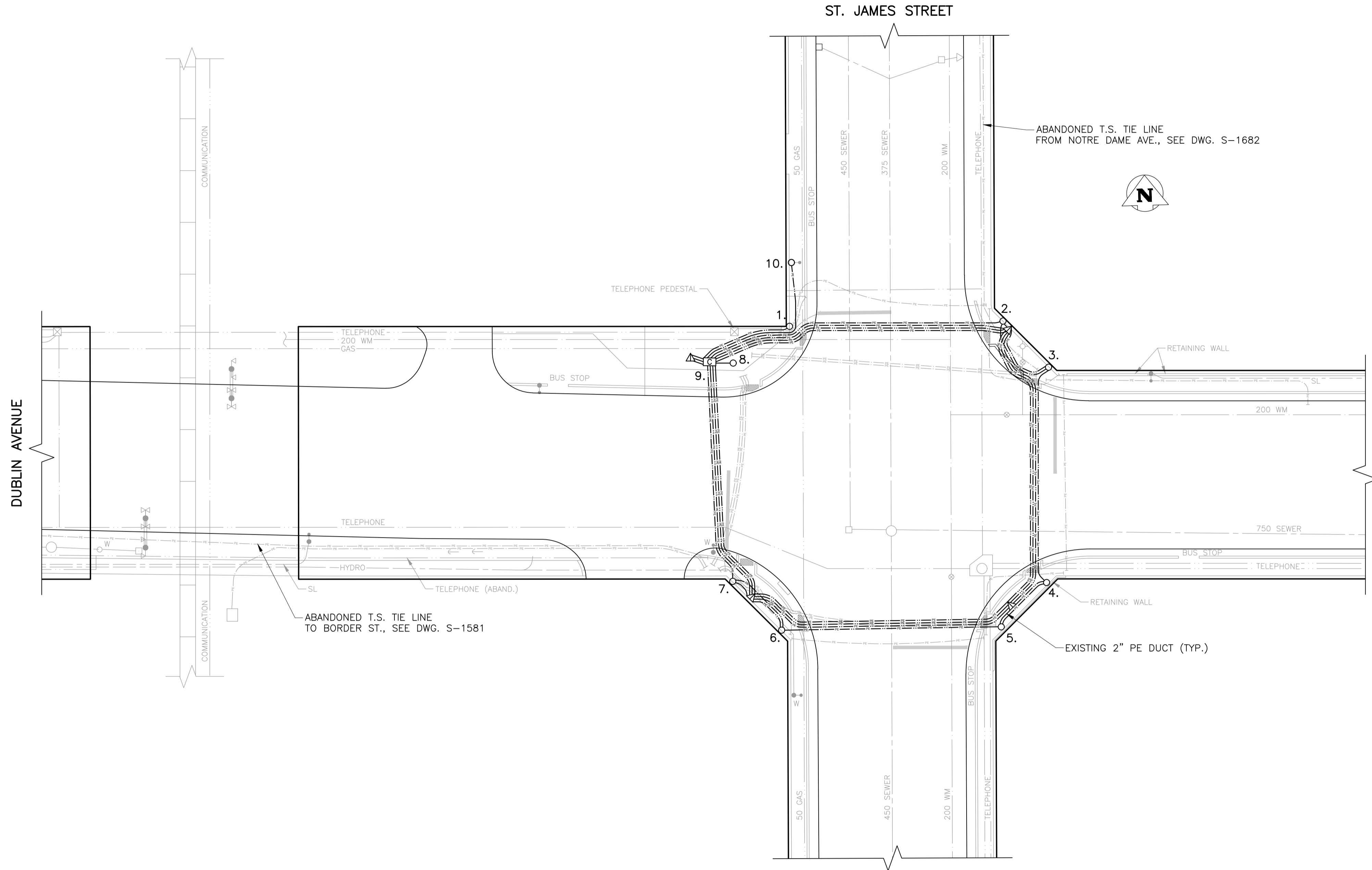
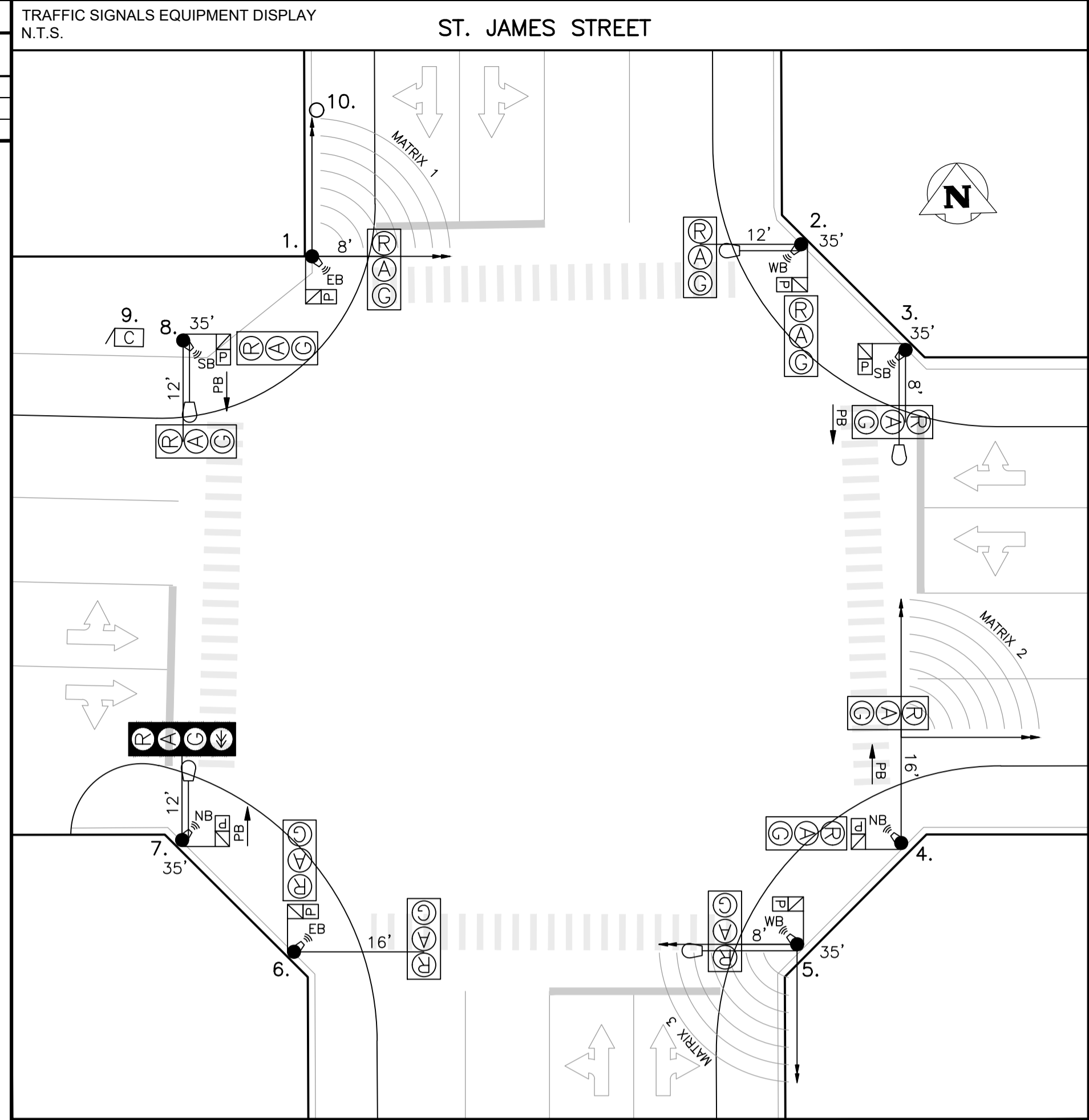

EQUIPMENT DISPLAY LEGEND			
EXISTING (AS SHOWN BELOW)			
	PEDESTRIAN HEAD WITH PCS		VEHICLE DETECTION AREA
	PEDESTRIAN CORRIDOR BOX		PUSH BUTTON & DIRECTION (GPS = CURVED/DIR)
	RFB (PHASE 'A' OR 'B')		APS SINGLE DIRECTION
	TRAFFIC SIGNAL HEAD		TRAFFIC SIGNAL POLE
	LOW ARM (SHOWN FROM CENTRE)		RED FLASHER
	HIGH ARM (SHOWN FROM SIDE)		AMBER FLASHER (SCOUT 'X' OR 'Y')
	LUMINAIRE		CAMERA

NO.	EQUIPMENT LIST	ARM	BASE	B.B.	NO.	EQUIPMENT LIST	ARM	BASE	B.B.
1.	CANTILEVER	8'	OD	DC					
2.	35' SIGNAL FOR 150 WATT LUMINAIRE	12'	G	GD					
3.	35' SIGNAL FOR 90 WATT LUMINAIRE	8'	G	GD					
4.	CANTILEVER	16'	OD	DC					
5.	35' SIGNAL FOR 150 WATT LUMINAIRE	8'	G	GD					
6.	CANTILEVER	16'	OD	DC					
7.	35' SIGNAL FOR 90 WATT LUMINAIRE	12'	G	GD					
8.	35' SIGNAL FOR 90 WATT LUMINAIRE	12'	G	GD					
9.	332 CABINET/2070 CONTROLLER								
10.	HYDRO WOOD SERVICE:								

TRAFFIC SIGNALS UNDERGROUND LEGEND		SIGNAL BASE BOLT SQUARE TYPES	
EXISTING (AS SHOWN BELOW) DISCONNECTED (LOOPS ONLY)		ABANDONED	
	1 1/2" PE CONDUIT		POLE BASE
	2" PE CONDUIT		CONTROLLER BASE
	2" ENT CONDUIT		PEDESTAL BASE
	AERIAL / BURIED CABLE		TERMINAL BASE
	CONDUIT STUB		SERVICE BOX (PIT)
	SAW-CUT LOOPS		24" PRECAST PIT
	PREFORMED LOOPS		30" PRECAST PIT
			36" PRECAST PIT

PLAN VIEW: UNDERGROUND CONSTRUCTION
1:250

EXISTING	LEGEND	PROPOSED	EXISTING	LEGEND	PROPOSED	EXISTING	LEGEND	PROPOSED
	WATERMAIN			ROADWAY			TELEPHONE	
	HYDRANT			SIDEWALK			COMMUNICATION	
	SEWER			CURB & CURB RAMP			STREET LIGHT	
	CATCH BASIN			SLOPE			WARNING TILE	
	HYDRO			BUILDING			BANNER POLE	
	GAS			CULVERT			RAILWAY POLE	
	WATERMAIN			BUILDING			GUY-WIRE	
	WATERMAIN			BUILDING			FENCE	
	WATERMAIN			BUILDING			GUARDRAIL	

UNDERGROUND STRUCTURES

UNDERGROUND STRUCTURES ID DATE (YYYY/MM/DD)

WATER & WASTE REVIEW ID

NOTE: LOCATIONS OF UNDERGROUND STRUCTURES AS SHOWN ARE BASED ON THE BEST INFORMATION AVAILABLE. BUT NO GUARANTEE IS GIVEN THAT ALL EXISTING UTILITIES ARE SHOWN OR THAT THE GIVEN LOCATIONS ARE EXACT. CONFIRMATION OF EXISTENCE AND EXACT LOCATION OF ALL SERVICES MUST BE OBTAINED FROM THE INDIVIDUAL UTILITIES BEFORE PROCEEDING WITH CONSTRUCTION.

CONSTRUCTION REVISIONS		DESIGNED BY	APPROVED BY
3	ISSUED FOR RECORD	2020/01/14	J.S.
2	ISSUED FOR CONSTRUCTION	2020/05/01	R.P.
1	RE-ISSUED FOR UGS APPROVAL	2020/02/20	R.S.
0	ISSUED FOR UGS APPROVAL	2020/01/30	R.S.
NO.	REVISION	DATE (YYYY/MM/DD)	BY

ACCOUNTS:

DESIGNED BY: J.S.

DRAWN BY: C.H.

CHECKED BY:

APPROVED BY:

LIABILITY DISCLAIMER NOTICE: THE DIGITAL INFORMATION PROVIDED FOR YOUR CONVENIENCE HEREIN IS FOR USE AT YOUR OWN RISK. THE CITY OF WINNIPEG, PUBLIC WORKS DEPARTMENT, SHALL ASSUME NO RESPONSIBILITY FOR THE INFORMATION AND IT SHOULD NOT BE CONSTRUED AS ASSULT INFORMATION. THE INFORMATION SHOULD BE USED FOR PLANNING PURPOSES ONLY AND SHOULD BE VERIFIED BY SURVEY. THE DEPARTMENT SHALL NOT IN ANY WAY SUPPORT ANY LIABILITY WHATSOEVER TO ANY PARTY FOR INJURY, LOSS OR DAMAGES SUFFERED BY SUCH PARTY ARISING FROM THEIR USE OF, OR RELIANCE UPON, THIS INFORMATION.

RECORD DRAWING

THE CITY OF WINNIPEG
PUBLIC WORKS DEPARTMENT
TRANSPORTATION DIVISION

TRAFFIC SIGNALS
DUBLIN AVE. & ST. JAMES ST.

UNITS: ALL DIMENSIONS ARE IN METERS UNLESS OTHERWISE NOTED

DRAWING NUMBER: S-1288