

CONSTRUCTION NOTES:

PROJECT SCOPE

1. INSTALL CONDUIT, BASES AND PITS AS SHOWN.
2. INSTALL SERVICE AND GROUND ROD ON WOOD POLE #9 AS SHOWN. INSTALL MAST AND DISCONNECT ON XX QUADRANT. INSTALL WEATHER HEAD 150mm LOWER THAN THE LOWEST HYDRO WIRE. REMOVE EXISTING SERVICE FROM WOOD POLE #E9. TOTAL LENGTH OF SERVICE CABLE: 25m.
3. INSTALL EQUIPMENT AS SHOWN. REMOVE JOINT USE POLE #E3 AS SHOWN. REMOVE SIGNALS EQUIPMENT FROM WOOD POLE #E7 AS SHOWN.
4. TIMINGS REQUIRED.

PROJECT COORDINATION

1. COORDINATE WORK WITH (CA'S NAME), (204) XXX-XXXX.
2. COORDINATE HYDRO SERVICE REBUILD WITH (HYDRO DESIGNER), (204) XXX-XXXX. RE: JUTA PERMIT No. BXXXXX
3. TWO WEEKS PRIOR TO CONSTRUCTION, COORDINATE REMOVAL OF JOINT USE POLE #E3 WITH DARREN TABAK, (204) 360-7521, dtabak@hydro.mb.ca.

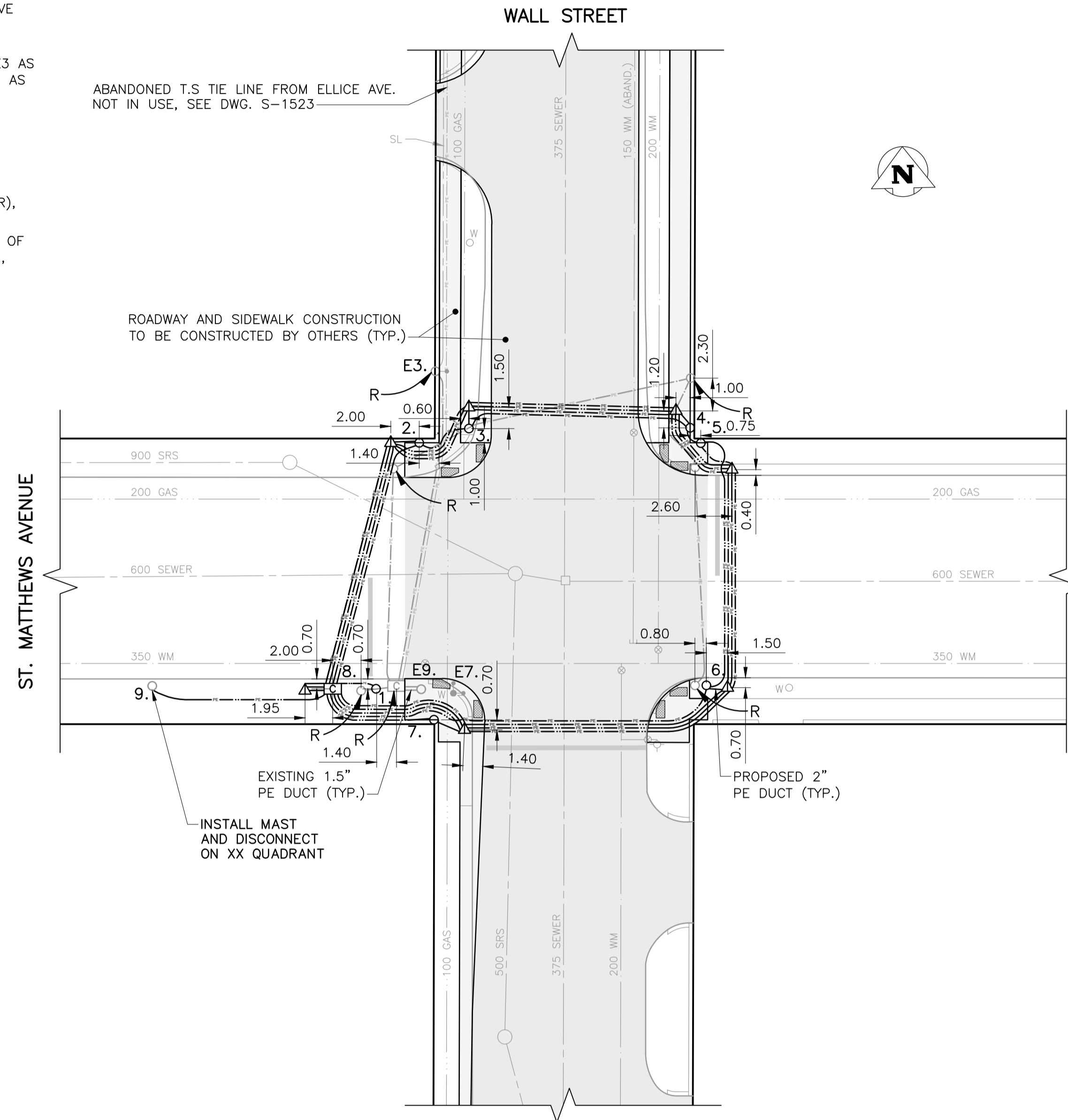

PLAN VIEW: UNDERGROUND CONSTRUCTION
1:250

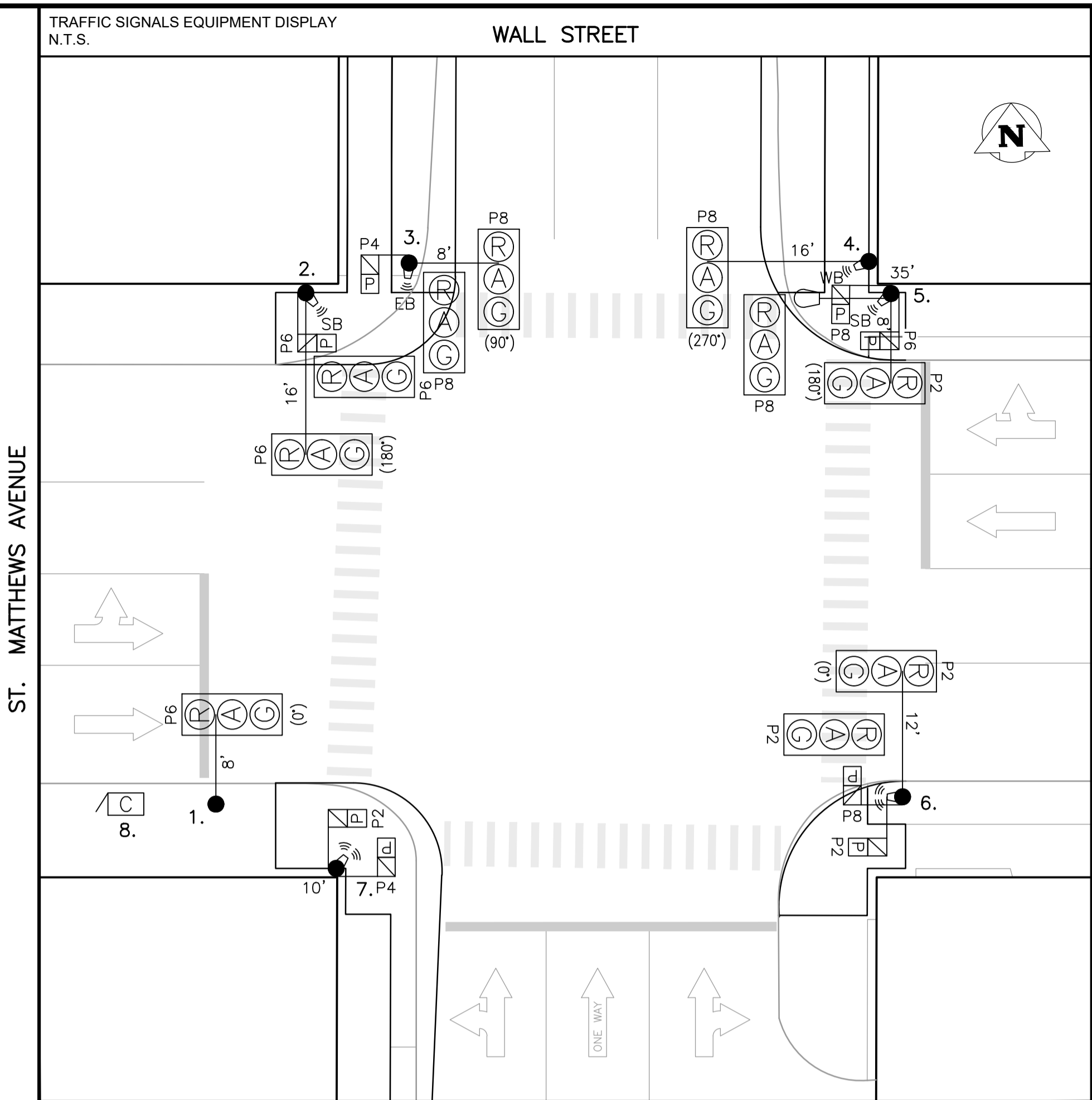

EQUIPMENT DISPLAY LEGEND

EXISTING	PROPOSED (AS SHOWN BELOW)	TRAFFIC SIGNAL HEAD	LOW ARM (SHOWN FROM CENTRE) HIGH ARM (SHOWN FROM SIDE)
PEDESTRIAN HEAD WITH PCS	VEHICLE DETECTION AREA	TRAFFIC SIGNAL HEAD	LOW ARM (SHOWN FROM CENTRE) HIGH ARM (SHOWN FROM SIDE)
PEDESTRIAN CORRIDOR BOX	PUSH BUTTON & DIRECTION (SPB = AUDIBLE PB)	TRAFFIC SIGNAL POLE	RED FLASHER LUMINAIRE
RRFB (PHASE 'A' OR 'B')	APS SINGLE DIRECTION	APS DUAL DIRECTION (2 SEPARATE SPEAKERS)	AMBER FLASHER (CIRCUIT 'A' OR 'B')
			CAMERA

NO.	EQUIPMENT LIST	ARM	BASE	B.B.	NO.	EQUIPMENT LIST	ARM	BASE	B.B.
1.	DAVIT	8'	OD	DD	E3.	45' SL (TO BE REMOVED)			
2.	DAVIT	16'	G	GD	E7.	HYDRO WOOD			
3.	DAVIT	8'	OD	DD	E9.	HYDRO WOOD SERVICE (TO BE REMOVED)			
4.	DAVIT	16'	G	GD					
5.	35' SIGNAL FOR 150 WATT (15000 LUMEN) LUMINAIRE		G	GD					
6.	DAVIT	12'	OD	DD					
7.	10' SIGNAL		G	G					
8.	332 CABINET/2070 CONTROLLER								
9.	HYDRO WOOD SERVICE:								

EXISTING	PROPOSED (AS SHOWN BELOW)	TRAFFIC SIGNALS UNDERGROUND LEGEND	SIGNAL BASE BOLT SQUARE TYPES
ABANDONED	DISCONNECTED (LOOPS ONLY)	POLE BASE	BOLT SQUARE (B.S.)
1 1/2" PE CONDUIT	POLE BASE	CONTROLLER BASE	TYPE "A" - 8 1/8"
2" PE CONDUIT	PEDESTAL BASE	TERMINAL BASE	TYPE "B" - 6 3/4"
4" PVC CONDUIT	SERVICE BOX (PIT)	24" PRECAST PIT	TYPE "C" - 8 1/8" SCREW TYPE
AERIAL / BURIED CABLE	30" PRECAST PIT	36" PRECAST PIT	TYPE "D" - 12 3/4", 1 1/4" DIA. BOLTS, 24" DIA.
CONDUIT STUB	REMOVAL		TYPE "OD" - 12 3/4", 1 1/4" DIA. BOLTS, 28" DIA.
BREAK-IN			TYPE "PD" - 12 3/4", PRECAST, 1 1/4" DIA. BOLTS
SPLICE			TYPE "E" - 9 9/16" SCREW TYPE
SAW-CUT LOOPS			TYPE "F" - 9 9/16"
PREFORMED LOOPS			TYPE "G" - 8 1/8", 1 1/4" DIA. BOLTS, 89mm PROJ.
			TYPE "GS" - 8 1/8", 1 1/4" DIA. BOLTS, 76mm PROJ.
			TYPE "PG" - 8 1/8", PRECAST, 1 1/4" DIA. BOLTS
			TYPE "H" - 9 7/8" SCREW TYPE
			TYPE "I" - 7 3/4"
			TYPE "J" - 10 5/8", 1 1/4" DIA. BOLTS
			TYPE "K" - 10 5/8", PRECAST, 1 1/4" DIA. BOLTS
			TYPE "L" - 6", 5/8" DIA. BOLTS
			TYPE "PM" - 8 1/8", PRECAST, 5/8" DIA. BOLTS

EXISTING	LEGEND	PROPOSED	EXISTING	LEGEND	PROPOSED	EXISTING	LEGEND	PROPOSED
	WATERMAIN			PROPERTY LINE			TELEPHONE	
	HYDRANT			ROADWAY			TELEPHONE COMMUNICATION	
	VALVE			SIDEWALK			WOOD POLE	
	SEWER			CURB & CURB RAMP			STREET LIGHT	
	MANHOLE			WARNING TILE			BANNER POLE	
	CATCH BASIN			SLOPE			RAILWAY POLE	
	CURB INLET			CULVERT			GUY-WIRE	
	HYDRO			BUILDING			FENCE	
	GAS			TREE			GUARDRAIL	

UNDERGROUND STRUCTURES	CONSTRUCTION REVISIONS
UNDERGROUND STRUCTURES ID DATE (YYYYMMDD)	
WATER & WASTE REVIEW ID	

NO.	REVISION	DATE (YYYYMMDD)	BY
0	ISSUED FOR UGS APPROVAL	2021/03/10	R.S.

C.H.	DESIGNED BY	C.H./R.S.	DRAWN BY	CHECKED BY	APPROVED BY
PENDING					

LIABILITY DISCLAIMER NOTICE:
THE DIGITAL INFORMATION PROVIDED FOR YOUR CONVENIENCE HEREIN IS FOR USE AT YOUR OWN RISK. THE CITY OF WINNIPEG, PUBLIC WORKS DEPARTMENT, SHALL ASSUME NO RESPONSIBILITY FOR THE INFORMATION AND IT SHOULD NOT BE CONSTRUED AS ASSULT INFORMATION. THE INFORMATION SHOULD BE USED FOR PLANNING PURPOSES ONLY AND SHOULD BE VERIFIED BY SURVEY. THE DEPARTMENT SHALL NOT IN ANY WAY SUPPORT ANY LIABILITY WHATSOEVER TO ANY PARTY FOR INJURY, LOSS OR DAMAGES SUFFERED BY SUCH PARTY ARISING FROM THEIR USE OF, OR RELIANCE UPON, THIS INFORMATION.

THE CITY OF WINNIPEG
PUBLIC WORKS DEPARTMENT
TRANSPORTATION DIVISION

TRAFFIC SIGNALS
ST. MATTHEWS AVE. & WALL ST.

UNITS: ALL DIMENSIONS ARE IN METERS UNLESS OTHERWISE NOTED

DRAWING NUMBER: S-1517