

DETECTION CONNECTION DETAILS			
SENSOR NO.	POLE NO.	DETECTION LOCATION	NOTES
MATRIX 1	10		

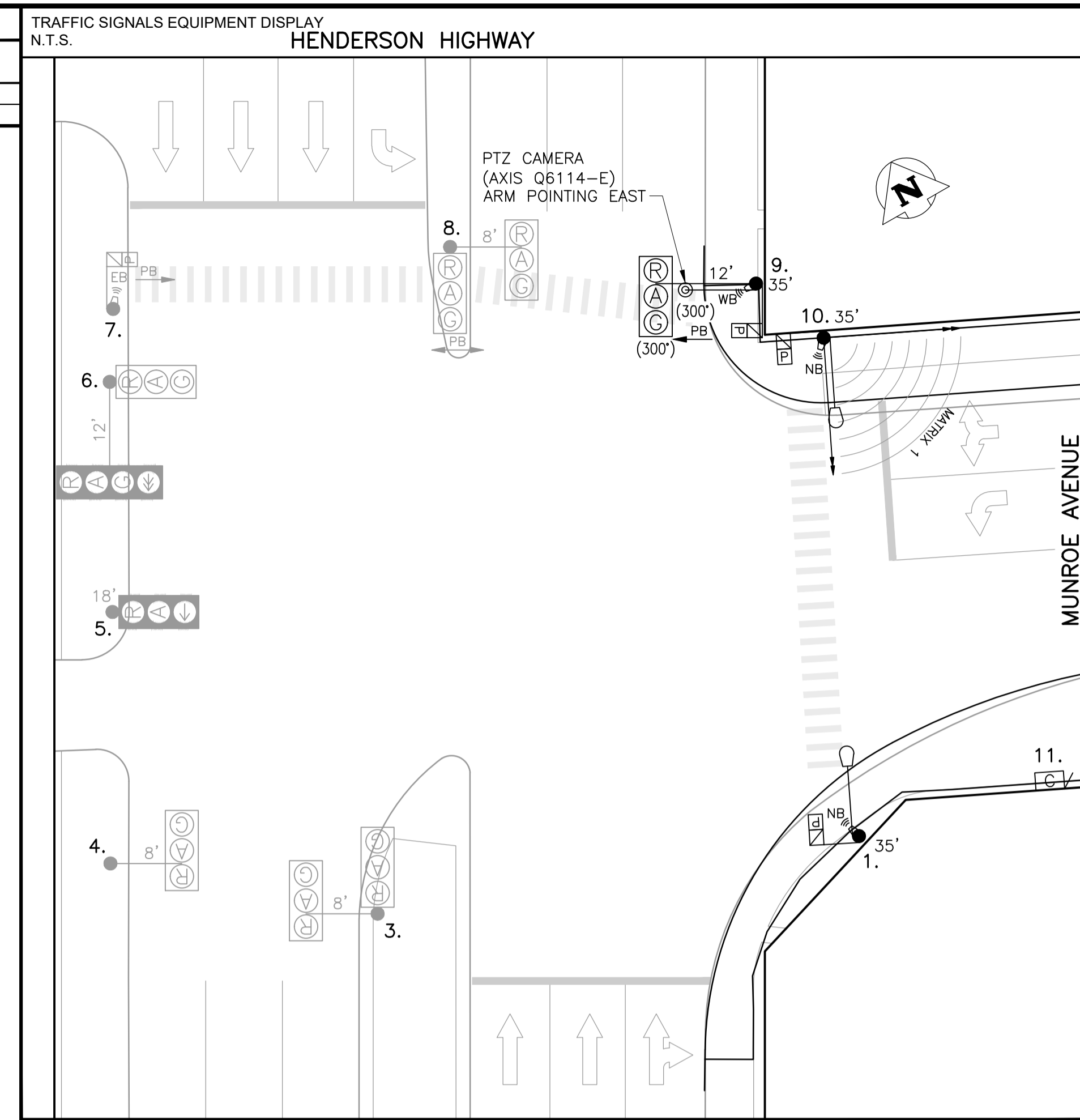

**CONSTRUCTION NOTES:**

- PROJECT SCOPE**
1. INSTALL CONDUIT, BASES AND PITS AS SHOWN.
  2. REBUILD SERVICE AND INSTALL GROUND ROD ON WOOD POLE #12 AS SHOWN. INSTALL MAST AND DISCONNECT ON XX QUADRANT. INSTALL WEATHER HEAD 150mm LOWER THAN THE LOWEST HYDRO WIRE. TOTAL LENGTH OF SERVICE CABLE: 35m.
  3. INSTALL EQUIPMENT AS SHOWN. REMOVE JOINT USE POLE #E1.
  4. TIMINGS REQUIRED.
- PROJECT COORDINATION**
1. COORDINATE WORK WITH (CA'S NAME), (204) XXX-XXXX.
  2. COORDINATE HYDRO SERVICE INSTALLATION WITH (HYDRO DESIGNER), (204) XXX-XXXX. RE: JUTA PERMIT No. BXXXXX
  3. TWO WEEKS PRIOR TO CONSTRUCTION, COORDINATE REMOVAL OF JOINT USE POLE #E1 WITH DARREN TABAK, (204) 360-7521, dtabak@hydro.mb.ca.

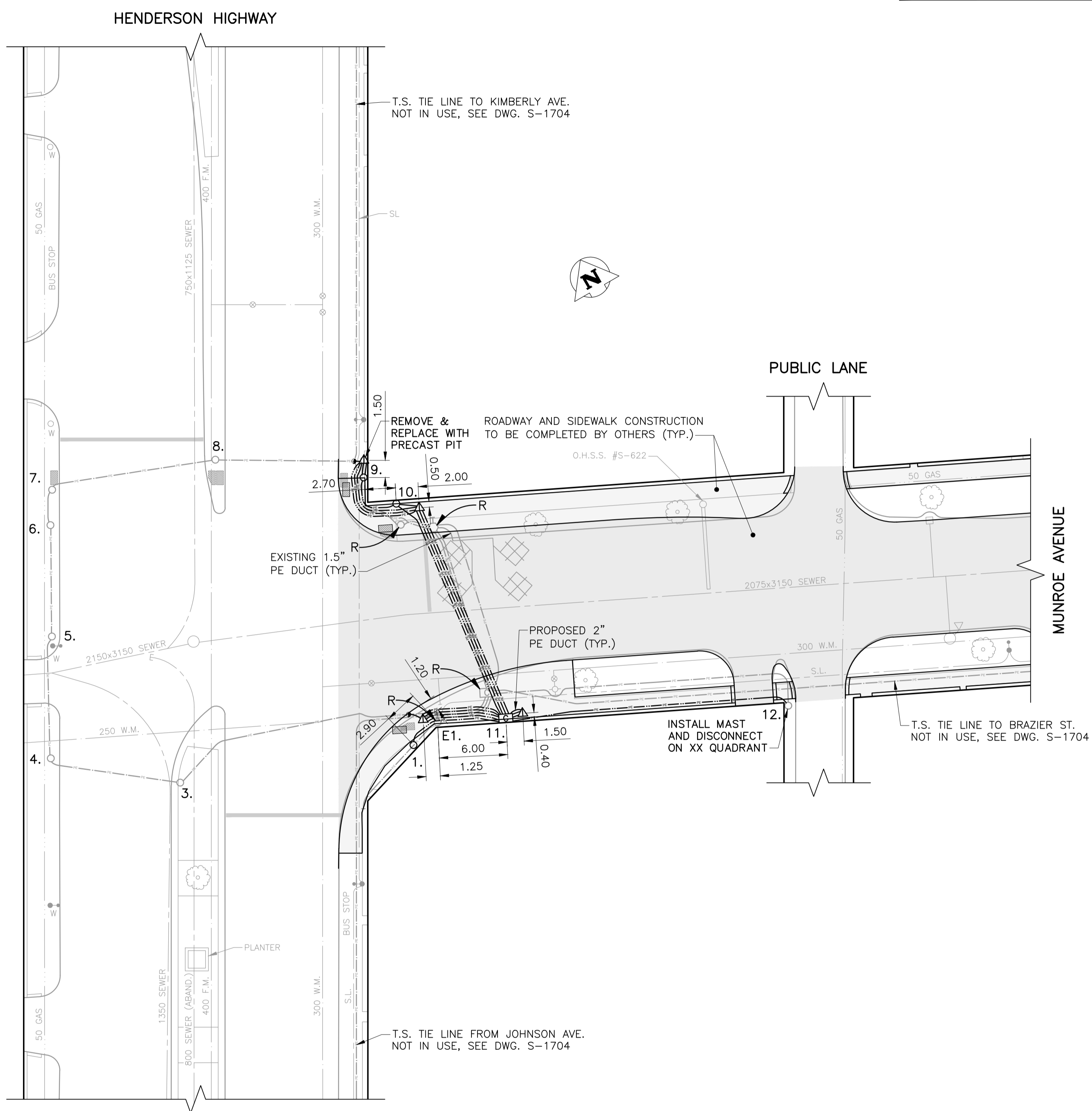

**EQUIPMENT DISPLAY LEGEND**

	EXISTING		PROPOSED (AS SHOWN BELOW)
			VEHICLE DETECTION AREA
	RFB (PHASE 'A' OR 'B')		PUSH BUTTON & DIRECTION (GPS = GUARDIAN PE)
	AEB		APS SINGLE DIRECTION
			TRAFFIC SIGNAL POLE
			RED FLASHER
			APS DUAL DIRECTION (2 SEPARATE SPEAKERS)
			AMBER FLASHER (CIRCUIT 'A' OR 'B')
			CAMERA
			LOW ARM (SHOWN FROM CENTRE)
			HIGH ARM (SHOWN FROM SIDE)
			LUMINAIRE

NO.	EQUIPMENT LIST	ARM	BASE	B.B.	NO.	EQUIPMENT LIST	ARM	BASE	B.B.
1.	35' SIGNAL FOR XX WATT (XXXX LUMEN) LUMINAIRE		G	GD	11.	332 CABINET/2070 CONTROLLER			
3.	DAVIT	8'	B	BD	12.	HYDRO WOOD SERVICE:			
4.	DAVIT	8'	A	AD	E1.	35' S.L. (TO BE REMOVED)		C	A
5.	18" SIGNAL		A	A					
6.	DAVIT	12'	A	AD					
7.	10" SIGNAL		A	A					
8.	DAVIT	8'	A	AD					
9.	35' SIGNAL FOR CAMERA	12'	OD	DD					
10.	35' SIGNAL FOR XX WATT (XXXX LUMEN) LUMINAIRE		G	GD					

**TRAFFIC SIGNALS UNDERGROUND LEGEND**

	1 1/2" PE CONDUIT		POLE BASE
	2" PE CONDUIT		CONTROLLER BASE
	2" ENT CONDUIT		PEDESTAL BASE
	AERIAL / BURIED CABLE		TERMINAL BASE
	CONDUIT STUB		SERVICE BOX (PIT)
	BREAK-IN		24" PRECAST PIT
	SPICE		30" PRECAST PIT
	SAW-CUT LOOPS		36" PRECAST PIT
	PREFORMED LOOPS		REMOVAL

**SIGNAL BASE BOLT SQUARE TYPES**

	TYPE "A" - 8 1/8"
	TYPE "B" - 6 3/4"
	TYPE "C" - 8 1/8" SCREW TYPE
	TYPE "D" - 12 3/4", 1 1/4" DIA. BOLTS, 24" DIA.
	TYPE "OD" - 12 3/4", 1 1/4" DIA. BOLTS, 28" DIA.
	TYPE "PD" - 12 3/4", PRECAST, 1 1/4" DIA. BOLTS
	TYPE "E" - 9 9/16" SCREW TYPE
	TYPE "F" - 9 9/16"
	TYPE "G" - 8 1/8", 1 1/4" DIA. BOLTS, 89mm PROJ.
	TYPE "GS" - 8 1/8", 1 1/4" DIA. BOLTS, 76mm PROJ.
	TYPE "PG" - 8 1/8", PRECAST, 1 1/4" DIA. BOLTS
	TYPE "H" - 9 7/8" SCREW TYPE
	TYPE "I" - 7 3/4"
	TYPE "J" - 10 5/8", 1 1/4" DIA. BOLTS
	TYPE "K" - 10 5/8", PRECAST, 1 1/4" DIA. BOLTS
	TYPE "L" - 6", 5/8" DIA. BOLTS
	TYPE "PM" - 8 1/8", PRECAST, 5/8" DIA. BOLTS

**INTERNAL REVIEW**

OPERATIONS:	DATE	INITIALS
TIMINGS (INITIAL):	DATE	INITIALS
TIMINGS (PRE-FC):	DATE	INITIALS
TMC:	DATE	INITIALS
STREET LIGHTING:	DATE	INITIALS
TRAFFIC MANAGEMENT:	DATE	INITIALS
FACILITIES PLANNING:	DATE	INITIALS

**PLAN VIEW: UNDERGROUND CONSTRUCTION**  
1:250

EXISTING	LEGEND	PROPOSED	EXISTING	LEGEND	PROPOSED	EXISTING	LEGEND	PROPOSED
	WATERMAIN			ROADWAY			TELEPHONE	
	HYDRANT			SIDEWALK			TELEPHONE	
	SEWER			CURBS & CURB RAMP			TELEPHONE	
	HYDRO			WARNING TILE			TELEPHONE	
	GAS			SLOPE			TELEPHONE	
	GAS			CULVERT			TELEPHONE	
	PROPERTY LINE			TREE			TELEPHONE	
	TELEPHONE			TELEPHONE			TELEPHONE	

**UNDERGROUND STRUCTURES**

UNDERGROUND STRUCTURES ID	DATE (YYYYMMDD)

**WATER & WASTE REVIEW ID**

NOTE: LOCATIONS OF UNDERGROUND STRUCTURES AS SHOWN ARE BASED ON THE BEST INFORMATION AVAILABLE. BUT NO GUARANTEE IS GIVEN THAT ALL EXISTING UTILITIES ARE SHOWN OR THAT THE GIVEN LOCATIONS ARE EXACT. CONFIRMATION OF EXISTENCE AND EXACT LOCATION OF ALL SERVICES MUST BE OBTAINED FROM THE INDIVIDUAL UTILITIES BEFORE PROCEEDING WITH CONSTRUCTION.

**CONSTRUCTION REVISIONS**

NO.	REVISION	DATE (YYYYMMDD)	BY
A	ISSUED FOR INTERNAL REVIEW		

**ACCOUNTS:**

WT PENDING

**LIABILITY DISCLAIMER NOTICE:**  
THE DIGITAL INFORMATION PROVIDED FOR YOUR CONVENIENCE HEREIN IS FOR USE AT YOUR OWN RISK. THE CITY OF WINNIPEG, PUBLIC WORKS DEPARTMENT, SHALL ASSUME NO RESPONSIBILITY FOR THE INFORMATION AND IT SHOULD NOT BE CONSTRUED AS ASSULT INFORMATION. THE INFORMATION SHOULD BE USED FOR PLANNING PURPOSES ONLY AND SHOULD BE VERIFIED BY SURVEY. THE DEPARTMENT SHALL NOT IN ANY WAY SUFFER ANY LIABILITY WHATSOEVER TO ANY PARTY FOR INJURY, LOSS OR DAMAGES SUFFERED BY SUCH PARTY ARISING FROM THEIR USE OF, OR RELIANCE UPON, THIS INFORMATION.

ENGINEER'S SEAL

PRELIMINARY

NOT FOR CONSTRUCTION

**THE CITY OF WINNIPEG**  
PUBLIC WORKS DEPARTMENT  
TRANSPORTATION DIVISION

**TRAFFIC SIGNALS**  
HENDERSON HWY. & MUNROE AVE.

UNITS: ALL DIMENSIONS ARE IN METERS UNLESS OTHERWISE NOTED

DRAWING NUMBER: S-1257