

1  
A1.2 REFLECTED CEILING PLAN  
SCALE: 1/4"=1'-0"

### REFLECTED CEILING PLAN SYMBOL LEGEND

- EXISTING FLUORESCENT CEILING LIGHT. REFER TO ELECTRICAL.
- RELOCATED FLUORESCENT CEILING LIGHT. REFER TO ELECTRICAL DRAWINGS.
- NEW 1'x4' FLUORESCENT CEILING LIGHT. REFER TO ELECTRICAL DRAWINGS.
- EXISTING POTLIGHTS
- NEW POTLIGHTS. REFER TO ELECTRICAL DRAWINGS
- SUSPENDED EXISTING LIGHT.
- FINISHED CEILING HEIGHT AND CEILING TYPE. NEW CEILING TILE- 1 FT X 5 FT LAY IN. TO MATCH EXISTING.
- RETURN AIR VENT. REFER TO MECHANICAL DRAWINGS. CLEAN AS REQUIRED.
- AIR SUPPLY REFER TO MECHANICAL DRAWINGS. CLEAN AS REQUIRED.

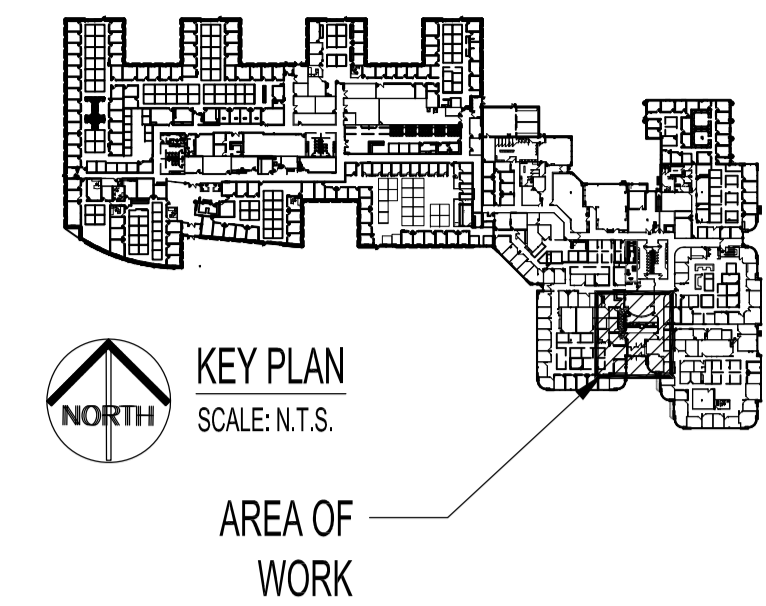

- ### DRAWING NOTES
- ① ALL EXISTING DRYWALL CEILINGS AND BULKHEADS TO BE REPAINTED. REFER TO ROOM FINISH SCHEDULE.
  - ② EXISTING CEILING GRID TO REMAIN, NEW CEILING TILE REQUIRED WHERE INDICATED. REFER TO FINISH SCHEDULE.
  - ③ ALL RETURN AIR VENTS AND HVAC DIFFUSERS IN CONSTRUCTION AREA TO BE CLEANED. REPLACE ONLY WHERE NECESSARY. REFER TO MECHANICAL.
  - ④ CEILING AREA TO BE NEW DRYWALL FILLED IN TO MATCH HEIGHT, WHERE ACT CEILING WAS.
  - ⑤ NEW EXIT LIGHT REQUIRED. "RED" EXIT SIGN TO MATCH REMAINDER OF BUILDING. REFER TO ELECTRICAL.
  - ⑦ MECHANICAL AND ELECTRICAL DRAWINGS TO OVERRULE THIS REFLECTED CEILING PLAN. REFER TO ELECTRICAL DRAWINGS FOR LIGHTING LAYOUT IF ANY DISCREPANCIES, AND REPORT TO CONTRACTOR ADMINISTRATOR.
  - ⑧ CONTRACTOR TO REMOVE, DISCONNECT AND CAP OFF EXISTING WALL SCONCES.

**NOTES:**

THESE DRAWINGS SHALL NOT BE SCALED.

THE CONTRACTOR SHALL VISIT THE SITE AND SATISFY ONESELF ALL DIMENSIONS, DATUM, AND DETAILED INFORMATION SHOWN ARE CORRECT.

THE CONTRACTOR IS TO REVIEW AND COORDINATE ALL ARCHITECTURAL, MECHANICAL, ELECTRICAL AND STRUCTURAL DRAWINGS FOR ADDITIONAL OPENINGS THROUGH FLOORS, WALLS AND CEILINGS FOR DUCT, PIPE & ELECTRICAL RISERS AND ALL OPENINGS NOT SHOWN ON DRAWINGS.

ALL OPENINGS THROUGH FIRE ASSEMBLIES ARE TO BE FIRE STOPPED AND SEALED WITH ULC APPROVED FIRE STOPPING TO MAINTAIN THE INTEGRITY OF THE FIRE SEPARATION, AND PROVIDE A SMOKE-TIGHT BARRIER.

ALL PRODUCTS AND MATERIALS TO BE USED AND INSTALLED SHALL CONFORM WITH MANUFACTURER'S SPECIFICATIONS & APPLICABLE CODES.

THE CONTRACTOR SHALL BE RESPONSIBLE TO PATCH AND MAKE GOOD ALL EXISTING CONSTRUCTION AFFECTED BY THE REMOVAL OF ALL ITEMS FORMING THE PART OF THE RENOVATION WORK.

WHERE NEW FLOORING AND BASE IS TO BE INSTALLED IN EXISTING AREAS (REFER TO FLOOR PLAN AND ROOM SCHEDULE) THE EXISTING FLOORING SURFACE AND BASE MUST BE REMOVED, UNLESS OTHERWISE NOTED. ALL FLOOR SURFACES SHALL BE PREPARED IN ACCORDANCE TO MANUFACTURER'S RECOMMENDATIONS FOR INSTALLATION OF NEW FLOORING.

WHERE PAINTING OF EXISTING WALLS IS INDICATED ON THE ROOM SCHEDULE, THESE WALLS MUST BE CLEANED OF ANY EXISTING WALL COVERING, PATCHED & PREPARED TO ACCEPT NEW MATERIAL, UNLESS OTHERWISE NOTED.

ORIGINAL STAMPED BY: FIRST LAST, XXXX  
DATE: YEAR.MM.DD

1	ISSUED FOR CONSTRUCTION	MAR. 11 2021
No.	REVISION/DESCRIPTION	BY DATE

DRAWN	CAD	CHECKED	DESIGNED	KJN	APPROVED
DATE	2021.03.01	USER	APPROVAL		

Winnipeg THE CITY OF WINNIPEG  
PLANNING, PROPERTY AND  
DEVELOPMENT DEPARTMENT  
MUNICIPAL ACCOMMODATIONS DIVISION  
3-65 GARRY STREET, R3C 4K4

PROJECT  
PUBLIC WORKS DEPARTMENT  
SECURITY AND ACCESSIBILITY UPGRADES

1155 PACIFIC AVENUE, WINNIPEG, MB. TENDER # 138-2021

SHEET TITLE  
REFLECTED CEILING PLAN

SCALE	PROJECT No:	SHEET No:
1/4"=1'-0"	2019-032	A1.2