

1 NEW FLOOR AND FINISH PLAN SCALE: 1/4"=1'-0"

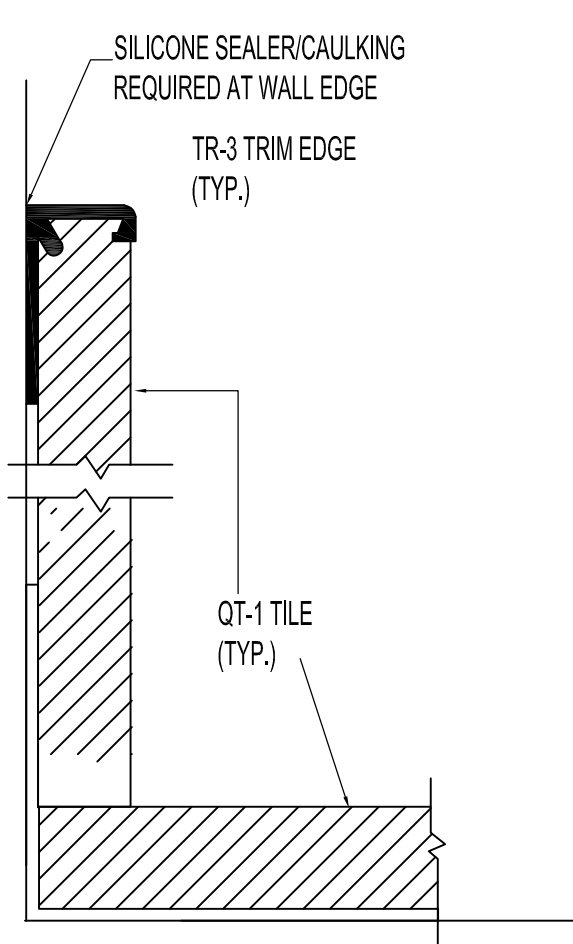

2 TILE SCHLUTER TRIM DETAIL SCALE: N.T.S

FINISH NOTES

- ① ALL FINISHES LISTED ON THE FINISH LEGEND ON DRAWING A1.5 ARE THE SELECTED PRODUCTS OF THE PUBLIC WORKS DEPARTMENT FOR DURABILITY AND FUNCTIONALITY. HOWEVER ALTERNATE FINISHES AND OR PRODUCTS MAY BE CONSIDERED AS AN APPROVED SUBSTITUTE IN ACCORDANCE WITH B7 AS PER THE TENDER DOCUMENTS.
- ② 4" HIGH RUBBER COVERED BASE REQUIRED WITH NEW CARPET TILE. RUBBER BASE TO BE JOHNSONITE REGULAR STANDARD TOE SERIES. 6" HIGH REQUIRED IN RECEPTION 102 ON DESK BASE ONLY.
- ③ QUARRY TILE TO BE INSTALLED IN A "BRICK" LAYOUT AS DRAWN. GROUT TO BE EPOXY GROUT; 4" HIGH QUARRY TILE BASE WHEREVER FLOOR TILE IS LOCATED. FLOOR TO BE SKIM COATED AND FLOATED TO PREPARE FLOOR FOR NEW FLOOR TILE.
- ④ TRANSITION EDGES BETWEEN FLOORING TYPES REQUIRED. REFER TO FINISH LEGEND.
- ⑤ ALL EXISTING WALLS TO BE REPAINTED. LATEX ACRYLIC LOW VOC PAINT REQUIRED. TWO FINISH COATS REQUIRED. PATCH AND FILL ANY EXISTING DAMAGE TO PREPARE WALLS FOR PAINTING.
- ⑥ NEW WALLS TO BE PAINTED WITH ONE PRIMER COAT, TWO FINISH COATS OF LATEX ACRYLIC LOW VOC PAINT REQUIRED. PATCH AND FILL ANY EXISTING HOLES TO PREPARE WALLS FOR PAINTING. PAINT SAMPLES TO BE SUBMITTED FOR APPROVAL TO C.O.W PRIOR TO PAINTING.
- ⑦ EXISTING CHERRY WOOD WALL PANELING TO REMAIN.
- ⑧ NEW WOOD WALL PANELING TO MATCH EXISTING SPECIES REQUIRED. 24" X 24" SQUARE PANELS WITH POLISHED CHROME REVEALS. STAIN SAMPLES TO BE SUBMITTED FOR APPROVAL PRIOR TO CONSTRUCTION.
- ⑨ NEW "STOP SIGN" SOLID RED CARPET TILE INSERT INLAIN INTO NEW CARPET TILE. CPT-2: SHAW CONTRACT
- ⑩ PROVIDE FLOOR EXPANSION JOINT IN TILE. SITE CONFIRM BEST LOCATION TO DEAL WITH FLOOR HEAVE IN VESTIBULE 100. PROVIDE ALLOWANCE FOR EXPANSION JOINTS IN LOBBY 101 AND MEDIA AREA 106. SITE CONFIRM AFTER DEMOLITION IF REQUIRED IN THESE TWO AREAS RECEIVING TILE.
- ⑪ INSTALLATION OF TILE AS PER N.M.S SECTION 09 03 15 PORCELAIN TILING, INCLUDED IN THE TENDER DOCUMENTS

FINISH LEGEND

ACT-1 : ACOUSTIC CEILING TILE
CGC CEILINGS; MARS HIGH NRC LOGIX FIELD PANELS # 86160
COLOR: WHITE
SIZE: 24"x60" (CONFIRM SIZE ON SITE)
EDGE: SQUARE EDGE (SQ)
TO BE INSET INTO EXISTING CEILING GRID

CPT-1: CARPET TILE (MAIN)
MANUFACTURER: SHAW CONTRACT
STYLE: CONSCIOUS TILE 5T359
COLOR: GRAPHITE 58510; SIZE: 18"x36"
INSTALLATION: MONOLITHIC
USE LOW VOC QUICK RELEASE ADHESIVE; CONTRACTOR TO PROVIDE 3 BOXES EXTRA MATERIAL

CG-1: CORNER GUARDS
FROST # MODEL #1117; 4"D x4"W X 40" H
18 GA. STAINLESS STEEL -TYPE 304; # 4 BRUSHED FINISH
PLAM-1: P.E.T IMBEDDED LAMINATE PRODUCT
FORMATIONS INC; ONBORD 3/4" THICK PANELS; SIZE: 4'X9'
COLOR: SERICA MARINE BLUE BL 6230 ; MATTE FINISH
DISTRIBUTED BY FORMATIONS WINNIPEG.

PT-1: PAINT (MAIN)
PRODUCT: DULUX PAINTS
COLOR: DLX1010-2 FOG
FINISH: EGGSHELL- 1 PRIMER COAT, 2 FINISH COATS

PT-2 PAINT (ACCENT WALL COLOR)
PRODUCT: DULUX PAINTS
COLOR: DLX1010-5 DOWNPOUR
FINISH: EGGSHELL- 1 PRIMER COAT, 2 FINISH COATS

PT-3 PAINT (DOOR FRAME COLOR)
PRODUCT: DULUX PAINTS
COLOR: DLX1043-7 BLACK FLAME
FINISH: SEMI-GLOSS- 1 PRIMER COAT, 2 FINISH COATS

PT-4: PAINT (CEILING)
PRODUCT: BENJAMIN MOORE PAINTS REGAL SELECT LATEX PAINT
COLOR: OC-17 WHITE DOVE
FINISH: FLAT- 1 PRIMER COAT, (NEW DRYWALL) 2 FINISH COATS

QT-1: QUARRY TILE
PRODUCT: OLYMPIA TILE ARKISTONE SERIES; 12"x24"
COLOR: SILVER MC.AK.SK 1224 MT
GROUT TO BE MAPEI EPOXY GROUT; COLOR TO BE SELECTED.
4" HIGH QUARRY TILE BASE
INSTALLATION: BRICK LAYOUT AS DRAWN.

RB-1: RUBBER BASE
JOHNSONITE STANDARD TOE WALL BASE
HEIGHT: 4" HIGH
COLOR: FROM COLOR GROUP A-TO BE SELECTED.

RB-2: RUBBER BASE
JOHNSONITE STANDARD TOE WALL BASE
HEIGHT: 6" HIGH
COLOR: FROM COLOR GROUP A-TO BE SELECTED.

SS-1: SOLID SURFACE COUNTERTOP
PRODUCT: WILSONART SOLID SURFACE
COLOR: 9208CS WHITE STONE
SHEEN/ FINISH LEVEL: MATTE
THICKNESS: 0.50" THICK

ST-1: WOOD STAIN
COLOR TO MATCH EXISTING DOORS AND WOOD PANELS ON SITE. CONTRACTOR TO PROVIDE COLOR SAMPLES ON SPECIFIED WOOD VENEER FOR APPROVAL.

TR-1: ADAPTOR TRANSITION STRIP - CARPET TO CARPET
JOHNSONITE CTA-XX-A; COLOR TO BE SELECTED BY C.O.W
CONTRACTOR TO ENSURE PROFILE TO SUIT TRANSITION

TR-2: WHEELED TRAFFIC TRANSITION STRIP- CARPET TO TILE
JOHNSONITE CTA-XX-J; COLOR TO BE SELECTED BY C.O.W
CONTRACTOR TO ENSURE PROFILE TO SUIT TRANSITION

TR-3: EDGE GUARD
SCHLUTER SCHIENE -A EDGE PROFILE
CONTRACTOR TO ENSURE PROFILE TO SUIT TRANSITION

WF-1: INTERIOR COLORED WINDOW FILM
MACTAC COLORED GLASS FILM- CITY OF WINNIPEG BLUE
LOCATION:OFFICE /MEETING ROOM WINDOWS

NOTES:
THESE DRAWINGS SHALL NOT BE SCALED.
THE CONTRACTOR SHALL VISIT THE SITE AND SATISFY HIMSELF ALL DIMENSIONS, DATUM, AND DETAILED INFORMATION SHOWN ARE CORRECT.
THE CONTRACTOR IS TO REVIEW AND COORDINATE ALL ARCHITECTURAL, MECHANICAL, ELECTRICAL, AND STRUCTURAL DRAWINGS FOR ADDITIONAL OPENINGS THROUGH FLOORS, WALLS, AND CEILINGS FOR DUCT, PIPE & ELECTRICAL RISERS AND ALL OPENINGS NOT SHOWN ON DRAWINGS.
ALL OPENINGS THROUGH FIRE ASSEMBLIES ARE TO BE FIRE STOPPED AND SEALED WITH ULC APPROVED FIRE STOPPING TO MAINTAIN THE INTEGRITY OF THE FIRE SEPARATION, AND PROVIDE A SMOKE-TIGHT BARRIER.
ALL PRODUCTS AND MATERIALS TO BE USED AND INSTALLED SHALL CONFORM WITH MANUFACTURER'S SPECIFICATIONS & APPLICABLE CODES.
THE CONTRACTOR SHALL BE RESPONSIBLE TO PATCH AND MAKE GOOD ALL EXISTING CONSTRUCTION AFFECTED BY THE REMOVAL OF ALL ITEMS FORMING THE PART OF THE RENOVATION WORK.
WHERE NEW FLOORING AND BASE IS TO BE INSTALLED IN EXISTING AREAS REFER TO FLOOR PLAN AND ROOM SCHEDULE THE EXISTING FLOORING SURFACE AND BASE MUST BE REMOVED, UNLESS OTHERWISE NOTED. ALL FLOOR SURFACES SHALL BE PREPARED IN ACCORDANCE TO MANUFACTURER'S RECOMMENDATIONS FOR INSTALLATION OF NEW FLOOR.
WHERE PAINTING OF EXISTING WALLS IS INDICATED ON THE ROOM SCHEDULE, THESE WALLS MUST BE CLEANED OF ANY EXISTING WALL COVERING, PATCHED & PREPARED TO ACCEPT NEW MATERIAL, UNLESS OTHERWISE NOTED.

ORIGINAL STAMPED BY: FIRST LAST, XXXX
DATE: YEAR.MM.DD

1	ISSUED FOR CONSTRUCTION	MAR. 1, 2021
No.	REVISION/DESCRIPTION	BY DATE

ROOM FINISH SCHEDULE

ROOM NO.	ROOM NAME	FLOOR	BASE	NORTH WALL	SOUTH WALL	EAST WALL	WEST WALL	CEILING	CEILING HEIGHT	NOTES
100	VESTIBULE	QT-1	QT-1	PT-1	PT-1	PT-1	PT-1	PT-4	8'-6"	NOTE:3
101	LOBBY	QT-1	QT-1	N/A	PT-1	PT-1	PT-1	PT-4	8'-6"	NOTE:3
102	RECEPTION/ PERMITS	QT-1	QT-1	WD	N/A	PT-1	PT-1	PT-4		NOTE:1
103	CORRIDOR	CPT-1	RB-1	PT-2	N/A	PT-1	PT-2	ACT-1/PT-4	8'-6"	NOTE:1
104	MEETING ROOM	CPT-1	RB-1	PT-1	PT-1	GL/ PT-1	PT-2	ACT-1	8'-6"	NOTE:1
105	PARKS BOOKING OFFICE	CPT-1	RB-1	PT-1	PT-1	GL/ PT-1	ST-1/PT-2	ACT-1	8'-6"	NOTE:1
106	MEDIA AREA	QT-1	QT-1	PT-2	PT-2	PT-1	WD/ST-1	ACT-1	8'-6"	NOTE:1
107	OPEN OFFICE AREA	EX	EX	PT-2	EX	PT-2	N/A	EX	8'-6"	NOTE:1NOTE:4
111	OPEN OFFICE AREA	EX	EX	N/A	PT-2	N/A	N/A	EX	8'-6"	NOTE:1NOTE:4

ABBREVIATIONS: ACT. -ACOUSTIC TILE CPT - CARPET TILE EX.- EXISTING GL. - GLASS PT. -PAINT RB.- RUBBER BASE
QT.- QUARRY TILE ST- STAINED WOOD WD.- EXISTING WOOD PANELS

NOTE: 1- ALL NEW DOORS ARE MAPLE WOOD VENEER AND TO BE STAINED TO MATCH EXISTING. FRAMES TO BE HOLLOW METAL PAINTED PT-3.
NOTE: 2- REFER TO INTERIOR ELEVATIONS FOR PAINT LOCATIONS.
NOTE: 3- LOBBY AND VESTIBULE DOORS AND FRAMES PREFINISHED AND NOT TO BE PAINTED
NOTE: 4- BOTH SIDES OF NEW WALL TO BE PAINTED.

DRAWN: KJN CHECKED: KJN DESIGNED: KJN APPROVED: KJN
DATE: 2021.03.01 USER APPROVAL

THE CITY OF WINNIPEG
PLANNING, PROPERTY AND
DEVELOPMENT DEPARTMENT
MUNICIPAL ACCOMMODATIONS DIVISION
3-65 GARRY STREET, R3C 4K4

PROJECT
PUBLIC WORKS DEPARTMENT
SECURITY AND ACCESSIBILITY UPGRADES

1155 PACIFIC AVENUE, WINNIPEG, MB. TENDER # 139-2021

SHEET TITLE
FLOOR AND FINISH PLAN
INTERIOR FINISHES