

NOTE: CHAINAGES SHOWN ARE ALONG CENTRE LINE OF ROW



WATER SERVICE INFORMATION

ADDRESS	PIPE SIZE & MATERIAL (STREET)	PIPE SIZE & MATERIAL (PROP.)	SHORT & LONG MEASUREMENT	CORP. LOCATION	REMARKS
862 SELKIRK AVE	25	25	0.82 SNL OF FOUNDATION	OPP S/C	RECONNECT SERVICE
RESIDENTIAL	CU	CU	3.75 SSL OF SELKIRK		

\* SERVICES TO BE RENEWED TO R

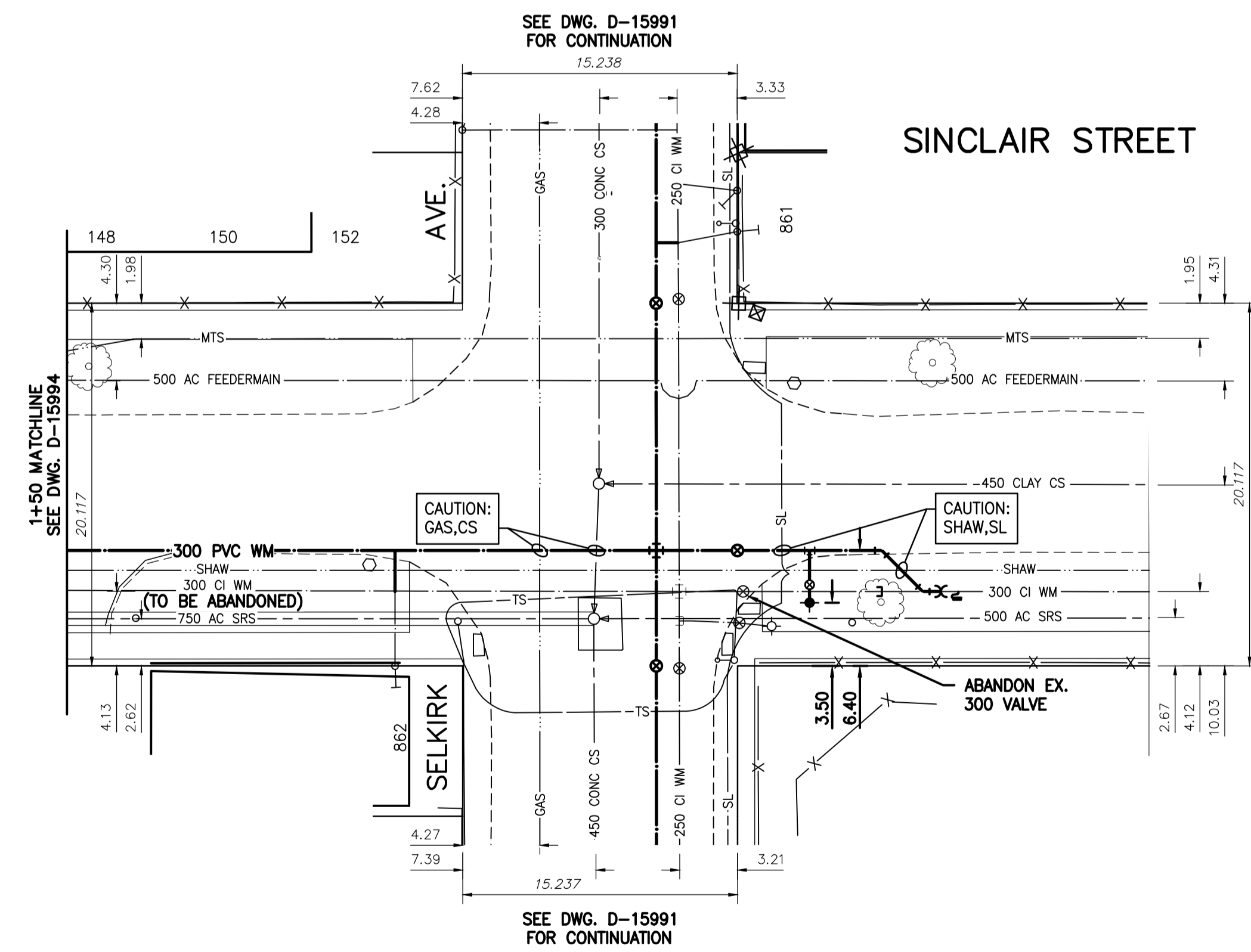

NOTE: VALVES TO BE INSTALLED COUNTER-CLOCKWISE TO CLOSE



LOCATION APPROVED UNDERGROUND STRUCTURES

SUPV. U/G STRUCTURES COMMITTEE DATE

NOTE: LOCATION OF UNDERGROUND STRUCTURES AS SHOWN ARE BASED ON THE BEST INFORMATION AVAILABLE BUT NO GUARANTEE IS GIVEN THAT ALL EXISTING UTILITIES ARE SHOWN OR THAT THE GIVEN LOCATIONS ARE EXACT. CONFIRMATION OF EXISTENCE AND EXACT LOCATION OF ALL SERVICES MUST BE OBTAINED FROM THE INDIVIDUAL UTILITIES BEFORE PROCEEDING WITH CONSTRUCTION.

B.M. 25-11 N.W. Cor. Arlington St. & Selkirk Ave., Tolt. In S. Conc. Foundation of King Edward Community School, 0.5 m W. & 0.1 m below Tyn dall Stone of the most S. Ety. Cor. of School.

NO.	REVISIONS	DATE	BY
03	ISSUED FOR TENDER	2021.04.09	RS
02	ISSUED FOR 66% REVIEW	2021.03.19	RS
01	ISSUED FOR 30% REVIEW	2021.03.05	RS

DESIGNED BY	RS	CHECKED BY	RS
DRAWN BY	SC	APPROVED BY	RS
SCALE:	HORIZONTAL 1:250 VERTICAL 1:50		
DATE	2019.01.15	DATE	

ENGINEER'S SEAL

CONSULTANT DRAWING NUMBER

C-212

**THE CITY OF WINNIPEG**  
WATER AND WASTE DEPARTMENT  
ENGINEERING DIVISION

2021 WATERMAIN RENEWALS  
CONTRACT 6  
**SINCLAIR STREET**  
50 N OF FLORA AVENUE TO  
SELKIRK AVENUE

SHEET 14 OF 14  
CITY DRAWING NUMBER  
D-15995

