

SPEERS RD

BERNIER BAY (N-LEG)

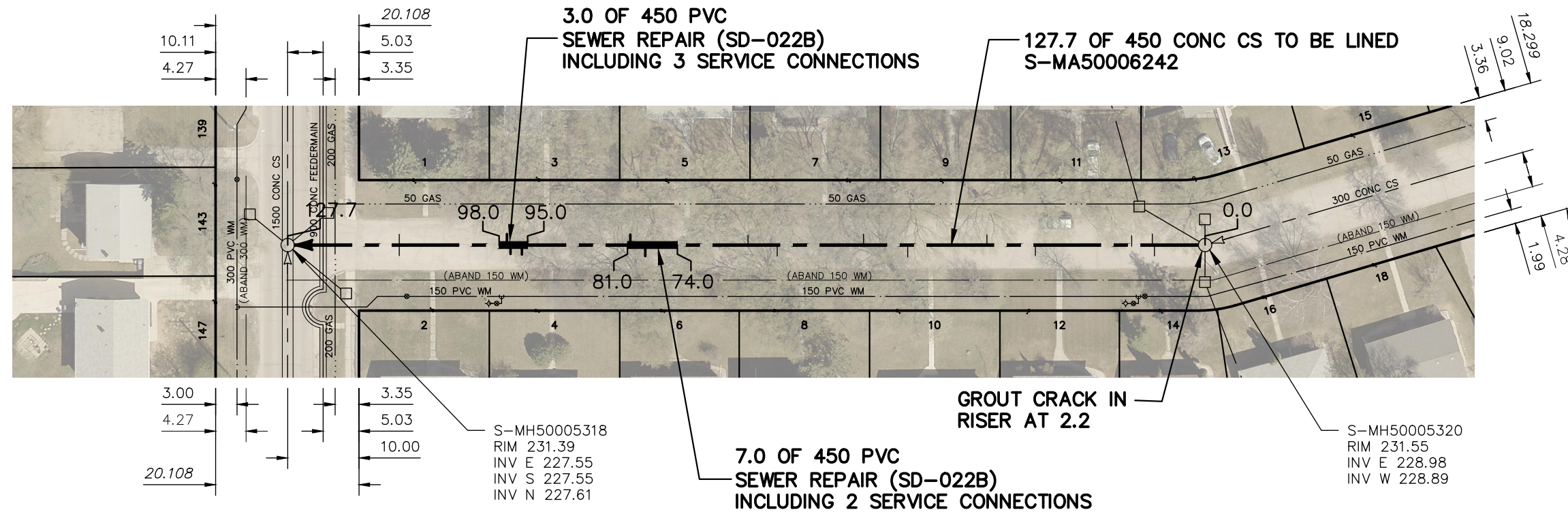

SEWER JUNCTION INFORMATION FROM SEWER VIDEO INSPECTION		
SEWER ID S-MA50006242		
DISTANCE FROM MH ID S-MH50005320		
DISTANCE	DIAMETER	CLOCK
7.1	150	2
7.4	150	10
10.3	150	10
23.8	150	2
30.6	150	10
41.7	150	2
47.9	150	10
60.0	150	2
64.1	150	10
78.5	150	2
80.6	150	10
95.8	150	2
97.4	150	2
97.9	150	10
113.0	150	2
113.0	150	10

WARNING

IF POWER EQUIPMENT OR EXPLOSIVES ARE TO BE USED FOR EXCAVATION ON THIS PROJECT THE CONTRACTOR MUST:

- 1) NOTIFY THE GAS COMPANY OF THE PROPOSED LOCATION OF EXCAVATION.
- 2) TAKE PRECAUTION TO AVOID DAMAGE TO GAS COMPANY INSTALLATIONS.

SEE PROVINCIAL REGULATION 210/72 FOR DETAILS

FOR INDEX SEE 12674

METRIC

WHOLE NUMBERS INDICATE MILLIMETRES
DECIMALIZED NUMBERS INDICATE METRES



LOCATION APPROVED
UNDERGROUND STRUCTURES

B.M.
ELEV.

SUPV. U/G STRUCTURES COMMITTEE DATE

NOTE:

LOCATION OF UNDERGROUND STRUCTURES AS SHOWN ARE BASED ON THE BEST INFORMATION AVAILABLE BUT NO GUARANTEE IS GIVEN THAT ALL EXISTING UTILITIES ARE SHOWN OR THAT THE GIVEN LOCATIONS ARE EXACT. CONFIRMATION OF EXISTENCE AND EXACT LOCATION OF ALL SERVICES MUST BE OBTAINED FROM THE INDIVIDUAL UTILITIES BEFORE PROCEEDING WITH CONSTRUCTION.

NO.	REVISIONS	DATE	BY

DESIGNED BY	SC	CHECKED BY	SC
DRAWN BY	AJ	APPROVED BY	KZ
SCALE:		RELEASED FOR CONSTRUCTION	
HORIZONTAL	1:750	K.ZUREK	
VERTICAL		DATE	2021-04-16
DATE	2021 04 16	DATE	2021-04-16

ENGINEER'S SEAL

ORIGINAL
SIGNED BY
**S.R.J.
COURNOYER**
2021/04/16

CONSULTANT DRAWING NUMBER



THE CITY OF WINNIPEG
WATER AND WASTE DEPARTMENT
ENGINEERING DIVISION

2021 SEWER RENEWALS BY CIPP LINING
CONTRACT No.9
BERNIER BAY (N-LEG)
1ST MH E OF SPEERS ROAD TO
MH AT SPEERS ROAD

SHEET **6** OF **57**
CITY DRAWING NUMBER

12679

PLOT DATE: 2021 04 16

BID OPPORTUNITY: 218-2021
CONTRACT NUMBER: 9

FILE PATH: R:\DRAWINGS\SEWER\2021 RENEWALS\CIPP LINING\CONTRACT #9\Construction Dwg\
FILE NAME: BERNIER BAY S (N SIDE).dwg