

GLEN AVENUE

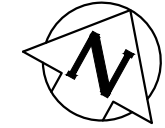

ST MARYS RD.

KILLARNEY ST

69.9 OF 450 CLAY CS TO BE LINED
S-MA50017782

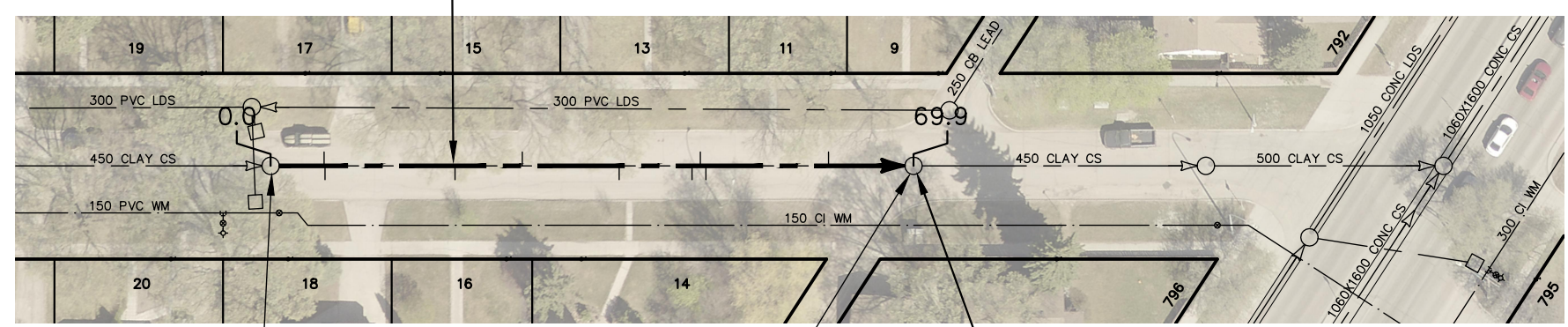

S-MH50014380
RIM 231.38
INV E 227.00
INV W 227.06

S-MH50014390
RIM 231.47
INV E 226.84
INV W 226.84

REPLACE FRAME
GROUT CRACK IN RISER
FROM 4.0-4.5

SEWER JUNCTION INFORMATION FROM SEWER VIDEO INSPECTION		
SEWER ID S-MA50017782		
DISTANCE FROM MH ID S-MH50014380		
DISTANCE	DIAMETER	CLOCK
5.8	150	2
5.9	150	10
20.0	150	10
27.3	150	1
37.8	150	10
45.7	150	10
46.6	150	2
47.2	150	11
60.5	150	1

WARNING

IF POWER EQUIPMENT OR EXPLOSIVES ARE TO BE USED FOR EXCAVATION ON THIS PROJECT THE CONTRACTOR MUST:

- 1) NOTIFY THE GAS COMPANY OF THE PROPOSED LOCATION OF EXCAVATION.
- 2) TAKE PRECAUTION TO AVOID DAMAGE TO GAS COMPANY INSTALLATIONS.

SEE PROVINCIAL REGULATION 210/72 FOR DETAILS

FOR INDEX SEE
12674

METRIC

WHOLE NUMBERS INDICATE MILLIMETRES
DECIMALIZED NUMBERS INDICATE METRES



LOCATION APPROVED UNDERGROUND STRUCTURES

SUPV. U/G STRUCTURES COMMITTEE DATE

NOTE:
LOCATION OF UNDERGROUND STRUCTURES AS SHOWN ARE BASED ON THE BEST INFORMATION AVAILABLE BUT NO GUARANTEE IS GIVEN THAT ALL EXISTING UTILITIES ARE SHOWN OR THAT THE GIVEN LOCATIONS ARE EXACT. CONFIRMATION OF EXISTENCE AND EXACT LOCATION OF ALL SERVICES MUST BE OBTAINED FROM THE INDIVIDUAL UTILITIES BEFORE PROCEEDING WITH CONSTRUCTION.

NO.	REVISIONS	DATE	BY

DESIGNED BY	SC	CHECKED BY	SC
DRAWN BY	AJ	APPROVED BY	KZ
SCALE:		RELEASED FOR CONSTRUCTION	
HORIZONTAL	1:750	K.ZUREK	DATE 2021-04-16
VERTICAL			
PLOT DATE: 2021 04 16		DATE 2021-04-16	

ENGINEER'S SEAL

ORIGINAL SIGNED BY
S.R.J. COURNOYER
2021/04/16

CONSULTANT DRAWING NUMBER



THE CITY OF WINNIPEG

WATER AND WASTE DEPARTMENT
ENGINEERING DIVISION

2021 SEWER RENEWALS BY CIPP LINING
CONTRACT No.9
GLEN AVENUE
1ST MH E OF KILLARNEY STREET TO
2ND MH W OF ST MARYS ROAD

SHEET 31 OF 57
CITY DRAWING NUMBER
12706