

- CONSTRUCTION NOTES:**
- ALL WORK AND MATERIALS IN ACCORDANCE WITH LATEST REVISION OF THE CITY OF WINNIPEG STANDARD CONSTRUCTION SPECIFICATIONS.
  - ALL DIMENSIONS ARE TO BACK OF CURB.
  - ISOLATE MISCELLANEOUS ITEMS IN NEW CONCRETE WORKS AS PER SD-228C.
  - LEGAL PLAN AND UNDERGROUND INFORMATION FROM CITY OF WINNIPEG LBIS. CONTRACTOR TO VERIFY ALL UNDERGROUNDS IN THE FIELD.
  - CONTRACTOR TO TAKE PRECAUTIONARY STEPS TO AVOID DAMAGE FROM CONSTRUCTION ACTIVITIES TO TREES WITHIN THE LIMITS OF CONSTRUCTION.
  - LOCATION OF EXISTING SERVICES TO BE CONFIRMED IN THE FIELD BY THE CONTRACTOR.
  - CB LEADS TO BE INSTALLED AT MIN. 1.0% SLOPE OR AS DIRECTED BY CONTRACT ADMINISTRATOR.
  - LIMITS OF CURB AND SIDEWALK RENEWAL TO BE FINALIZED IN THE FIELD BY THE CONTRACT ADMINISTRATOR.
  - LIMITS OF BOULEVARD GRADING TO BE FINALIZED IN THE FIELD BY THE CONTRACT ADMINISTRATOR.
  - ADJUST ALL WATER VALVES, MANHOLES, CATCH BASINS, CATCH PITS, AND WATER SERVICE SHUT OFF VALVES TO GRADE.
  - ALL PRIVATE WALKWAYS ADJUSTED TO NEW SIDEWALK OR TOP OF CURB ELEVATION, AS REQUIRED.
  - MODIFIED BARRIER CURB TO BE CONSTRUCTED AT ALL INTERSECTION RADI AND BACK LANE RADI.
  - LAMP STANDARDS, HYDRO POLES AND ANCHORS THAT REQUIRE TEMPORARY SUPPORT, REMOVAL OR REPLACEMENT, ARE TO BE DONE AT THE EXPENSE OF THE CONTRACTOR, AS NECESSARY.
  - SEE SHEET 12 FOR TYPICAL PANDORA AVE. SECTION.

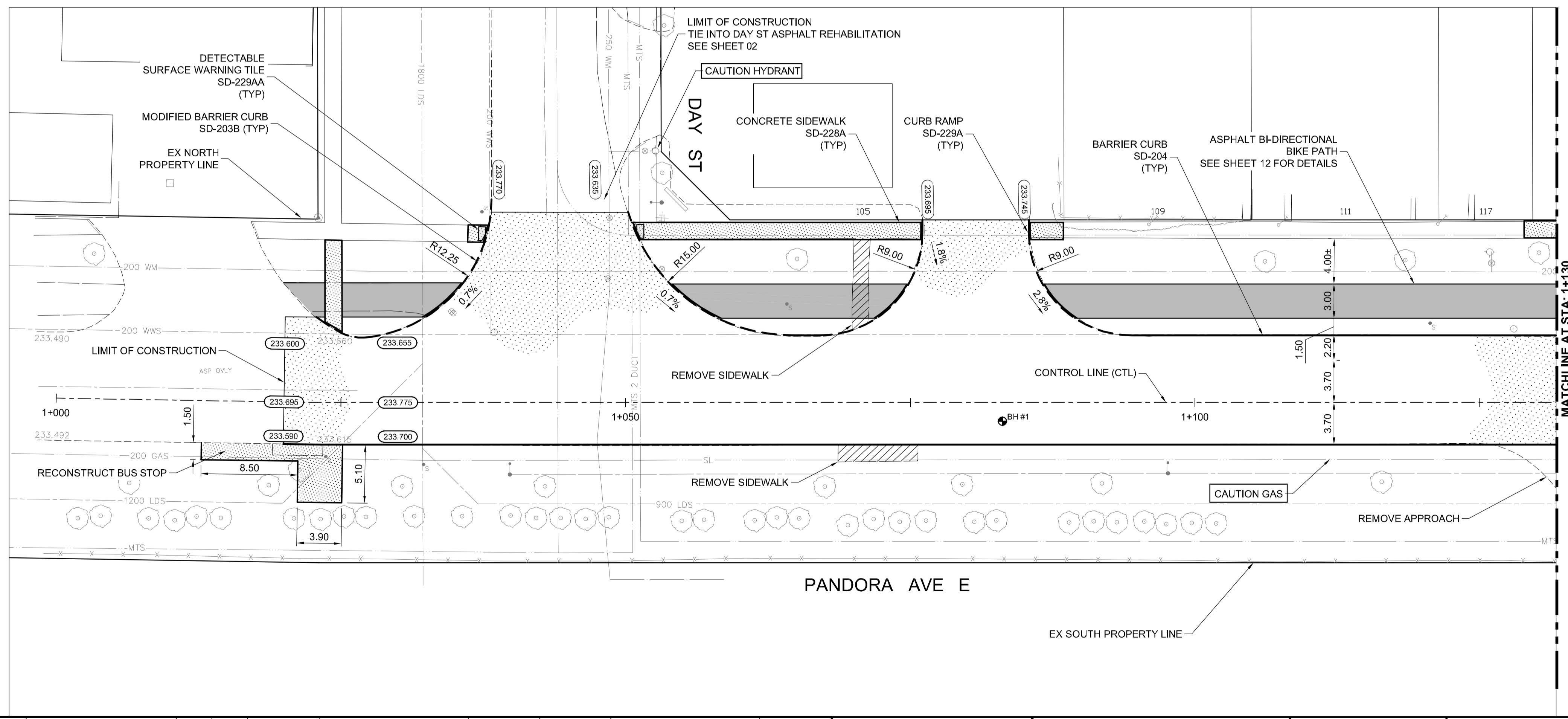

**ENGINEERS GEOSCIENTISTS MANITOBA**  
 Certificate of Authorization  
**Dillon Consulting Limited (MB)**  
 No. 1789 Date: 2021/03/11

**ABBREVIATIONS:**

CONC	CONCRETE ROADWAY
ASP	ASPHALT ROADWAY
ASP OVLY	ASPHALT OVERLAY ROADWAY
GRAN	GRANULAR ROADWAY
PVS	PAVING STONE/BRICK
CSW	CONCRETE SIDEWALK
ASW	ASPHALT SIDEWALK
GSW	GRANULAR SIDEWALK
TYP	TYPICAL SIDEWALK
EX	EXISTING
MH	MANHOLE
WV	WATER VALVE
EL	ELEVATION
CB	CATCH BASIN
CP	CATCH PIT
CI	CURB INLET
CL	CONTROL LINE

**METRIC**

WHOLE NUMBERS INDICATE MILLIMETRES  
 DECIMALIZED NUMBERS INDICATE METRES

**WARNING**

- IF POWER EQUIPMENT OR EXPLOSIVES ARE TO BE USED FOR EXCAVATION ON THIS PROJECT THE CONTRACTOR MUST:
- NOTIFY THE GAS COMPANY OF THE PROPOSED LOCATION OF EXCAVATION.
  - TAKE PRECAUTION TO AVOID DAMAGE TO GAS COMPANY INSTALLATIONS SEE PROVINCIAL REGULATION 210/72 FOR DETAILS.
  - OBTAIN EXCAVATION PERMITS PRIOR TO CONSTRUCTION.

EXISTING	LEGEND-PLAN	PROPOSED	EXISTING	LEGEND-PLAN	PROPOSED	EXISTING	LEGEND-PROFILE	PROPOSED
	HYDRANT			CONCRETE			WATERMAIN	
	VALVE			ASPHALT			LAND DRAINAGE SEWER	
	MANHOLE			SIDEWALK			WASTE WATER SEWER	
	CATCH BASIN			PAVING STONES			HYDRANT	
	CATCH PIT			PAVEMENT REPAIR FABRIC			VALVE	
	WATERMAIN			PROPERTY LINE			PROFILE	
	LAND DRAINAGE SEWER			ELEVATION			NORTH/WEST GUTTER	
	WASTE WATER SEWER			TRAFFIC SIGNAL			SOUTH/EAST GUTTER	
	HYDRO			SURVEY BAR			NORTH/WEST DITCH	
	M.T.S.			CURB RAMP			SOUTH/EAST DITCH	
	GAS			DETECTABLE TILE				

**UNDERGROUND STRUCTURES**

APPROVED BY UGS 2021/03/11  
 SUPV. U/G STRUCTURES DATE

LOCATION OF UNDERGROUND STRUCTURES AS SHOWN ARE BASED ON THE BEST INFORMATION AVAILABLE, BUT NO GUARANTEE IS GIVEN THAT ALL EXISTING UTILITIES ARE SHOWN OR THAT THE GIVEN LOCATIONS ARE EXACT. CONFIRMATION OF EXISTENCE AND EXACT LOCATION OF ALL SERVICES MUST BE OBTAINED FROM THE INDIVIDUAL UTILITIES BEFORE PROCEEDING WITH CONSTRUCTION.

NO.	REVISIONS	DATE	BY
1	ISSUED FOR TENDER	21/03/11	TJP

DESIGNED BY	MRF
DRAWN BY	PMW
CHECKED BY	KP
APPROVED BY	TJP
HOR. SCALE	1:250
VERTICAL	1:10

**DILLON CONSULTING**

REGISTERED PROFESSIONAL ENGINEER

PROVINCE OF MANITOBA  
 CERTIFICATE OF AUTHORIZATION  
**T.J. PETERS**  
 2021/03/11  
 Member 22309

**THE CITY OF WINNIPEG PUBLIC WORKS DEPARTMENT**

2021 DAY/PANDORA PAVEMENT RENEWAL PROJECT  
 PANDORA CONCRETE RECONSTRUCTION  
 DAY STREET TO WAYOATA STREET

CITY DRAWING NUMBER P-3540-2021-04  
 SHEET 04 OF 14  
 CONSULTANT DRAWING NUMBER

PANDORA AVE. EAST PLAN PROFILE  
 (START TO STA: 1+130)

CONSULTANT PROJECT NUMBER 20-2914