

**PROFILE - ALLEY PAVEMENT**

Scale H=1:250 V=1:10

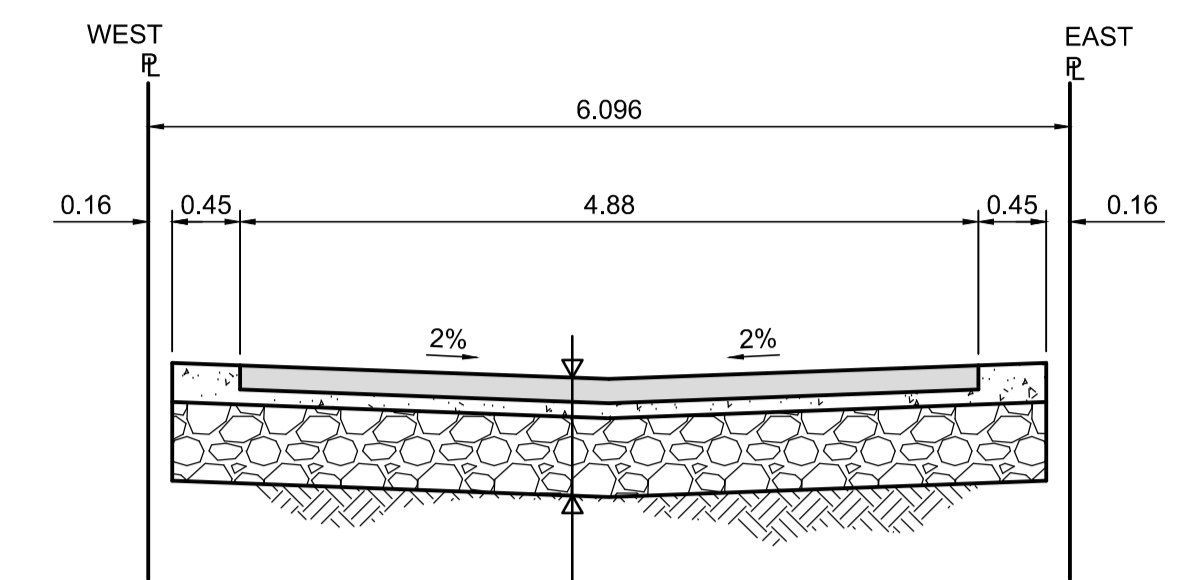

**SECTION - TYPICAL**

Scale NTS

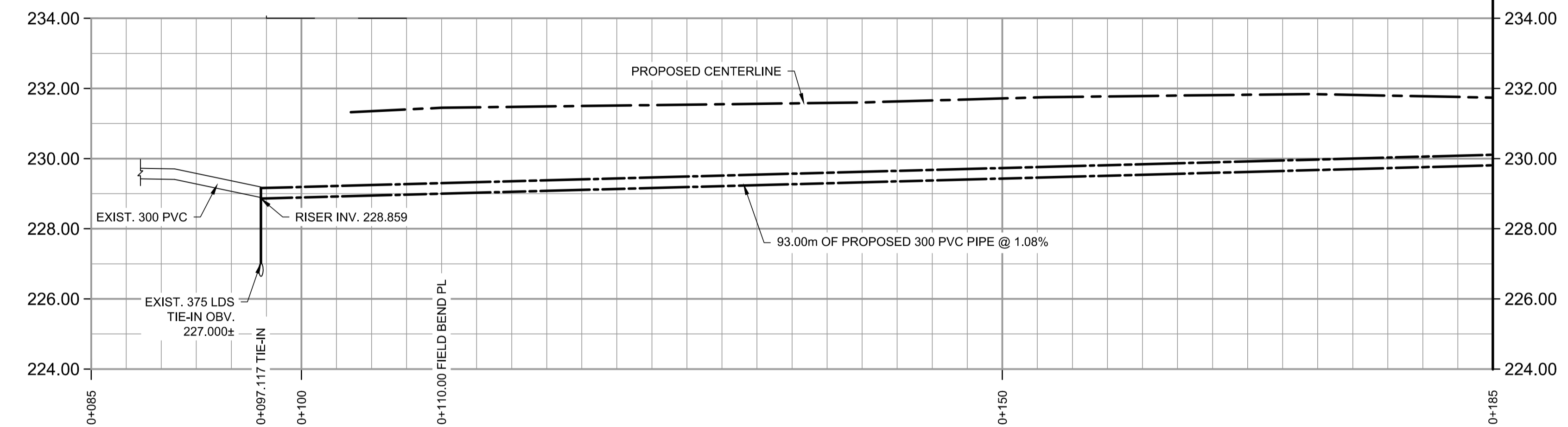

**PROFILE - ALLEY DRAINAGE**

Scale H=1:250 V=1:100

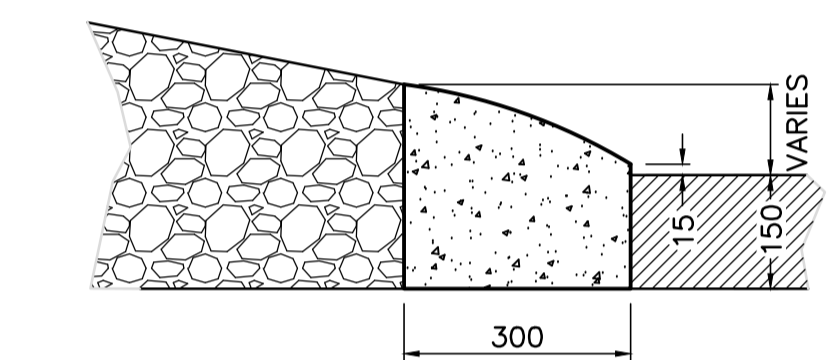

**DETAIL - LIP CURB (MONOLITHIC)**

Scale NTS

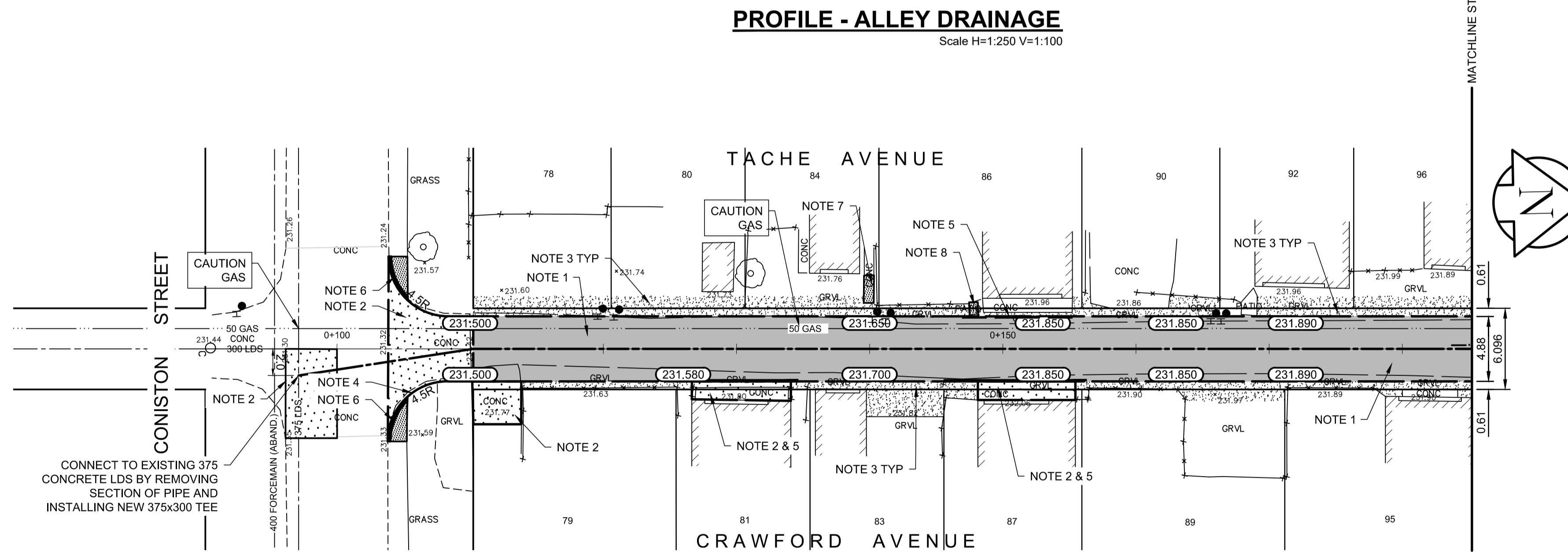

**PLAN - ALLEY**

Scale 1:250

**REFERENCE NOTES:**

- A. PAVEMENT DIMENSIONS ARE TO BACK OF CURB
- B. BASELINE IS CENTRE LINE OF 6.096m WIDE RIGHT OF WAY
- C. PROPERTY LINES OBTAINED FROM CITY OF WINNIPEG L.B.I.S., AND NO SCALE FACTOR WAS APPLIED
- D. REFER TO AECOM FIELD BOOK NO. 5097

**CONSTRUCTION NOTES:**

- 1. CONSTRUCT NEW ASPHALT PAVEMENT AS PER TYPICAL SECTION
- 2. REMOVE EXISTING CONCRETE PAVEMENT AND CONSTRUCT NEW 150mm REINFORCED CONCRETE PAVEMENT
- 3. REGRADE EXISTING GRAVEL SURFACE WITH BASE COURSE
- 4. CONSTRUCT NEW MODIFIED BARRIER CURB (180mm HT. INTEGRAL)
- 5. CONSTRUCT NEW LIP CURB (MONOLITHIC) AS PER DETAIL
- 6. CONSTRUCT NEW CURB RAMP (10mm HT. INTEGRAL)
- 7. RENEW EXISTING CONCRETE SIDEWALK
- 8. REGRADE EXISTING PATIO BLOCKS

**ENGINEERS**  
**GEOSCIENTISTS**  
**MANITOBA**  
Certificate of Authorization  
AECOM Canada Ltd.  
No. 4671 Date:

**PRELIMINARY**  
NOT FOR CONSTRUCTION

Date: 2021/07/20

**METRIC**

WHOLE NUMBERS INDICATE MILLIMETRES  
DECIMALIZED NUMBERS INDICATE METRES

150 mm W.M.	WATERMAIN	150 mm W.M.	HYDRO	— x —	PROFILE
Hydrant	HYDRANT	Hydrant	M.T.S.	North/West Gutter	NORTH/WEST GUTTER
Valve	VALVE	Valve	CONCRETE	South/East Gutter	SOUTH/EAST GUTTER
300mm L.D.S.	LAND DRAINAGE SEWER	300mm L.D.S.	ASPHALT	N/W PROPERTY LINE	N/W PROPERTY LINE
250mm W.W.S.	WASTEWATER SEWER	250mm W.W.S.	GRAVEL	S/E PROPERTY LINE	S/E PROPERTY LINE
Manhole	MANHOLE	Manhole	SURVEY BAR		
Catch Basin	CATCH BASIN	Catch Basin	ELEVATION		
Catch Pit	CATCH PIT	Catch Pit	TREE		
Property Line	PROPERTYLINE	Property Line	SIDEWALK RAMP		
Culvert	CULVERT	Culvert	CONCRETE SIDEWALK		
Gas	GAS	Gas	FENCE		
EXISTING	LEGEND - PLAN	PROPOSED	LEGEND - PLAN	PROPOSED	EXISTING
	LEGEND - PROFILE		LEGEND - PROFILE		PROPOSED

**LOCATION APPROVED UNDERGROUND STRUCTURES**

NOTE:  
LOCATION OF UNDERGROUND STRUCTURES AS SHOWN ARE BASED ON THE BEST INFORMATION AVAILABLE, BUT NO GUARANTEE IS GIVEN THAT ALL EXISTING UTILITIES ARE SHOWN OR THAT THE GIVEN LOCATIONS ARE EXACT. CONFIRMATION OF EXISTENCE AND EXACT LOCATION OF ALL SERVICES MUST BE OBTAINED FROM THE INDIVIDUAL UTILITIES BEFORE PROCEEDING WITH CONSTRUCTION.

B.M. ELEV.	88R519 - W. SIDE CHAIRING CROSS CRES. S. OF S. LEG OF STRAND CIRCLE. TBLT. ON TOP OF 0.05m sq. x 2.4m IRON TUBE. 7.5m E. OF E. WALL & 15.8m S. OF S. WALL NO. 119 STRAND CIRCLE. OR 35.38m S. OF S.L. STRAND CIRCLE & 5.9m E. OF W.L. CHAIRING CROSS CRES. ELEVATION: 232.430
NO.	REVISIONS
0	ISSUED FOR TENDER 07/20/2021 RC
A	ISSUED FOR REVIEW 07/08/2021 BC
DATE	2021/06/16

DESIGNED BY	BC	CHECKED BY	RC
DRAWN BY	RAM/PAAP	APPROVED BY	RC
HOR. SCALE:	1:250	ORIGINAL SIGNED BY:	
VERTICAL:	AS SHOWN	DATE	2021/06/16

ENGINEER'S SEAL  
PROVINCE OF MANITOBA  
**R. T. CUNNINGHAM**  
Member 24711  
REGISTERED PROFESSIONAL ENGINEER

**THE CITY OF WINNIPEG**  
PUBLIC WORKS DEPARTMENT  
ENGINEERING DIVISION

2021 LOCAL IMPROVEMENT ALLEYS

CRAWFORD AVE. / TACHE AVE. ALLEY - CONISTON ST. TO HIGHFIELD ST.  
LOCAL IMPROVEMENT  
STA. 0+100 TO STA. 0+185

CITY DRAWING NUMBER  
SHEET 01 OF 04