

NOTE:
 PROVIDE INDENT IN CONC SIDEWALK AT INSIDE OF STEEL GUARD TO
 ENSURE SHIPPING CONTAINER DOORS ARE OPERABLE.
 COORDINATE W/ SLOPE AWAY FROM BUILDING (REFER TO CIVIL)

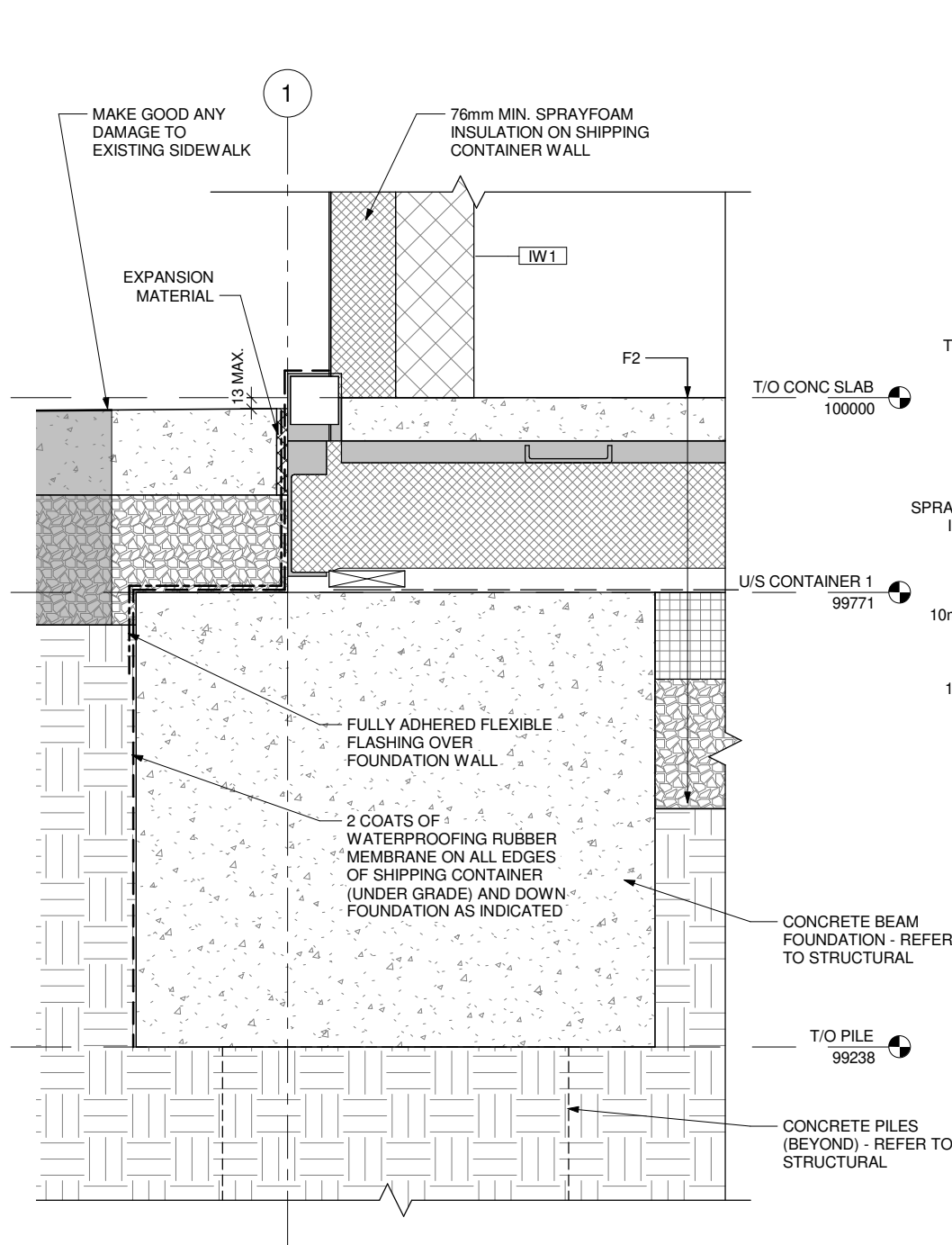

1 SECTION DETAIL - FOUNDATION AT EXISTING SIDEWALK
 1:8

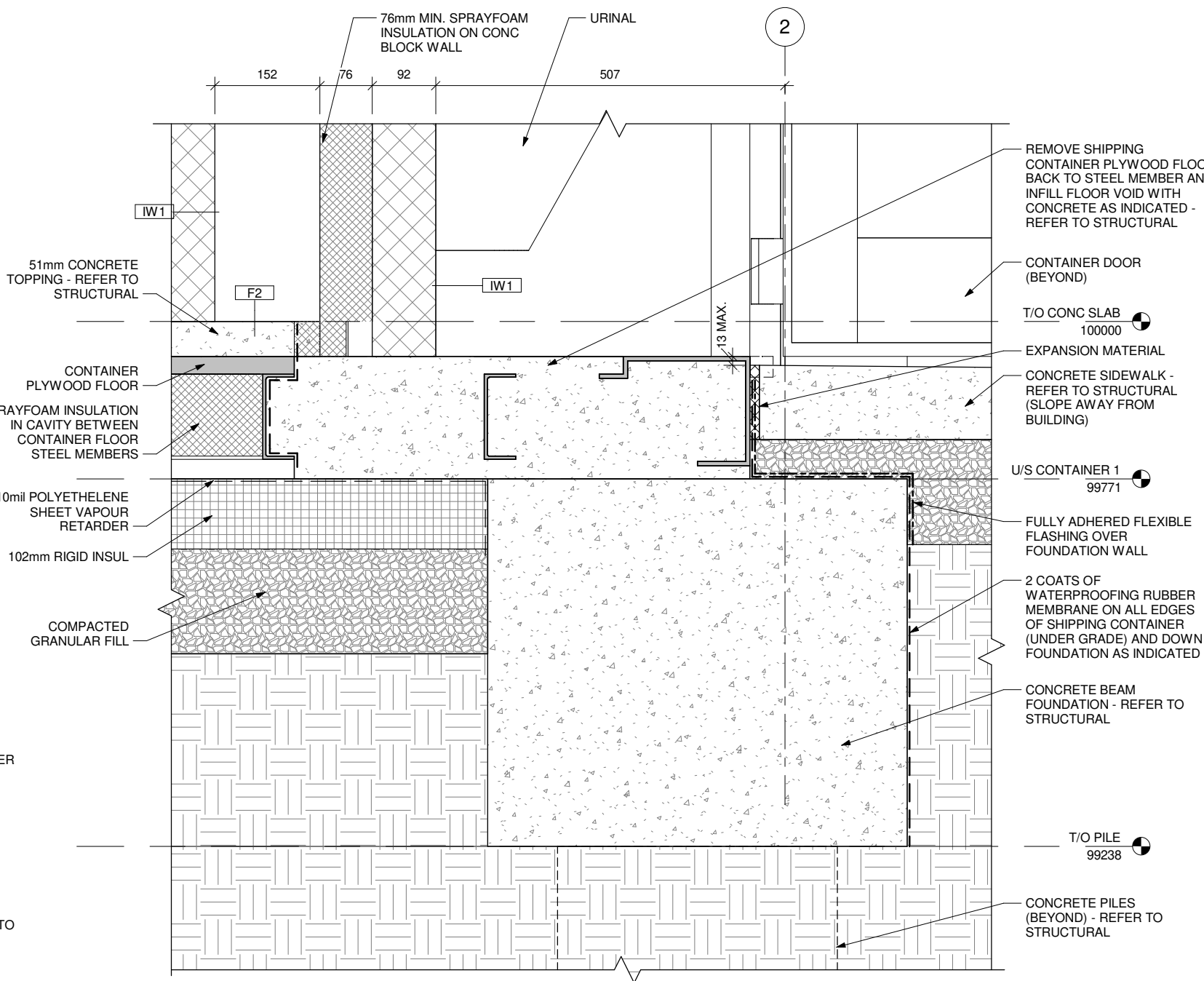

2 SECTION DETAIL - FOUNDATION AT URINALS
 1:8

Project:
**715 MAIN STREET
 PUBLIC TOILET**

715 Main Street, Winnipeg, MB

Project Number: 2022
 Bid Opportunity Number: 54-2021



#	Issue/Revision	Date
1	ISSUED FOR CONSTRUCTION	MAR. 3, 2021

Drawing Title:
SECTION DETAILS

Sheet No:

A551

This drawing is property of the Architect and cannot be reproduced or used without the consent of the Architect. The contractor is responsible for checking and verifying all levels and dimensions and shall report all discrepancies to the Architect and obtain clarification prior to commencing work.