

**REFER TO  
 DRAWING M0.0  
 FOR LEGEND**

**GENERAL NOTES - PLUMBING**

- MECHANICAL CONTRACTOR SHALL VERIFY EXACT LOCATIONS, SIZES, INVERTS, ETC. PRIOR TO COMMENCEMENT OF WORK. VERIFY ALL CONNECTION POINTS ON SITE.
- MECHANICAL CONTRACTOR SHALL ALLOW IN HIS TENDER QUOTATION FOR ALL REQUIRED MODIFICATIONS TO EXISTING SYSTEMS (I.E.) RE-ROUTING OF EXISTING PIPING AS DEEMED NECESSARY DUE TO RENOVATION WORK.
- REFER TO ARCHITECTURAL, ELECTRICAL & STRUCTURAL DRAWINGS FOR COORDINATION PURPOSES.
- MECHANICAL CONTRACTOR SHALL CAREFULLY REMOVE & RELOCATE EXISTING EQUIPMENT AS PER OWNERS REQUIREMENTS.
- ALL CUTTING & PATCHING OF FLOOR SLABS, WALLS ETC. TO BE PERFORMED BY GENERAL CONTRACTOR.
- ALL VENT PIPING TO BE INSTALLED AS PER CODE.
- PROVIDE ISOLATION VALVES ON ALL FIXTURES OR FIXTURE GROUP.
- PROVIDE TRAP SEAL TO ALL FLOOR AND HUB DRAINS. WADE OR EQUAL.
- PROVIDE AUTOMATIC AIR VENTS AT ALL HIGH POINTS OF SYSTEM.
- ALL DOMESTIC WATER LINES TO BE INSULATED TO MANITOBA HYDRO POWER SMART REQUIREMENTS.
- ALL WORK SHALL COMPLY IN EVERY RESPECT WITH ALL NATIONAL, PROVINCIAL AND LOCAL CODES AND BY-LAWS, WHICH SHALL BE CONSIDERED PART OF THE SPECIFICATION. IN THE CASE OF CONFLICTING REQUIREMENTS, BE GOVERNED BY THE MOST STRINGENT REGULATIONS.
- THE MECHANICAL CONTRACTOR SHALL INSTALL PLUMBING SYSTEMS IN COMPLETE ACCORDANCE WITH THE RECOMMENDATIONS OF THE NATIONAL/PROVINCIAL BUILDING CODE, LOCAL PLUMBING CODES, AND MANITOBA OFFICE OF THE FIRE COMMISSIONER REQUIREMENTS.
- ALL INSULATING MATERIALS, METHODS, SIZES AND TYPES OF INSULATION FOR ALL PIPING SHALL BE INSTALLED TO THE REQUIREMENTS OF THE ASHRAE STANDARDS 90.1-2010 "ENERGY STANDARD FOR BUILDING EXCEPT LOW-RISE RESIDENTIAL BUILDINGS", STANDARD 90.2 "ENERGY EFFICIENT DESIGN OF LOW-RISE RESIDENTIAL BUILDINGS", THERMAL INSULATION ASSOCIATION OF CANADA (TIAC) STANDARDS.
- PROVIDE DI-ELECTRIC COUPLINGS ON ALL PIPING CONNECTIONS TO HOT WATER TANKS.
- PROVIDE APPROPRIATE FIRE-STOPPING MEASURES ON ALL PIPING PENETRATING FIRE SEPARATIONS SUBMIT SHOP DRAWINGS FOR REVIEW. ACCEPTABLE PRODUCT: HILTI, OR EQUAL.
- INSULATE VENT PIPING BACK 10'-0" (3.0 M) FROM ROOF PENETRATIONS IN ALL DIRECTIONS.
- COORDINATE MOUNTING HEIGHT OF ALL FIXTURES ARCHITECTURAL ELEVATIONS.
- ALL SANITARY WASTE, VENT PIPING, RAIN WATER PIPING, AND DOMESTIC WATER PIPING SHALL BE CAPABLE OF MEETING OR EXCEEDING THE FLAME SPREAD RATING OF 25 AND DEVELOPED SMOKE RATING OF 50, AND BE SUITABLE FOR INSTALLATION IN AIR PLENUMS.
- ALL CONTROL / ELECTRICAL WIRING TO MEET FLAME SPREAD RATING OF 25, DEVELOPED SMOKE RATING OF 50 AND BE RATED FOR USE IN PLENUMS.
- PLUMBING SIZING SHOWN IS BASED ON COPPER PIPING FOR DOMESTIC WATER, AND CAST IRON PIPING FOR SANITARY AND STORM. MECHANICAL CONTRACTOR IS RESPONSIBLE FOR COORDINATING REVISED PLUMBING SIZING WITH MANUFACTURER'S RECOMMENDATIONS AS REQUIRED WHEN USING ALTERNATE MATERIALS. SUBMIT TO CONSULTANT FOR REVIEW PRIOR TO ORDERING MATERIALS.
- ALL INSULATION AND COVERINGS SHALL MEET THE REQUIREMENTS OF CAN/ULC-S102 OR S102.2 AND HAVE A FLAME SPREAD RATING NOT EXCEEDING 25 AND A SMOKE DEVELOPED CLASSIFICATION NOT EXCEEDING 50. THIS SHALL INCLUDE ALL TAPES, SEALANTS, AND MISCELLANEOUS PRODUCTS ASSOCIATED WITH THE INSTALLATION.
- CONTRACTOR TO CONFIRM FINAL LOCATIONS OF ALL FIXTURES WITH ARCHITECTURAL PLANS AND ON SITE, PRIOR TO ROUGH-IN.

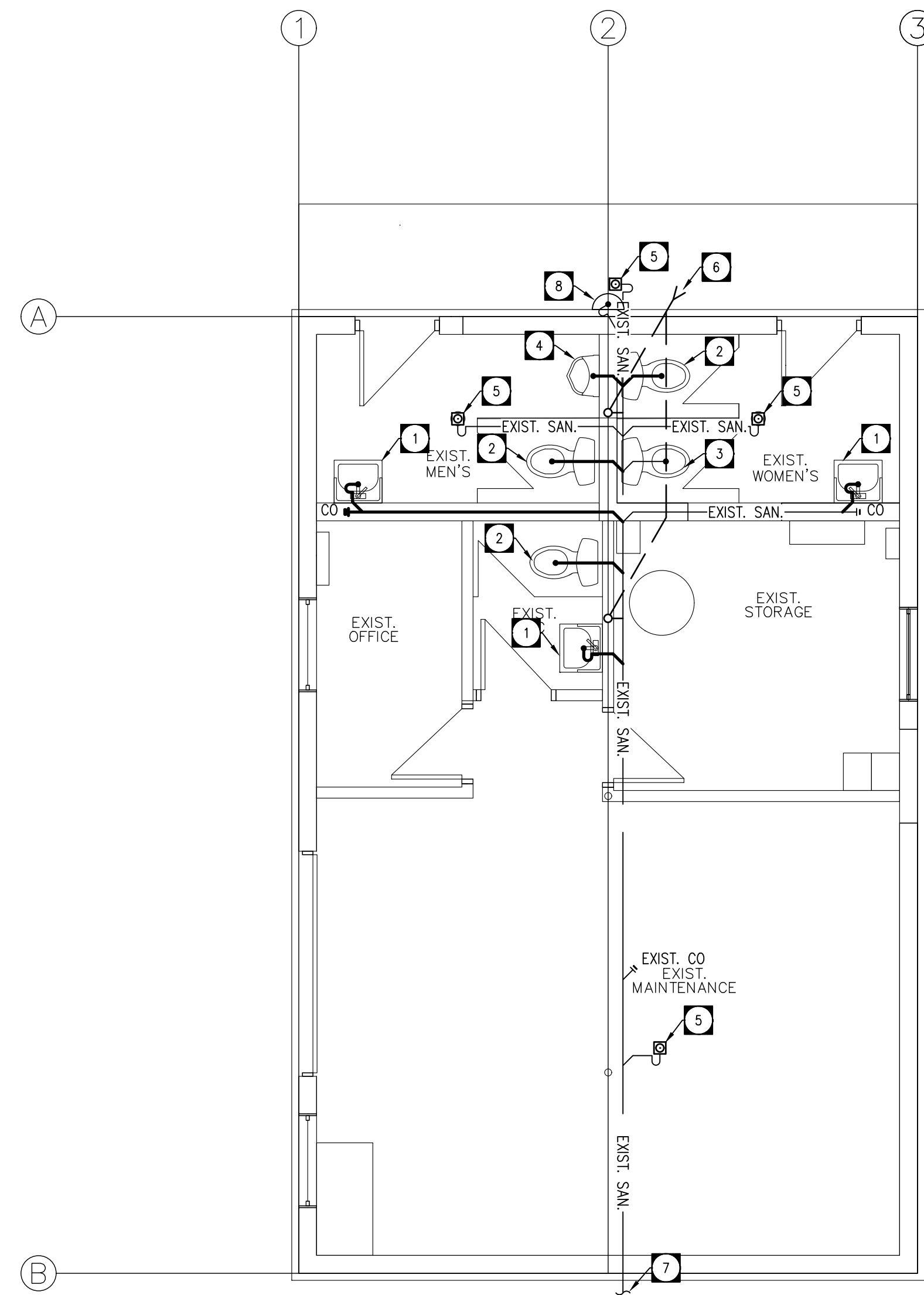

**MAIN FLOOR PLAN - SANITARY (DEMO)**  
 SCALE: 1/4"=1'-0"

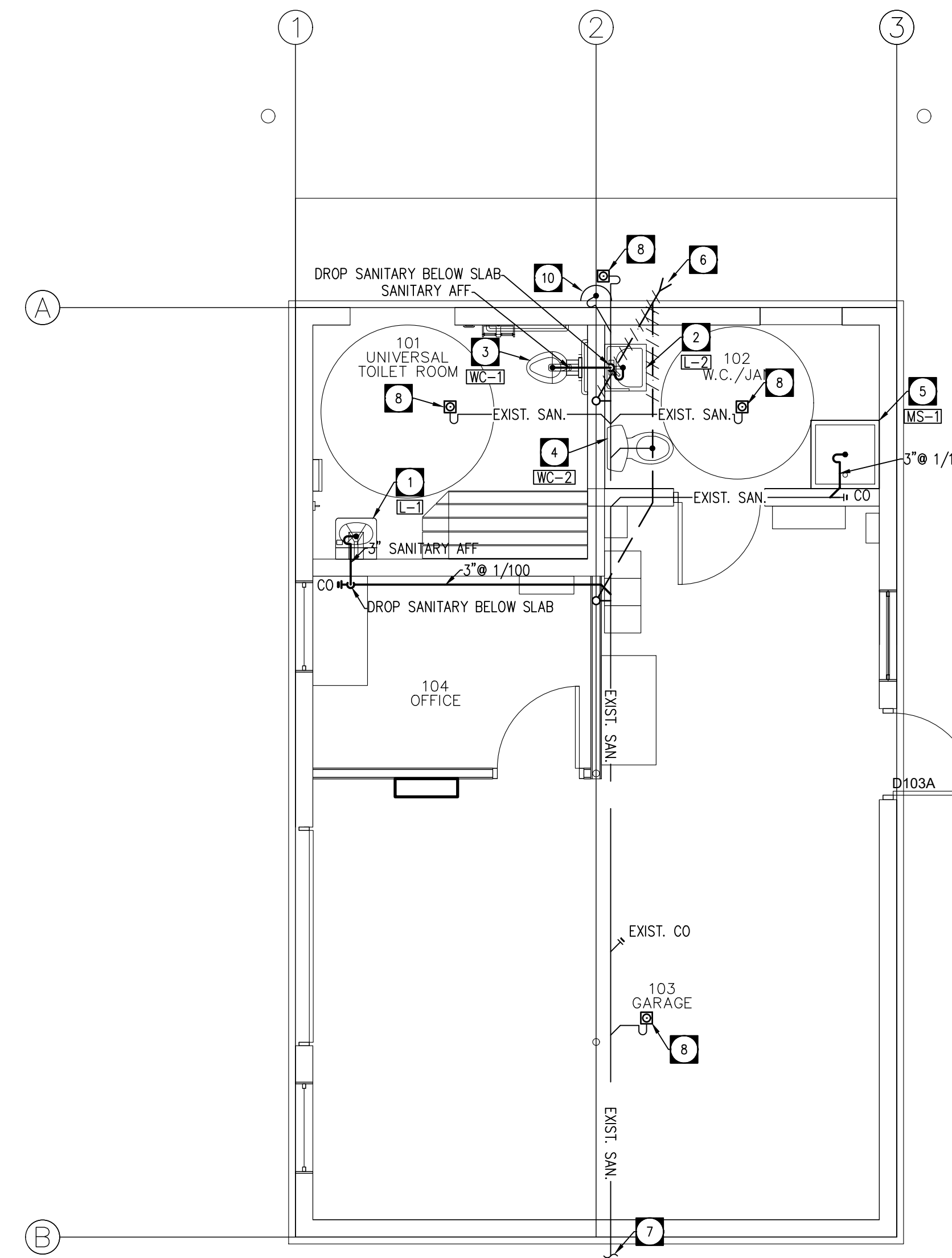

**MAIN FLOOR PLAN - SANITARY**  
 SCALE: 1/4"=1'-0"

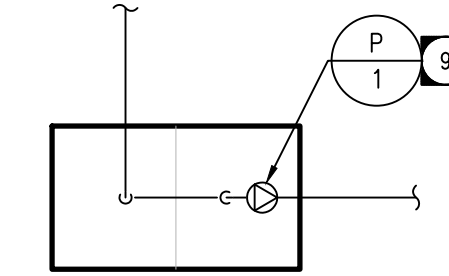

**DRAWING NOTES - DEMO**

- EXISTING LAVATORY AND ASSOCIATED SANITARY LINE TO BE DEMOLISHED.
- EXISTING TOILET AND ASSOCIATED SANITARY LINE TO BE DEMOLISHED.
- EXISTING TOILET TO BE DEMOLISHED. EXISTING ASSOCIATED SANITARY LINE TO REMAIN AND BE REUSED.
- EXISTING URINAL AND ASSOCIATED SANITARY LINE TO BE DEMOLISHED.
- EXISTING FLOOR DRAIN TO REMAIN AND BE REUSED. EXISTING SANITARY LINE TO BE REUSED. CONFIRM EXACT LOCATION ON SITE.
- EXISTING VENT LOCATION TO BE REUSED. EXISTING VENTS AT HIGH LEVEL TO BE REMOVED AND REPLACED.
- APPROXIMATE LOCATION OF EXISTING SANITARY SEWER LINE LEAVING BUILDING.
- EXISTING DRINKING FOUNTAIN TO REMAIN AND BE REUSED. EXISTING SANITARY LINE TO BE REUSED. CONFIRM EXACT LOCATION ON SITE.

**DRAWING NOTES - SANITARY**

- SUPPLY AND INSTALL LAVATORY C/W SANITARY CONNECTION APPROXIMATELY AS SHOWN. TIE INTO EXISTING LINE AS SHOWN. CONNECT VENT ABOVE FLOOD LEVEL OF FIXTURE. REFER TO SCHEDULE.
- SUPPLY AND INSTALL LAVATORY C/W SANITARY CONNECTION WITHIN WASHROOM. APPROXIMATELY AS SHOWN. TIE SINK CONNECTION INTO TOILET SANITARY THROUGH WALL IN 102 WASHROOM. CONNECT VENT ABOVE FLOOD LEVEL OF FIXTURE. REFER TO SCHEDULE.
- SUPPLY AND INSTALL FLUSH VALVE TYPE WATER CLOSET C/W SANITARY CONNECTION AND VENT APPROXIMATELY AS SHOWN. SANITARY LINE THROUGH WALL AND TIED INTO SINK CONNECTION IN 102 WASHROOM. VERIFY HANDING ON SITE. REFER TO SCHEDULE.
- SUPPLY AND INSTALL TANK TYPE WATER CLOSET C/W SANITARY CONNECTION AND VENT APPROXIMATELY AS SHOWN. EXISTING SANITARY LINE TO BE USED IF POSSIBLE. VERIFY HANDING ON SITE. REFER TO SCHEDULE.
- SUPPLY AND INSTALL MOP SINK C/W SANITARY CONNECTIONS. TIE INTO EXISTING AS SHOWN. CONNECT VENT ABOVE FLOOD LEVEL OF FIXTURE. REFER TO SCHEDULE.

- EXISTING VENT LOCATION TO BE REUSED. PROVIDE NEW VENT TO ROOF C/W INCREASER AT ROOF LINE. INSULATE VENT PIPING BACK 10'-0" FROM ROOF PENETRATION IN ALL DIRECTIONS. ENSURE FINAL ROOF PENETRATION IS 10'-0" FROM ALL AIR INTAKES.
- APPROXIMATE LOCATION OF EXISTING SANITARY SEWER LINE LEAVING BUILDING.
- EXISTING FLOOR DRAIN TO REMAIN AND BE REUSED. EXISTING SANITARY LINE TO BE REUSED. CONFIRM EXACT LOCATION ON SITE.
- SUPPLY AND INSTALL NEW GRINDER PUMP FOR SEWAGE TANK. COORDINATE INSTALLATION REQUIREMENTS ON SITE. PROVIDE CONTROL PANEL IN BUILDING. MATCH NEW PUMP SIZE TO EXISTING. CONFIRM SIZE WITH OWNER AND ON SITE PRIOR TO ORDERING.
- EXISTING DRINKING FOUNTAIN TO REMAIN AND BE REUSED. EXISTING SANITARY LINE TO BE REUSED. EXTEND SANITARY PIPING AS REQUIRED TO SUIT NEW CLADDING. CONFIRM EXACT REQUIREMENTS AND LOCATION ON SITE.

**NOVA 3 ENGINEERING LTD.**  
 PROFESSIONAL ENGINEERS  
 201-120 FORT STREET TEL.: (204) 943-6142  
 WINNIPEG, MANITOBA R3C 1C7 FAX.: (204) 942-1276  
 WWW.NOVA3.CA J.N.: 41-139

THIS DRAWING IS THE EXCLUSIVE PROPERTY OF NOVA 3 ENGINEERING LTD. AND MAY ONLY BE REPRODUCED WITH THE WRITTEN PERMISSION OF NOVA 3 ENGINEERING LTD.  
 THE CONCEPT AND DESIGN INCORPORATED INTO THIS DRAWING ARE BASED ON INFORMATION PROVIDED BY THE CLIENT AND OTHER RELATED SOURCES. PROFESSIONAL ENGINEER ACCEPTS NO RESPONSIBILITY FOR DRAWING AND DESIGN UNLESS DRAWING IS ACCOMPANIED BY ORIGINAL SEALED LETTER OF INTENT OR EQUIVALENT ACCEPTABLE FACSIMILE. PROFESSIONAL ENGINEER ACCEPTS NO RESPONSIBILITY FOR FINAL INSTALLATION CONFORMANCE WITHOUT ORIGINAL SEALED CERTIFICATE OF INSPECTION OR EQUIVALENT ACCEPTABLE FACSIMILE.

Revisions

2021-10-20	Issued for Tender, Permit, and Construction
Date	Revision

Northern Sky Architecture Inc.

100-128 James Avenue  
 Winnipeg, Manitoba, Canada  
 R3B 0N8  
 Phone: (204) 943-6142  
 Fax: 204.942.7979  
 204.943.6767

Stamp

**APEN**  
 Certificate of Authorization  
 Nova 3 Engineering Ltd.  
 No.962 Date: 2021-10-25

Stamp

PROFESSIONAL ENGINEER  
 REG. NO. 31511  
 MEMBER  
 2021-10-25

Project  
 City of Winnipeg  
 Churchill Park Maintenance  
 Building Renovation  
 430 Churchill Dr  
 Winnipeg, Manitoba

drawing title	MECHANICAL - MAIN FLOOR PLAN - SANITARY		
scale	as noted	designed by	HC
date	2021-10-20	drawn by	HC
project no.	21.190	reviewed by	JHG
reference no.	sheet	M1.0	REV.