

THIS DRAWING SHALL NOT BE SCALED. FOLLOW GIVEN DIMENSIONS ONLY.
 THE CONSTRUCTOR SHALL SATISFY HIM/HERSELF THAT ALL DIMENSIONS AND INFORMATION ARE CORRECT.
 PRIOR TO THE COMMENCEMENT OF WORK REPORT ANY DISCREPANCIES TO THE CONTRACT ADMINISTRATOR.
 VARIATIONS AND MODIFICATIONS TO WORK WILL NOT BE ALLOWED WITHOUT THE WRITTEN PERMISSION OF THE CONTRACT ADMINISTRATOR.
 THIS DRAWING SHALL NOT BE USED FOR CONSTRUCTION PURPOSES UNTIL APPROVED BY CONTRACT ADMINISTRATOR AND AUTHORIZED BY OWNER.

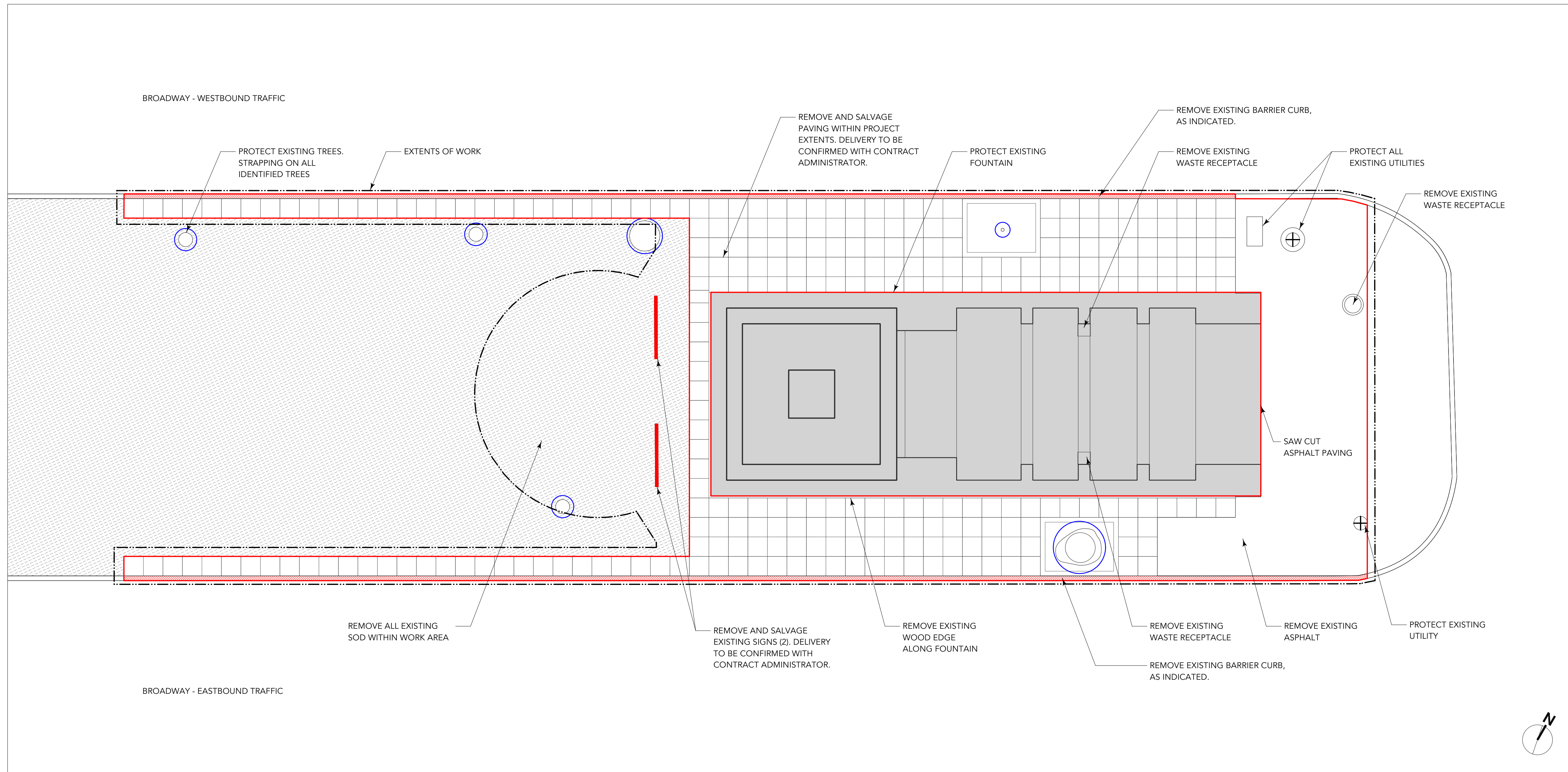

No.	Date	Reviewed	Revision Notes
D	2022-05-13	ML	ISSUED FOR TENDER
C	2022-04-21	ML	ISSUED FOR 90% REVIEW
B	2021-12-21	ML	ISSUED FOR 60% REVIEW
A	2021-10-21	ML	ISSUED FOR 30% REVIEW

PRELIMINARY
DRAWING
NOT TO BE USED FOR
CONSTRUCTION

Consultant

 little bluestem
 landscape architecture
Little studio, deep roots.
 139 MORLEY AVENUE
 WINNIPEG, MB

Project Title

BROADWAY FOUNTAIN
 PLAZA IMPROVEMENTS
 WEST MEDIAN AT BROADWAY
 AND DONALD AVENUE

Sheet Title

EXISTING + REMOVALS PLAN

Drawn By	ML	Project No.	622-2021
Reviewed By	DG	Sheet No.	L01
Date	2022-05-13		
Scale	AS NOTED		

1 EXISTING + REMOVALS PLAN
 L01 Scale: 1:75

General Notes

1. IF POWER EQUIPMENT IS TO BE USED FOR EXCAVATION ON THIS PROJECT THE CONTRACTOR MUST:
 - A) NOTIFY ALL UTILITIES OF THE PROPOSED LOCATION OF EXCAVATION
 - B) TAKE PRECAUTION TO AVOID DAMAGE TO ALL UTILITIES
2. LOCATION OF UNDERGROUND STRUCTURES AS SHOWN ARE BASED ON THE BEST INFORMATION AVAILABLE BUT NO GUARANTEE IS GIVEN THAT ALL EXISTING UTILITIES ARE SHOWN OR THAT THE GIVEN LOCATIONS ARE EXACT. CONFIRMATION OF EXISTENCE AND EXACT LOCATION OF ALL SERVICES MUST BE OBTAINED FROM THE INDIVIDUAL UTILITIES BEFORE PROCEEDING WITH CONSTRUCTION
3. CONTRACTOR TO CONFIRM ALL EXISTING CONDITIONS, DIMENSIONS AND MATERIALS ON SITE AND REPORT ANY DISCREPANCIES TO THE CONTRACT ADMINISTRATOR PRIOR TO CONSTRUCTION
4. CONSTRUCTION ACCESS TO BE LIMITED TO THE ROUTES SPECIFIED ON SITE BY CONTRACT ADMINISTRATOR
5. ALL EXISTING TREES, SHRUBS, SIDEWALKS, CURBS, SOD, UTILITIES AND PAVING TO BE PROTECTED (UNLESS OTHERWISE NOTED) DURING CONSTRUCTION TO CITY OF WINNIPEG STANDARDS. CONTRACTOR TO MAKE GOOD ALL AREAS DAMAGED DURING CONSTRUCTION BOTH ON AND OFF SITE TO CITY OF WINNIPEG STANDARDS AT THE CONTRACTOR'S COST
6. REFER ALSO TO WRITTEN SPECIFICATIONS