

Feb 24, 2022 - 3:06pm - Pioneer\_William Renewal Project\1.0 Tech & Professional Services\Drawings\04 Working Drawings\Drawings\04 Working Drawings\Pioneer\William\_Geometry Plan.dwg - Job: 807-2021-Drawing\_211-03198-00-01-RA

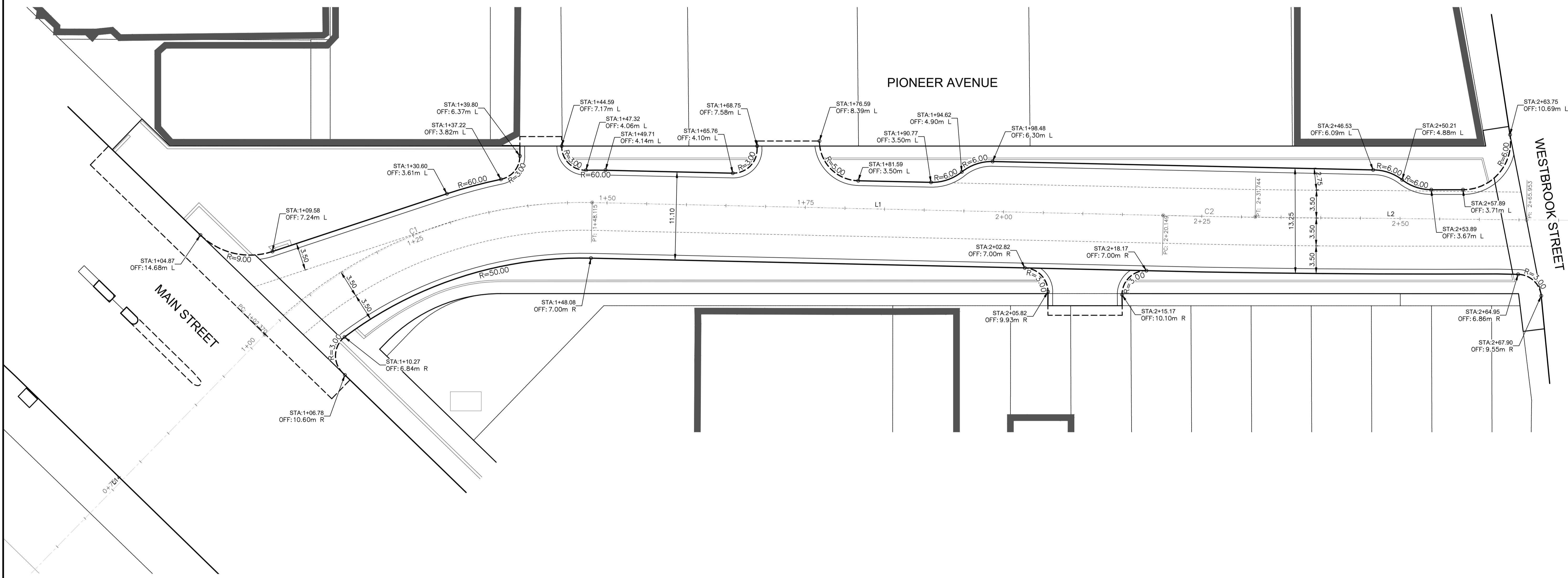
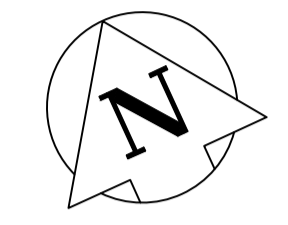

Curve #	Radius	Length	Chord Direction	Start Point	End Point
C1	57.00	45.74	S86° 46' 29.55"E	(633751.79,5528557.97)	(633796.25,5528555.46)
C2	993.00	11.60	S63° 51' 23.62"E	(633860.73,5528523.35)	(633871.14,5528518.24)

Line #	Length	Direction	Start Point	End Point
L1	72.03	S63° 31' 19.35"E	(633796.25,5528555.46)	(633860.73,5528523.35)
L2	34.21	S64° 11' 27.88"E	(633871.14,5528518.24)	(633901.93,5528503.34)

EXISTING	LEGEND-PLAN	PROPOSED	EXISTING	LEGEND-PLAN	PROPOSED	EXISTING	LEGEND-PROFILE	PROPOSED
	WATER MAIN			IRON BAR				
	LAND DRAINAGE SEWER			LIGHT STANDARD OR TRAFFIC SIGNAL				
	WASTE WATER SEWER			CURB RAMP				
	HYDRO POLE			EDGE OF SIDEWALK				
	BELL/MTS			PROPERTY LINE				
	GAS			EDGE OF CONCRETE				
	SIGNALS			BARRIER CURB				
	MANHOLE			CONC SIDEWALK				
	CATCH BASIN			ASPHALT				
	CURB INLET			NORTH OR WEST GUTTER				
	UTILITIES ADJUSTED			SOUTH OR EAST GUTTER				
	PLUG							
	HYDRANT							
	VALVE							
	CURB STOP							
	GROUND GRADE							
	PAVEMENT GRADE							
	ANCHOR							
	CIVIC ADDRESS							
	EXISTING LEGEND-PLAN			EXISTING LEGEND-PROFILE			EXISTING LEGEND-PROFILE	

**LOCATIONS APPROVED UNDERGROUND STRUCTURES**

SIGNED BY: \_\_\_\_\_ DATE: \_\_\_\_\_

SUPV U/G STRUCTURES \_\_\_\_\_ DATE \_\_\_\_\_

LOCATION OF UNDERGROUND STRUCTURES AS SHOWN ARE BASED ON THE BEST INFORMATION AVAILABLE BUT NO GUARANTEE IS GIVEN THAT ALL EXISTING UTILITIES ARE SHOWN OR THAT THE GIVEN LOCATIONS ARE EXACT CONFIRMATION OF EXISTENCE AND EXACT LOCATION OF ALL SERVICES MUST BE OBTAINED FROM THE INDIVIDUAL UTILITIES BEFORE PROCEEDING

G.M.	ELEV.	TOP NUT OF FIRE HYDRANT AT
H		
G		
F		
E		
D		
C		
B		
A		
NO.		

**wsp**

DESIGNED BY: MV/SS  
 DRAWN BY: SB  
 HOR. SCALE: 1:250  
 VERTICAL: 1:10  
 DATE: AUGUST 2021

WSP Canada Inc.  
 1600 Buffalo Place  
 Winnipeg, MB R3T 6B8  
 t. 204.477.6650  
 f. 204.474.2864  
 www.wsp.com

ENGINEER'S SEAL

CONSULTANT ACAD DWG. NO.  
211-03198-00-01

**FOR TENDER PURPOSES ONLY**  
**NOT FOR CONSTRUCTION**

**METRIC**  
 WHOLE NUMBERS INDICATE MILLIMETRES  
 DECIMALIZED NUMBERS INDICATE METRES

**ENGINEERS GEOSCIENTISTS MANITOBA**  
 Certificate of Authorization  
 WSP Canada Inc.  
 No. 5750

**THE CITY OF WINNIPEG**  
 PUBLIC WORKS DEPARTMENT  
 ENGINEERING SERVICES DIVISION

2021-2022 PIONEER, WILLIAM STEPHENSON, COLONY & ST. MARY RENEWALS PROJECT  
 PIONEER AVENUE - HORIZONTAL GEOMETRY  
 ASPHALT RECONSTRUCTION  
 STA. 0+96.14 TO STA. 2+70.23

CITY DRAWING NUMBER: P-3545-01  
 SHEET: 01 OF 19  
 TENDER NO.: 807-2021