

CONSTRUCTION NOTES:

- PROJECT SCOPE**
- REMOVE PITS AS SHOWN.
 - REBUILD SERVICE AND INSTALL GROUND ROD ON WOOD POLE #13 AS SHOWN. INSTALL MAST AND DISCONNECT ON XX QUADRANT. INSTALL WEATHER HEAD 150mm LOWER THAN THE LOWEST HYDRO WIRE.
 - INSTALL EQUIPMENT AS SHOWN.
- PROJECT COORDINATION**
- COORDINATE WORK WITH (CA'S NAME), (204) XXX-XXXX.
 - COORDINATE HYDRO SERVICE INSTALLATION WITH (TODD FOUNTAIN), (204) 792-3682. RE: JUTA PERMIT No. B25243

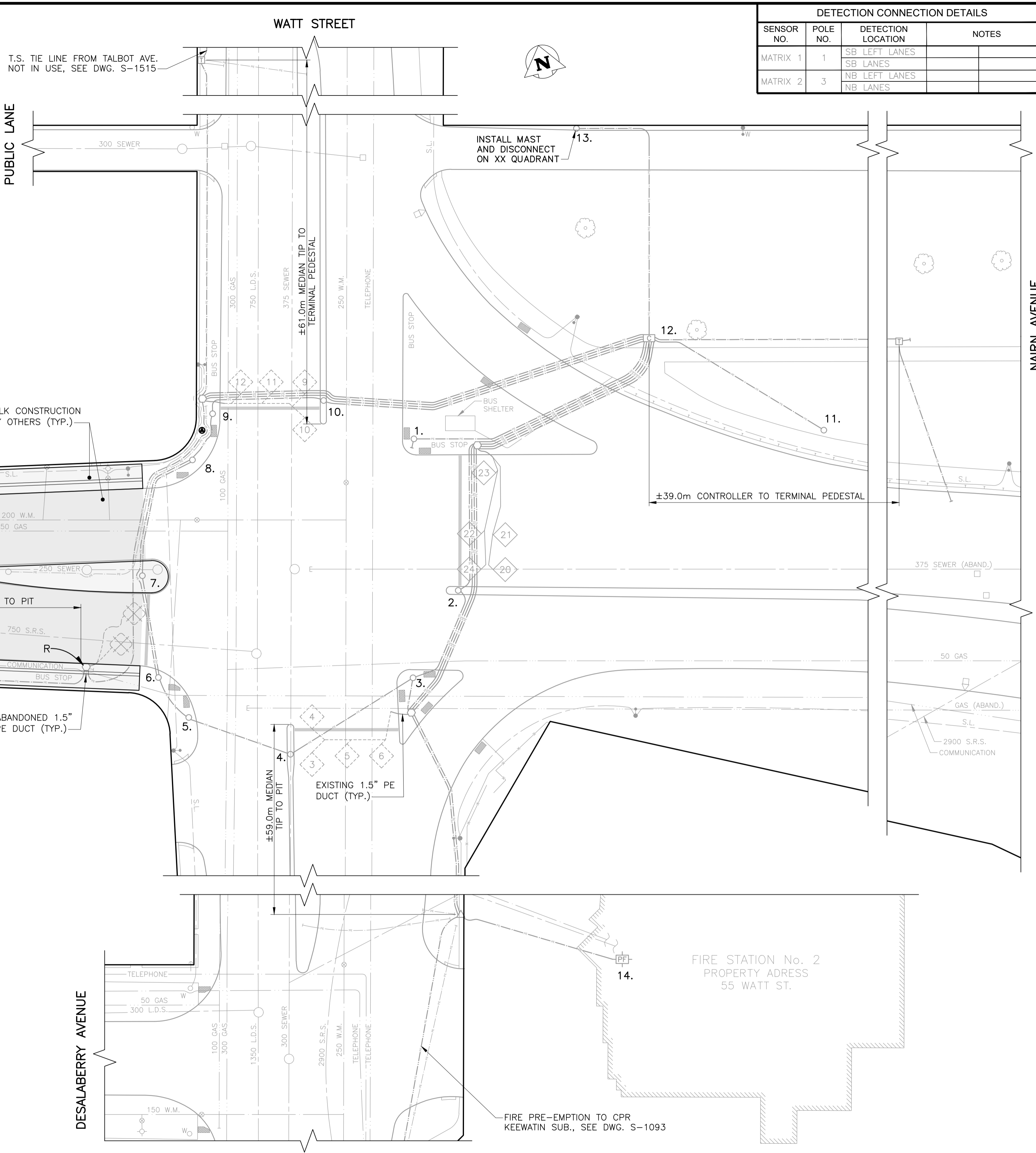

DETECTION CONNECTION DETAILS			
SENSOR NO.	POLE NO.	DETECTION LOCATION	NOTES
MATRIX 1	1	SB LEFT LANES	
		SB LANES	
MATRIX 2	3	NB LEFT LANES	
		NB LANES	

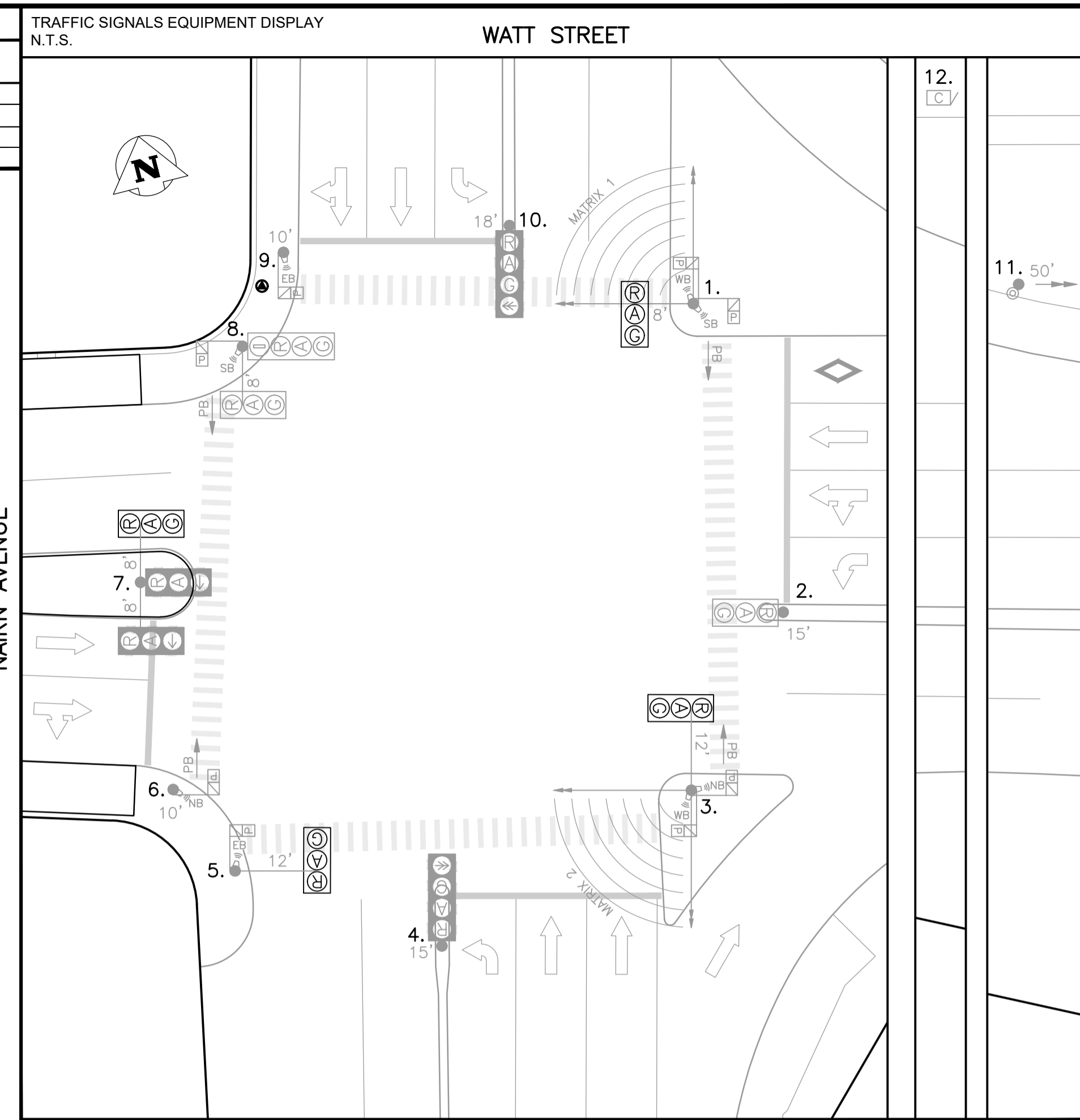

EXISTING		PROPOSED (AS SHOWN BELOW)	
	PEDESTRIAN HEAD WITH PCS		VEHICLE DETECTION AREA
	PEDESTRIAN CORRIDOR BOX		TRAFFIC SIGNAL POLE
	RRFB (PHASE 'A' OR 'B')		WOOD POST
	TRAFFIC SIGNAL HEAD		APS SINGLE DIRECTION
	TRAFFIC SIGNAL HEAD		APS DUAL DIRECTION (2 SEPARATE DISPLAYS)
	PUSH BUTTON & DIRECTION (APB = ADJUSTABLE PB)		RED FLASHER
	LOW ARM (SHOWN FROM CENTRE) HIGH ARM (SHOWN FROM SIDE)		AMBER FLASHER (CIRCUIT 'A' OR 'B')
	LUMINAIRE		CAMERA

NO.	EQUIPMENT LIST	ARM	BASE	B.B.	NO.	EQUIPMENT LIST	ARM	BASE	B.B.	
1.	DAVIT		8'	A	A	11.	50' TOWER POLE FOR CAMERA FOLDING EAST		J	-
2.	15' SIGNAL			G	G					
3.	DAVIT		12'	A	A	12.	332 CABINET/170 CONTROLLER FIRE PRE-EMPTION UPS SIDEMOUNT S6 CABINET			
4.	15' SIGNAL			A	A	13.	HYDRO WOOD SERVICE:			
5.	DAVIT		12'	A	A	14.	FIRE STATION No. 2 FIRE PRE-EMPTION			
6.	10' SIGNAL			A	A					
7.	DOUBLE DAVIT		8'/8'	A	AD					
8.	DAVIT		8'	A	AD					
9.	10' SIGNAL			A	A					
10.	18' SIGNAL			A	A					

EXISTING		PROPOSED (AS SHOWN BELOW)	
	1 1/2" PE CONDUIT		POLE BASE
	2" PE CONDUIT		WOOD POST
	4" PVC CONDUIT		CONTROLLER BASE
	AERIAL / BURIED CABLE		PEDESTAL BASE
	CONDUIT STUB		TERMINAL BASE
	BREAK-IN		SERVICE BOX (PIT)
	SPICE		24" PRECAST PIT
	SAW-CUT LOOPS		30" PRECAST PIT
	PREFORMED LOOPS		36" PRECAST PIT
			REMOVAL

PLAN VIEW: UNDERGROUND CONSTRUCTION
1:250

EXISTING	LEGEND	PROPOSED	EXISTING	LEGEND	PROPOSED	EXISTING	LEGEND	PROPOSED
	WATERMAIN			TELEPHONE			TELEPHONE	
	HYDRANT			COMMUNICATION			TELEPHONE	
	VALVE			COMMUNICATION			TELEPHONE	
	SEWER			COMMUNICATION			TELEPHONE	
	MANHOLE			COMMUNICATION			TELEPHONE	
	CATCH BASIN			COMMUNICATION			TELEPHONE	
	CURB INLET			COMMUNICATION			TELEPHONE	
	HYDRO			COMMUNICATION			TELEPHONE	
	GAS			COMMUNICATION			TELEPHONE	

UNDERGROUND STRUCTURES	
UNDERGROUND STRUCTURES ID	DATE (YYYY/MM/DD)
WATER & WASTE REVIEW ID	

CONSTRUCTION REVISIONS			
NO.	REVISION	DATE (YYYY/MM/DD)	BY
A	ISSUED FOR INTERNAL REVIEW	2022/02/16	R.S.

DESIGNED BY	R.S.
DRAWN BY	R.S.
CHECKED BY	C.H.
APPROVED BY	

WT PENDING

LIABILITY DISCLAIMER NOTICE:
THE DIGITAL INFORMATION PROVIDED FOR YOUR CONVENIENCE HEREIN IS FOR USE AT YOUR OWN RISK. THE CITY OF WINNIPEG, PUBLIC WORKS DEPARTMENT, SHALL ASSUME NO RESPONSIBILITY FOR THE INFORMATION AND IT SHOULD NOT BE CONSTRUED AS ASSUAL INFORMATION. THE INFORMATION SHOULD BE USED FOR PLANNING PURPOSES ONLY AND SHOULD BE VERIFIED BY SURVEY. THE DEPARTMENT SHALL NOT IN ANY WAY SUFFER ANY LIABILITY WHATSOEVER TO ANY PARTY FOR INJURY, LOSS OR DAMAGES SUFFERED BY SUCH PARTY ARISING FROM THEIR USE OF, OR RELIANCE UPON, THIS INFORMATION.

THE CITY OF WINNIPEG
PUBLIC WORKS DEPARTMENT
TRANSPORTATION DIVISION

TRAFFIC SIGNALS
NAIRN AVE. & WATT ST.

UNITS: ALL DIMENSIONS ARE IN METERS UNLESS OTHERWISE NOTED

DRAWING NUMBER: S-1608

U:\Staff\Engineering\Infrastructure\Watt & Nairn\DWG\TrafficSignals\Watt & Nairn\Watt & Nairn S-1608.dwg
 2022/02/16 10:00 AM
 R.S.