

1 ASPHALT PATH TYPICAL CROSS SECTION-2
Scale NTS

MATCHLINE STATION 0+780

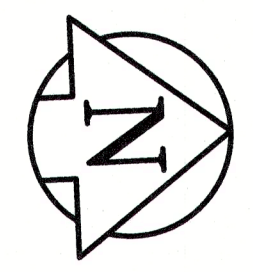

- REFERENCE NOTES:**
- PAVEMENT DIMENSIONS ARE TO BACK OF CURB
 - BASELINE IS CENTRE LINE ROADWAY
 - PROPERTY LINES OBTAINED FROM CITY OF WINNIPEG L.B.I.S., AND NO SCALE FACTOR WAS APPLIED
 - REFER TO AECOM FIELD BOOK NO. 5113
- CONSTRUCTION NOTES:**
- CONSTRUCT NEW ASPHALT PAVEMENT OVERLAY TYPE 1A (100mm AVG. THICKNESS)
 - CONSTRUCT NEW ASPHALT BIKE PATHWAY PAVEMENT TYPE 1A (75mm THICKNESS) CW COMPACTED 125mm OF LIMESTONE BASE COURSE, GEOGRID, 150mm OF 50mm LIMESTONE SUB-BASE AND SEPARATION/FILTRATION GEOTEXTILE
 - REMOVE EXISTING CONCRETE PAVEMENT AND CONSTRUCT NEW 150m REINFORCED CONCRETE PAVEMENT
 - ADJUST EXISTING MANHOLE / CATCH BASIN TO GRADE
 - INSTALL NEW CAST IRON RISER RING
 - REMOVE EXISTING FRAME AND COVER AND PLACE NEW FRAME AND COVER (AP-006 / AP-007)
 - ADJUST EXISTING PAVING STONES
 - ADJUST EXISTING PATIO BLOCKS
 - RENEW EXISTING CONCRETE SIDEWALK
 - INSTALL CONCRETE BARRIER CURB (SEPARATE SD-203A 75mm REVEAL)
 - REMOVE EXISTING BARRIER CURB AND CONSTRUCT NEW MODIFIED BARRIER CURB (150mm REVEAL)
 - CONSTRUCT NEW CONCRETE CURB RAMP (10-12mm REVEAL, MONOLITHIC)
 - INSTALL NEW DETECTABLE WARNING TILE
 - REMOVE EXISTING CURB AND CONSTRUCT NEW CONCRETE BARRIER CURB (75mm REVEAL HT. DOWELED)
 - REMOVE EXISTING CONCRETE BARRIER CURB
 - REMOVE AND RELOCATE STREET LIGHTS. REFER TO MANITOBA HYDRO STREET LIGHT DRAWINGS FOR LOCATION
 - CONTRACT ADMINISTRATOR TO DETERMINE LOCATIONS FOR INSTALLATION OF PAVEMENT REPAIR FABRIC PRIOR TO ASPHALT PAVING
 - TRAFFIC SIGNALS TO COMPLETE REQUIRED SIGNALS WORK IN INTERSECTION, COORDINATE AS PER TENDER DOCUMENT
 - MH20007609 - REPLACE RISER TO 1.4m

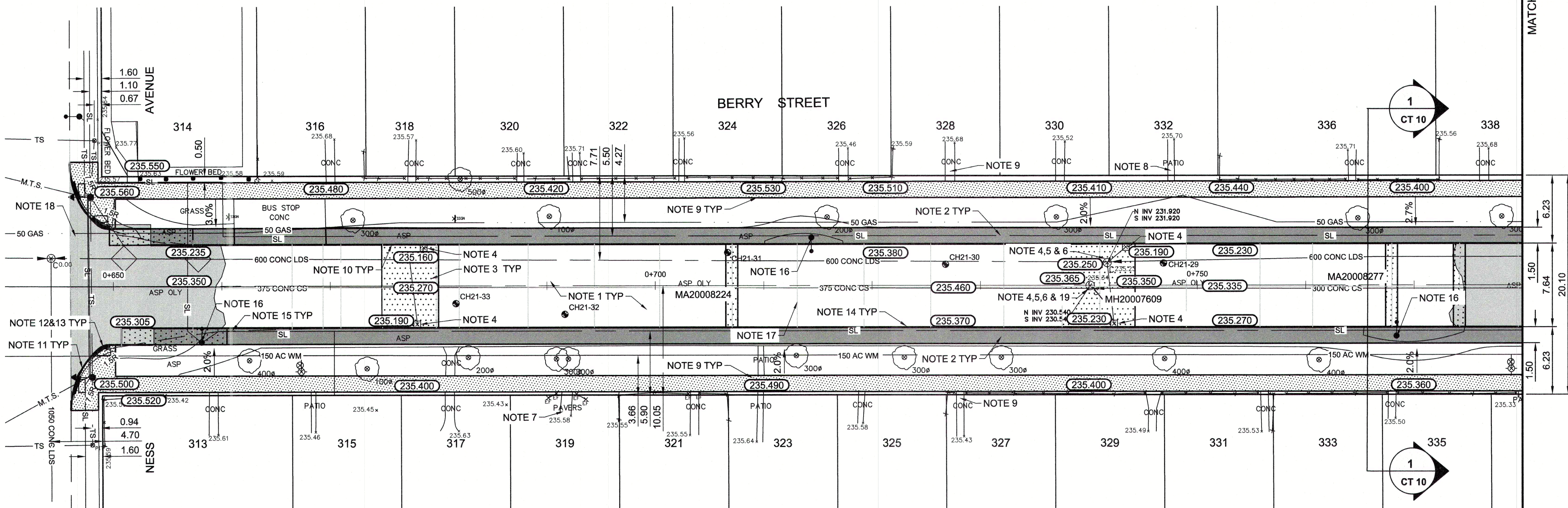

**ENGINEERS
GEOSCIENTISTS
MANITOBA**
Certificate of Authorization
AECOM Canada Ltd.
No. 4671 Date: 2022/02/17

METRIC
WHOLE NUMBERS INDICATE MILLIMETRES
DECIMALIZED NUMBERS INDICATE METRES

EXISTING	LEGEND - PLAN	PROPOSED	EXISTING	LEGEND - PLAN	PROPOSED	EXISTING	LEGEND - PROFILE	PROPOSED
150 mm W.M.	WATERMAIN	150 mm W.M.	---	HYDRO	---	---	C PROFILE	---
300mm L.D.S.	LAND DRAINAGE SEWER	300mm L.D.S.	---	M.T.S.	---	---	WEST GUTTER	---
250mm W.W.S.	WASTEWATER SEWER	250mm W.W.S.	---	CONCRETE	---	---	EAST GUTTER	---
○	MANHOLE	●	---	ASPHALT	---	---	WEST PROPERTY LINE	---
□	CATCH BASIN	■	---	PROPERTY LINE	---	---	EAST PROPERTY LINE	---
▽	CATCH PIT	▼	---	SURVEY BAR	---	---		
---	JUNCTIONS	---	---	ELEVATION	(235.750)	---		
---	CULVERT	---	---	TREE	---	---		
---	GAS	---	---	SIDEWALK RAMP	---	---		
			---	CONCRETE SIDEWALK	---	---		
			---	FENCE	---	---		

LOCATION APPROVED UNDERGROUND STRUCTURES

SUPV. U/G STRUCTURES COMMITTEE DATE

NOTE:
LOCATION OF UNDERGROUND STRUCTURES AS SHOWN ARE BASED ON THE BEST INFORMATION AVAILABLE. BUT NO GUARANTEE IS GIVEN THAT THE GIVEN LOCATIONS ARE EXACT. CONFIRMATION OF EXISTENCE AND EXACT LOCATION OF ALL SERVICES MUST BE OBTAINED FROM THE INDIVIDUAL UTILITIES BEFORE PROCEEDING WITH CONSTRUCTION.

B.M. #30 N.W. Corn. Queen St. & Silver Ave., Tblt. in S. Corn. foundation No. 424 Queen St., 1m E. & 0.2m below. ELEVATION: 234.449m. BOOK # 5113.

DESIGNED BY BC CHECKED BY BC/TF

DRAWN BY AA APPROVED BY

HOR. SCALE: 1=250
VERTICAL: 1=10

RELEASED FOR CONSTRUCTION BY:

ISSUED FOR TENDER 02/17/2022 BC

ISSUED FOR REVIEW 01/28/2022 BC

NO. REVISIONS DATE BY

DATE 02/17/2022 DATE

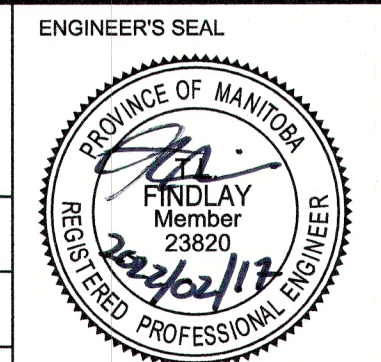

THE CITY OF WINNIPEG
PUBLIC WORKS DEPARTMENT
ENGINEERING DIVISION

2022 LOCAL AND INDUSTRIAL STREET RENEWAL PROGRAM

BERRY STREET - PORTAGE AVENUE TO ELLICE AVENUE
ASPHALT PAVEMENT REHABILITATION
NESS AVENUE TO STATION 0+780

CITY DRAWING NUMBER SHEET 10 OF 15

CONSULTANT DRAWING NO. CT-10