

1 CT 11 ASPHALT PATH TYPICAL CROSS SECTION-2
Scale NTS

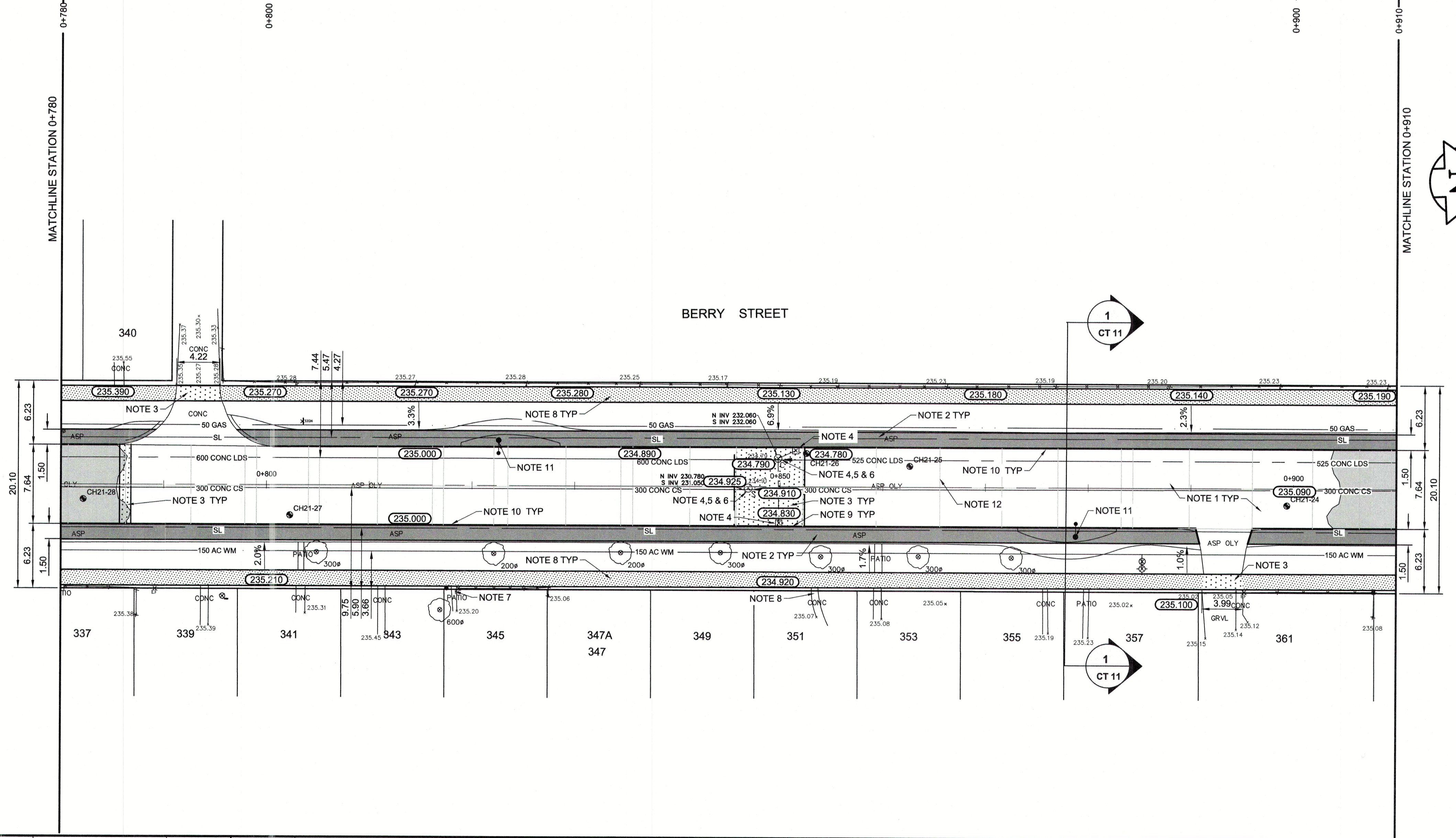

- REFERENCE NOTES:**
- PAVEMENT DIMENSIONS ARE TO BACK OF CURB
 - BASELINE IS CENTRE LINE ROADWAY
 - PROPERTY LINES OBTAINED FROM CITY OF WINNIPEG L.B.I.S., AND NO SCALE FACTOR WAS APPLIED
 - REFER TO AECOM FIELD BOOK NO. 5113
- CONSTRUCTION NOTES:**
- CONSTRUCT NEW ASPHALT PAVEMENT OVERLAY TYPE 1A (100mm AVG. THICKNESS)
 - CONSTRUCT NEW ASPHALT BIKE PATHWAY PAVEMENT TYPE 1A (75mm THICKNESS) C/W COMPACTED 125mm OF LIMESTONE BASE COURSE, GEOGRID, 150mm OF 50mm LIMESTONE SUB-BASE AND SEPARATION/FILTRATION GEOTEXTILE
 - REMOVE EXISTING CONCRETE PAVEMENT AND CONSTRUCT NEW 150mm REINFORCED CONCRETE PAVEMENT
 - ADJUST EXISTING MANHOLE / CATCH BASIN TO GRADE
 - INSTALL NEW CAST IRON RISER RING
 - REMOVE EXISTING FRAME AND COVER AND PLACE NEW FRAME AND COVER (AP-006 / AP-007)
 - ADJUST EXISTING PATIO BLOCKS
 - RENEW EXISTING CONCRETE SIDEWALK
 - INSTALL CONCRETE BARRIER CURB (SEPARATE SD-203A 75mm REVEAL)
 - REMOVE EXISTING BARRIER CURB AND CONSTRUCT NEW CONCRETE BARRIER CURB (75mm REVEAL HT. DOWELED)
 - REMOVE AND RELOCATE STREET LIGHTS. REFER TO MANITOBA HYDRO STREET LIGHT DRAWINGS FOR LOCATION
 - CONTRACT ADMINISTRATOR TO DETERMINE LOCATIONS FOR INSTALLATION OF PAVEMENT REPAIR FABRIC PRIOR TO ASPHALT PAVING

ENGINEERS GEOSCIENTISTS MANITOBA
Certificate of Authorization
AECOM Canada Ltd.
No. 4671 Date: 2022/02/17

METRIC
WHOLE NUMBERS INDICATE MILLIMETRES
DECIMALIZED NUMBERS INDICATE METRES

EXISTING	LEGEND - PLAN	PROPOSED	EXISTING	LEGEND - PLAN	PROPOSED	EXISTING	LEGEND - PROFILE	PROPOSED
150 mm W.M.	WATERMAIN	150 mm W.M.	HYDRO	HYDRO	HYDRO	— X —	Q PROFILE	— X —
300mm L.D.S.	LAND DRAINAGE SEWER	300mm L.D.S.	CONCRETE	CONCRETE	CONCRETE	— X —	WEST GUTTER	— X —
250mm W.W.S.	WASTEWATER SEWER	250mm W.W.S.	ASPHALT	ASPHALT	ASPHALT	— X —	EAST GUTTER	— X —
MANHOLE	MANHOLE	MANHOLE	PROPERTY LINE	PROPERTY LINE	PROPERTY LINE	— X —	WEST PROPERTY LINE	— X —
CATCH BASIN	CATCH BASIN	CATCH BASIN	SURVEY BAR	SURVEY BAR	SURVEY BAR	— X —	EAST PROPERTY LINE	— X —
CATCH PIT	CATCH PIT	CATCH PIT	ELEVATION	ELEVATION	ELEVATION	— X —		
JUNCTIONS	JUNCTIONS	JUNCTIONS	TREE	TREE	TREE	— X —		
CULVERT	CULVERT	CULVERT	SIDEWALK RAMP	SIDEWALK RAMP	SIDEWALK RAMP	— X —		
GAS	GAS	GAS	CONCRETE SIDEWALK	CONCRETE SIDEWALK	CONCRETE SIDEWALK	— X —		
			FENCE	FENCE	FENCE	— X —		

LOCATION APPROVED UNDERGROUND STRUCTURES

SUPV. U/G STRUCTURES COMMITTEE DATE

NOTE:
LOCATION OF UNDERGROUND STRUCTURES AS SHOWN ARE BASED ON THE BEST INFORMATION AVAILABLE. BUT NO GUARANTEE IS GIVEN THAT ALL EXISTING UTILITIES ARE SHOWN OR THAT THE GIVEN LOCATIONS ARE EXACT. CONFIRMATION OF EXISTENCE AND EXACT LOCATION OF ALL SERVICES MUST BE OBTAINED FROM THE INDIVIDUAL UTILITIES BEFORE PROCEEDING WITH CONSTRUCTION.

B.M. #30 N.W. Corn. Queen St. & Silver Ave., 1/4 in S. Corn. foundation No. 424 Queen St., 1m E. & 0.2m below. ELEV. ELEVATION: 234.449m. BOOK # 5113.

DESIGNED BY	BC	CHECKED BY	BC/TF
DRAWN BY	AA	APPROVED BY	
HOR. SCALE:	1=250	RELEASED FOR CONSTRUCTION BY:	
VERTICAL:	1=10		

AECOM

DESIGNED BY: BC
CHECKED BY: BC/TF
DRAWN BY: AA
APPROVED BY: [Signature]
HORIZONTAL SCALE: 1=250
VERTICAL SCALE: 1=10
RELEASED FOR CONSTRUCTION BY: [Signature]
DATE: 02/17/2022

ENGINEER'S SEAL
PROVINCE OF MANITOBA
REGISTERED PROFESSIONAL ENGINEER
FINLAY
Member
23820
2022/02/17

THE CITY OF WINNIPEG
PUBLIC WORKS DEPARTMENT
ENGINEERING DIVISION

2022 LOCAL AND INDUSTRIAL STREET RENEWAL PROGRAM

BERRY STREET - PORTAGE AVENUE TO ELLICE AVENUE
ASPHALT PAVEMENT REHABILITATION
STATION 0+780 TO STATION 0+910

CITY DRAWING NUMBER
SHEET 11 OF 19