

1 CT 12 ASPHALT PATH TYPICAL CROSS SECTION-2
Scale NTS

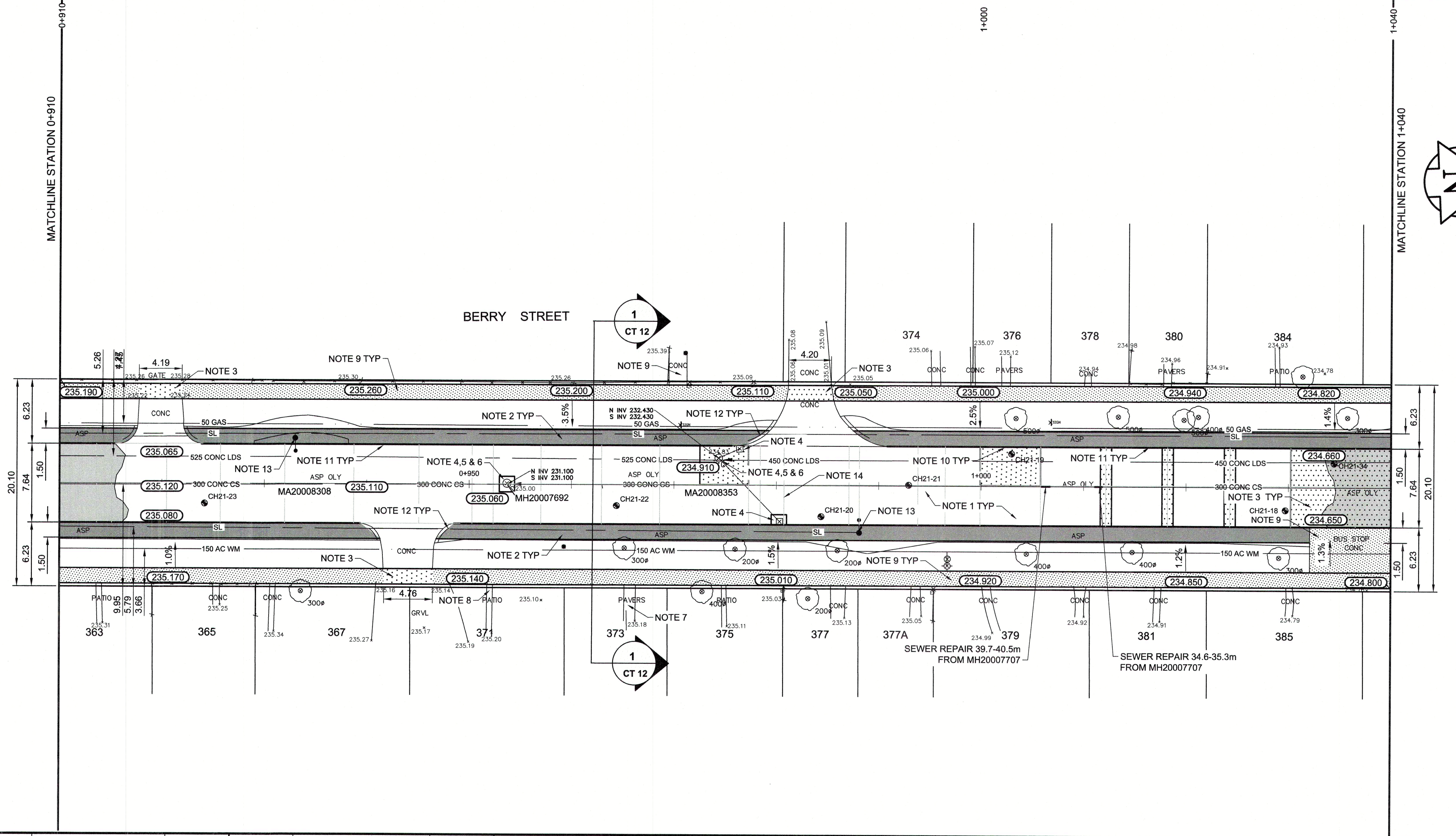

- REFERENCE NOTES:**
- PAVEMENT DIMENSIONS ARE TO BACK OF CURB
 - BASELINE IS CENTRE LINE ROADWAY
 - PROPERTY LINES OBTAINED FROM CITY OF WINNIPEG L.B.I.S., AND NO SCALE FACTOR WAS APPLIED
 - REFER TO AECOM FIELD BOOK NO. 5113
- CONSTRUCTION NOTES:**
- CONSTRUCT NEW ASPHALT PAVEMENT OVERLAY TYPE 1A (100mm AVG. THICKNESS)
 - CONSTRUCT NEW ASPHALT BIKE PATHWAY PAVEMENT TYPE 1A (75mm THICKNESS) CW COMPACTED 125mm OF LIMESTONE BASE COURSE, GEOGRID, 150mm OF 50mm LIMESTONE SUB-BASE AND SEPARATION/FILTRATION GEOTEXTILE
 - REMOVE EXISTING CONCRETE PAVEMENT AND CONSTRUCT NEW 150m REINFORCED CONCRETE PAVEMENT
 - ADJUST EXISTING MANHOLE / CATCH BASIN TO GRADE
 - INSTALL NEW CAST IRON RISER RING
 - REMOVE EXISTING FRAME AND COVER AND PLACE NEW FRAME AND COVER (AP-006 / AP-007)
 - ADJUST EXISTING PAVING STONES
 - ADJUST EXISTING PATIO BLOCKS
 - RENEW EXISTING CONCRETE SIDEWALK
 - INSTALL CONCRETE BARRIER CURB (SEPARATE SD-203A 75mm REVEAL)
 - REMOVE EXISTING BARRIER CURB AND CONSTRUCT NEW CONCRETE BARRIER CURB (75mm REVEAL HT. DOWELED)
 - CONSTRUCT NEW CONCRETE CURB RAMP (10-12mm REVEAL, MONOLITHIC)
 - REMOVE AND RELOCATE STREET LIGHTS. REFER TO MANITOBA HYDRO STREET LIGHT DRAWINGS FOR LOCATION
 - CONTRACT ADMINISTRATOR TO DETERMINE LOCATIONS FOR INSTALLATION OF PAVEMENT REPAIR FABRIC PRIOR TO ASPHALT PAVING

ENGINEERS GEOSCIENTISTS MANITOBA
Certificate of Authorization
AECOM Canada Ltd.
No. 4671 Date: 2022/02/17

METRIC
WHOLE NUMBERS INDICATE MILLIMETRES
DECIMALIZED NUMBERS INDICATE METRES

EXISTING	LEGEND - PLAN	PROPOSED	EXISTING	LEGEND - PLAN	PROPOSED	EXISTING	LEGEND - PROFILE	PROPOSED
150 mm W.M.	WATERMAIN	150 mm W.M.	---	HYDRO	---	---	Q PROFILE	---
300mm L.D.S.	HYDRANT	300mm L.D.S.	---	M.T.S.	---	---	WEST GUTTER	---
250mm W.W.S.	VALVE	250mm W.W.S.	---	CONCRETE	---	---	EAST GUTTER	---
	LAND DRAINAGE SEWER		---	ASPHALT	---	---	WEST PROPERTY LINE	---
	WASTEWATER SEWER		---	PROPERTY LINE	---	---	EAST PROPERTY LINE	---
	MANHOLE		---	SURVEY BAR	---	---		
	CATCH BASIN		---	ELEVATION	(235.750)	---		
	CATCH PIT		---	TREE	---	---		
	JUNCTIONS		---	SIDEWALK RAMP	---	---		
	CULVERT		---	CONCRETE SIDEWALK	---	---		
	GAS		---	FENCE	---	---		

LOCATION APPROVED UNDERGROUND STRUCTURES

SUPV. U/G STRUCTURES COMMITTEE DATE

NOTE:
LOCATION OF UNDERGROUND STRUCTURES AS SHOWN ARE BASED ON THE BEST INFORMATION AVAILABLE. BUT NO GUARANTEE IS GIVEN THAT ALL EXISTING UTILITIES ARE SHOWN OR THAT THE GIVEN LOCATIONS ARE EXACT. CONFIRMATION OF EXISTENCE AND EXACT LOCATION OF ALL SERVICES MUST BE OBTAINED FROM THE INDIVIDUAL UTILITIES BEFORE PROCEEDING WITH CONSTRUCTION.

B.M. #30 N.W. Corn. Queen St. & Silver Ave., Tdlt. in S. Corn. Foundation No. 424 Queen St., 1m E. & 0.2m below. ELEV. ELEVATION: 234.449m. BOOK # 5113.

AECOM

DESIGNED BY: BC CHECKED BY: BC/TF

DRAWN BY: AA APPROVED BY:

HOR. SCALE: 1=250 RELEASED FOR CONSTRUCTION BY:

VERTICAL: 1=10

0 ISSUED FOR TENDER 02/17/2022 BC

A ISSUED FOR REVIEW 01/28/2022 BC

NO. REVISIONS DATE BY DATE 02/17/2022 DATE

ENGINEER'S SEAL

PROVINCE OF MANITOBA
REGISTERED PROFESSIONAL ENGINEER
FINDLAY
Member
23820
2022/02/17

CONSULTANT DRAWING NO. CT-12

THE CITY OF WINNIPEG
PUBLIC WORKS DEPARTMENT
ENGINEERING DIVISION

2022 LOCAL AND INDUSTRIAL STREET RENEWAL PROGRAM

BERRY STREET - PORTAGE AVENUE TO ELLICE AVENUE
ASPHALT PAVEMENT REHABILITATION
STATION 0+910 TO STATION 1+040

CITY DRAWING NUMBER SHEET 12 OF 15