

1 CT 14 ASPHALT PATH TYPICAL CROSS SECTION-3
Scale NTS

REFERENCE NOTES:

- A. PAVEMENT DIMENSIONS ARE TO BACK OF CURB
- B. BASELINE IS CENTRE LINE ROADWAY
- C. PROPERTY LINES OBTAINED FROM CITY OF WINNIPEG L.B.I.S., AND NO SCALE FACTOR WAS APPLIED
- D. REFER TO AECOM FIELD BOOK NO. 5113

CONSTRUCTION NOTES:

1. CONSTRUCT NEW ASPHALT PAVEMENT OVERLAY TYPE 1A (100mm AVG. THICKNESS)
2. CONSTRUCT NEW ASPHALT BIKE PATHWAY PAVEMENT TYPE 1A (75mm THICKNESS) C/W COMPACTED 125mm OF LIMESTONE BASE COURSE, GEOGRID, 150mm OF 50mm LIMESTONE SUB-BASE AND SEPARATION/FILTRATION GEOTEXTILE.
3. REMOVE EXISTING CONCRETE PAVEMENT AND CONSTRUCT NEW 150mm REINFORCED CONCRETE PAVEMENT
4. ADJUST EXISTING MANHOLE / CATCH BASIN TO GRADE
5. INSTALL NEW CAST IRON RISER RING (AP-006 / AP-007)
6. REMOVE EXISTING FRAME AND COVER AND PLACE NEW FRAME AND COVER
7. ADJUST EXISTING PATIO BLOCKS
8. RENEW EXISTING CONCRETE SIDEWALK
9. INSTALL CONCRETE BARRIER CURB (SEPARATE SD-203A 75mm REVEAL)
10. REMOVE AND RELOCATE EXISTING CATCH BASIN AND CONNECT TO EXISTING 250mm LEAD
11. ADJUST EXISTING WATER VALVE TO GRADE
12. REMOVE EXISTING BARRIER CURB AND CONSTRUCT NEW CONCRETE BARRIER CURB (75mm REVEAL HT. DOWELED)
13. CONSTRUCT NEW CONCRETE CURB RAMP (10-12mm REVEAL, MONOLITHIC)
14. CONTRACT ADMINISTRATOR TO DETERMINE LOCATIONS FOR INSTALLATION OF PAVEMENT REPAIR FABRIC PRIOR TO ASPHALT PAVING
15. MH20007745 - REPLACE RISER TO 0.6m

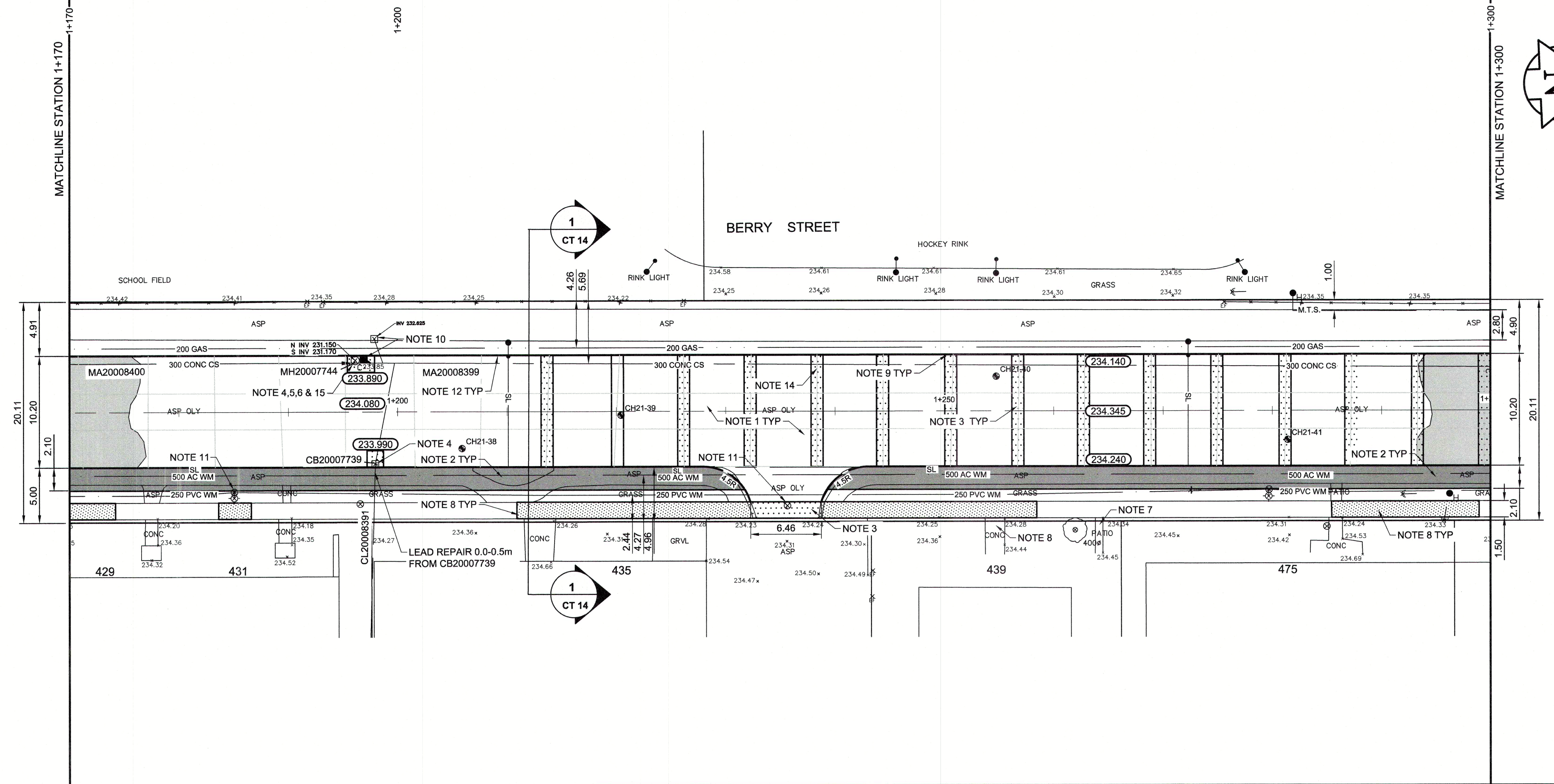

ENGINEERS GEOSCIENTISTS MANITOBA
Certificate of Authorization
AECOM Canada Ltd.
No. 4671 Date: 2022/02/17

METRIC
WHOLE NUMBERS INDICATE MILLIMETRES
DECIMALIZED NUMBERS INDICATE METRES

EXISTING	LEGEND - PLAN	PROPOSED	EXISTING	LEGEND - PLAN	PROPOSED	EXISTING	LEGEND - PROFILE	PROPOSED
150mm W.M.	WATERMAIN	150mm W.M.	---	HYDRO	---	---	⊙ PROFILE	---
300mm L.D.S.	LAND DRAINAGE SEWER	300mm L.D.S.	---	CONCRETE	---	---	WEST GUTTER	---
250mm W.W.S.	WASTEWATER SEWER	250mm W.W.S.	---	ASPHALT	---	---	EAST GUTTER	---
○	MANHOLE	●	---	PROPERTY LINE	---	---	WEST PROPERTY LINE	---
□	CATCH BASIN	■	---	SURVEY BAR	---	---	EAST PROPERTY LINE	---
▽	CATCH PIT	▼	---	ELEVATION	(235.750)	---		
+	JUNCTIONS	+	---	TREE	---	---		
---	CULVERT	---	---	SIDEWALK RAMP	---	---		
---	GAS	---	---	CONCRETE SIDEWALK	---	---		
---		---	---	FENCE	---	---		

LOCATION APPROVED UNDERGROUND STRUCTURES
SUPV. U/G STRUCTURES COMMITTEE DATE
NOTE:
LOCATION OF UNDERGROUND STRUCTURES AS SHOWN ARE BASED ON THE BEST INFORMATION AVAILABLE. BUT NO GUARANTEE IS GIVEN THAT ALL EXISTING UTILITIES ARE SHOWN OR THAT THE GIVEN LOCATIONS ARE EXACT. CONFIRMATION OF EXISTENCE AND EXACT LOCATION OF ALL SERVICES MUST BE OBTAINED FROM THE INDIVIDUAL UTILITIES BEFORE PROCEEDING WITH CONSTRUCTION.

B.M. ELEV.	#30 N.W. Corn. Queen St. & Silver Ave., Tbit. in S. Corn. Foundation No. 424 Queen St., 1m E. & 0.2m below. ELEVATION: 234.449m. BOOK # 5113.

AECOM

DESIGNED BY: BC	CHECKED BY: BC/TF
DRAWN BY: AA	APPROVED BY:
HOR. SCALE: 1=250	RELEASED FOR CONSTRUCTION BY:
VERTICAL: 1=10	DATE: 02/17/2022

ENGINEER'S SEAL
PROVINCE OF MANITOBA
REGISTERED PROFESSIONAL ENGINEER
2022/02/17

THE CITY OF WINNIPEG
PUBLIC WORKS DEPARTMENT
ENGINEERING DIVISION

2022 LOCAL AND INDUSTRIAL STREET RENEWAL PROGRAM

BERRY STREET - PORTAGE AVENUE TO ELLICE AVENUE ASPHALT PAVEMENT REHABILITATION STATION 1+170 TO STATION 1+300

CITY DRAWING NUMBER: SHEET 14 OF 19