

**1** ASPHALT PATH TYPICAL CROSS SECTION-4  
Scale NTS

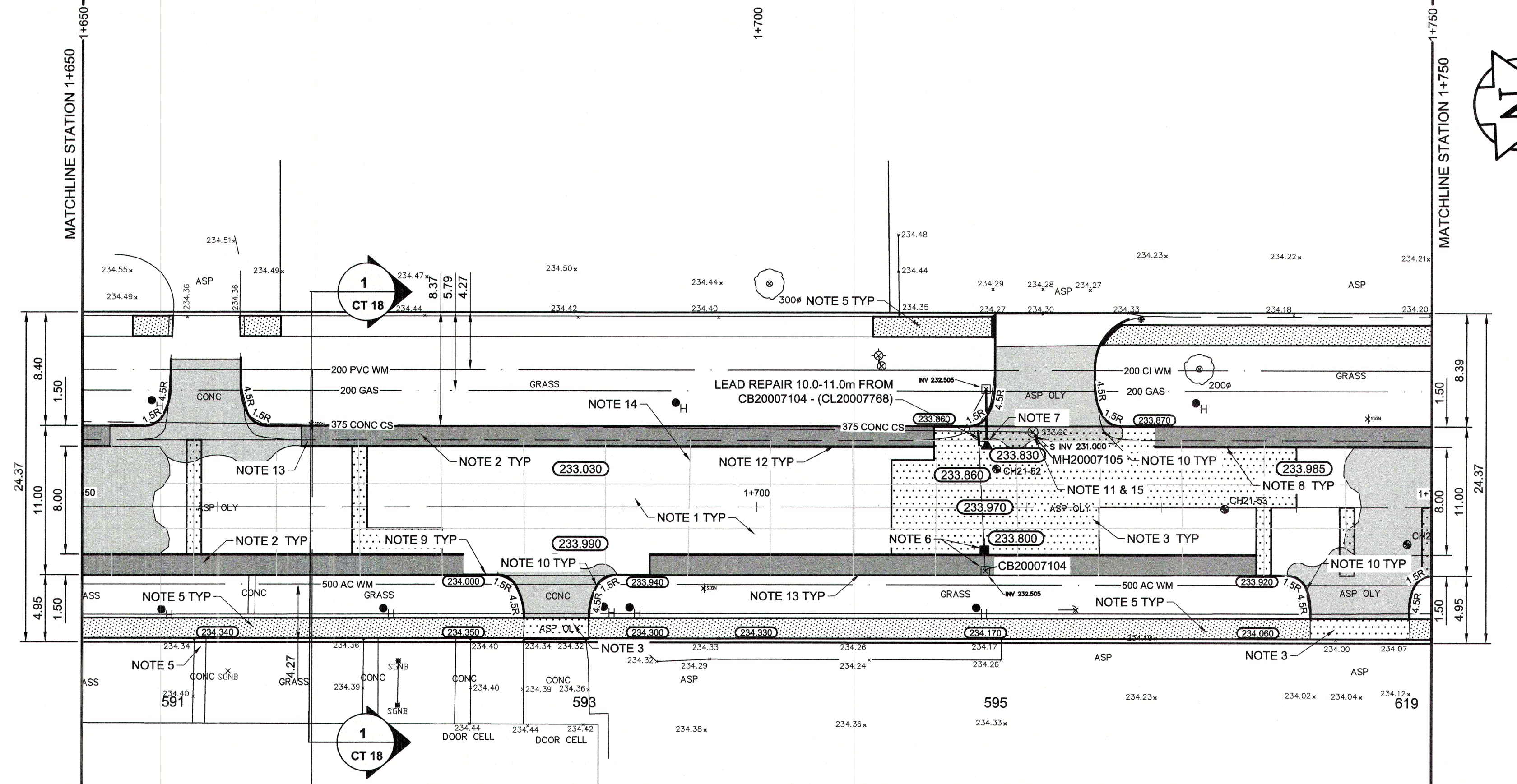

**REFERENCE NOTES:**

- A. PAVEMENT DIMENSIONS ARE TO BACK OF CURB
- B. BASELINE IS CENTRE LINE ROADWAY
- C. PROPERTY LINES OBTAINED FROM CITY OF WINNIPEG L.B.I.S., AND NO SCALE FACTOR WAS APPLIED
- D. REFER TO AECOM FIELD BOOK NO. 5113

**CONSTRUCTION NOTES:**

1. CONSTRUCT NEW ASPHALT PAVEMENT OVERLAY TYPE 1A (100mm AVG. THICKNESS)
2. CONSTRUCT NEW ASPHALT BIKE PATHWAY PAVEMENT TYPE 1A (75mm THICKNESS) C/W COMPACTED 125mm OF LIMESTONE BASE COURSE, GEOGRID, 150mm OF 50mm LIMESTONE SUB-BASE AND SEPARATION/FILTRATION GEOTEXTILE.
3. REMOVE EXISTING CONCRETE PAVEMENT AND CONSTRUCT NEW 150m REINFORCED CONCRETE PAVEMENT
4. ADJUST EXISTING MANHOLE / CATCH BASIN TO GRADE
5. RENEW EXISTING CONCRETE SIDEWALK
6. REMOVE AND RELOCATE EXISTING CATCH BASIN AND CONNECT TO EXISTING 250mm LEAD
7. INSTALL NEW CATCH PIT (SD-023) AND CONNECT TO EXISTING CATCH BASIN
8. INSTALL CONCRETE BARRIER CURB (SEPARATE SD-203A 75mm REVEAL)
9. REMOVE EXISTING BARRIER CURB AND CONSTRUCT NEW CONCRETE BARRIER CURB (75mm REVEAL HT. DOWELED)
10. REMOVE EXISTING BARRIER CURB AND CONSTRUCT NEW MODIFIED BARRIER CURB (150mm REVEAL HT.)
11. INSTALL NEW CAST IRON RISER RING
12. CONSTRUCT NEW CONCRETE BARRIER CURB (75mm REVEAL HT. DOWELED)
13. REMOVE EXISTING CONCRETE BARRIER CURB
14. CONTRACT ADMINISTRATOR TO DETERMINE LOCATIONS FOR INSTALLATION OF PAVEMENT REPAIR FABRIC PRIOR TO ASPHALT PAVING
15. MH20007105 - REPAIR BENCHING AND GROUT WALLS BELOW 1.6m

**ENGINEERS GEOSCIENTISTS MANITOBA**  
Certificate of Authorization  
AECOM Canada Ltd.  
No. 4671 Date: 2022/02/17

**METRIC**  
WHOLE NUMBERS INDICATE MILLIMETRES  
DECIMALIZED NUMBERS INDICATE METRES

EXISTING	LEGEND - PLAN	PROPOSED	EXISTING	LEGEND - PLAN	PROPOSED	EXISTING	LEGEND - PROFILE	PROPOSED
150mm W.M.	WATERMAIN	150mm W.M.	---	HYDRO	---	---	Q PROFILE	---
300mm L.D.S.	LAND DRAINAGE SEWER	300mm L.D.S.	---	M.T.S.	---	---	WEST GUTTER	---
250mm W.W.S.	WASTEWATER SEWER	250mm W.W.S.	---	CONCRETE	---	---	EAST GUTTER	---
---	VALVE	---	---	ASPHALT	---	---	WEST PROPERTY LINE	---
---	MANHOLE	---	---	PROPERTY LINE	---	---	EAST PROPERTY LINE	---
---	CATCH BASIN	---	---	SURVEY BAR	---	---	---	---
---	CATCH PIT	---	---	ELEVATION	(235.750)	---	---	---
---	JUNCTIONS	---	---	TREE	---	---	---	---
---	CULVERT	---	---	SIDEWALK RAMP	---	---	---	---
---	GAS	---	---	CONCRETE SIDEWALK	---	---	---	---
---	---	---	---	FENCE	---	---	---	---

**LOCATION APPROVED UNDERGROUND STRUCTURES**  
SUPV. U/G STRUCTURES COMMITTEE DATE  
NOTE: LOCATION OF UNDERGROUND STRUCTURES AS SHOWN ARE BASED ON THE BEST INFORMATION AVAILABLE, BUT NO GUARANTEE IS GIVEN THAT THE GIVEN LOCATIONS ARE EXACT. CONFIRMATION OF EXISTENCE AND EXACT LOCATION OF ALL SERVICES MUST BE OBTAINED FROM THE INDIVIDUAL UTILITIES BEFORE PROCEEDING WITH CONSTRUCTION.

#30 N.W. Corn. Queen St. & Silver Ave., Tblt. in S. Corn. foundation No. 424 Queen St., 1m E. & 0.2m below.  
ELEVATION: 234.449m. BOOK # 5113  
DESIGNED BY: BC  
DRAWN BY: AA  
CHECKED BY: BC/TF  
APPROVED BY: [Signature]  
HOR. SCALE: 1=250  
VERTICAL: 1=10  
ISSUED FOR TENDER: 02/17/2022 BC  
ISSUED FOR REVIEW: 01/28/2022 BC  
NO. REVISIONS DATE BY

**AECOM**  
DESIGNED BY: BC  
DRAWN BY: AA  
CHECKED BY: BC/TF  
APPROVED BY: [Signature]  
HOR. SCALE: 1=250  
VERTICAL: 1=10  
ISSUED FOR TENDER: 02/17/2022 BC  
ISSUED FOR REVIEW: 01/28/2022 BC  
NO. REVISIONS DATE BY

ENGINEER'S SEAL  
PROVINCE OF MANITOBA  
REGISTERED PROFESSIONAL ENGINEER  
Member 23820  
2022/02/17

**THE CITY OF WINNIPEG**  
PUBLIC WORKS DEPARTMENT  
ENGINEERING DIVISION  
2022 LOCAL AND INDUSTRIAL STREET RENEWAL PROGRAM  
BERRY STREET - PORTAGE AVENUE TO ELLICE AVENUE ASPHALT PAVEMENT REHABILITATION STATION 1+650 TO STATION 1+750  
CITY DRAWING NUMBER SHEET 18 OF 19