

NOTE: CHAINAGES SHOWN ARE ALONG CENTRE LINE OF ROW

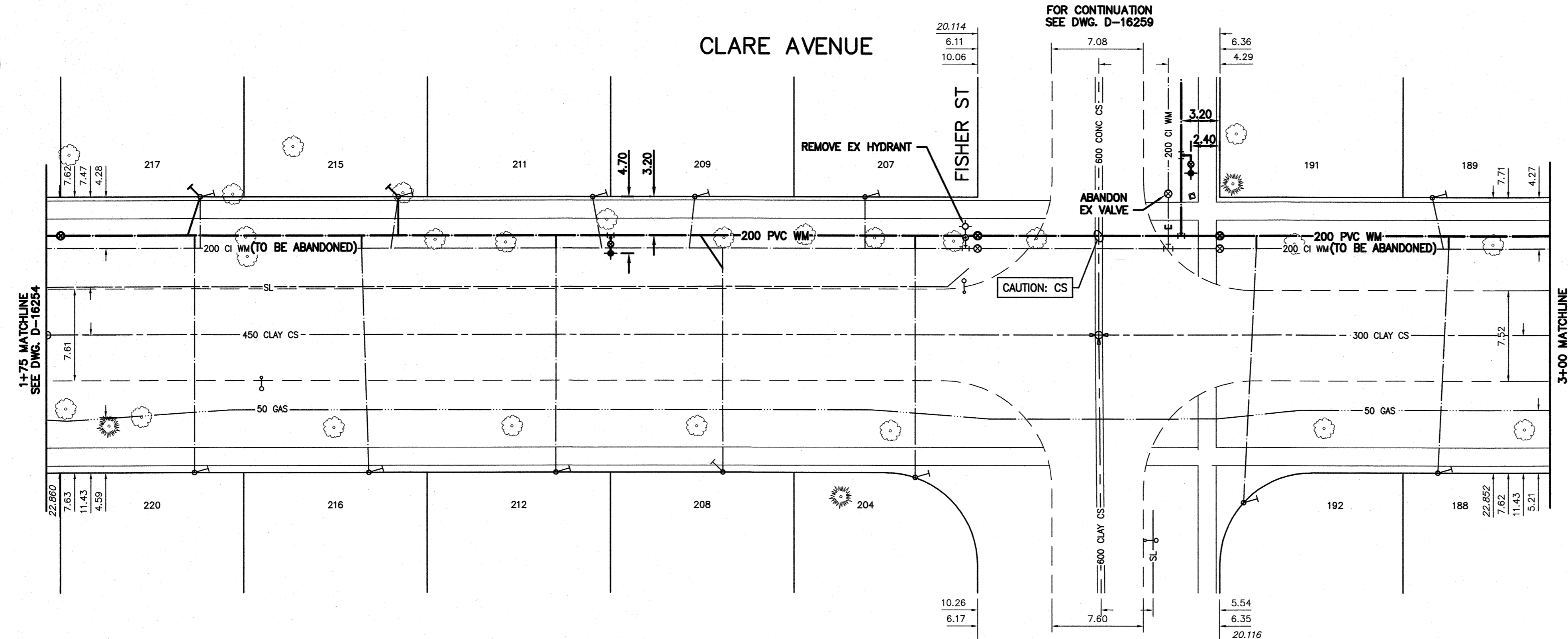
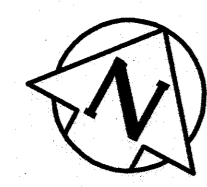

WATER SERVICE INFORMATION

ADDRESS	PIPE SIZE & MATERIAL (STREET)	PIPE SIZE & MATERIAL (PROP.)	SHORT & LONG MEASUREMENT	CORP. LOCATION	REMARKS
220 CLARE AVE	CU	CU	7.00 WEL HSE	OPP S/C	RECONNECT SERVICE
RESIDENTIAL	20	20	286.50 EEL CASEY		
* 217 CLARE AVE	LEAD	CU	OPP EL FRONT DOOR	1.0 E S/C	RECONNECT SERVICE
RESIDENTIAL	12	20	212.00 WWL FISHER		
216 CLARE AVE	CU	CU	5.50 WEL HSE	2.0 W S/C	RECONNECT SERVICE
RESIDENTIAL	20	20	166.00 WWL FISHER		
* 215 CLARE AVE	LEAD	LEAD	1.00 WEL HOUSE	160.0 WWL FISHER	RENEW SERVICE
RESIDENTIAL	12	12	158.00 WWL FISHER		
212 CLARE AVE	CU	CU	9.00 WEL HSE	OPP S/C	RECONNECT SERVICE
RESIDENTIAL	20	20	385.00 EEL CASEY		
211 CLARE AVE	CU	LEAD	2.00 EEL HSE	2.5 E S/C	RECONNECT SERVICE
RESIDENTIAL	20	12	105.00 WWL FISHER		
209 CLARE AVE	CU	CU	16.00 EWL HSE	1.5 W S/C	RECONNECT SERVICE
RESIDENTIAL	20	20	78.00 W HYD NWCOR FIS&CLAR		
208 CLARE AVE	CU	CU	5.90 W ELL	OPP CS	RECONNECT SERVICE
RESIDENTIAL	20	20			
207 CLARE AVE	CU	CU	12.00 EWL HSE	OPP S/C	RECONNECT SERVICE
RESIDENTIAL	20	20	31.00 W HYD NWCOR FIS&CLAR		
204 CLARE AVE	CU	CU	2.00 EEL HSE	OPP S/C	RECONNECT SERVICE
RESIDENTIAL	20	20	483.00 EEL CASEY		
192 CLARE AVE	CU	CU	1.00 WWL HSE	3.5 E S/C	RECONNECT SERVICE
RESIDENTIAL	20	20	6.50 EEL FISHER		
191 CLARE AVE	LEAD	LEAD	3.66 N/S H/L	0.3 S/SC	(SERVICED OFF FISHER ST)
RESIDENTIAL	20	20	52.00>NNL CLARE		
189 CLARE AVE	CU	CU	6.00 EWL HSE	3.0 E S/C	RECONNECT SERVICE
RESIDENTIAL	20	20	58.00 EEL FISHER		
188 CLARE AVE	CU	CU	4.00 EWL HSE	3.0 E S/C	RECONNECT SERVICE
RESIDENTIAL	20	20	59.50 EEL FISHER		

* SERVICES TO BE RENEWED TO t

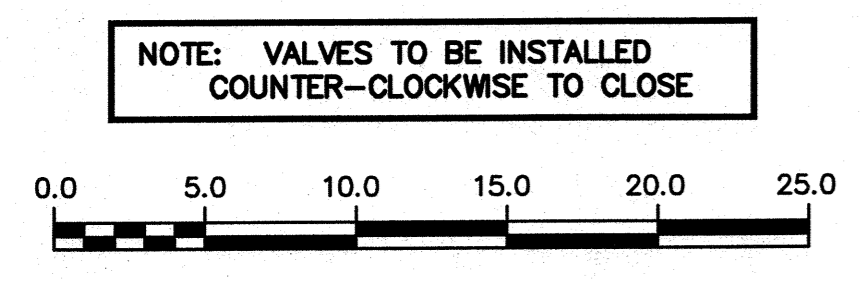

NOTE: VALVES TO BE INSTALLED COUNTER-CLOCKWISE TO CLOSE

FOR INDEX SEE D-16245

METRIC
WHOLE NUMBERS INDICATE MILLIMETRES
DECIMALIZED NUMBERS INDICATE METRES

ENGINEERS GEOSCIENTISTS MANITOBA
Certificate of Authorization
Stantec Consulting Ltd.
No. 1301

LOCATION APPROVED UNDERGROUND STRUCTURES

SUPV. U/G STRUCTURES COMMITTEE DATE

NOTE:
LOCATION OF UNDERGROUND STRUCTURES AS SHOWN ARE BASED ON THE BEST INFORMATION AVAILABLE BUT NO GUARANTEE IS GIVEN THAT ALL EXISTING UTILITIES ARE SHOWN OR THAT THE GIVEN LOCATIONS ARE EXACT. CONFIRMATION OF EXISTENCE AND EXACT LOCATION OF ALL SERVICES MUST BE OBTAINED FROM THE INDIVIDUAL UTILITIES BEFORE PROCEEDING WITH CONSTRUCTION.

B.M. 53-31 ELEV. 232.097	N.W. Cor. Baltimore Rd. & Hay St., Brass plug in 14.8m Conc. pile, 2.4m E. of W.L. Hay St., 2.4m S. of N.L. Baltimore Rd.		
NO.	REVISIONS	DATE	BY
01	ISSUED FOR TENDER	2022.04.22	RS

Stantec

DESIGNED BY: RS
DRAWN BY: OS
SCALE: HORIZONTAL 1:250, VERTICAL 1:50
DATE: 2022.03.01

CHECKED BY: RS
APPROVED BY: RS
RELEASED FOR CONSTRUCTION: [Signature]
DATE: 2022.04.22

ENGINEER'S SEAL

PROVINCE OF MANITOBA
2022-04-22
B.A. SHERLOCK
Member
24045
REGISTERED PROFESSIONAL ENGINEER

CONSULTANT DRAWING NUMBER: C-210

THE CITY OF WINNIPEG
WATER AND WASTE DEPARTMENT
ENGINEERING DIVISION

2022 WATERMAIN RENEWALS
CONTRACT 5
CLARE AVENUE
75.0 E OF CASEY STREET TO
27.5 E OF FISHER STREET

SHEET 12 OF 16
CITY DRAWING NUMBER: D-16255